

REVISIONS

Shoppes On Broadway
Building Shell Only
1630 Broadway South
Rochester, Minnesota 55904

HEREBY CERTIFY THAT THIS PLAN, SPECIFICATION, OR REPORT WAS PREPARED BY ME OR UNDER MY DIRECT SUPERVISION AND THAT I AM A DULY LICENSED ARCHITECT UNDER THE LAWS OF THE STATE OF MINNESOTA.

TODD A. JELNSKI
 09-14-2017 43796
 DATE REG. NO.

LJA JOB # 15326
 PROJ. DATE: 09-14-2017
 FILE NAME: 15326_A101
 DWG. SCALE:
 CHECKED BY: TAJ
 DRAWN BY: PAN

SHEET DESCRIPTION
Floor Plan

A101

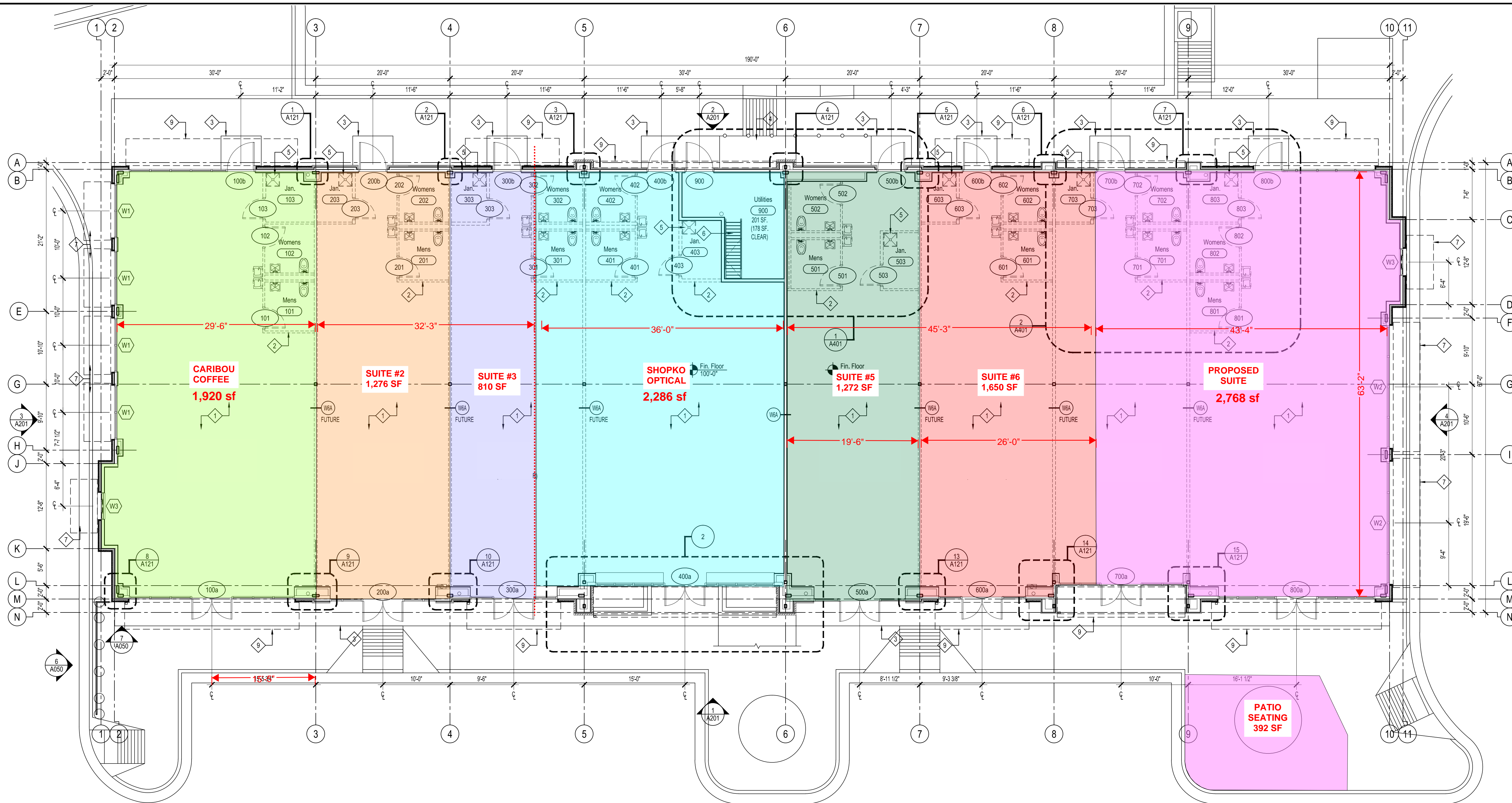

1 Floor Plan, Building Footprint - 12, 381 SF.

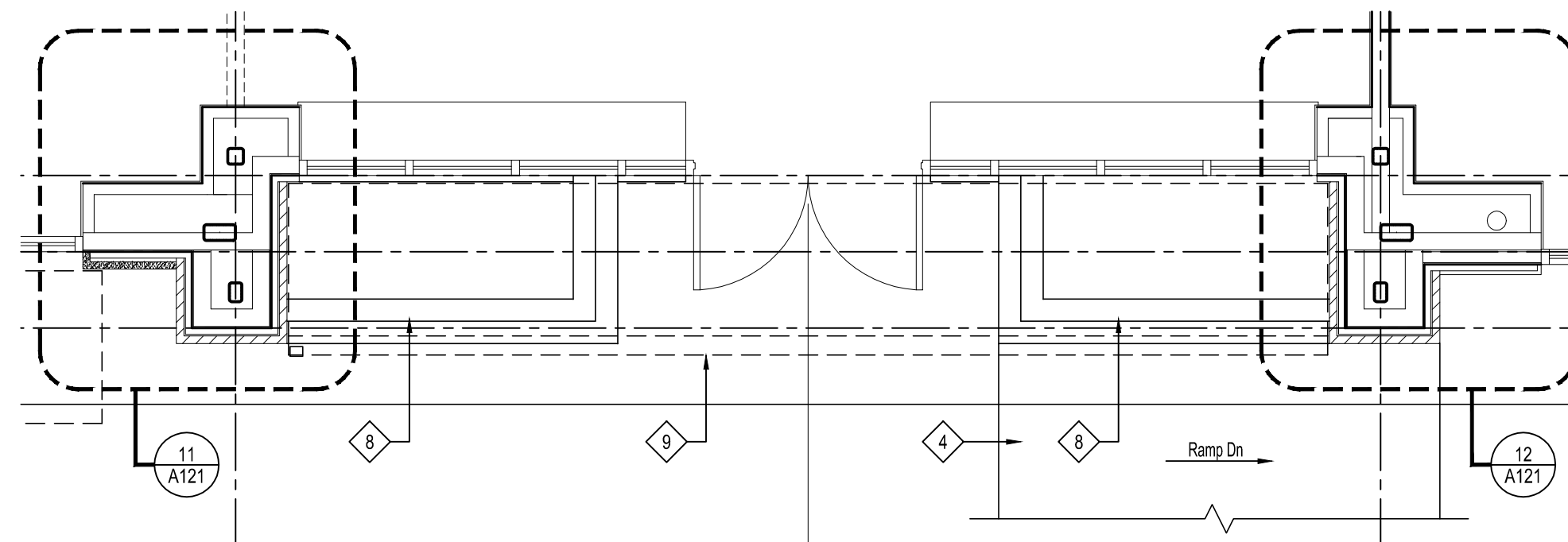

2 Enlarged Floor Plan

CONSTRUCTION NOTES

#	DESCRIPTION
1	Suite interior floor plan shown for reference only. Final design per tenant fit up.
2	Restroom design shown for reference only. Final design per tenant fit up. Final design to be ADA compliant and meet any and all local design codes and regulation requirements.
3	Concrete stoop - (see structural drawings)
4	Concrete ramp - (see civil drawings)
5	Future mop sink
6	Ships ladder to roof access hatch
7	Window canopy - (see elevations & sections)
8	Plaster box
9	Entry canopy - (see elevations & sections)

General wall notes:
 1. See structural drawings for any/all reinforcing, curb, footing and foundation details and general information.
 2. Bottom of truss is 114'-0". Ceiling height to be determined by tenant fit up per ceiling system and coordination w/ lighting & mechanical ventilation systems w/ maximum ceiling height of 114'-0".
 3. All walls to extend to roof or floor structure above unless noted otherwise.
 4. See sheet A121 for wall types notes.