

AVAILABLE FOR LEASE: 13,189 TOTAL SF

ANOTHER INNOVATIVE DEVELOPMENT BY PRICE REAL ESTATE

LONE PEAK BUSINESS

PARK – OLYMPUS

12218 S. LONE PEAK PKWY., SUITES 103-105
DRAPER, UT 84020





PROPERTY FEATURES

13,189 Total Square Feet

- 4,237 Office Square Feet
- 8,952 Warehouse Square Feet

Three (3) Dock High Doors Equipped with EOD Levelers and Bumpers

Three (3) Ground Level Doors (10'x12')

18' Clear Height

Power: 675 Amp / 480 / 277 V / 3 Phase

Class A Corporate Business Park Environment

Generous Storefront Glass Treatments

Excellent Access to I-125 via 12300 South

N

LIFE SCIENCE WAY

- Three (3) Ground Level Doors (10'x12')
- Three (3) Dock High Doors

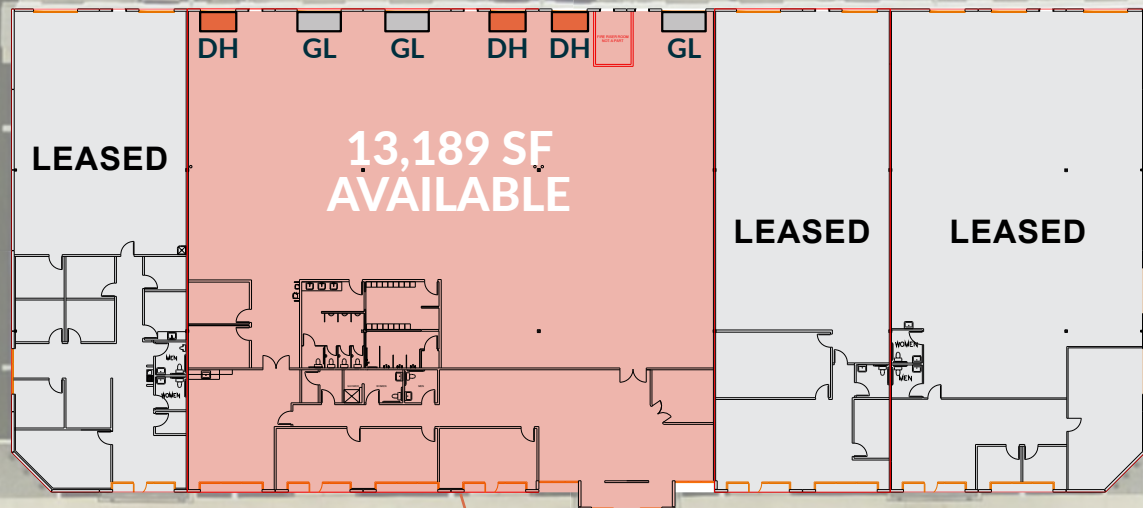

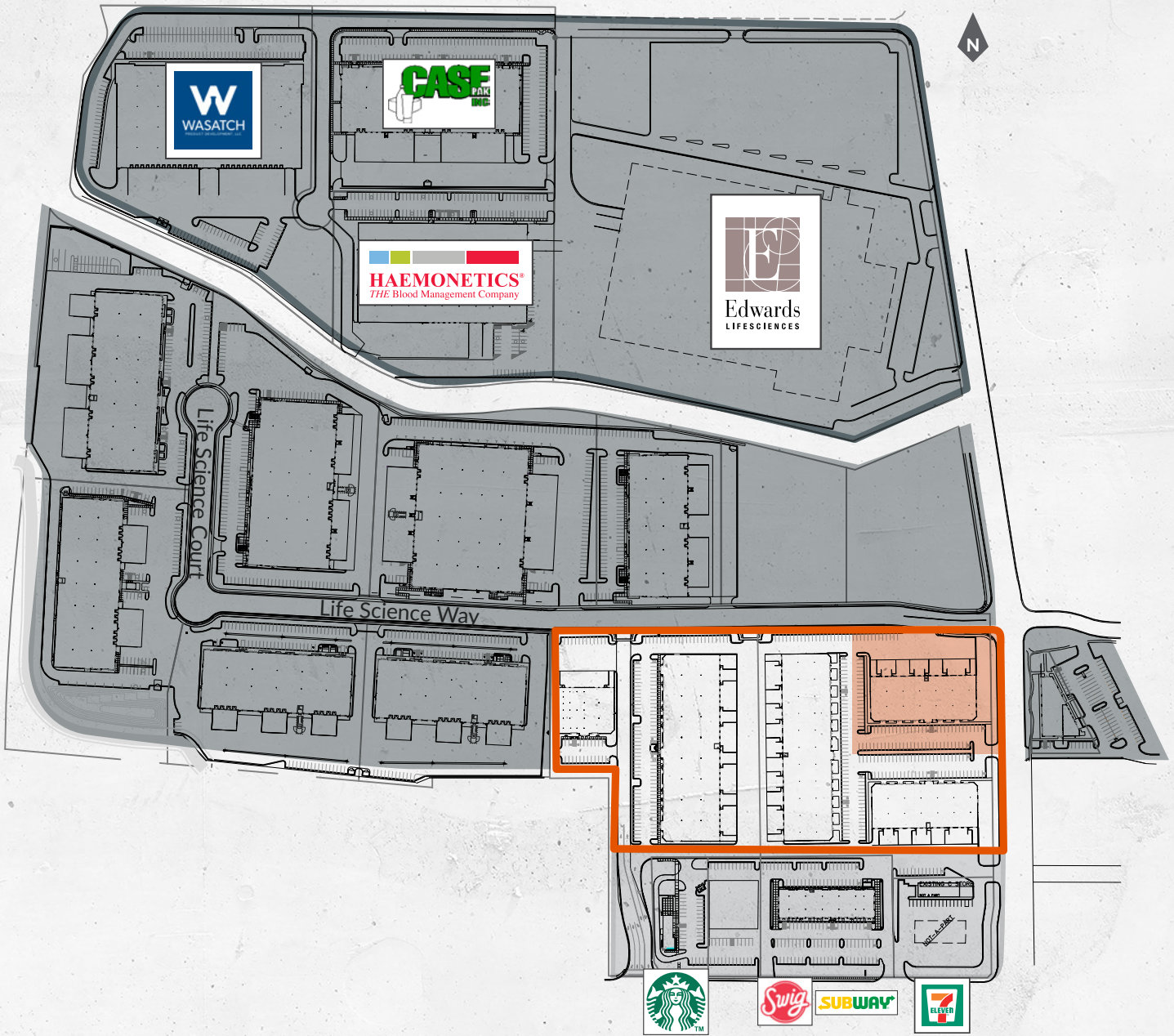

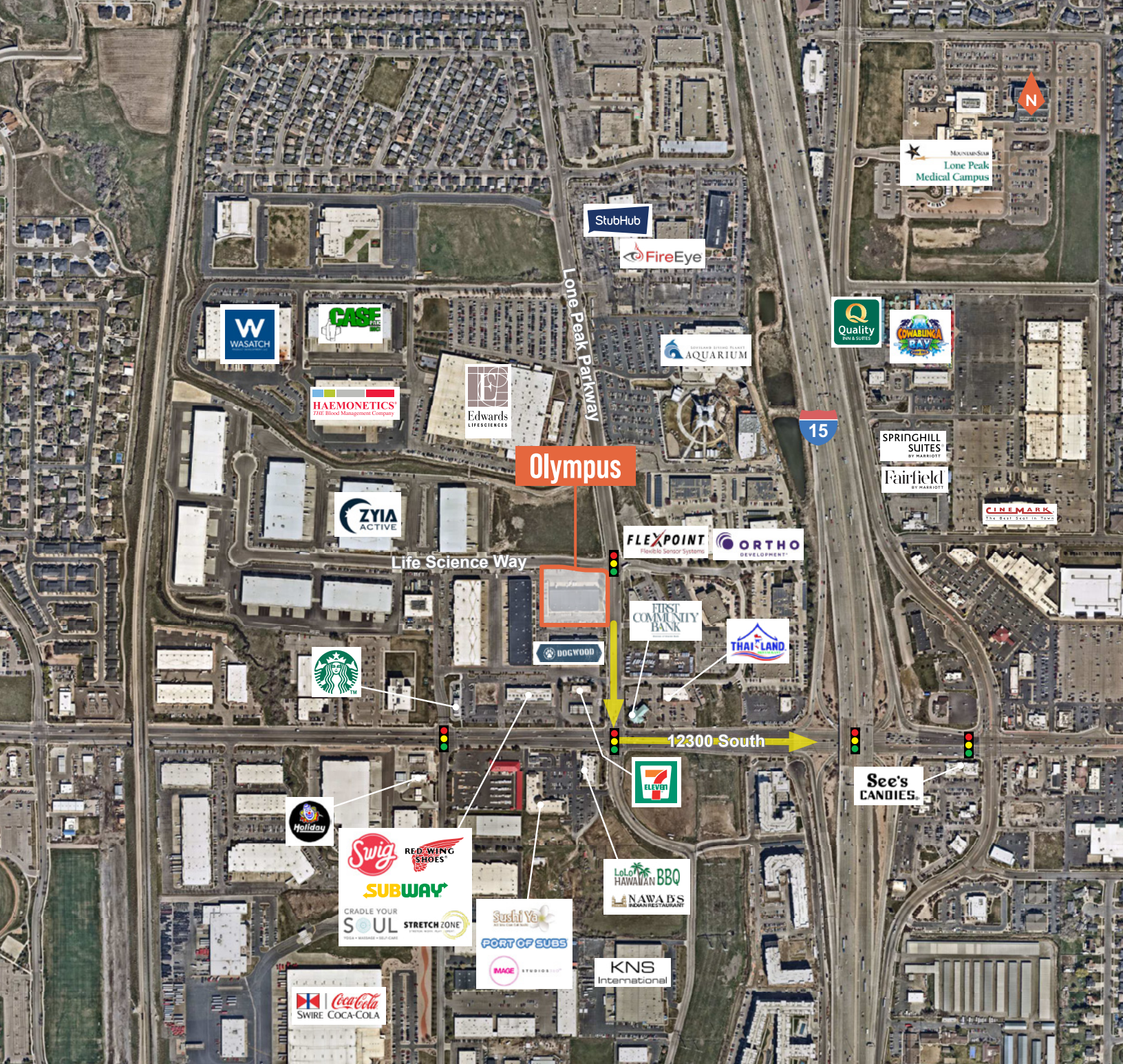

LISTED BY:

Kyle Roberts, CCIM, SIOR, CSCMP
 t 801-578-5525
 kroberts@newmarkmw.com

Ben Richardson
 t 801-746-4733
 brichardson@newmarkmw.com

The information contained herein has been obtained from sources deemed reliable but has not been verified and no guarantee, warranty or representation, either express or implied, is made with respect to such information. Terms of sale or lease and availability are subject to change or withdrawal without notice.