

FOR  
LEASE

# TYLER VILLAGE

CLEVELAND, OH 44114



CREATIVE LOFT OFFICE SUITES IN THE HEART  
OF THE ST. CLAIR-SUPERIOR DISTRICT



3615 SUPERIOR AVE  
CLEVELAND, OHIO

# VILLAGE OVERVIEW

THE TYLER VILLAGE mixed-use complex sits in the heart of Cleveland's St. Clair-Superior neighborhood. This dynamic area is home to iconic landmark hot spots, Slyman's Deli, the "Pho Row" groups of restaurants, galleries, grocery and Asian food markets. Offering close proximity to Interstate I-90, Route 2, University Circle and Downtown Cleveland, TYLER VILLAGE'S convenient location is a leading factor in the neighborhoods growth.

- ◆ Excellent Highway Access
- ◆ Parking: 380 free surface spaces
  - › Covered parking available
  - › Abundant free spaces in East 36th ancillary parking lots
- ◆ Ownership is committed to individual premise upgrades to increase superior air quality through UV light systems and air filtration systems
- ◆ 24/7 On-site Security Staff
- ◆ Tyler Village Amenities:
  - › The Bake Shop / The Roaming Biscuit (breakfast, lunch, coffee)
  - › Building Conference Room
  - › Fitness Operator
- ◆ Area Amenities Include:
  - › Grocery store, drug store, and post office
  - › Luxury lakefront housing
  - › Close to childcare, doggie day care, and farmers market
  - › Diverse restaurants and shops
  - › In the heart of a vibrant arts community





# AVAILABLE SPACES

TYLER EAST

## AVAILABLE OFFICE SPACE

| UNIT # | RSF   | CONTIG. | DESCRIPTION   |
|--------|-------|---------|---------------|
| 2004A  | 2,853 | 2,853   | Office        |
| 4401A  | 1,162 | 3,651   | Office/Retail |
| 4401B  | 2,489 | 3,651   | Office/Retail |
| 4404B  | 5,500 | 5,500   | Office        |

## CAMPUS NOTES

- Spec suites now available in flexible sizing and terms
- Vaulted Ceilings
- New hardwood floors, LED lights, upgraded power, new HVAC, new windows and more.





# SITE PLAN

## KEY

DEEPER COLORS  
DENOTE  
BUILDINGS  
WITH  
AVAILABILITIES



TYLER WEST



TYLER EAST



BLDG. 44



BLDG. 31

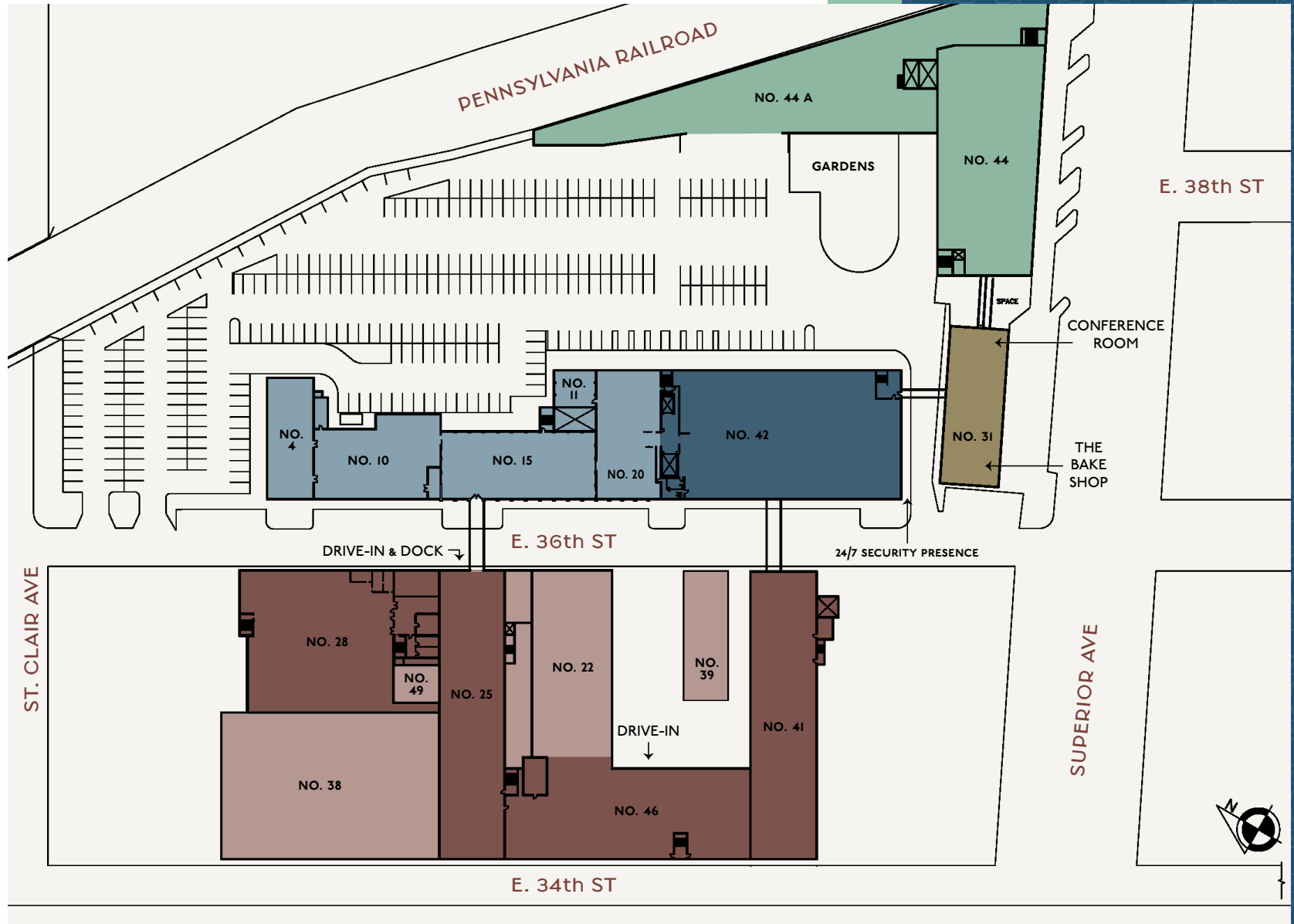



TYLER

# FLOOR PLAN

BUILDING 20

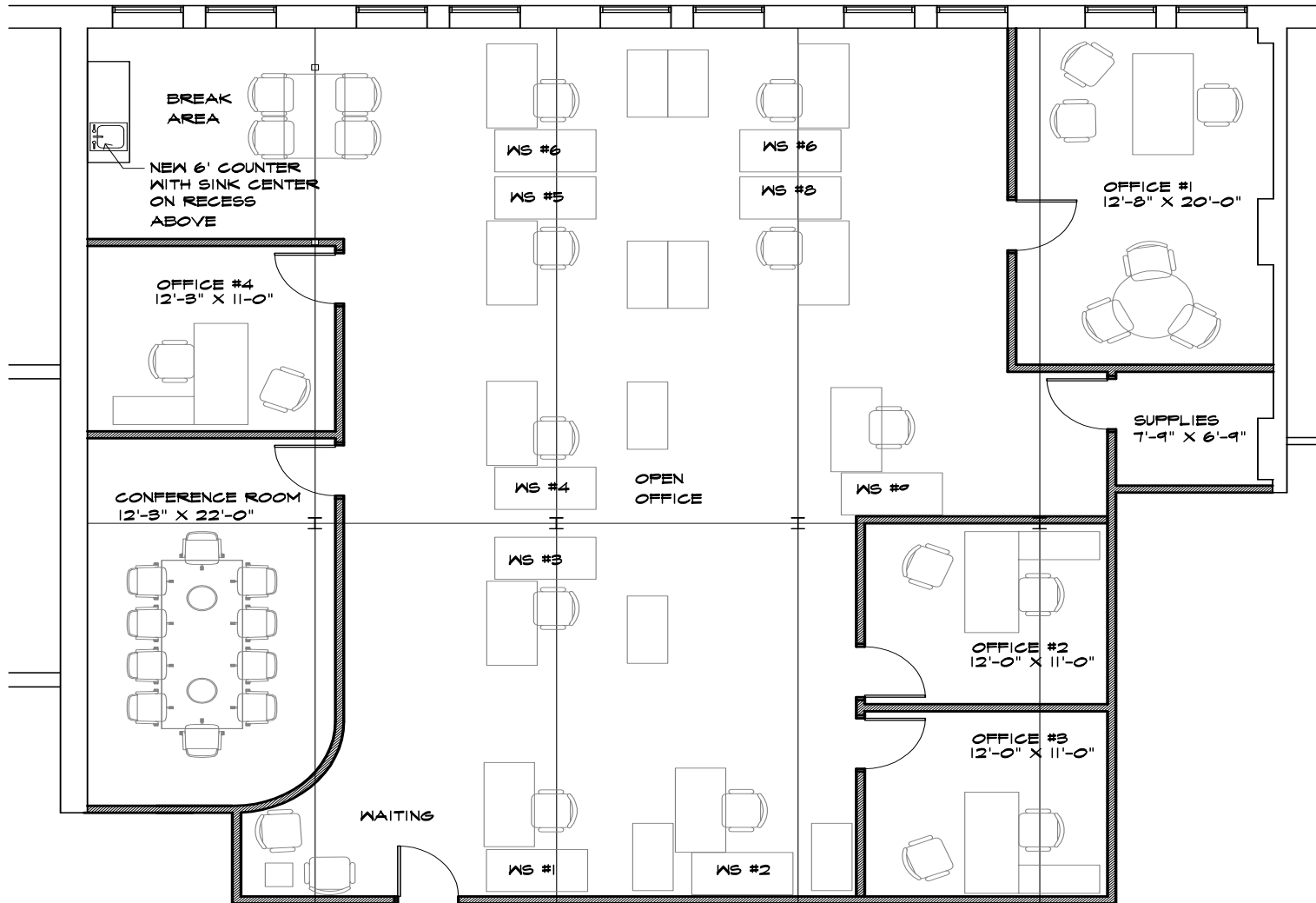

AVAILABLE  
SPACE

2004A



# FLOOR PLAN

BUILDING 44

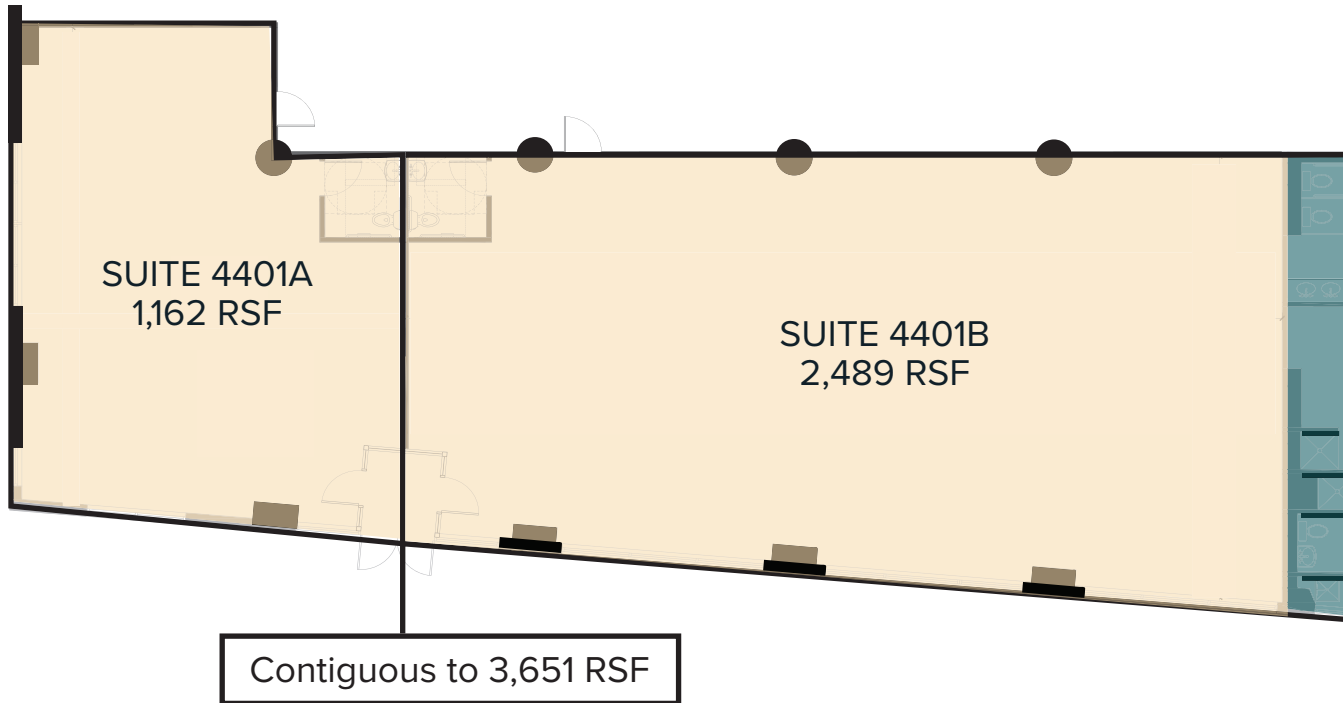

|                         |              |
|-------------------------|--------------|
| <b>AVAILABLE SPACES</b> | <b>4401A</b> |
|                         | <b>4401B</b> |



TYLER

# FLOOR PLAN

BUILDING 44

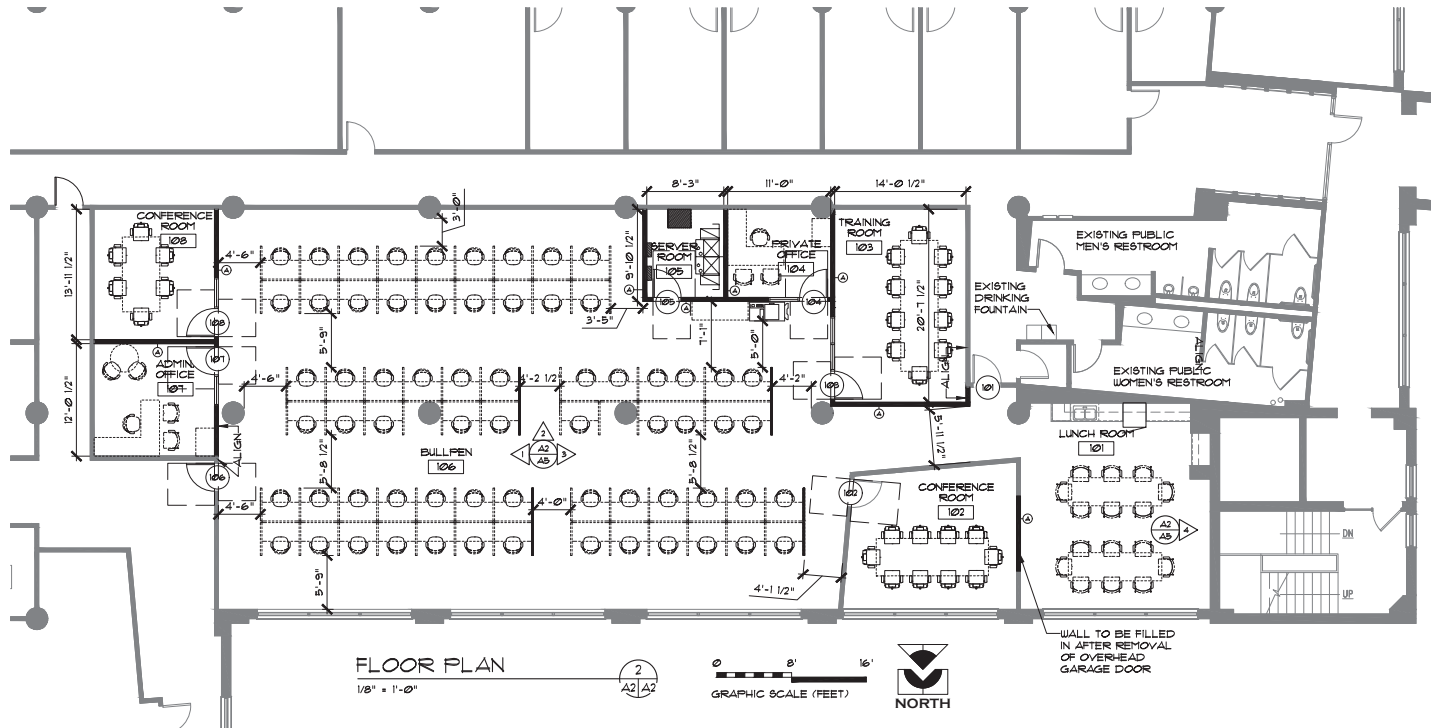

**AVAILABLE SPACE**

**4404B**

# NEARBY NEIGHBORHOODS

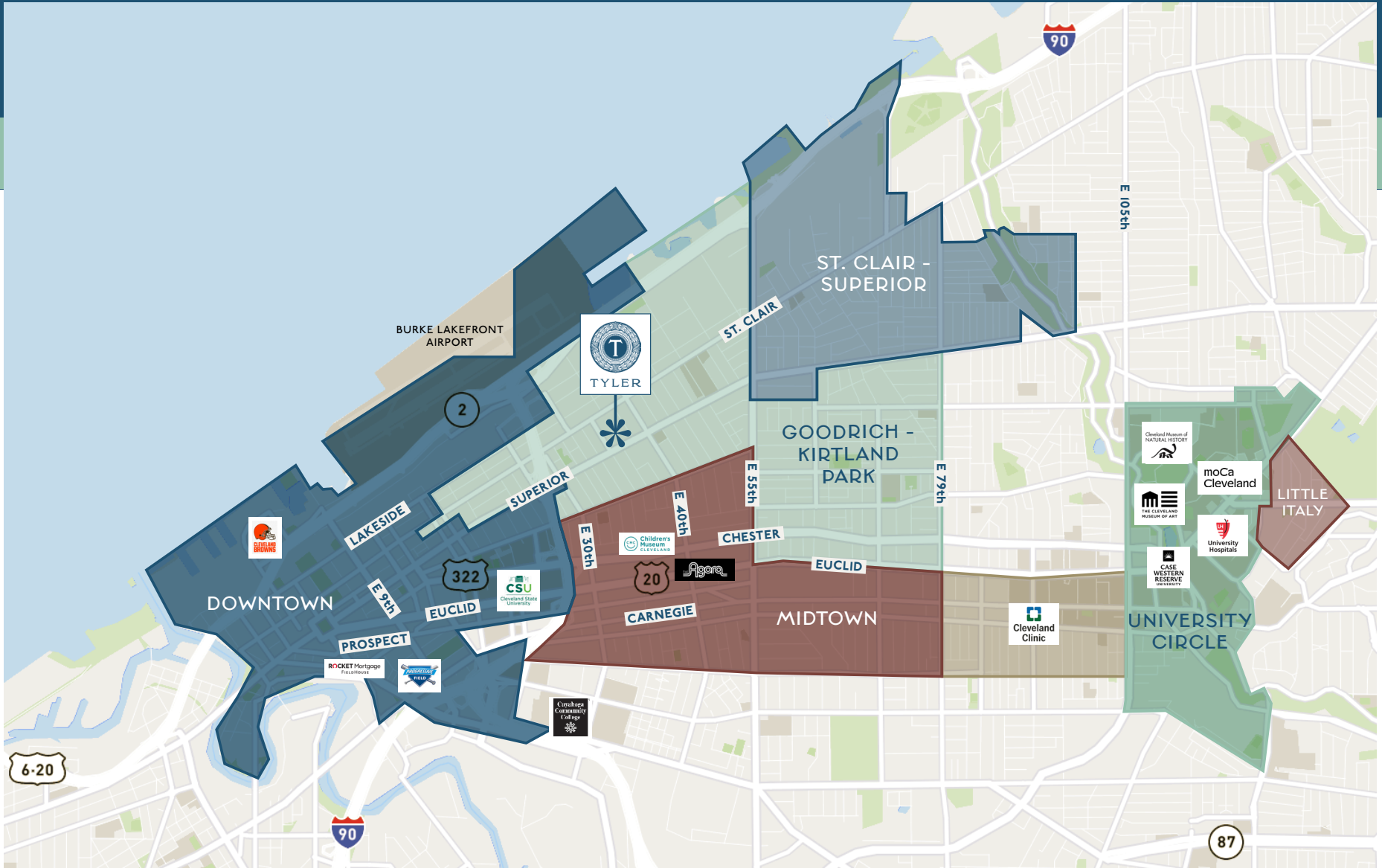

# LOCAL MAP



# TYLER VILLAGE

3615 SUPERIOR AVENUE  
CLEVELAND, OHIO 44114

## CONTACTS

STEPHEN MORRIS

Associate

+1 216 658 6115

[stephen.morris2@cbre.com](mailto:stephen.morris2@cbre.com)

# CBRE

CBRE, INC.  
950 Main Avenue, Suite 200  
Cleveland, Ohio 44114

© 2025 CBRE, Inc. All rights reserved. This information has been obtained from sources believed reliable but has not been verified for accuracy or completeness. CBRE, Inc. makes no guarantee, representation or warranty and accepts no responsibility or liability as to the accuracy, completeness, or reliability of the information contained herein. You should conduct a careful, independent investigation of the property and verify all information. Any reliance on this information is solely at your own risk. CBRE and the CBRE logo are service marks of CBRE, Inc. All other marks displayed on this document are the property of their respective owners, and the use of such marks does not imply any affiliation with or endorsement of CBRE. Photos herein are the property of their respective owners. Use of these images without the express written consent of the owner is prohibited.