



Prime Dock-High Warehouse

5911 Thurston Avenue, Virginia Beach, VA 23455

Highlights:

Strategically located in the highly sought-after Airport Industrial Park, this versatile facility offers exceptional access to major transportation routes including I-64, Route 13, and the Chesapeake Bay Bridge Tunnel. Attractive and functional office/warehouse facility, currently set up for distribution but also has heavy electrical power capability which makes it ideal for manufacturing.

- Warehouse: 20,000 SF - 60,262 SF available
- Column Spacing: 41' wide x 34' (one column line)
- Floor: 5" reinforced concrete
- Fire Suppression: Wet sprinklers throughout
- Power: Up to ±2500 amps, 3-phase, 227/480v
- Loading: 2 dock doors at covered loading dock, with potential to add ramp
- Heat: Suspended natural gas heaters
- Parking: Abundant, expandable parking
- Zoning: I1 (Light Industrial)

For Lease

20,000 SF -
60,262 SF

\$6.95-\$7.95/NNN
(pending size & term)

Contact us:

R. Worth Remick

Senior Vice President
+1 757 228 1849
worth.remick@colliers.com

H. Ashton Williamson, MAI, SIOR

Executive Vice President
+1 757 288 3438
ashton.williamson@colliers.com

Colliers

150 W. Main St., Suite 1100
Norfolk, VA 23510
P: +1 757 490 3300

Property Drawing

Site Plan - 5911 Thurston Avenue

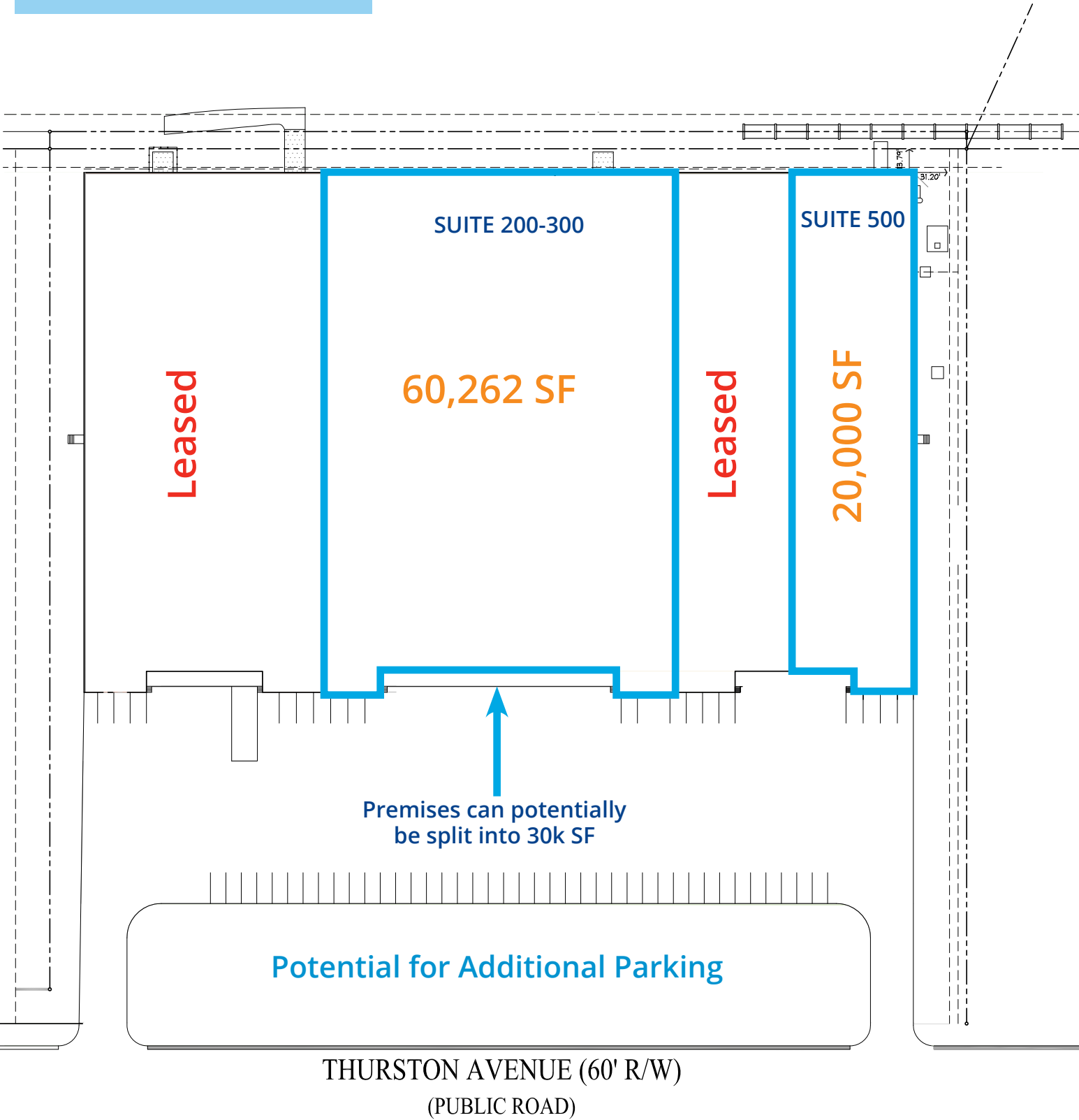

Property Drawings



Floor Plan - Suite 200 & 300

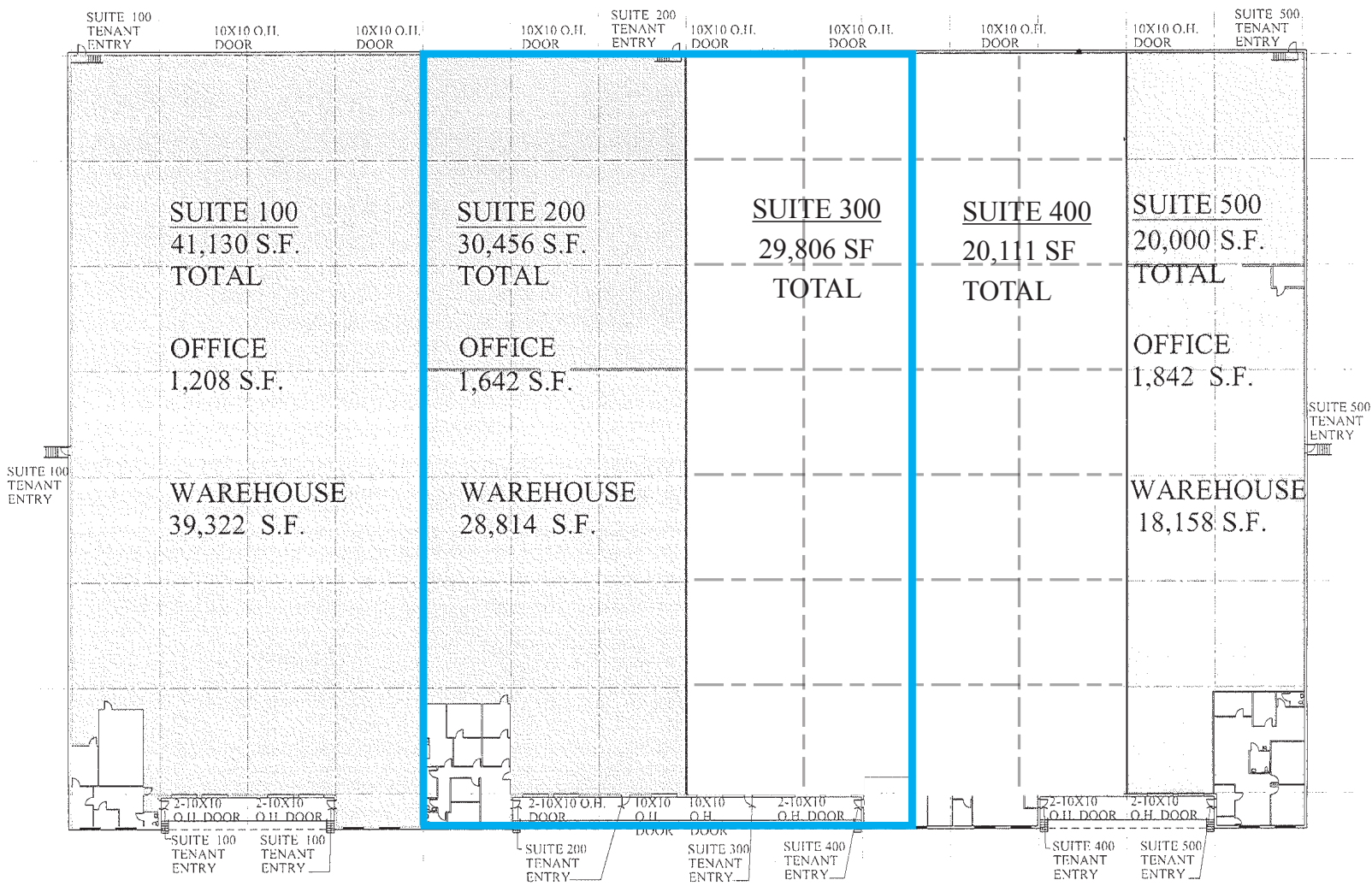

Property Drawings



Floor Plan - Suite 500

Suite 500
20,000 SF
Total

Warehouse
18,158 SF

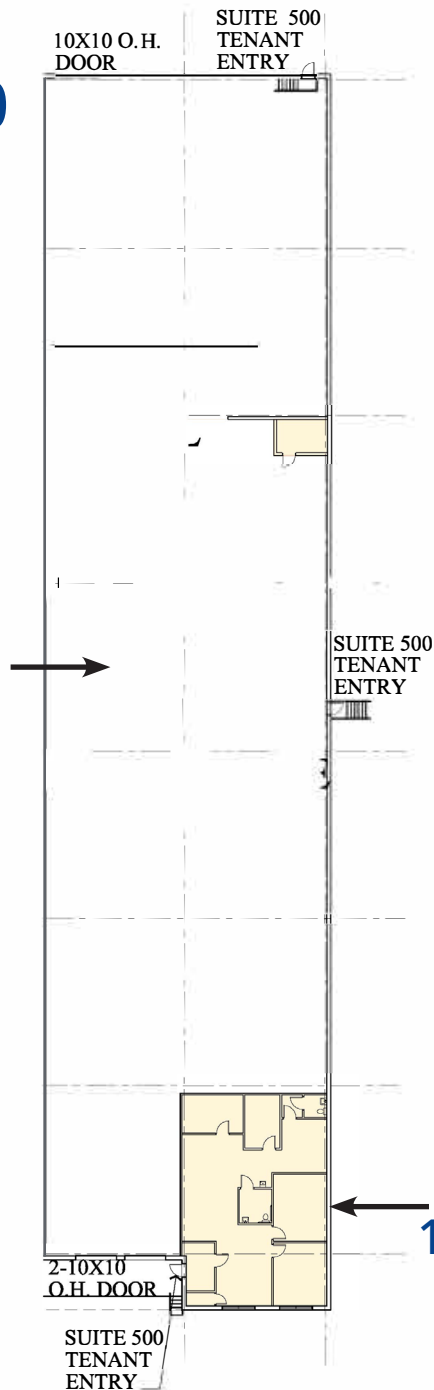

Suite 500

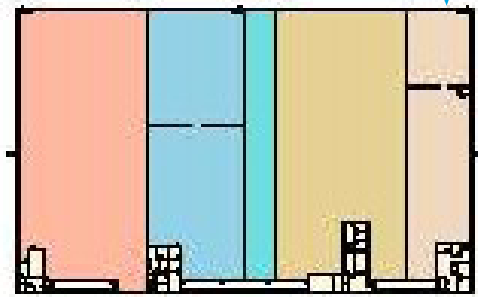

Office
1,842 SF

Property Aerial

Colliers

5911 Thurston Avenue



Area Map

Chesapeake Bay

Atlantic Ocean

Norfolk Harbor

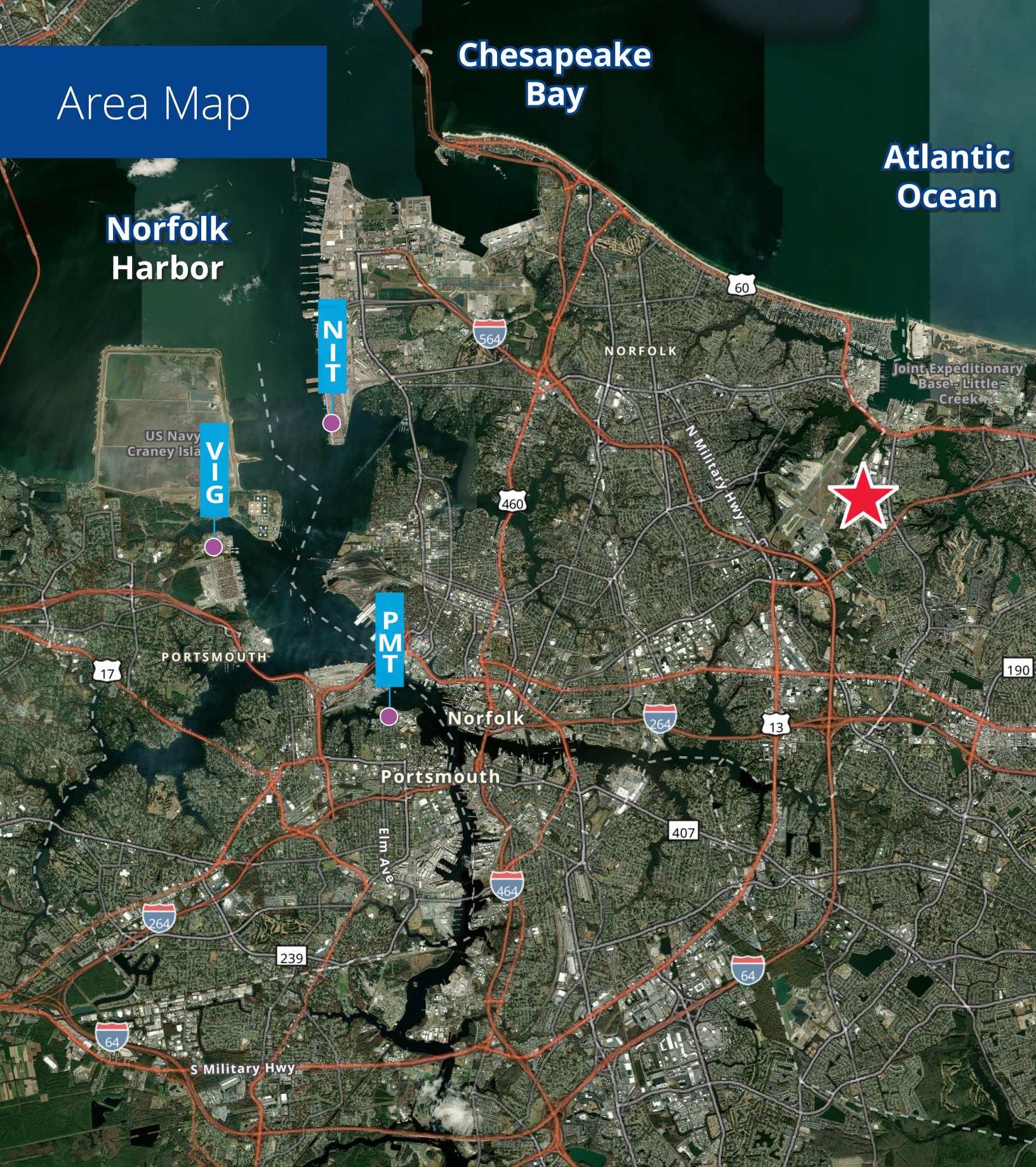

R. Worth Remick
Senior Vice President
+1 757 228 1849
worth.remick@colliers.com

H. Ashton Williamson, MAI, SIOR
Executive Vice President
+1 757 288 3438
ashton.williamson@colliers.com

