



For sublease

2340 Energy Park Dr, Suite 100, St. Paul, MN
32,544 SF Warehouse Available

 **JLL** SEE A BRIGHTER WAY

Building specifications

2340 Energy Park Dr, Suite 100

St. Paul, MN

Available Through

June 30, 2027

Direct Access

to Highway 280

Building Size

107,344 SF

SF Available

32,544 SF Warehouse

Year Built

2005

Clear Height

14'

Loading

Six (6) dock doors with levelers

Parking

1.35/1,000 SF

Sublease Rate

\$9.00 PSF Gross

Available

Now

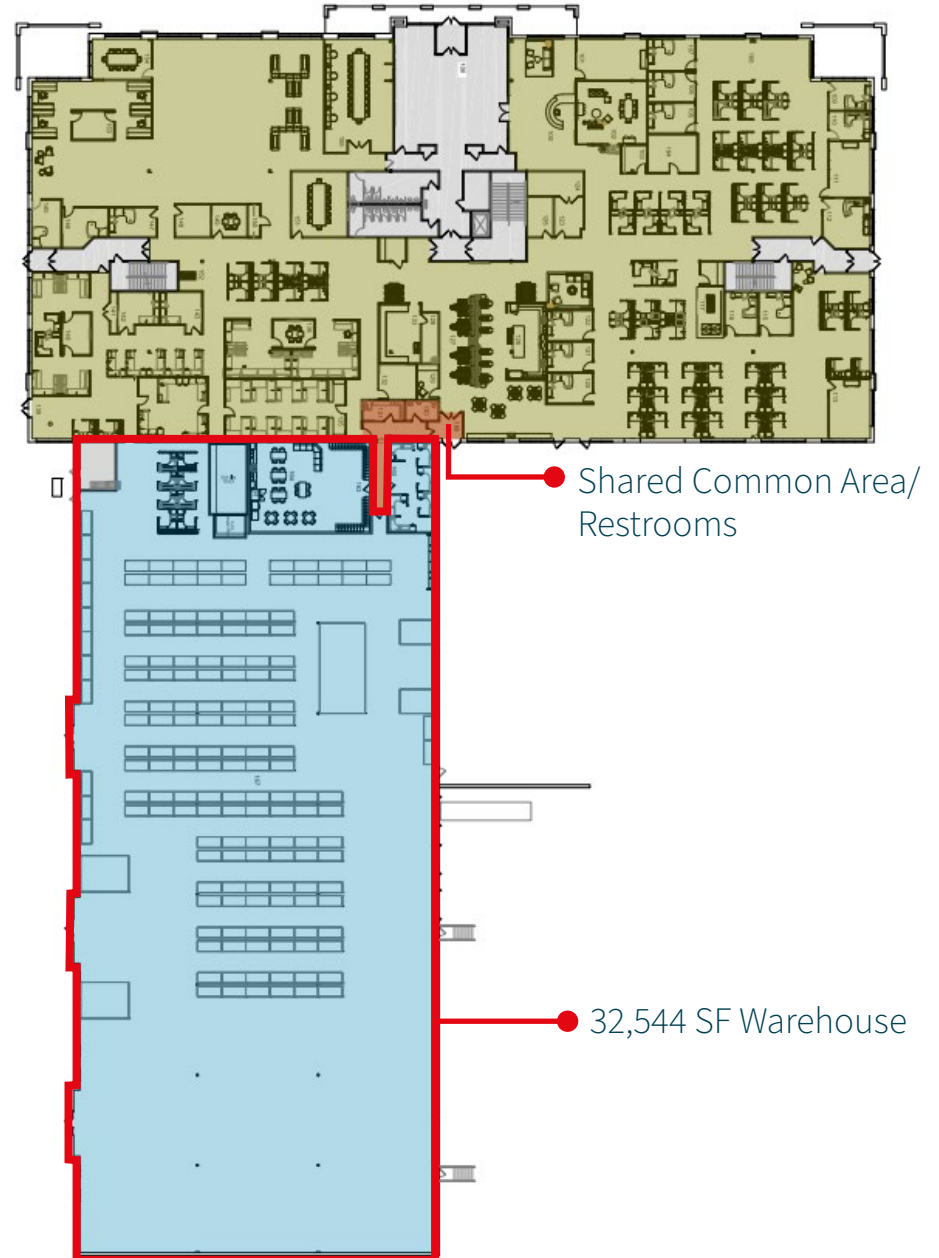

Building photos

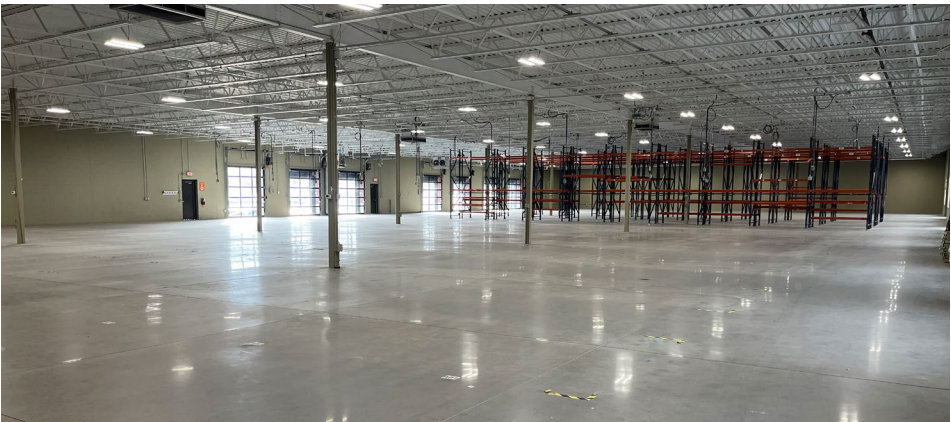

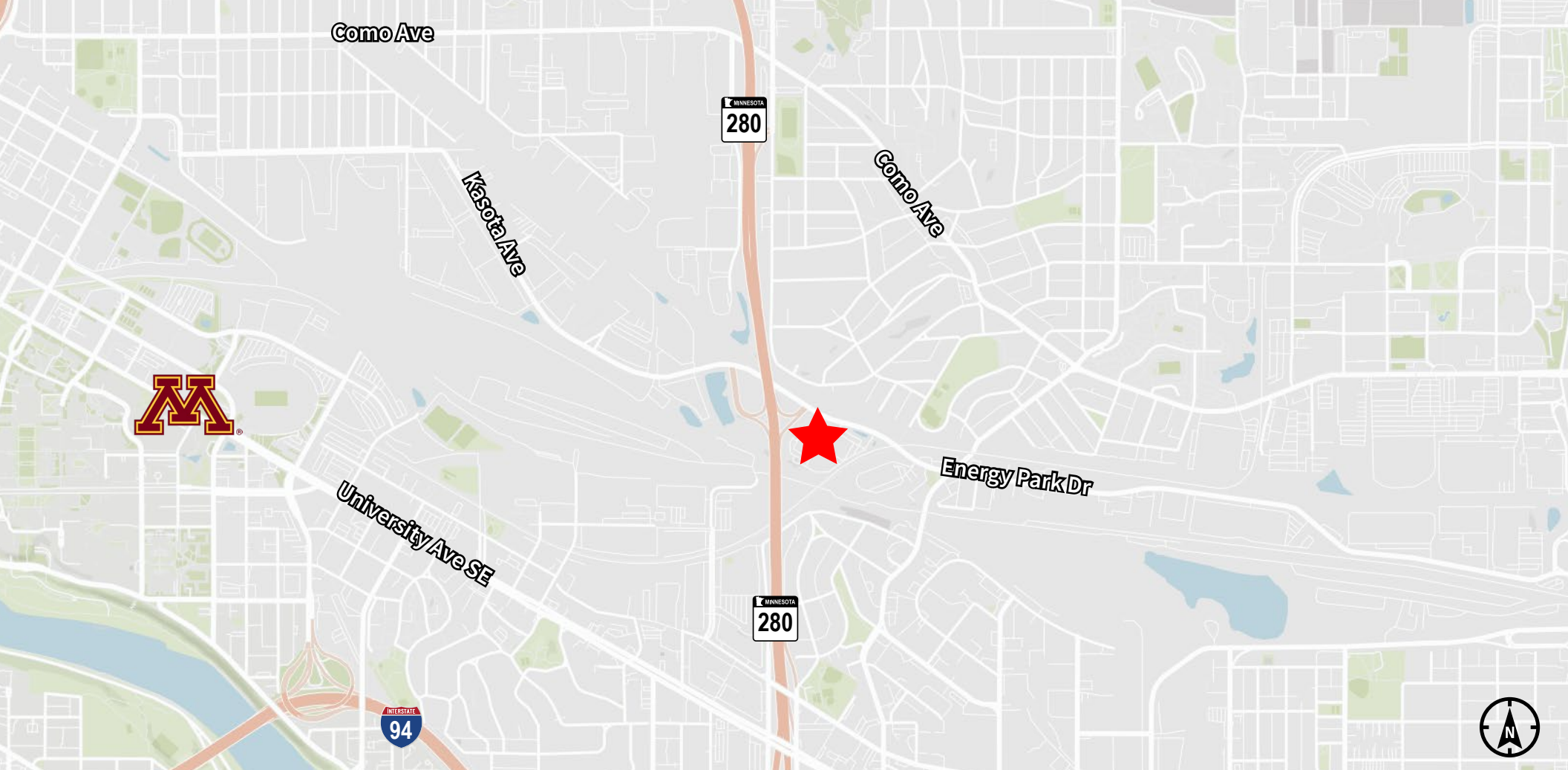

JLL SEE A BRIGHTER WAY

Connor Ott
Senior Vice President
+1 612 217 6741
connor.ott@jll.com

Alex Ach
Executive Vice President
+1 763 354 4419
alex.ach@jll.com

JLL
250 Nicollet Mall
Suite 1000
Minneapolis, MN 55401