

**BUNTON SURVEYING and MAPPING, PA**

231 13TH AVE PL NW  
 HICKORY, NC 28601  
 SUITE 5  
 828-855-3313  
 828-635-0333  
 DEREK R. BUNTON, PLS-4808  
 BUSINESS LICENSE: C-2069

BOUNDARY and LOCATION SURVEY FOR:

**THE EAST WING, INC.**

**HICKORY TOWNSHIP,  
 CATAWBA COUNTY, NC**

DATE: 05/29/25 F.B. H-16, Pg.73 SCALE: 1" = 50'  
 PIN #3721-0887-0844  
 REFERENCE DEED: BOOK 1841 PAGE 564

DRAWN BY: DEREK R. BUNTON, PLS-4808  
 JOB #25050110  
 FILE NAME: 25050110

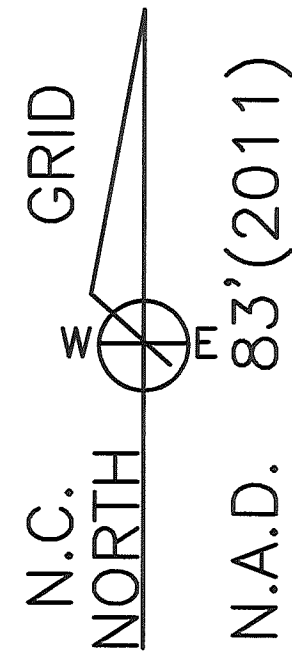

- LEGEND**
- EXISTING IRON ROD - EIR - ●
  - EXISTING IRON PIPE - EIP - ○
  - NEW 1/2" REBAR SET - NIR - ○
  - R.R. SPIKE - ○
  - EXISTING STONE CORNER - △
  - CONCRETE MONUMENT - □
  - N.C.G.S. CONTROL MONUMENT - ■
  - P.K. NAIL - ⊗
  - CALCULATED POINT - +
  - MANHOLE - ⊙
  - DRAINAGE MANHOLE - ⊙
  - FIRE HYDRANT - ⊙
  - WATER METER - ⊙
  - WATER VALVE - ⊙
  - CLEAN OUT - ⊙
  - UTILITY POLE - ⊙
  - LIGHT POLE - ⊙
  - SEWER LINE - ————
  - OVERHEAD UTILITY LINE - ————
  - FENCE LINE - ————

THE HARLEY GROUP, LLC  
 3725/1355

RBH, INC.  
 1540/655

SLF, INC.  
 1380/770

ION AMERICA, LLC  
 3557/1799

THE HARLEY GROUP, LLC  
 3725/1355

1.207 ACRES

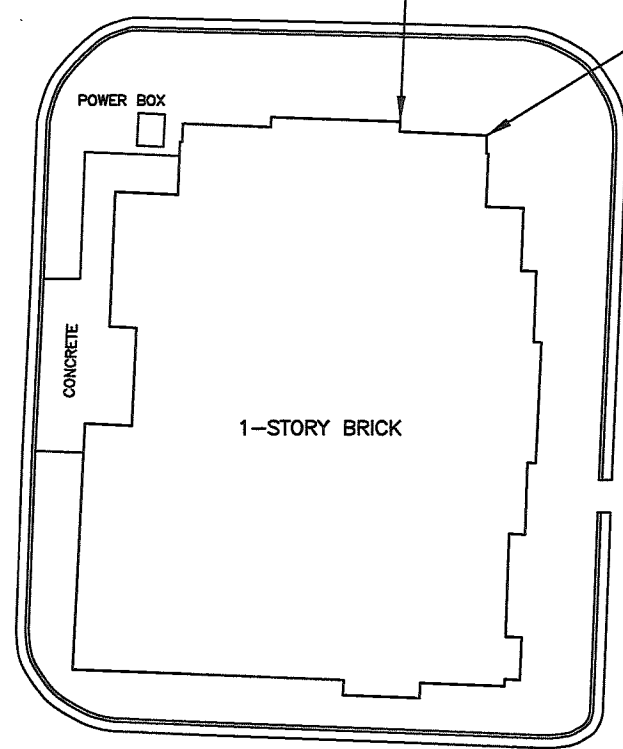

NGCS MONUMENT  
 SHERATON  
 N: 718,344.85  
 E: 1,328,496.02

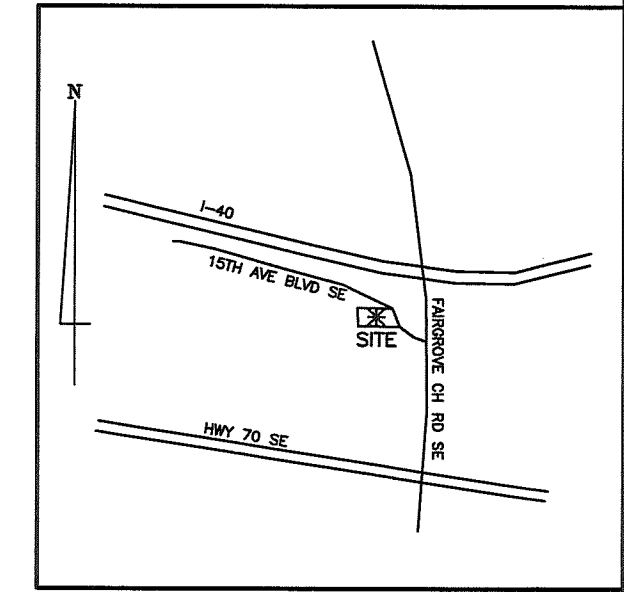

I, Derek R. Bunton, certify that this plot was drawn under my supervision from an actual survey made under my supervision (subject property surveyed from references shown hereon); that the boundaries not surveyed are clearly indicated as drawn; that the ratio of precision or positional accuracy as calculated is 1 : 20,000+; that this plot was prepared in accordance with "Standards of Practice for Land Surveying in North Carolina". Witness my original signature, license number and seal this 3rd day of June, 2025.

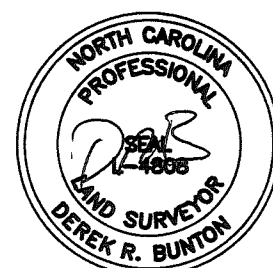

*Derek R. Bunton*  
 Professional Land Surveyor  
 PLS-4808  
 License Number

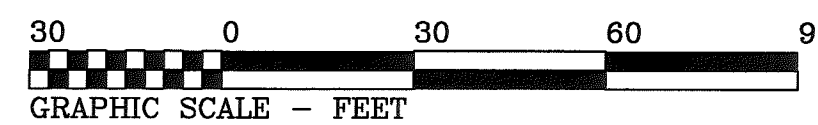

**SPECIAL NOTES**

- NOTE: ALL AREAS SHOWN HEREON WERE DETERMINED BY COORDINATE COMPUTATION.
- NOTE: PROPERTY IS SUBJECT TO ANY AND ALL EASEMENTS, RIGHTS-OF-WAY, COVENANTS, RESTRICTIONS, AND CONDITIONS OF RECORD AFFECTING SAID PREMISES.
- NOTE: THIS PLAT IS THE RESULT OF AN ACTUAL FIELD SURVEY MADE BY DEREK R. BUNTON, PLS-4808 AND REFLECTS GROUND EVIDENCE FOUND AT THE TIME OF SAID SURVEY.
- NOTE: THIS PLAT WAS PREPARED FOR THE EXCLUSIVE USE OF THE PARTY(S) NAMED HEREON. CERTIFICATES DO NOT EXTEND TO ANY UNNAMED PERSON(S) WITHOUT AN EXPRESS RECERTIFICATION BY THE SURVEYOR NAMING SAID PERSON(S).
- NOTE: SURVEYOR IS NOT RESPONSIBLE FOR ALTERATIONS MADE BY OTHERS TO ORIGINAL SURVEY PLAT.
- NOTE: SUBJECT PROPERTY IS NOT LOCATED IN A WATERSHED AREA OF CATAWBA COUNTY.
- NOTE: SUBJECT PROPERTY IS NOT LOCATED WITHIN A SPECIAL FLOOD HAZARD AREA OF CATAWBA COUNTY (SEE F.E.M.A. PANEL #3710372100J)