

PROPOSED
GA. HWY. 92

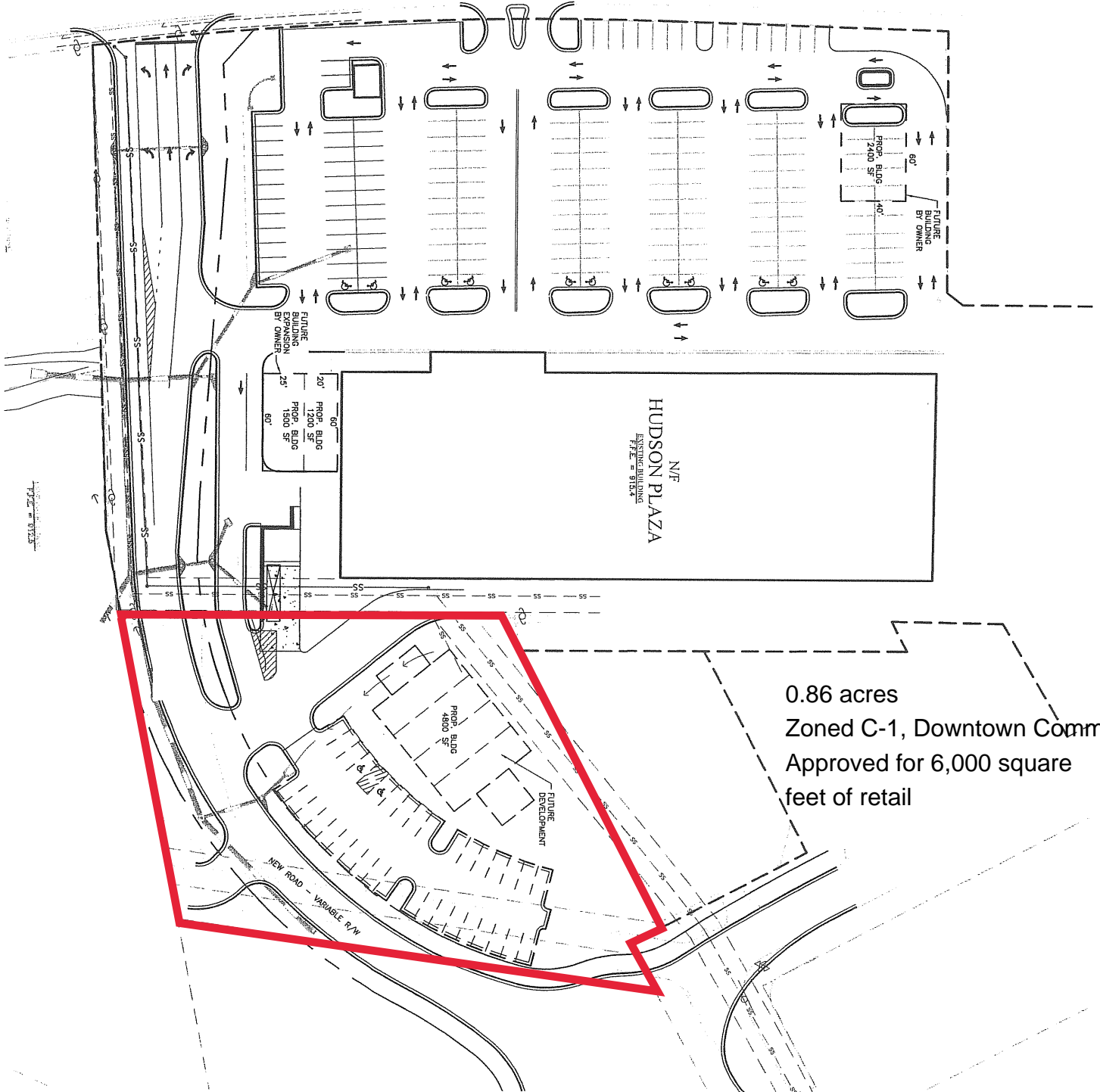

0.86 acres
 Zoned C-1, Downtown Commercial
 Approved for 6,000 square
 feet of retail

EXHIBIT
H

FUTURE
SITE IMPROVEMENTS

CONCEPTUAL STUDY
FOR
HUDSON PLAZA
 CITY OF FAYETTEVILLE

PROJECT LOCATED IN LAND LOTS XX OF THE XTH DISTRICT, FAYETTE COUNTY, GA

Date: 08.05.11 Drawn by: GAC Check by: LHD
 Project #: 09032.03 Design by: JLW Review by: LHD
 SCALE: 1" = 40'



**INTEGRATED
Science &
Engineering**

800 Commerce Drive, Suite 100, Peachtree City, Georgia 30269
(p) 770.461.4292 (f) 770.461.4801
Atlanta/Savannah