



FOR LEASE

# SIERRA COMMERCE PARK

1001 E GLENDALE AVE | BUILDING 9 | SPARKS, NV 89431

[cushmanwakefield.com](http://cushmanwakefield.com)

LBA Logistics  |  CUSHMAN & WAKEFIELD

FOR LEASE

# PROPERTY FEATURES

|                                  |   |
|----------------------------------|---|
| Lease Rate                       | Negotiable                                |
| NNN Rate                         | \$0.11/SF/month                           |
| Total Industrial Warehouse Space | ±21,584 SF                                |
| Total Office Space               | ±1,179 SF                                 |
| Dock-high Doors                  | 4 dock-high doors                         |
| Ceiling Height                   | 22' clear height                          |
| Column Spacing                   | 48' X 48'                                 |
| Sprinkler Rating                 | .33/3,000                                 |
| Management                       | Professionally managed<br>1.5M SF project |

## Area Overview

- Great location in Sparks
- Excellent access to Interstate 80 and the McCarran loop
- Localized labor force

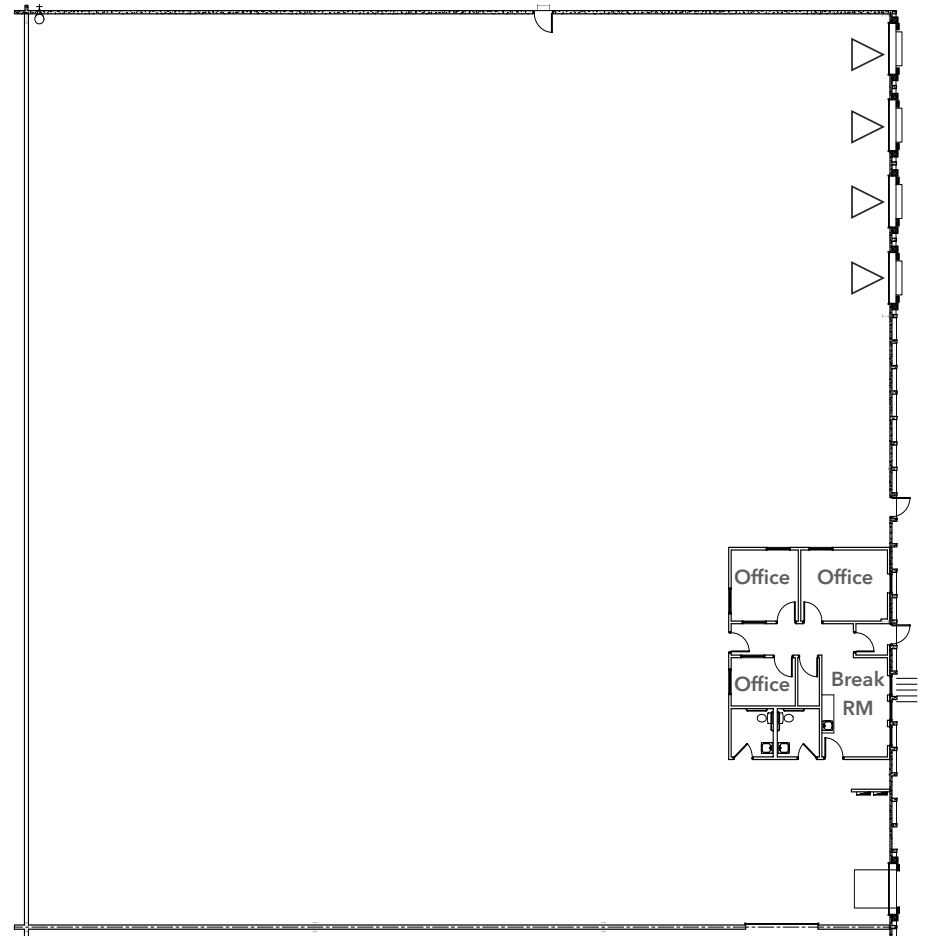

# SITE PLAN

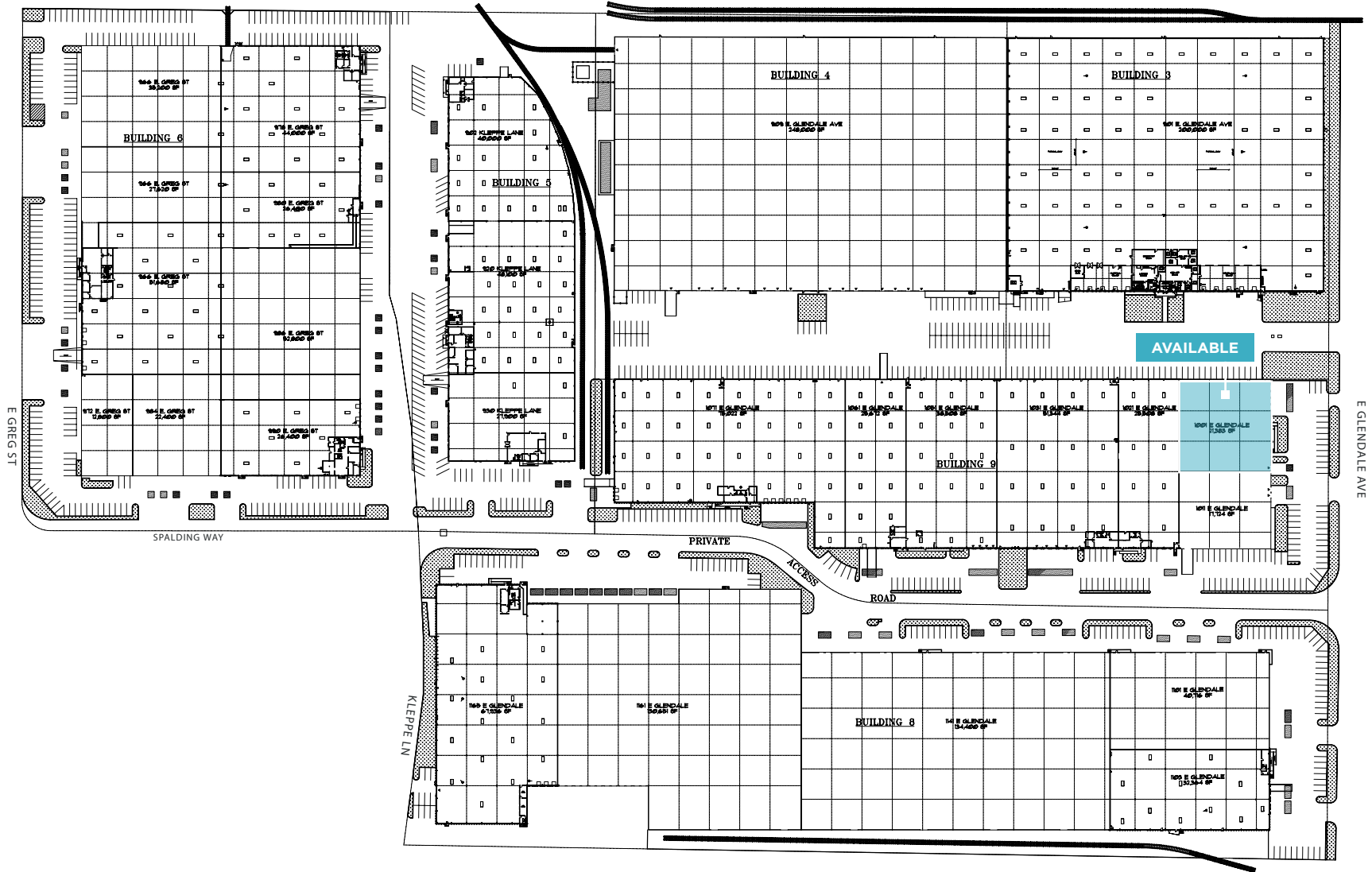

# AREA OVERVIEW

## TRANSPORTATION

| Ground                   | Miles |
|--------------------------|-------|
| Reno-Tahoe Int'l Airport | 4.6   |
| Reno-Stead FBO           | 14.6  |
| UPS Regional             | 2.7   |
| FEDEX Express            | 3.0   |
| FEDEX Ground             | 7.9   |
| FEDEX LTL                | 2.4   |

## DEMOGRAPHICS

| 2024            | 3 mi     | 5 mi     | 7 mi      |
|-----------------|----------|----------|-----------|
| Population      | 69,153   | 192,675  | 321,201   |
| Households      | 27,804   | 78,146   | 130,681   |
| Avg, HH Incomes | \$92,245 | \$85,913 | \$101,364 |
| Total Employees | 37,198   | 103,736  | 173,126   |



Source: NVEnergy  
Last updated: 2020

## NEVADA STATE INCENTIVES

- No state, corporate or personal income tax
- No estate tax, no inventory tax, no unitary tax, no franchise tax
- Right-to-work state
- Moderate real estate costs
- Low workers' compensation rates
- State-qualified employee hiring incentive

## HELPFUL LINKS

- **Business Costs**  
<https://www.edawn.org/site-selector/business-relocation-advantages/>
- **Business Incentives**  
<https://goed.nv.gov/programs-incentives/incentives/>
- **Cost of Living**  
[https://www.nvenergy.com/publish/content/dam/nvenergy/brochures\\_arch/about-nvenergy/economic-development/costoflivingred.pdf](https://www.nvenergy.com/publish/content/dam/nvenergy/brochures_arch/about-nvenergy/economic-development/costoflivingred.pdf)
- **Quality of Life**  
<http://edawn.org/live-play/>

## BUSINESS COST COMPARISONS

| Tax Comparisons                                       | NV         | CA           | AZ          | UT        | ID         | OR           | WA  |
|---|------------|--------------|-------------|-----------|------------|--------------|---|
| State Corporate Income Tax                            | No         | 8.84%        | 4.9%        | 4.85%     | 5.7%       | 6.6%-7.6%    | No, Business & Occupation Tax: 0.15%-0.484% |
| Personal Income Tax                                   | No         | 1%-13.3%     | 2.5%        | 4.55%     | 5.659%     | 4.75%-9.9%   | No  |
| Payroll Tax   | 1.17%      | 1.2% SDI Tax | No          | No        | No         | 1.1%-3.8237% | No  |
| Monthly Property Tax<br>(Based On \$25m Market Value) | \$26,688   | \$23,927     | \$31,981    | \$19,852  | \$18,905   | \$39,500     | \$23,356                                    |
| Unemployment Tax                                      | 0.25%-5.4% | 1.6%-6.2%    | 0.04%-9.72% | 0.2%-7.2% | 0.18%-5.4% | 0.9%-5.4%    | 0.24%-6.05%                                 |
| Capital Gains Tax                                     | No         | Up to 14.4%  | 2.5%        | 4.55%     | Up to 5.8% | Up to 9.9%   | Up to 7% above \$250,000                    |

FOR LEASE

# SIERRA COMMERCE PARK

1001 E GLENDALE AVE | BUILDING 9 | SPARKS, NV 89431

FOR MORE INFORMATION, PLEASE CONTACT:

**Mike Nevis, SIOR, CCIM**  
Vice Chairman  
+1 775 232 6119  
mike.nevis@cushwake.com  
Lic. # S.0061759

**Emily Jaenson**  
Associate  
+1 847 630 4739  
emily.jaenson@cushwake.com  
Lic. # S.0203962

**LBA**Logistics  |  **CUSHMAN &  
WAKEFIELD**

[cushmanwakefield.com](https://cushmanwakefield.com)

©2026 Cushman & Wakefield. All rights reserved. The information contained in this communication is strictly confidential. This information has been obtained from sources believed to be reliable but has not been verified. NO WARRANTY OR REPRESENTATION, EXPRESS OR IMPLIED, IS MADE AS TO THE CONDITION OF THE PROPERTY (OR PROPERTIES) REFERENCED HEREIN OR AS TO THE ACCURACY OR COMPLETENESS OF THE INFORMATION CONTAINED HEREIN, AND SAME IS SUBMITTED SUBJECT TO ERRORS, OMISSIONS, CHANGE OF PRICE, RENTAL OR OTHER CONDITIONS, WITHDRAWAL WITHOUT NOTICE, AND TO ANY SPECIAL LISTING CONDITIONS IMPOSED BY THE PROPERTY OWNER(S). ANY PROJECTIONS, OPINIONS OR ESTIMATES ARE SUBJECT TO UNCERTAINTY AND DO NOT SIGNIFY CURRENT OR FUTURE PROPERTY PERFORMANCE. COE-PM-West-02.3.2026