



## 5665 Flatiron Parkway

Suite 250, Boulder, CO

### Exceptional Office Space in Flatiron Park

#### Lynda Gibbons

lynda@gibbonswhite.com  
(303) 586-5920

#### Annie Lund

annie@gibbonswhite.com  
(303) 586-5922

#### Steve Sims

steve@gibbonswhite.com  
(303) 586-5932

www.gibbonswhite.com

[Property Info & Gallery](#)

[View Map](#)

Available Space	3,800 - 10,500 sq. ft.
Lease Rate / sq. ft.	\$23.00 NNN
Expenses / sq. ft.	\$10.85*

*\*Plus Utilities & Janitorial*

- Divisible to 3,800, 4,500, 5,500, or 6,200 sq. ft.
- Outdoor Gathering Spaces & Furnishings Provide a Great Place for Mid-Day Breaks, Lunches or Meetings
- Beautiful Skylights Above the Reception Area Bringing in Lots of Natural Light
- Private Restrooms & Shower Room Inside the Suite
- Co-Tenants in the Building Include Garmin International & Magic Leap
- Flatiron Park is Home to Some of Boulder's Best Creative, Tech & Life Sciences Companies & Will Soon See the Arrival of Apple as They Move Into Their New 115,000 sq. ft. Office
- Close to Breweries & Restaurants Such as Ozo Coffee, Upslope Brewing, Wild Provisions Beer Project, Baby Goat Coffee, Blackbelly Restaurant, Snarf's Sandwiches & Pica's Taqueri

© 2026 Gibbons-White, Inc.

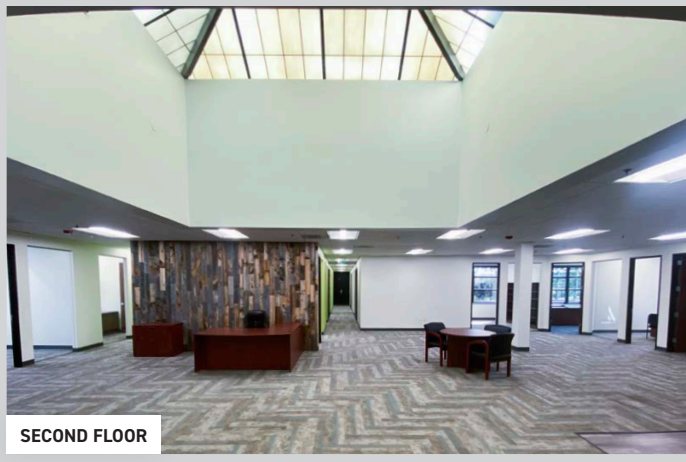

SECOND FLOOR



LOBBY



PATIO

VIDEO



TOUR

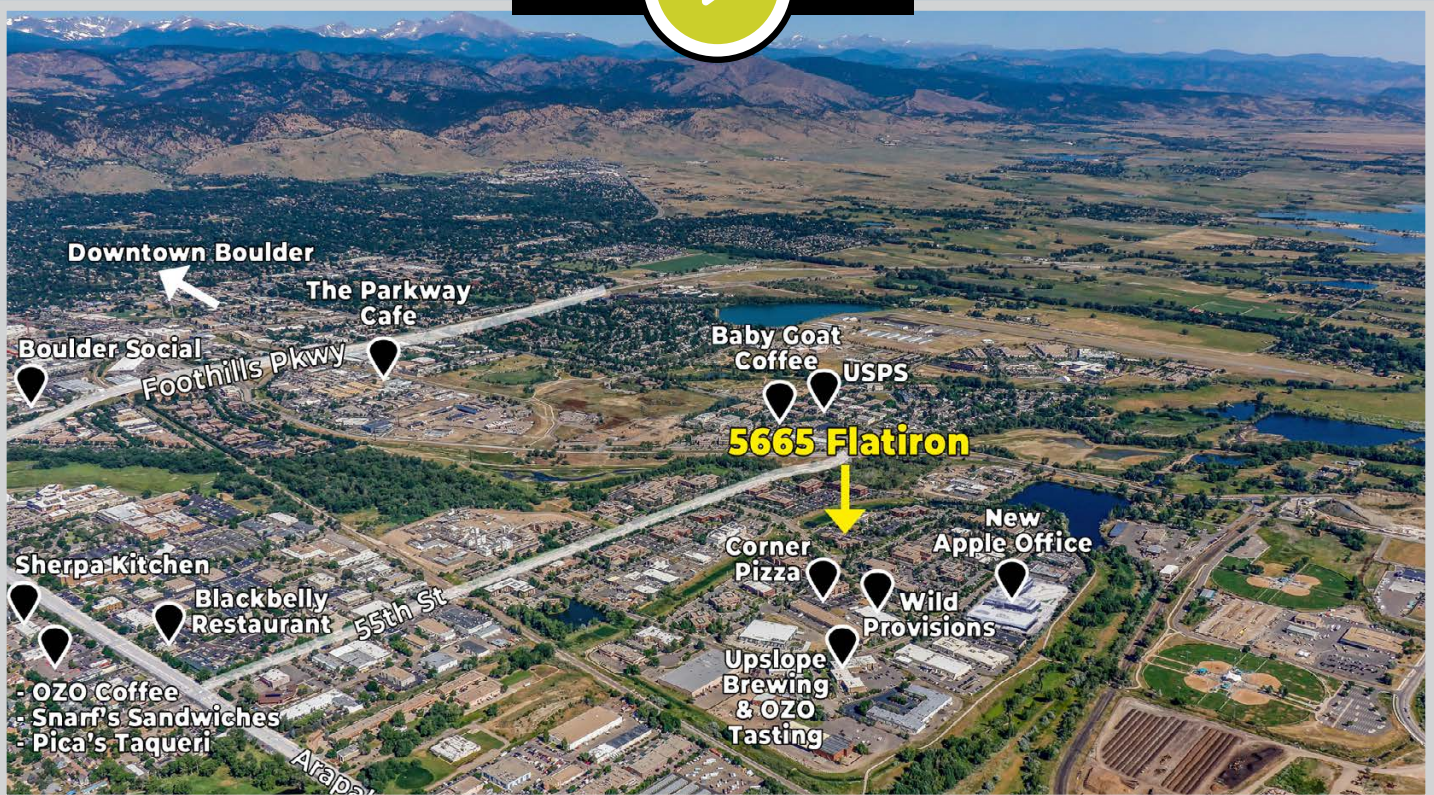

Second Floor



VIDEO



TOUR

Suite 250  
Demising Options

