

Hardee County Property Appraiser

Homestead Exemption

[Apply for Homestead Exemption](#)

Parcel Summary

AlternateID 5839
Parcel ID 33-33-25-0000-08730-0000
Location 1340 N US HWY 17
Address WAUCHULA 33873
Brief Legal Description 4.09 AC BEG AT THE NE COR OF NW1/4 OF THE SE1/4 & RUN S 747 LKS THEN W 457 LKS TO R/W OF ACL RR THEN N 14° 30' W 761 LKS THEN RUN E 616 LKS TO POB 33 33S 25E 306P605 404P511(SP EXC) 487P69 489P229 528P44 (CA-96-123) 532P197 567P151 658P725 682P682 201525006155 201825002844 201925006453-LD/6486-LP/6601-LD/6682-PRECO-EASE 202025000905-LP/0910-LP/0969-LD /1009-LD/1011-LD/1012-LD/1803-LP(DESC NOT PROVIDED)/1823(DESC NOT PROVIDED)/8730-LD 202025004299-LD 202425003875-LD/3883-LD /3887-LD/3911-LD/3912-LD/5868-ORDER /5869-ORDER 202525004703-AFF
(Note: Not to be used on legal documents.)
Property Use Code LIGHT MANUFACTURE (4100)
Sec/Twp/Rng 33-33-25
Tax District UNINC CO (900)
Millage Rate 13.3551
Acreage 4.091
Homestead N

[View Map](#)

Owner Information

Primary Owner
[HARDEE FRESH LLC](#)
P O BOX 9
WAUCHULA, FL 33873

Map



Certified Values

	2025 Final Values
Building Value	\$668,316
Extra Features Value	\$37,750
Land Value	\$267,315
Land Agricultural Value	\$0
Agricultural (Market) Value	\$0
Just (Market) Value	\$973,381
Assessed Value	\$973,381
Exempt Value	\$0
Taxable Value	\$973,381
Maximum Save Our Homes Portability/Non-Homestead Cap	\$0

Historical Values

	2024 Certified Values	2023 Certified Values
Building Value	\$656,336	\$590,828
Extra Features Value	\$37,750	\$35,437
Land Value	\$267,315	\$267,315
Land Agricultural Value	\$0	\$0
Agricultural (Market) Value	\$0	\$0
Just (Market) Value	\$961,401	\$893,580
Assessed Value	\$961,401	\$893,580
Exempt Value	\$0	\$0
Taxable Value	\$961,401	\$893,580
Maximum Save Our Homes Portability/Non-Homestead Cap	\$0	\$0

Land Information

Land Use	Number of Units	Unit Type	Frontage	Depth
4100 - INDUSTRIAL	178210	SF	502	355

Zoning

Building Information

Type	MFG LT-WEL	Heat	NONE
Total Area	34,920	Air Conditioning	
Heated Area	29,444	Bathrooms	0
Exterior Walls	CORG METAL	Bedrooms	0
Roof Cover	TIN/METAL	Stories	1
Interior Walls		Actual Year Built	1966
Frame Type	STEEL	Effective Year Built	1990
Floor Cover	CONC FINSH		

Type	WAREH STOR	Heat	NONE
Total Area	1,344	Air Conditioning	
Heated Area	1,344	Bathrooms	0
Exterior Walls	CORG METAL	Bedrooms	0
Roof Cover	TIN/METAL	Stories	1
Interior Walls	MINIMUM	Actual Year Built	1985
Frame Type	STEEL	Effective Year Built	1985
Floor Cover	CONC FINSH		

Extra Features

Code	Description	Length x Width x Height	Units	Unit Type
CAN 02	CANOPY	30 x 36 x 0	1,080	SF
PAV 03	PAVING	0 x 0 x 0	19,000	SF
CLF 03	6' CHAIN LINK	0 x 0 x 6	1,540	LF
MSC 01	MISC XFOB	148 x 40 x 0	5,920	UT
C/S 03	CONC SLB	20 x 8 x 0	160	SF
C/S 03	CONC SLB	20 x 20 x 0	400	SF
LDK 03	LOAD DOCK	90 x 8 x 0	720	SF

Sales

Multi Parcel	Sale Date	Sale Price	Instrument	Book/Page	Instrument Number	Qualification	Reason	Vacant/Improved	Grantor	Grantee
Y	5/7/2018	\$1,250,000	WD	0000/0000	201825002844	Unqualified	UNQUAL/FEDERAL/STATE/LOCAL GOV	Improved	HARDEE COUNTY INDUSTRIAL DEVELOPMENT AUTHORIT	HARDEE FRESH LLC
Y	10/15/2015	\$750,000	WD	0000/0000	201525006155	Qualified	QUAL/MULT-PROP W/MULT-TAXIDS	Improved	SMM WAUCHULA LLC	HARDEE COUNTY INDUSTRIAL DEVELOPMENT AUTHORIT
N	5/13/2005	\$700,000	WD	0682/0682		Qualified	QUAL/CREDIBLE,VERIF/DOC/EVIDEN	Improved	LEA FAMILY PARTNERSHIP LTD	SMM WAUCHULA LLC
N	2/5/2004	\$38,500	QC	0658/0725		Qualified	QUAL/DEED EXAMINATION	Improved	NOLAN JOSEPH J TTEE M/BASS IRREVOCABLE TRUST	LEA FAMILY PARTNERSHIP LTD
N	3/31/1999	\$300,000	WD	0567/0151		Qualified	QUAL/DEED EXAMINATION	Improved	FIRST NATIONAL BANK OF WAUCHULA	NOLAN JOSEPH J TRUSTEE

Multi Parcel	Sale Date	Sale Price	Instrument	Book/Page	Instrument Number	Qualification	Reason	Vacant/Improved	Grantor	Grantee
N	7/14/1997	\$100	CT	0532/0197		Unqualified	UNQUAL/CORRECTIVE/QCD,TD	Improved	B HUGH BRADLEY CLERK OF COURT	FIRST NATIONAL BANK OF WAUCHULA
N	6/1/1995	\$0	01	0489/0229		Unqualified	N/A	Improved		GROWERS CONNECTION INC
N	5/1/1995	\$296,000	17	0487/0069		Unqualified	N/A	Improved		
N	3/1/1985	\$250,000	00	0306/0605		Qualified	N/A	Improved		
N	4/20/1972	\$14,000	WD	0125/0240	132404	Qualified	N/A	Improved	ASSOCIATED PACKING COMPANY INC	PARKER FARMS INC
N	7/25/1969	\$0	WD	0090/0018	122536	Qualified	QUAL/DEED EXAMINATION	Vacant	NEELEY LEWIS GEORGE	ASSOCIATED PACKING COMPANY INC

Permits

Permit Number	Type	Description	Issued	Amount
2600273	CD	COMMERCIAL DEMO	3/13/2026	\$500
2202184	CR	COMMERCIAL ROOFING	10/13/2022	\$23,440
1900673	AEE	AGRICULTURAL EXEMPT ELEC	6/11/2019	\$2,500
1900900	AEE	AGRICULTURAL EXEMPT ELEC	8/8/2019	\$200,000
1701152	CE	COMMERCIAL ELECTRICAL	10/17/2017	\$10,500
1700445	CD	COMMERCIAL DEMO		\$30,000
1600726	CD	COMMERCIAL DEMO		\$30,000
1600674	CAL	COMMERCIAL ALTERATION	10/21/2016	\$361,303
0400029	0022	X FEATURE	1/12/2004	\$11,400
0300340	0028	CERT OCC	4/28/2003	\$0
0300340	0006	COMMERCIAL	4/10/2003	\$30,000
10792	0006	COMMERCIAL	2/1/1990	\$24,000
7634	0006	COMMERCIAL	8/1/1985	\$8,000
7534	0006	COMMERCIAL	6/1/1985	\$30,000

Sketches

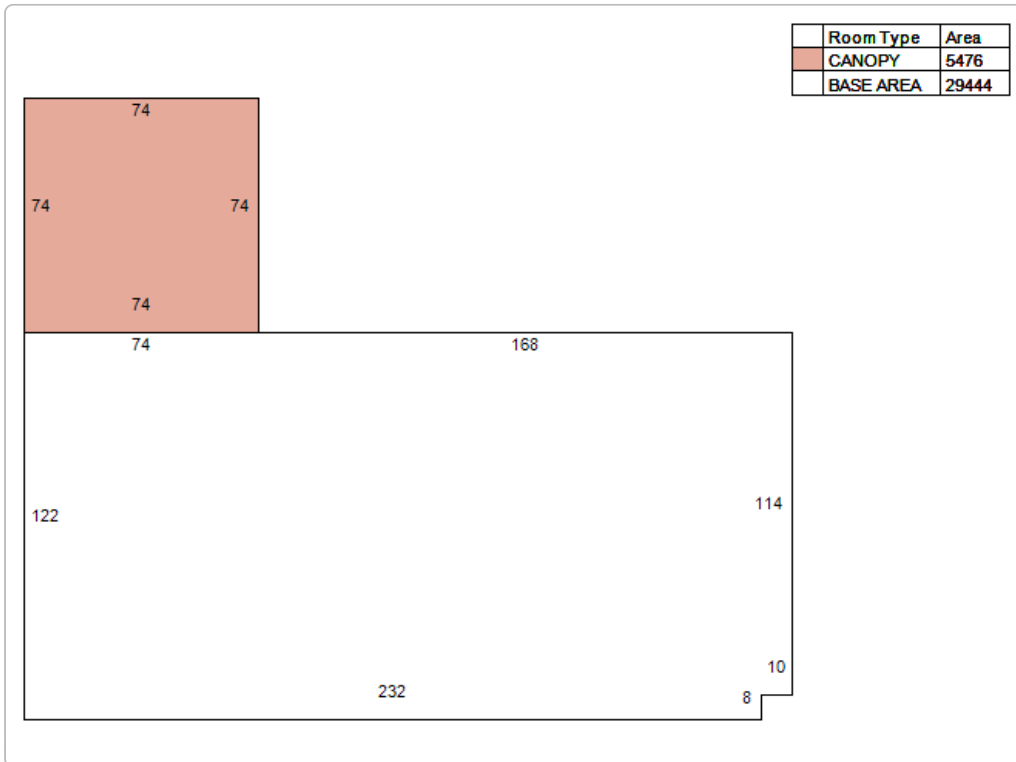

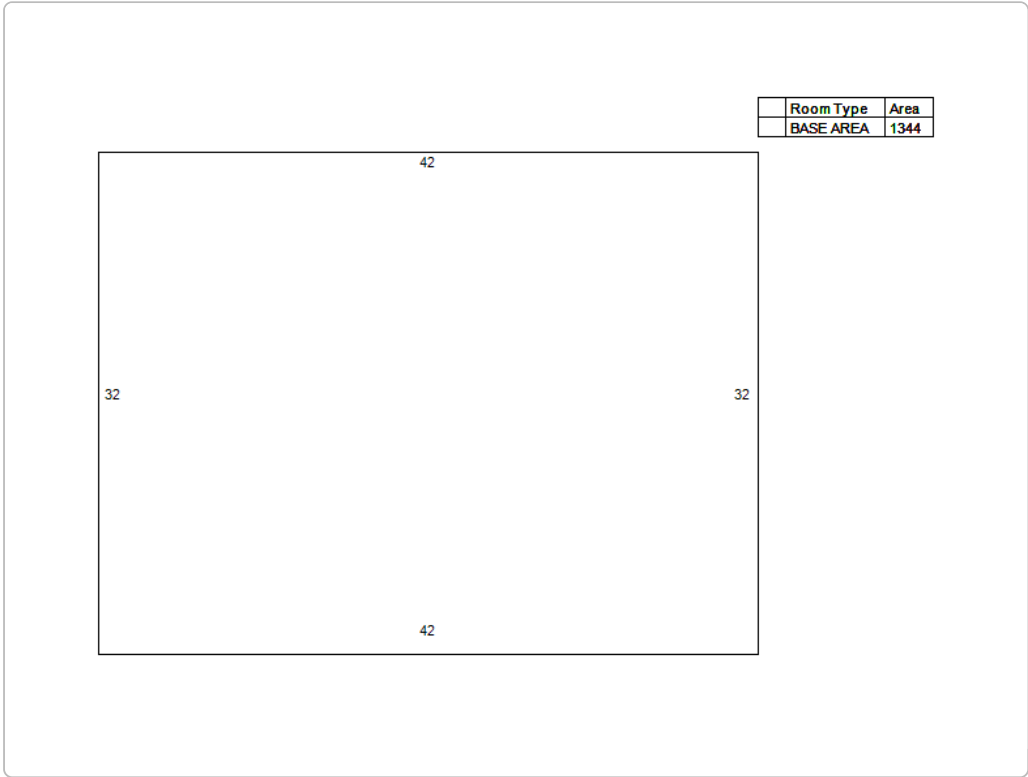

Sales Questionnaire Form

Would you like to submit a Sales Questionnaire?

No data available for the following modules: Online Ag Classification Filing.

The Hardee County Property Appraiser's Office makes every effort to produce the most accurate information possible. No warranties, expressed or implied, are provided for the data herein, its use or interpretation. Just (Market) Value is established by the Property Appraiser for ad valorem tax purposes. Working values are subject to change.
 | [User Privacy Policy](#) | [GDPR Privacy Notice](#)
 Last Data Upload: 4/24/2026, 3:34:01 AM

Contact Us

