

30 Light Street



Stats

Availability: Immediate, 2,916 RSF of retail space on ground floor

Building Type: 11-story, 520 space parking garage with ground floor retail



Location

Located in Baltimore's Central Business District with great visibility facing Lombard between Charles and Light Streets



Market Facts

Located in the heart of the Central Business District, containing 29M SF of office space

Shared ownership with the adjacent "Transamerica Tower," which has approximately 1,800 office workers

\$446,998,756 in annual expenditures from daytime employees located within 1 mile

Daytime population: 52,000 within ½ mile

Households: 4,740 within ½ mile // 17,900 within 1 mile

8,009 hotel rooms within a ten minute walk

AAWDT: 37,212 vehicles at Light and Lombard Streets

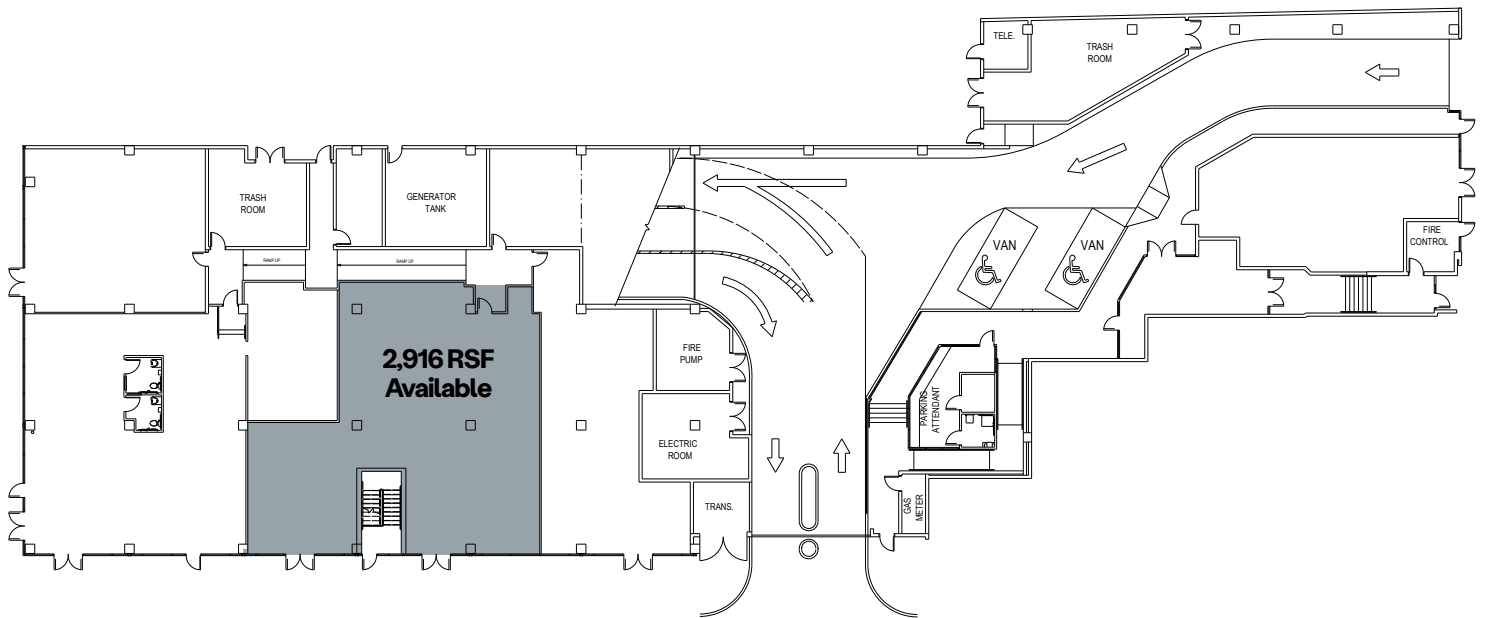
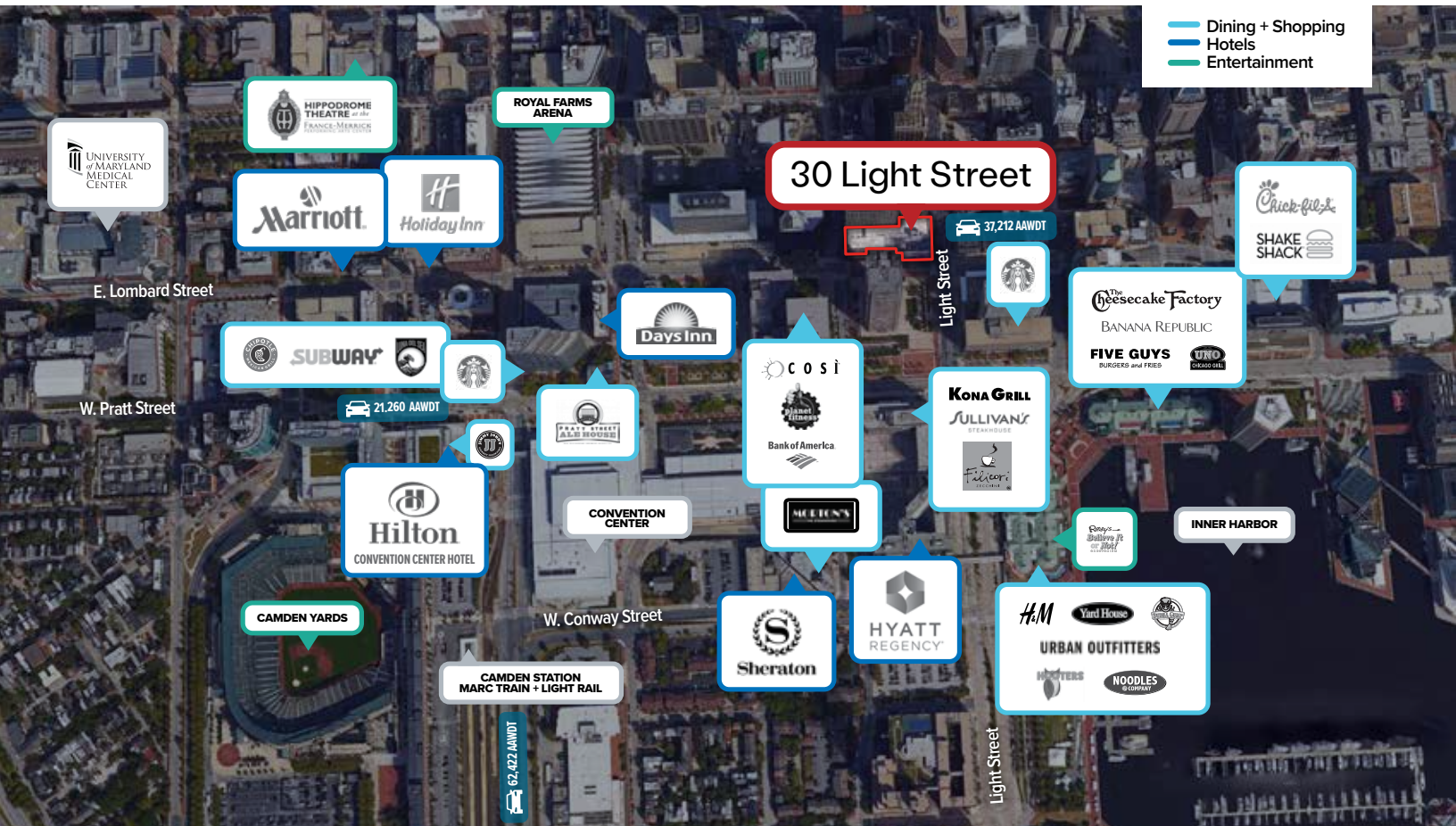

John Hermann
443.285.5711
john.hermann@copt.com

Krysta Herring
443.285.5709
krysta.herring@copt.com

Corporate Headquarters
6711 Columbia Gateway Drive, Suite 300
Columbia, MD 21046
443.285.5400 | copt.com | NYSE: CDP