

Plaza del Sol

31620 Auto Center Drive, Lake Elsinore, CA 92530

Ready for Occupancy Immediately!

Unit B-1 Improvements:

Open area, private office, fully air conditioned storefront with dropped ceiling, private restroom, and storage closet

Project Features:

3.00:1,000 Parking Ratio

Surveillance Cameras

Signage Opportunity

High Visibility Location

Easy Access to I-215 via Diamond Drive

Lease Rate:

\$1.80/SF, MG per month

+/-760 Square Foot Office/Retail Suite



**More Information: Christopher J. Masino, SIOR
(951) 795-4556 | cmasino@masinoindustrial.com
DRE License: 01352110**



Plaza del Sol

31620 Auto Center Drive, Lake Elsinore, CA 92530

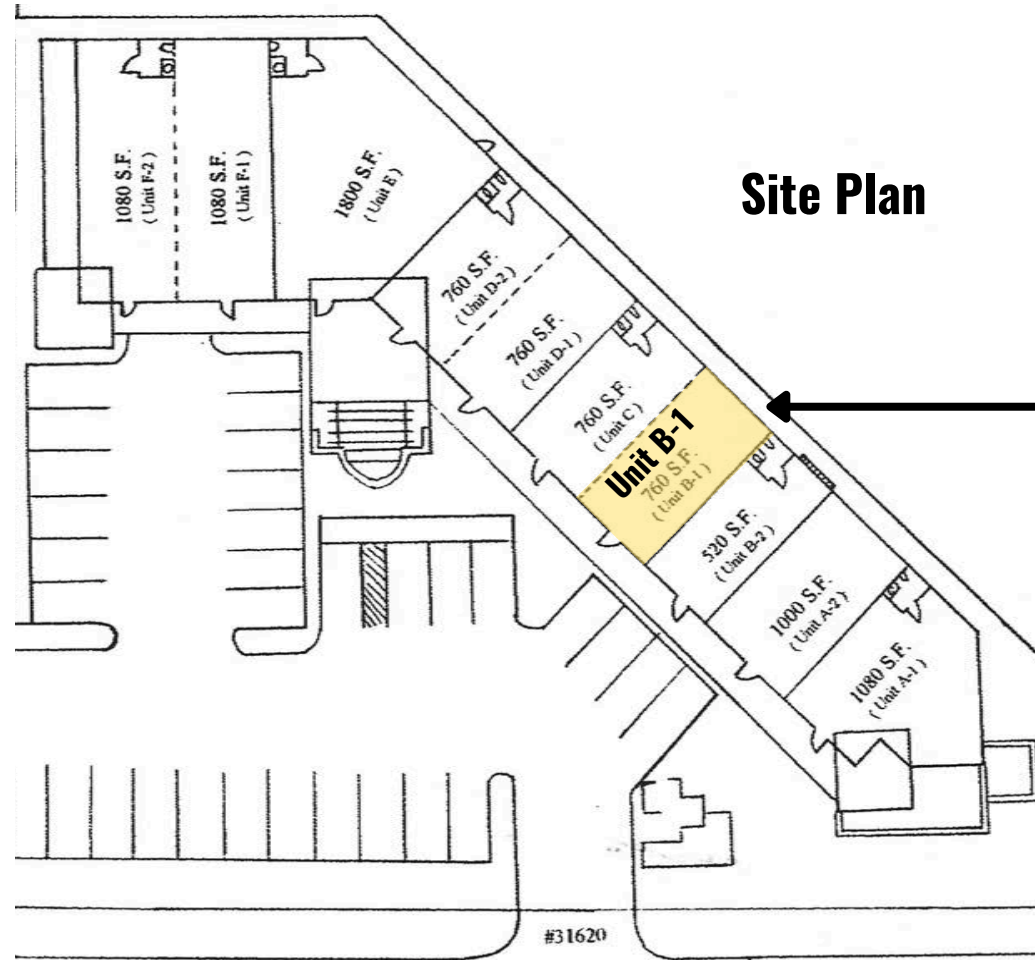

Site Plan

Unit B-1:
+/-760 SF

More Information: Christopher J. Masino, SIOR
(951) 795-4556 | cmasino@masinoindustrial.com
DRE License: 01352110



Plaza del Sol

31620 Auto Center Drive, Lake Elsinore, CA 92530

Selected Images



More Information: Christopher J. Masino, SIOR
(951) 795-4556 | cmasino@masinoindustrial.com
DRE License: 01352110



Plaza del Sol

31620 Auto Center Drive, Lake Elsinore, CA 92530

Suite	Square Feet	Suite Features	*Lease Rate/Mo.
B-1	760	Open Space, Private Office, Restroom, Storage Closet	\$1,368
*Modified Gross			
Updated:	6/2/2026		



More Information: Christopher J. Masino, SIOR
(951) 795-4556 | cmasino@masinoindustrial.com
DRE License: 01352110



Plaza del Sol

31620 Auto Center Drive, Lake Elsinore, CA 92530

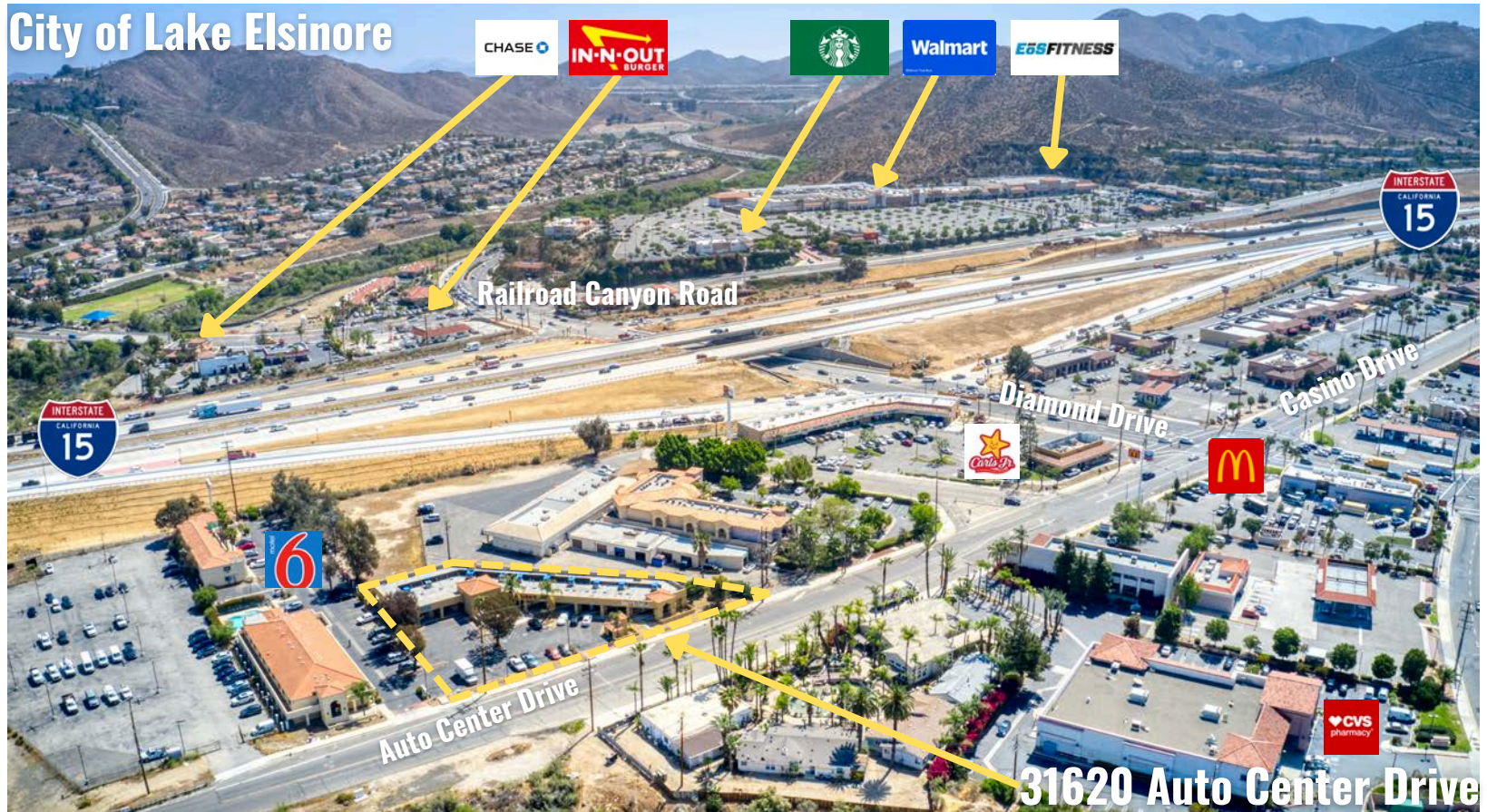

More Information: Christopher J. Masino, SIOR
(951) 795-4556 | cmasino@masinoindustrial.com
DRE License: 01352110

