

| AREA | FINISHES | TILE/FLOOR |
|---------|-------------------|-----------------|
| CLUB | External Terrazzo | Hard Tile |
| HALL | Mosaic & Marble | Decorative Tile |
| WALL | Plaster & Marble | |
| CEILING | Acoustic (S.A.C.) | |
| ROOFING | 1/2" Marble | |

#3 TON HEAT & AIR UNIT
TO SUPPLY FUEL, VENTILATE
& GIBBY SIZES

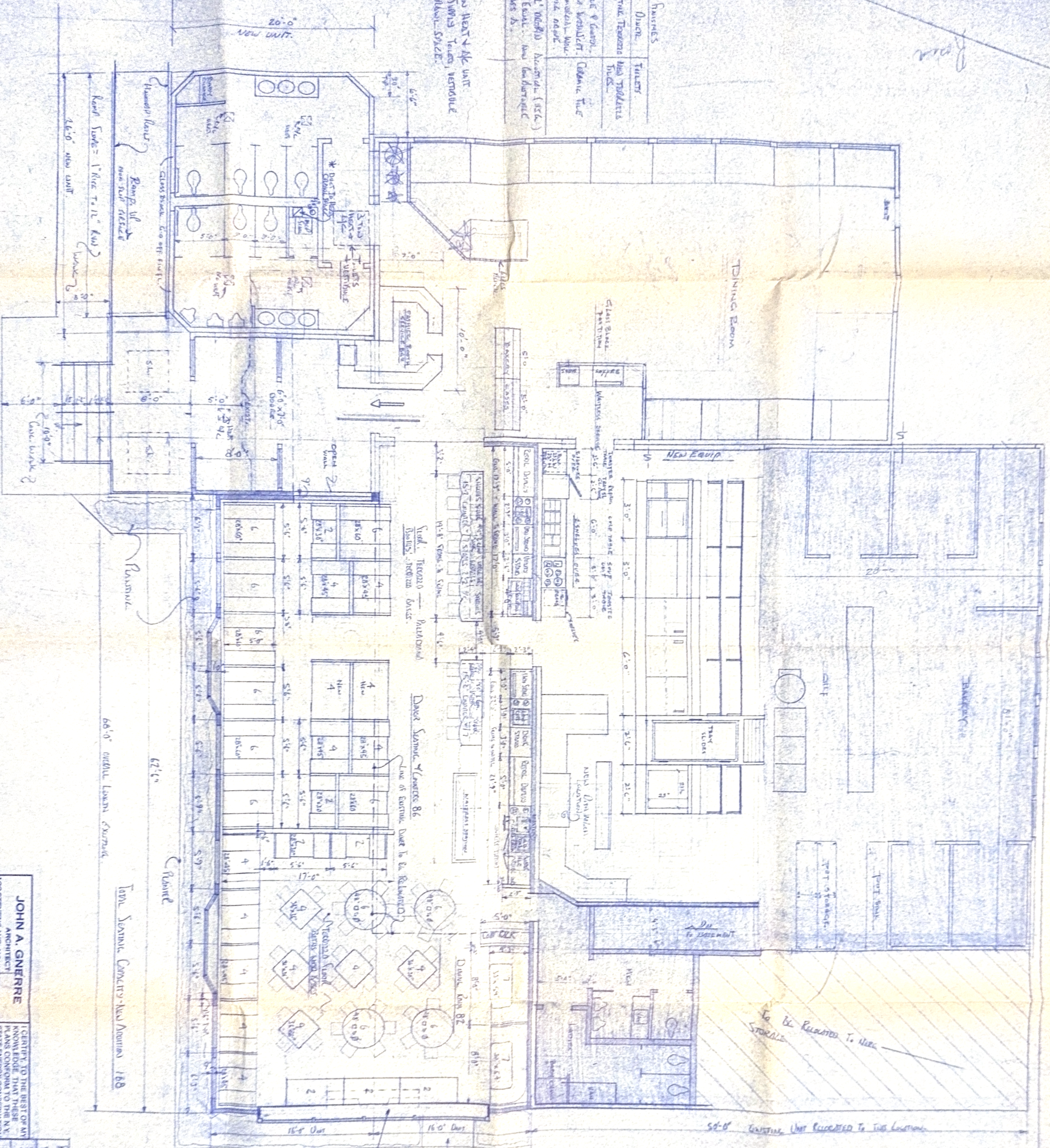

JOHN A. GNERRE
ARCHITECT
100 STEVENS AVE. MOUNT VERNON NY
STATE ENERGY CONSERVATION
CONSTRUCTION CODE



KNOWLEDGE THAT THESE
PLANS CONFORM TO THE N.Y.
STATE ENERGY CONSERVATION
CONSTRUCTION CODE

JOHN A. GNERRE
ARCHITECT
100 STEVENS AVE. MOUNT VERNON NY
STATE ENERGY CONSERVATION
CONSTRUCTION CODE

To Be Relocated To Here
STORAGE

50'-0" EXISTING UNIT RELOCATED TO THIS LOCATION