

LOT 1 LEGAL DESCRIPTION

A PORTION OF THE NORTHEAST QUARTER OF SECTION 31, TOWNSHIP 7 NORTH, RANGE 3 EAST OF THE GILA AND SALT RIVER BASE AND MERIDIAN, MARICOPA COUNTY, ARIZONA, MORE PARTICULARLY DESCRIBED AS FOLLOWS:

COMMENCING AT THE NORTHEAST CORNER OF SAID SECTION 31, BEING A FOUND GLO BRASS CAP FROM WHICH THE NORTH QUARTER CORNER OF SAID SECTION 31, BEING A FOUND GLO BRASS CAP BEARS NORTH 89 DEGREES 49 MINUTES 16 SECONDS WEST, A DISTANCE OF 2,640.95 FEET;

THENCE ALONG THE NORTH LINE OF SAID SECTION 31, NORTH 89 DEGREES 49 MINUTES 16 SECONDS WEST, A DISTANCE OF 400.00 FEET TO THE POINT OF BEGINNING OF THE PARCEL HEREIN DESCRIBED;

THENCE LEAVING THE NORTH LINE OF SAID SECTION 31, SOUTH 00 DEGREES 04 MINUTES 10 SECONDS WEST, A DISTANCE OF 220.00 FEET;

THENCE SOUTH 49 DEGREES 58 MINUTES 06 SECONDS WEST, A DISTANCE OF 339.91 FEET;

THENCE NORTH 00 DEGREES 04 MINUTES 10 SECONDS EAST, A DISTANCE OF 439.44 FEET TO A POINT ON THE NORTH LINE OF SAID SECTION 31;

THENCE ALONG THE NORTH LINE OF SAID SECTION 31, SOUTH 89 DEGREES 49 MINUTES 16 SECONDS EAST, A DISTANCE OF 260.00 FEET, TO THE POINT OF BEGINNING OF THE PARCEL HEREIN DESCRIBED;

SAID PARCEL CONTAINS 85,728 SQ. FT OR 1.968 ACRES, MORE OR LESS.



LOT 2 LEGAL DESCRIPTION

A PORTION OF THE NORTHEAST QUARTER OF SECTION 31, TOWNSHIP 7 NORTH, RANGE 3 EAST OF THE GILA AND SALT RIVER BASE AND MERIDIAN, MARICOPA COUNTY, ARIZONA, MORE PARTICULARLY DESCRIBED AS FOLLOWS:

COMMENCING AT THE NORTHEAST CORNER OF SAID SECTION 31, BEING A FOUND GLO BRASS CAP FROM WHICH THE NORTH QUARTER CORNER OF SAID SECTION 31, BEING A FOUND GLO BRASS CAP BEARS NORTH 89 DEGREES 49 MINUTES 16 SECONDS WEST, A DISTANCE OF 2,640.95 FEET;

THENCE ALONG THE NORTH LINE OF SAID SECTION 31, NORTH 89 DEGREES 49 MINUTES 16 SECONDS WEST, A DISTANCE OF 400.00 FEET;

THENCE LEAVING THE NORTH LINE OF SAID SECTION 31, SOUTH 00 DEGREES 04 MINUTES 10 SECONDS WEST, A DISTANCE OF 220.00 FEET TO THE POINT OF BEGINNING OF THE PARCEL HEREIN DESCRIBED;

THENCE SOUTH 89 DEGREES 49 MINUTES 16 SECONDS EAST, A DISTANCE OF 200.00 FEET;

THENCE SOUTH 00 DEGREES 04 MINUTES 10 SECONDS WEST, A DISTANCE OF 219.34 FEET;

THENCE NORTH 89 DEGREES 50 MINUTES 03 SECONDS WEST, A DISTANCE OF 460.00 FEET;

THENCE NORTH 49 DEGREES 58 MINUTES 06 SECONDS EAST, A DISTANCE OF 339.91 FEET, TO THE POINT OF BEGINNING OF THE PARCEL HEREIN DESCRIBED;

SAID PARCEL CONTAINS 72,393 SQ. FT OR 1.662 ACRES, MORE OR LESS.



LOT 1 LEGAL DESCRIPTION

A PORTION OF THE NORTHEAST QUARTER OF SECTION 31, TOWNSHIP 7 NORTH, RANGE 3 EAST OF THE GILA AND SALT RIVER BASE AND MERIDIAN, MARICOPA COUNTY, ARIZONA, MORE PARTICULARLY DESCRIBED AS FOLLOWS:

COMMENCING AT THE NORTHEAST CORNER OF SAID SECTION 31, BEING A FOUND GLO BRASS CAP FROM WHICH THE NORTH QUARTER CORNER OF SAID SECTION 31, BEING A FOUND GLO BRASS CAP BEARS NORTH 89 DEGREES 49 MINUTES 16 SECONDS WEST, A DISTANCE OF 2,640.95 FEET;

THENCE ALONG THE NORTH LINE OF SAID SECTION 31, NORTH 89 DEGREES 49 MINUTES 16 SECONDS WEST, A DISTANCE OF 400.00 FEET TO THE POINT OF BEGINNING OF THE PARCEL HEREIN DESCRIBED;

THENCE LEAVING THE NORTH LINE OF SAID SECTION 31, SOUTH 00 DEGREES 04 MINUTES 10 SECONDS WEST, A DISTANCE OF 220.00 FEET;

THENCE SOUTH 49 DEGREES 58 MINUTES 06 SECONDS WEST, A DISTANCE OF 339.91 FEET;

THENCE NORTH 00 DEGREES 04 MINUTES 10 SECONDS EAST, A DISTANCE OF 439.44 FEET TO A POINT ON THE NORTH LINE OF SAID SECTION 31;

THENCE ALONG THE NORTH LINE OF SAID SECTION 31, SOUTH 89 DEGREES 49 MINUTES 16 SECONDS EAST, A DISTANCE OF 260.00 FEET, TO THE POINT OF BEGINNING OF THE PARCEL HEREIN DESCRIBED;

SAID PARCEL CONTAINS 85,728 SQ. FT OR 1.968 ACRES, MORE OR LESS.

LOT 2 LEGAL DESCRIPTION

A PORTION OF THE NORTHEAST QUARTER OF SECTION 31, TOWNSHIP 7 NORTH, RANGE 3 EAST OF THE GILA AND SALT RIVER BASE AND MERIDIAN, MARICOPA COUNTY, ARIZONA, MORE PARTICULARLY DESCRIBED AS FOLLOWS:

COMMENCING AT THE NORTHEAST CORNER OF SAID SECTION 31, BEING A FOUND GLO BRASS CAP FROM WHICH THE NORTH QUARTER CORNER OF SAID SECTION 31, BEING A FOUND GLO BRASS CAP BEARS NORTH 89 DEGREES 49 MINUTES 16 SECONDS WEST, A DISTANCE OF 2,640.95 FEET;

THENCE ALONG THE NORTH LINE OF SAID SECTION 31, NORTH 89 DEGREES 49 MINUTES 16 SECONDS WEST, A DISTANCE OF 400.00 FEET;

THENCE LEAVING THE NORTH LINE OF SAID SECTION 31, SOUTH 00 DEGREES 04 MINUTES 10 SECONDS WEST, A DISTANCE OF 220.00 FEET TO THE POINT OF BEGINNING OF THE PARCEL HEREIN DESCRIBED;

THENCE SOUTH 89 DEGREES 49 MINUTES 16 SECONDS EAST, A DISTANCE OF 200.00 FEET;

THENCE SOUTH 00 DEGREES 04 MINUTES 10 SECONDS WEST, A DISTANCE OF 219.34 FEET;

THENCE NORTH 89 DEGREES 50 MINUTES 03 SECONDS WEST, A DISTANCE OF 460.00 FEET;

THENCE NORTH 49 DEGREES 58 MINUTES 06 SECONDS EAST, A DISTANCE OF 339.91 FEET, TO THE POINT OF BEGINNING OF THE PARCEL HEREIN DESCRIBED;

SAID PARCEL CONTAINS 72,393 SQ. FT OR 1.662 ACRES, MORE OR LESS.

LOT 1 LEGAL DESCRIPTION

A PORTION OF THE NORTHEAST QUARTER OF SECTION 31, TOWNSHIP 7 NORTH, RANGE 3 EAST OF THE GILA AND SALT RIVER BASE AND MERIDIAN, MARICOPA COUNTY, ARIZONA, MORE PARTICULARLY DESCRIBED AS FOLLOWS:

COMMENCING AT THE NORTHEAST CORNER OF SAID SECTION 31, BEING A FOUND GLO BRASS CAP FROM WHICH THE NORTH QUARTER CORNER OF SAID SECTION 31, BEING A FOUND GLO BRASS CAP BEARS NORTH 89 DEGREES 49 MINUTES 16 SECONDS WEST, A DISTANCE OF 2,640.95 FEET;

THENCE ALONG THE NORTH LINE OF SAID SECTION 31, NORTH 89 DEGREES 49 MINUTES 16 SECONDS WEST, A DISTANCE OF 400.00 FEET TO THE POINT OF BEGINNING OF THE PARCEL HEREIN DESCRIBED;

THENCE LEAVING THE NORTH LINE OF SAID SECTION 31, SOUTH 00 DEGREES 04 MINUTES 10 SECONDS WEST, A DISTANCE OF 220.00 FEET;

THENCE SOUTH 49 DEGREES 58 MINUTES 06 SECONDS WEST, A DISTANCE OF 339.91 FEET;

THENCE NORTH 00 DEGREES 04 MINUTES 10 SECONDS EAST, A DISTANCE OF 439.44 FEET TO A POINT ON THE NORTH LINE OF SAID SECTION 31;

THENCE ALONG THE NORTH LINE OF SAID SECTION 31, SOUTH 89 DEGREES 49 MINUTES 16 SECONDS EAST, A DISTANCE OF 260.00 FEET, TO THE POINT OF BEGINNING OF THE PARCEL HEREIN DESCRIBED;

SAID PARCEL CONTAINS 85,728 SQ. FT OR 1.968 ACRES, MORE OR LESS.



LOT 2 LEGAL DESCRIPTION

A PORTION OF THE NORTHEAST QUARTER OF SECTION 31, TOWNSHIP 7 NORTH, RANGE 3 EAST OF THE GILA AND SALT RIVER BASE AND MERIDIAN, MARICOPA COUNTY, ARIZONA, MORE PARTICULARLY DESCRIBED AS FOLLOWS:

COMMENCING AT THE NORTHEAST CORNER OF SAID SECTION 31, BEING A FOUND GLO BRASS CAP FROM WHICH THE NORTH QUARTER CORNER OF SAID SECTION 31, BEING A FOUND GLO BRASS CAP BEARS NORTH 89 DEGREES 49 MINUTES 16 SECONDS WEST, A DISTANCE OF 2,640.95 FEET;

THENCE ALONG THE NORTH LINE OF SAID SECTION 31, NORTH 89 DEGREES 49 MINUTES 16 SECONDS WEST, A DISTANCE OF 400.00 FEET;

THENCE LEAVING THE NORTH LINE OF SAID SECTION 31, SOUTH 00 DEGREES 04 MINUTES 10 SECONDS WEST, A DISTANCE OF 220.00 FEET TO THE POINT OF BEGINNING OF THE PARCEL HEREIN DESCRIBED;

THENCE SOUTH 89 DEGREES 49 MINUTES 16 SECONDS EAST, A DISTANCE OF 200.00 FEET;

THENCE SOUTH 00 DEGREES 04 MINUTES 10 SECONDS WEST, A DISTANCE OF 219.34 FEET;

THENCE NORTH 89 DEGREES 50 MINUTES 03 SECONDS WEST, A DISTANCE OF 460.00 FEET;

THENCE NORTH 49 DEGREES 58 MINUTES 06 SECONDS EAST, A DISTANCE OF 339.91 FEET, TO THE POINT OF BEGINNING OF THE PARCEL HEREIN DESCRIBED;

SAID PARCEL CONTAINS 72,393 SQ. FT OR 1.662 ACRES, MORE OR LESS.

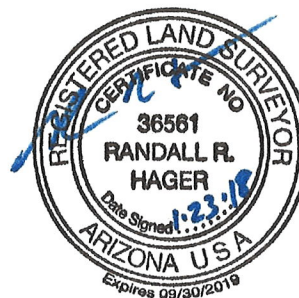

LOT 1 LEGAL DESCRIPTION

A PORTION OF THE NORTHEAST QUARTER OF SECTION 31, TOWNSHIP 7 NORTH, RANGE 3 EAST OF THE GILA AND SALT RIVER BASE AND MERIDIAN, MARICOPA COUNTY, ARIZONA, MORE PARTICULARLY DESCRIBED AS FOLLOWS:

COMMENCING AT THE NORTHEAST CORNER OF SAID SECTION 31, BEING A FOUND GLO BRASS CAP FROM WHICH THE NORTH QUARTER CORNER OF SAID SECTION 31, BEING A FOUND GLO BRASS CAP BEARS NORTH 89 DEGREES 49 MINUTES 16 SECONDS WEST, A DISTANCE OF 2,640.95 FEET;

THENCE ALONG THE NORTH LINE OF SAID SECTION 31, NORTH 89 DEGREES 49 MINUTES 16 SECONDS WEST, A DISTANCE OF 400.00 FEET TO THE POINT OF BEGINNING OF THE PARCEL HEREIN DESCRIBED;

THENCE LEAVING THE NORTH LINE OF SAID SECTION 31, SOUTH 00 DEGREES 04 MINUTES 10 SECONDS WEST, A DISTANCE OF 220.00 FEET;

THENCE SOUTH 49 DEGREES 58 MINUTES 06 SECONDS WEST, A DISTANCE OF 339.91 FEET;

THENCE NORTH 00 DEGREES 04 MINUTES 10 SECONDS EAST, A DISTANCE OF 439.44 FEET TO A POINT ON THE NORTH LINE OF SAID SECTION 31;

THENCE ALONG THE NORTH LINE OF SAID SECTION 31, SOUTH 89 DEGREES 49 MINUTES 16 SECONDS EAST, A DISTANCE OF 260.00 FEET, TO THE POINT OF BEGINNING OF THE PARCEL HEREIN DESCRIBED;

SAID PARCEL CONTAINS 85,728 SQ. FT OR 1.968 ACRES, MORE OR LESS.

LOT 2 LEGAL DESCRIPTION

A PORTION OF THE NORTHEAST QUARTER OF SECTION 31, TOWNSHIP 7 NORTH, RANGE 3 EAST OF THE GILA AND SALT RIVER BASE AND MERIDIAN, MARICOPA COUNTY, ARIZONA, MORE PARTICULARLY DESCRIBED AS FOLLOWS:

COMMENCING AT THE NORTHEAST CORNER OF SAID SECTION 31, BEING A FOUND GLO BRASS CAP FROM WHICH THE NORTH QUARTER CORNER OF SAID SECTION 31, BEING A FOUND GLO BRASS CAP BEARS NORTH 89 DEGREES 49 MINUTES 16 SECONDS WEST, A DISTANCE OF 2,640.95 FEET;

THENCE ALONG THE NORTH LINE OF SAID SECTION 31, NORTH 89 DEGREES 49 MINUTES 16 SECONDS WEST, A DISTANCE OF 400.00 FEET;

THENCE LEAVING THE NORTH LINE OF SAID SECTION 31, SOUTH 00 DEGREES 04 MINUTES 10 SECONDS WEST, A DISTANCE OF 220.00 FEET TO THE POINT OF BEGINNING OF THE PARCEL HEREIN DESCRIBED;

THENCE SOUTH 89 DEGREES 49 MINUTES 16 SECONDS EAST, A DISTANCE OF 200.00 FEET;

THENCE SOUTH 00 DEGREES 04 MINUTES 10 SECONDS WEST, A DISTANCE OF 219.34 FEET;

THENCE NORTH 89 DEGREES 50 MINUTES 03 SECONDS WEST, A DISTANCE OF 460.00 FEET;

THENCE NORTH 49 DEGREES 58 MINUTES 06 SECONDS EAST, A DISTANCE OF 339.91 FEET, TO THE POINT OF BEGINNING OF THE PARCEL HEREIN DESCRIBED;

SAID PARCEL CONTAINS 72,393 SQ. FT OR 1.662 ACRES, MORE OR LESS.