

A photograph of a modern, multi-story glass building at dusk. The building's facade is composed of large glass panels and dark metal frames. The interior lights are on, and the sky is a deep blue. In the foreground, there are some young trees and a set of stairs leading up to the building. The overall mood is professional and modern.

FOR SUBLEASE

610 CHARTWELL ROAD  
OAKVILLE, ON

MOTIVATED SUBLANDLORD  
BELOW MARKET RATES

John Potter\*

Senior Vice President

416 798 6242

[john.potter@cbre.com](mailto:john.potter@cbre.com)

\*Sales Representative

**CBRE**

# BUILDING DETAILS

<b>Total Size</b>	53,922 Sq. Ft.
<b>Availability</b>	Suite 300: 26,961 Sq. Ft. Suite 400: 26,961 Sq. Ft.
<b>Parking</b>	4:1,000 Sq. Ft. Leased
<b>Sublease Term</b>	Until December 30, 2031
<b>Net Rental Rate</b>	Please Contact Listing Broker <i>Motivated SubLandlord – Below Market Rental Rates</i>
<b>Additional Rent (2024 Estimate)</b>	\$12.66 per sq. ft.
<b>Possession</b>	Immediate

## Additional Comments

- Suite has collaboration space, wellness room, 3 kitchenettes, divisible meeting rooms, breakout calling rooms
- Class-A office building built in 2017



Local Amenities



Efficient Floor Plan



High-End In Place Leasehold Improvements

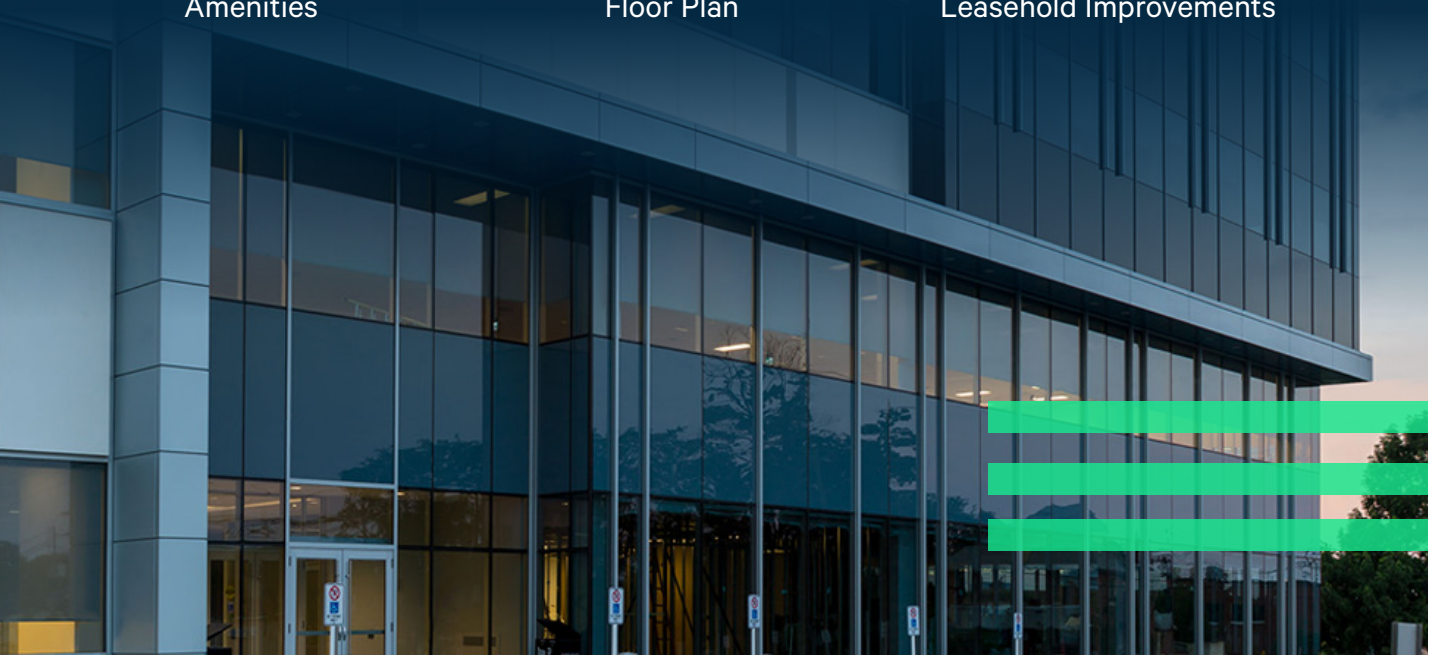
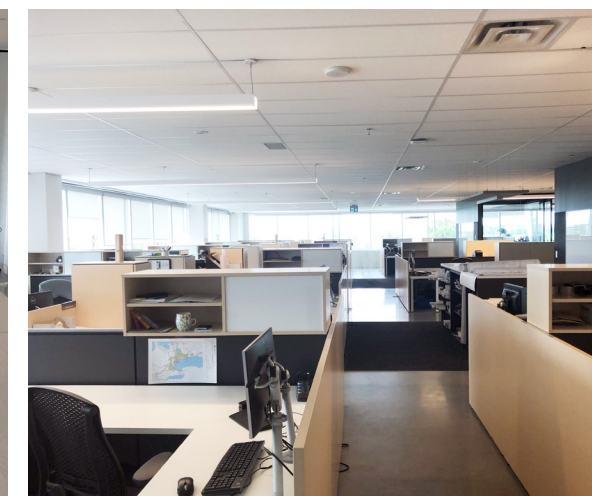

# FLOOR PLANS



## THIRD FLOOR

26,961 Sq. Ft. Available

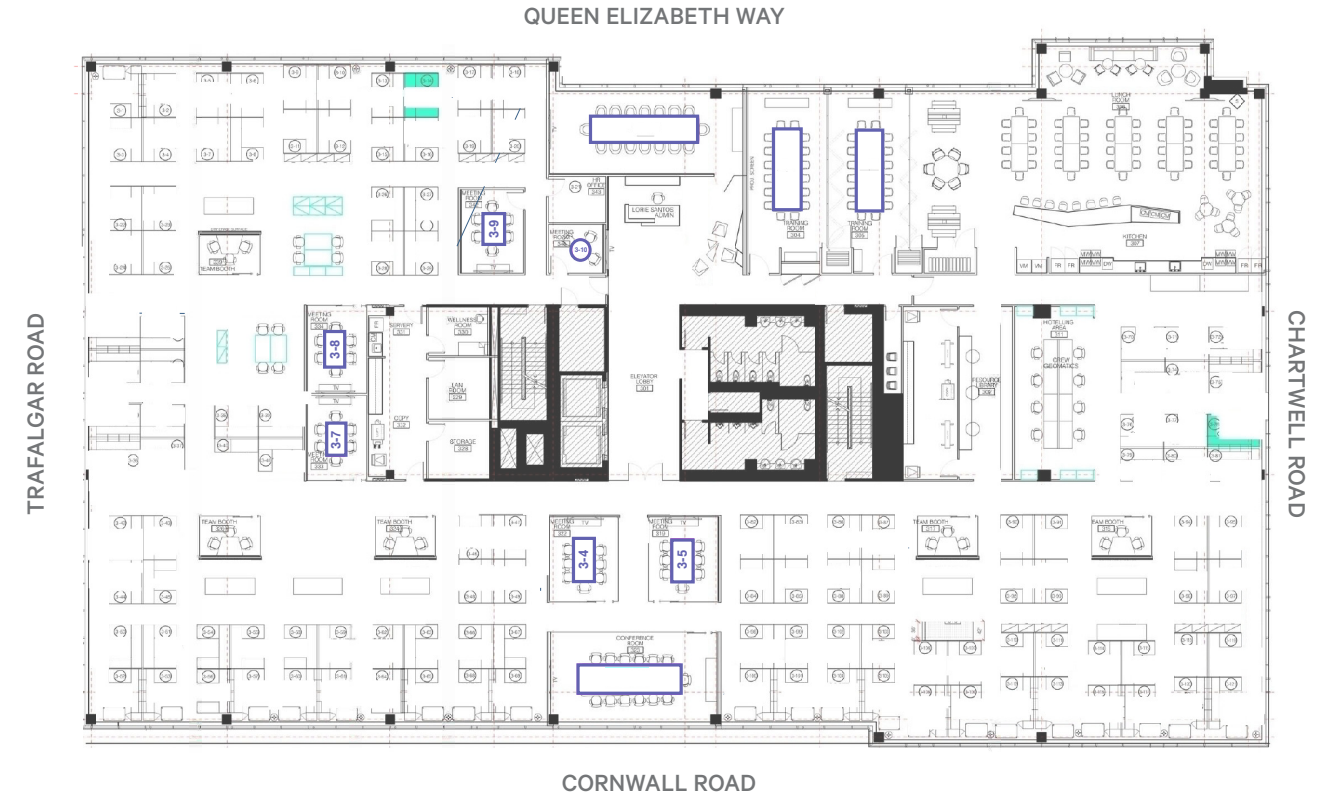

## FOURTH FLOOR

26,961 Sq. Ft. Available

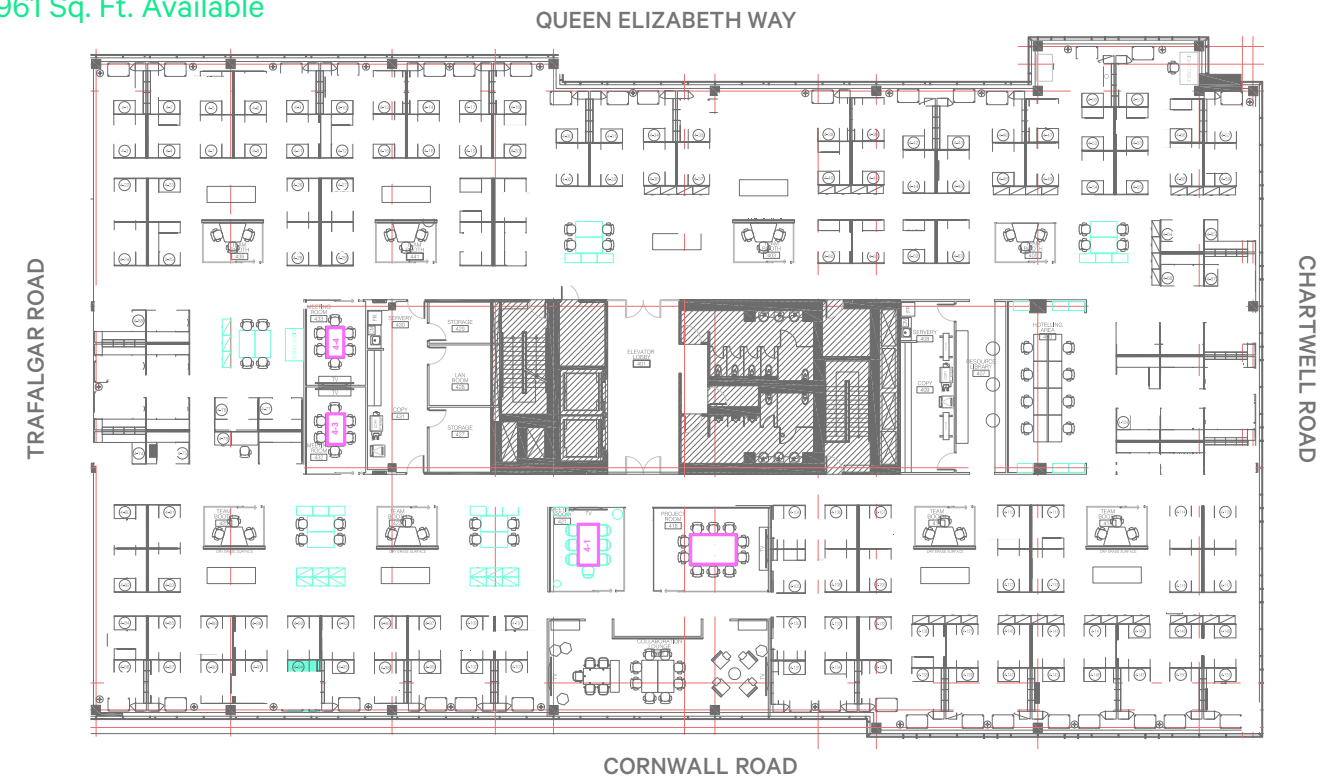

# LOCATION & LOCAL AMENITIES

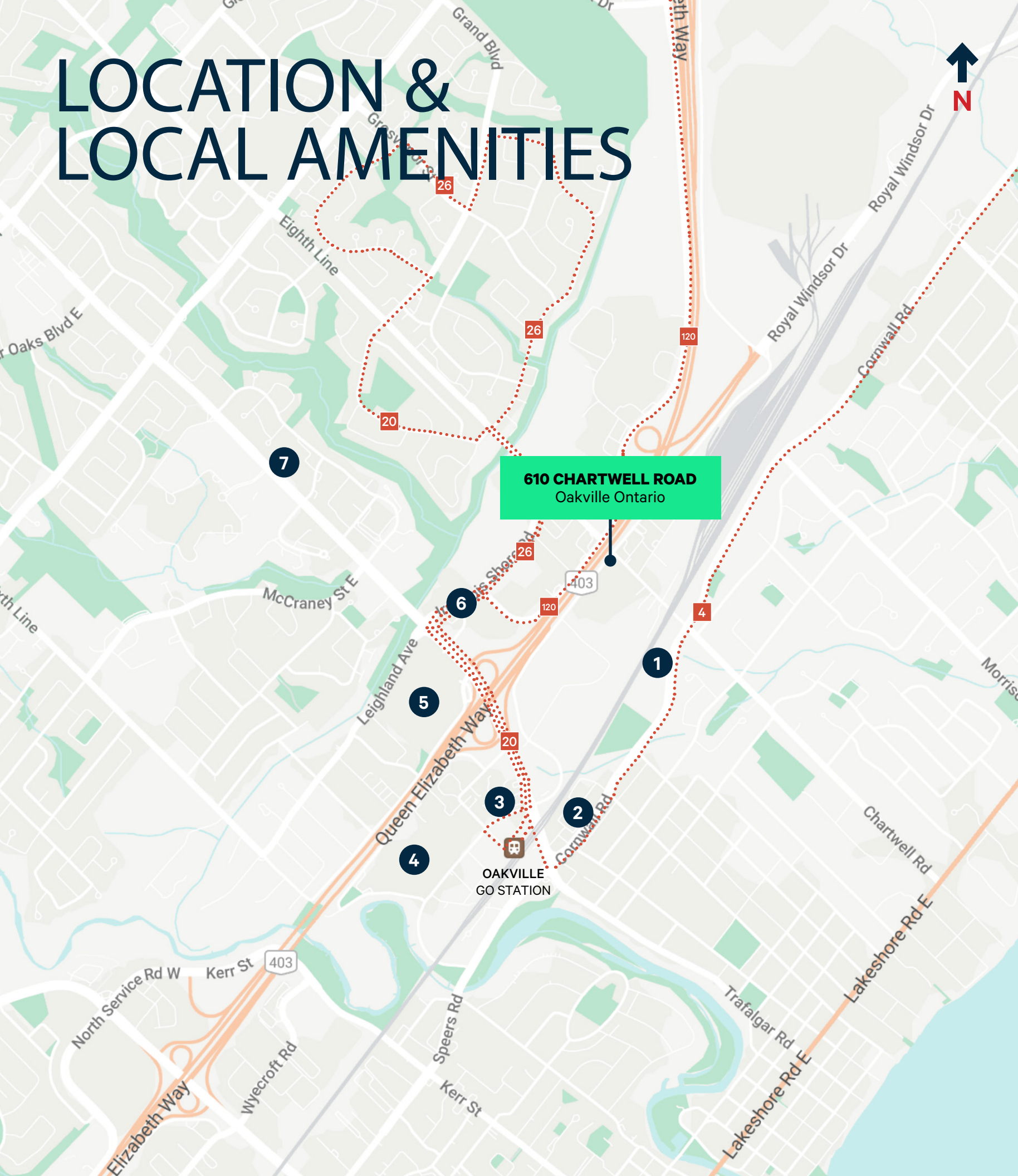

## LEGEND

- 1 Longos • Starbucks • BMO • Burger Priest
- 2 Whole Foods • Beertown • Shoppers Drugmart • LCBO • RBC
- 3 McDonalds • Swiss Chalet • Esso
- 4 Home Depot • Tim Hortons • Dollarama
- 5 The Bay • Sportchek • Shoppers Drugmart • GoodLife Fitness • H&M • PetSmart
- 6 TD Bank • McDonalds • RBC • Petro-Canada • Tim Hortons
- 7 Burger King

### Oakville Transit Routes



Great exposure from  
QEW Highway



Convenient access from both  
South Service Rd and Chartwell Rd



Close proximity to the  
Oakville GO Station



**FOR MORE INFORMATION,  
PLEASE CONTACT:**

\*Sales Representative

**John Potter\***

Senior Vice President

john.potter@cbre.com

416 798 6242

**CBRE**



CBRE Limited, Real Estate Brokerage | 5935 Airport Rd, Suite 700, Mississauga, ON L4V 1W5 | [www.cbre.ca](http://www.cbre.ca)

This disclaimer shall apply to CBRE Limited, Real Estate Brokerage, and to all other divisions of the Corporation; to include all employees and independent contractors ("CBRE"). The information set out herein, including, without limitation, any projections, images, opinions, assumptions and estimates obtained from third parties (the "Information") has not been verified by CBRE, and CBRE does not represent, warrant or guarantee the accuracy, correctness and completeness of the Information. CBRE does not accept or assume any responsibility or liability, direct or consequential, for the Information or the recipient's reliance upon the Information. The recipient of the Information should take such steps as the recipient may deem necessary to verify the Information prior to placing any reliance upon the Information. The Information may change and any property described in the Information may be withdrawn from the market at any time without notice or obligation to the recipient from CBRE. CBRE and the CBRE logo are the service marks of CBRE Limited and/or its affiliated or related companies in other countries. All other marks displayed on this document are the property of their respective owners. All Rights Reserved. Mapping Sources: Canadian Mapping Services [canadamapping@cbre.com](mailto:canadamapping@cbre.com); DMTI Spatial, Environics Analytics, Microsoft Bing, Google Earth