

PRIME LEASING OPPORTUNITY AVAILABLE IN SE CALGARY



Copperfield Corner

15566 McIvor Boulevard SE
Calgary, AB

CBRE

Demographics



98,212

Population within 3 KM

61,801

Daytime Population within 3 KM



\$165,473

Average Household
Income Within 3 KM

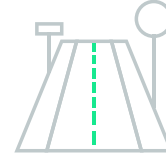

34,154

VPD along
McIvor Blvd SE

45,767

VPD along
52nd Street SE

Prime retail opportunity in the SE neighborhood of Copperfield

- Servicing the communities of Copperfield, Mahogany, Cranston, Auburn Bay, McKenzie Towne, McKenzie Lake and New Brighton
- Current Tenants include Starbucks, Papa John's Pizza, Star Liquor, Preschool, Co-op Gas Bar/C-Store, Tower Cleaners, Nails, Medical Clinic, Pharmasave, Dental, Chiropractor, Vet, Tail Blazers, Avis Kabob and Edward Jones

Space Available

Unit 511
1,114 sq. ft.

BASIC RENT -	Market
OP COSTS & TAXES -	\$24.39 (2026)
SIGNAGE -	Pylon (\$175/month per dbl sided panel)
AVAILABLE -	Immediately
ZONING -	C-N2
TERM -	5 - 10 years



Leasing Plan

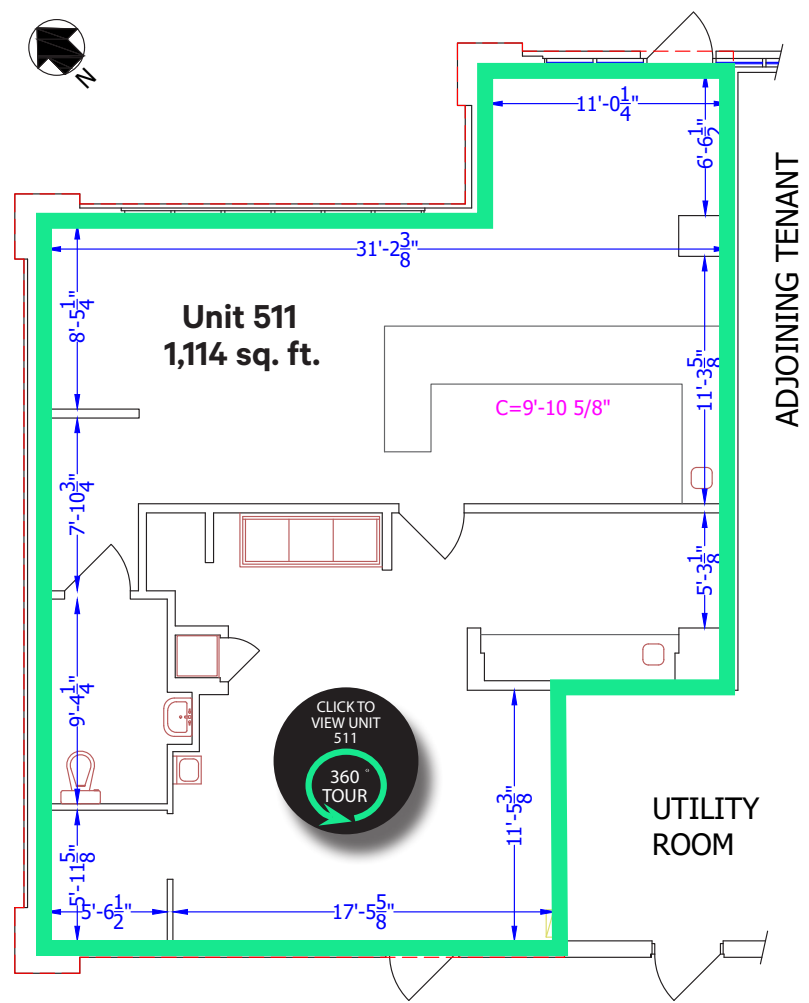
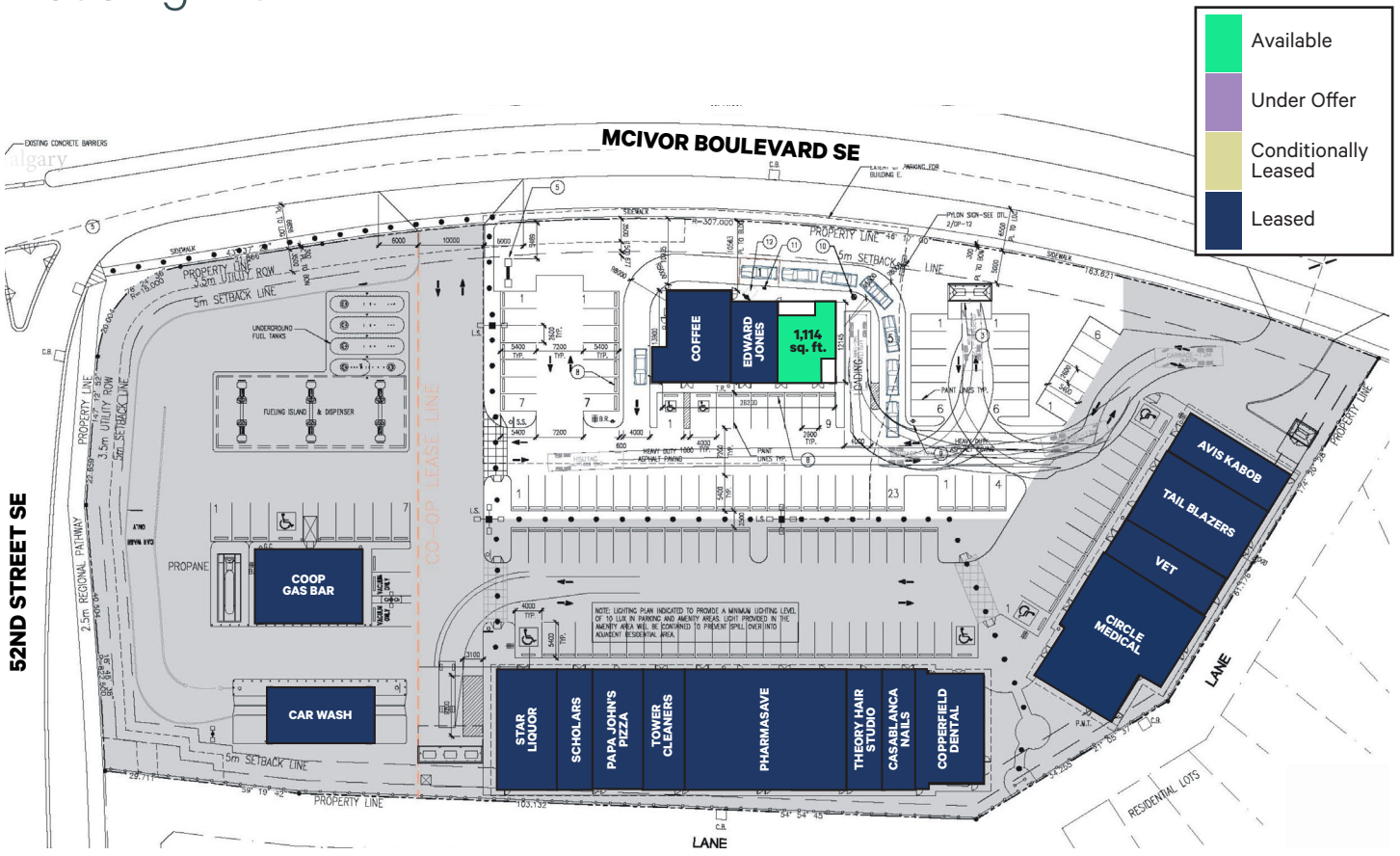

Unit 511 Exterior Photos



Pylon Signage



Unit 511 Interior Photos



Property Photos



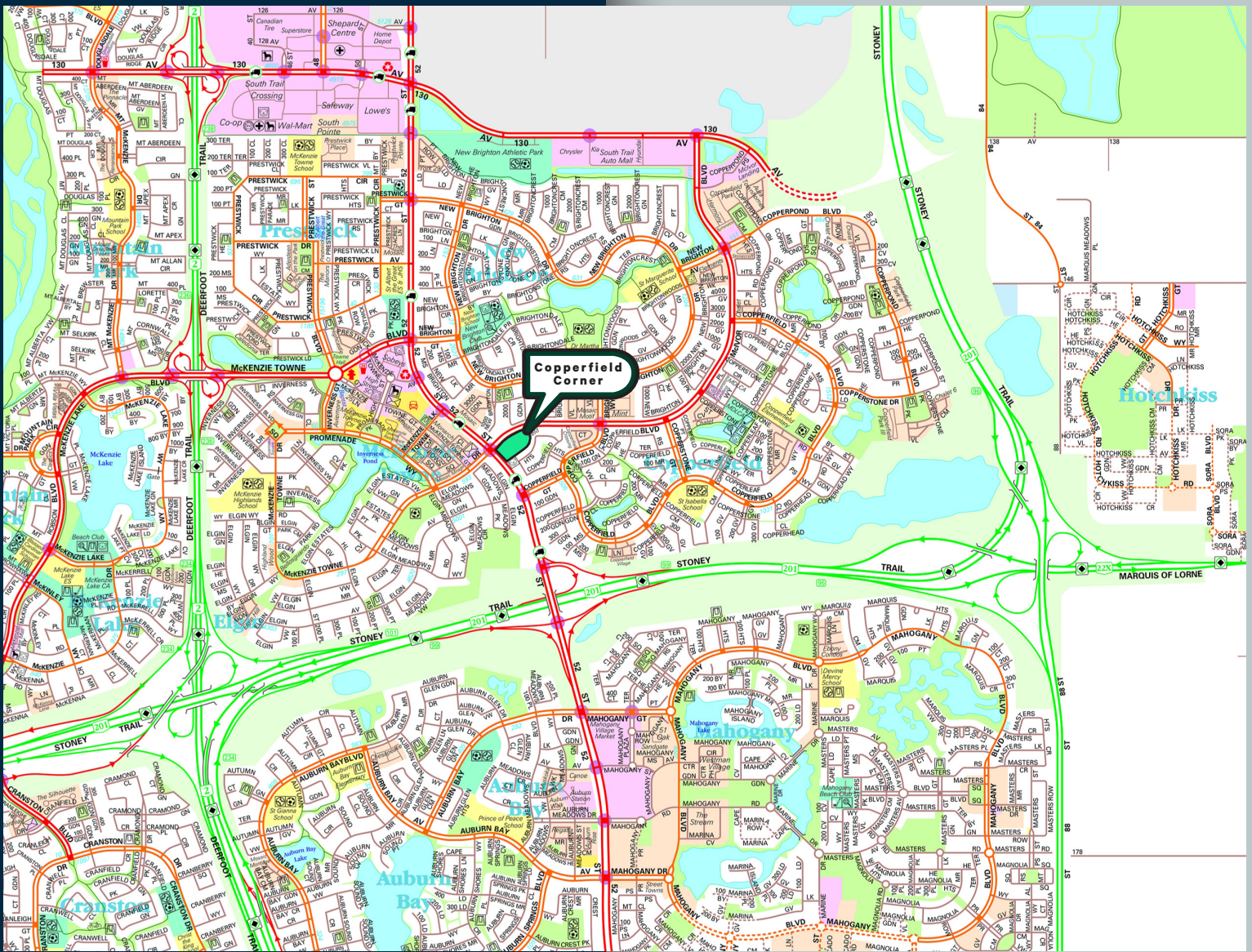

For More Information Please Contact

Alistair Corbett

Senior Vice President
403.294.5709
alistair.corbett@cbre.com

Cory Miles

Associate Vice President
403.750.0523
cory.miles@cbre.com

Mac Marcinew

Sales Associate
587.583.7197
mac.marcinew@cbre.com

Jayne Rogers

Transaction Manager
403.750.0535
jayce.rogers@cbre.com

Brandy Chorney

Marketing Specialist
403.303.3609
brandy.chorney@cbre.com

CBRE Calgary

Eighth Avenue Place
East Tower 525 8 Avenue SW Suite 3200
Calgary, Alberta T2P 1G1

This disclaimer shall apply to CBRE Limited, and to all divisions of the Corporation ("CBRE"). The information set out herein (the "Information") has not been verified by CBRE, and CBRE does not represent, warrant or guarantee the accuracy, correctness and completeness of the Information. CBRE does not accept or assume any responsibility or liability, direct or consequential, for the Information or the recipient's reliance upon the Information. The recipient of the Information should take such steps as the recipient may deem necessary to verify the Information prior to placing any reliance upon the Information. The Information may change and any property described in the Information may be withdrawn from the market at any time without notice or obligation to the recipient from CBRE. Mapping Sources: Canadian Mapping Services canadamapping@cbre.com; DMTI Spatial, Environs Analytics, Microsoft Bing, Google Earth. Map© 2024 Sherlock Publishing Ltd.

