

# Plaza Montréal-Nord

1,800 pi. ca. | sq. ft.  
COMMERCIAL

## À LOUER | FOR LEASE

5845 - 5849 boul. Henri-Bourassa Est  
Montreal-Nord, QC



**MIKE TROTTA**  
Président  
Courtier Immobilier Agrée  
514.962.6880  
[mike.trotta@c21.ca](mailto:mike.trotta@c21.ca)

**GIUSEPPE DIODATI**  
Vice-Président  
Courtier Immobilier  
514.293.9576  
[giuseppe.diodati@c21.ca](mailto:giuseppe.diodati@c21.ca)

**ANTHONY D'ANELLO**  
Associée  
Courtier Immobilier  
514.713.6500  
[anthony.danello@c21.ca](mailto:anthony.danello@c21.ca)

**CENTURY 21.**  
Excel  
REAL ESTATE AGENCY

# Description de la propriété

## PROPERTY DESCRIPTION

900-1,800 pi. ca. | sq. ft.

Rez-de-chaussée | Ground floor

Chauffage et climatisation inclus | Heating & air conditioning included

Vaste stationnement extérieur | Large exterior parking

Ample fenestration et lumière naturelle | Ample windows & natural lighting

Plafonds de 9 pieds | 9 foot ceilings

Occupation Immédiate | Immediate Occupancy

Espaces flexibles et personnalisables | Flexible & customizable space

Entrée privée | Private entrance

Immense visibilité | Immense visibility

Accès 24 heures | 24 hour access

Bureaux fermes | Closed offices

Services de gestion professionnel Professional management services

[WWW.EXCEL.C21.CA](http://WWW.EXCEL.C21.CA) | #MLS: 18751790

**PRESTIGE COIFFURE DOIGTS MAGIQUE**

TRESSE AFRICAINE ◦ TWISTS ◦ GREFFE ◦ POSE LACE  
COIFFURE DE MARIAGE ◦ MAQUILLAGE ◦ POSE-CILS  
BASE DE PERRUQUE ◦ LAVAGE ◦ TRESSE ENFANT  
SOURCILS ◦ PERMANENTE ◦ CROCHET

**514.290.6031**

**BIJOUTERIE**

**ACHETONS  
OR!**



5849

# LOCAL 5849

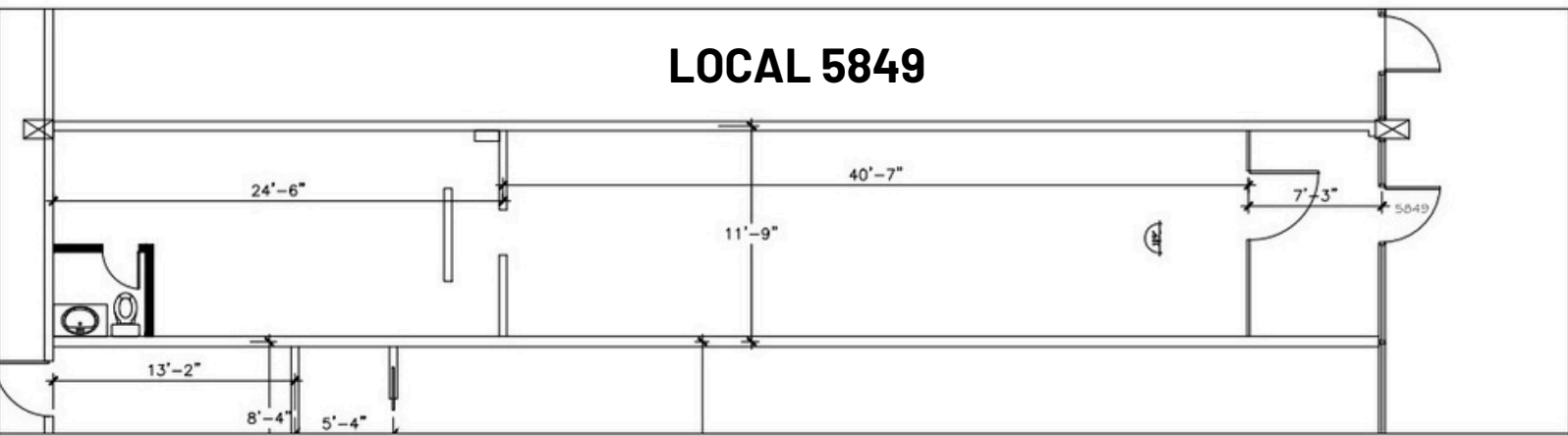

# LOCAL 5845

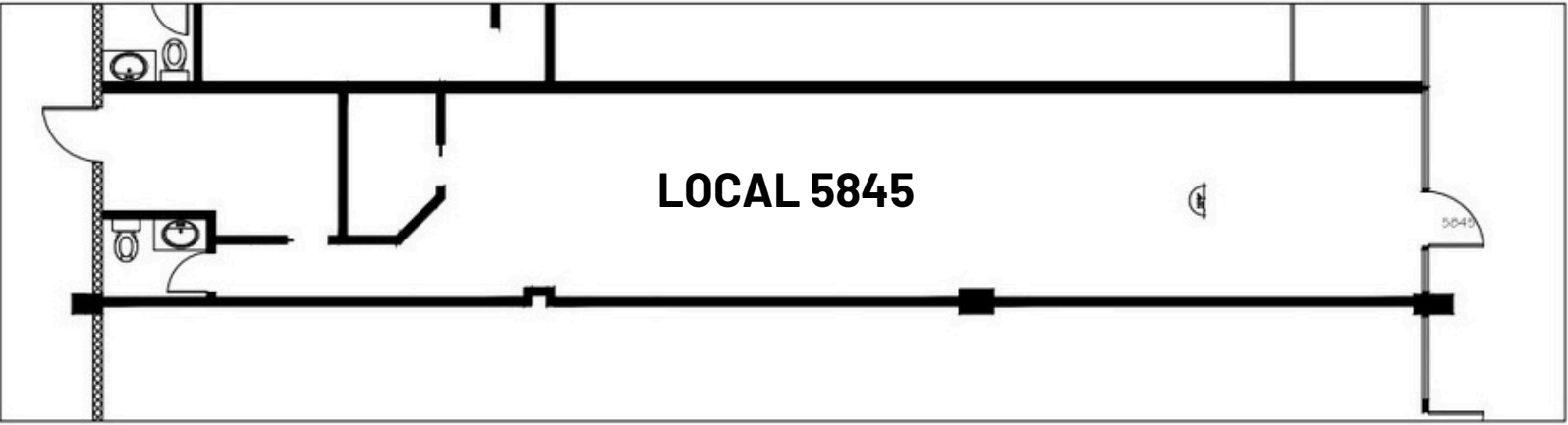

[WWW.EXCEL.C21.CA](http://WWW.EXCEL.C21.CA) | #MLS: 18751790



# Emplacement

## LOCATION

Cette propriété commercial est stratégiquement situer près de la gare St. Leonard/Montréal-Nord, centre commerciaux, CLSC, autoroute 25, pont Pie-IX, transport en commun et future station de métro.

This commercial property is strategically located close to the gare St. Leonard/ Montreal-North, shopping centers, CLSC, highway 25, Pie-IX bridge, public transport and future metro station.

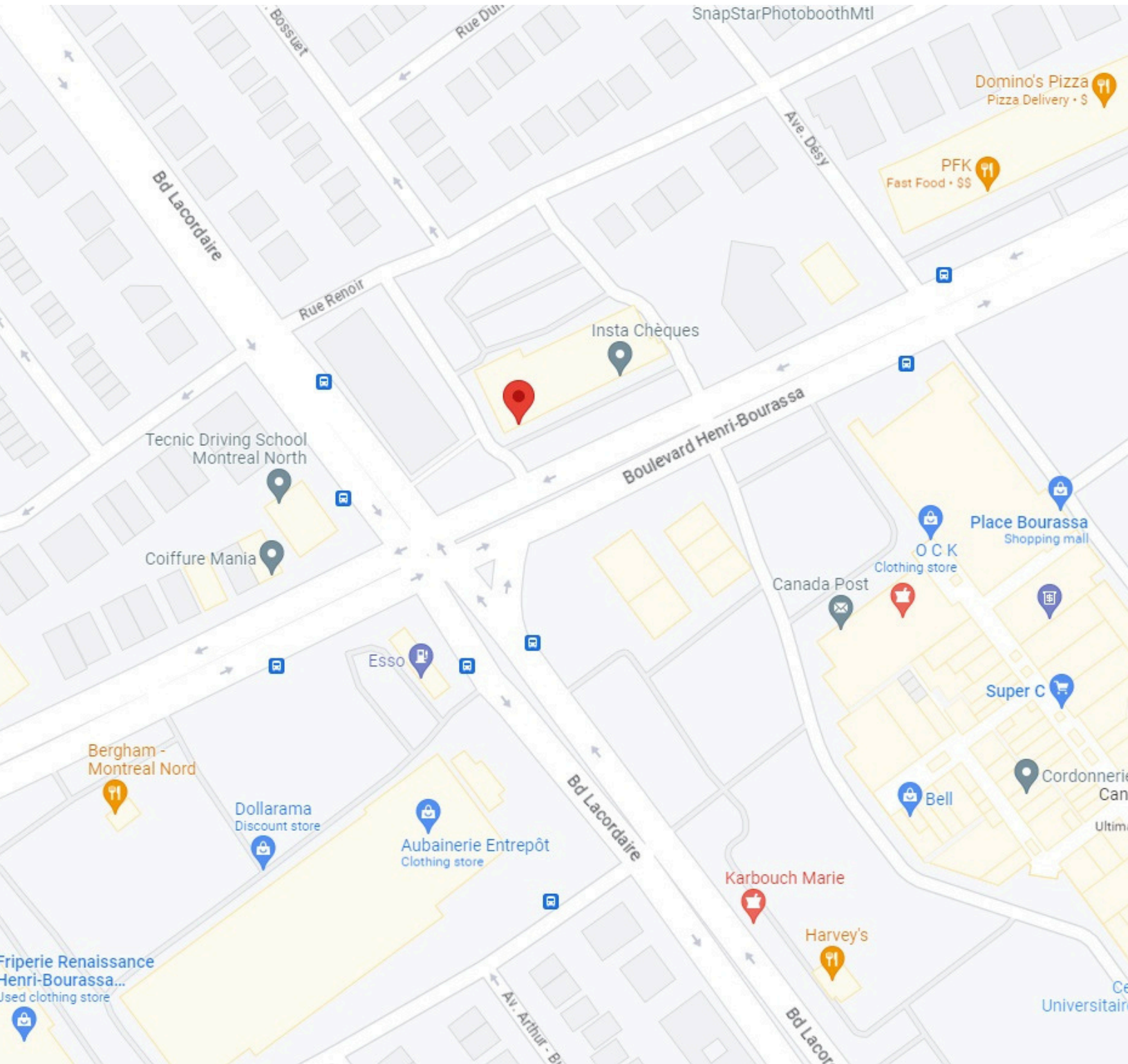

© 2023 Century 21 Excel. All rights reserved. This information has been obtained from sources believed reliable, but has not been verified for accuracy or completeness. You should conduct a careful, independent investigation of the property and verify all information. All other marks displayed on this document are the property of their respective owners, and the use of such logos does not imply any affiliation with or endorsement of Century 21 Excel. Photos herein are the property of their respective owners. Use of these images without the express written consent of the owner is prohibited.

