

Location Map Possible Road Expansion Map Identified in Road outlined in Burgundy

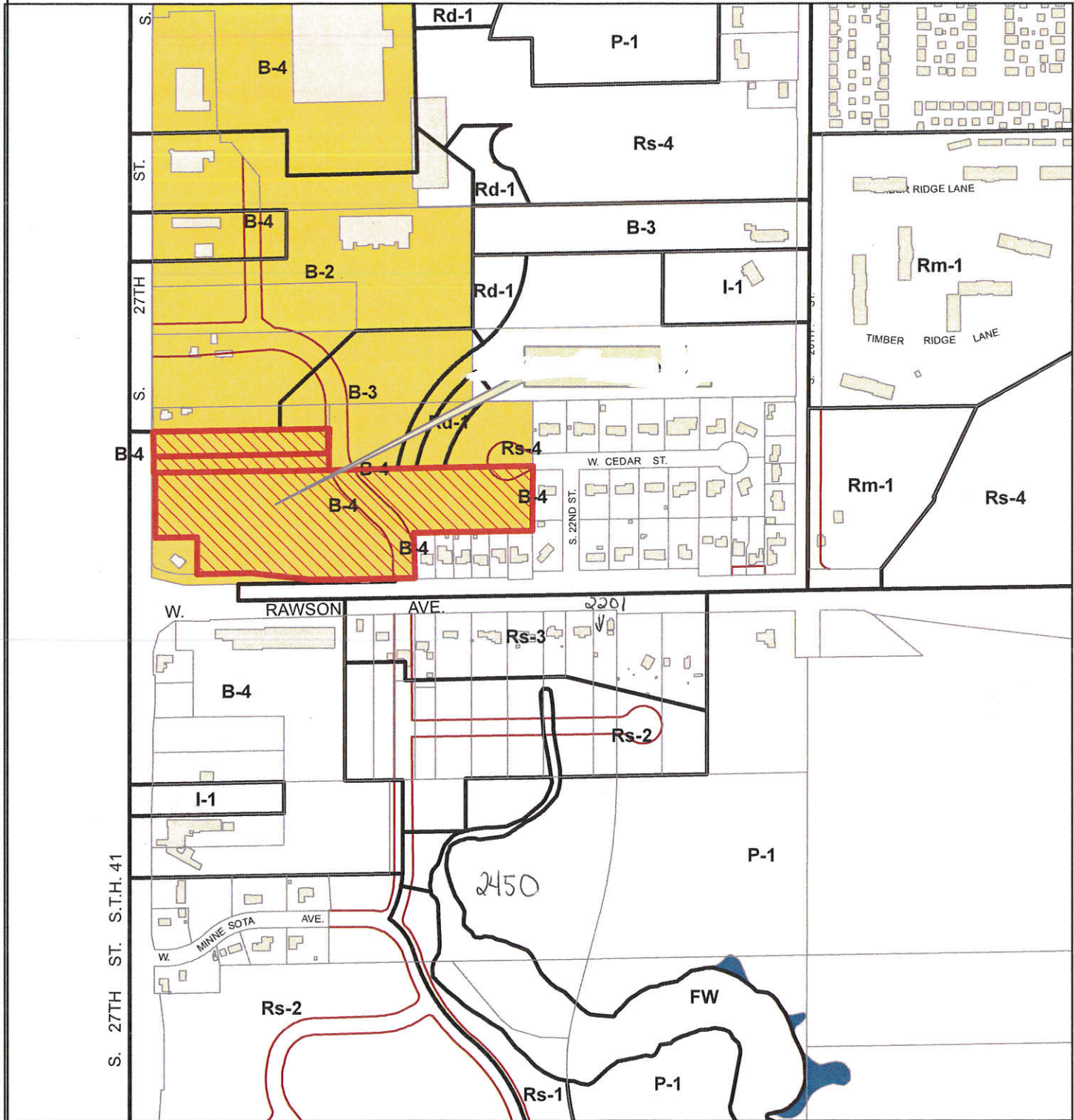

This map is not a survey of the actual boundary of any property this map depicts.



Department of Community Development



Legend

- 2500 W Rawson Ave.
- 7015 S 27th St.
- 7006 S 27th St.
- C-1 Shoreland Wetland
- FF Flood Fringe
- Lakefront Overlay
- NC Mixed Use Neighborhood
- OO Mixed Use Office
- RR Regional Retail