



**Keegan & Coppin**  
COMPANY, INC.

FOR LEASE

399 BUSINESS PARK COURT  
WINDSOR, CA

WAREHOUSE SPACE IN THE  
SHILOH BUSINESS CENTER

Go beyond broker.

REPRESENTED BY:

**RUSS MAYER, PARTNER**  
LIC # 01260916 (707) 664-1400, EXT 353  
RMAYER@KEEGANCOPPIN.COM



# SITE PLAN



399 BUSINESS PARK CT  
WINDSOR, CA

WAREHOUSE SPACE  
FOR LEASE

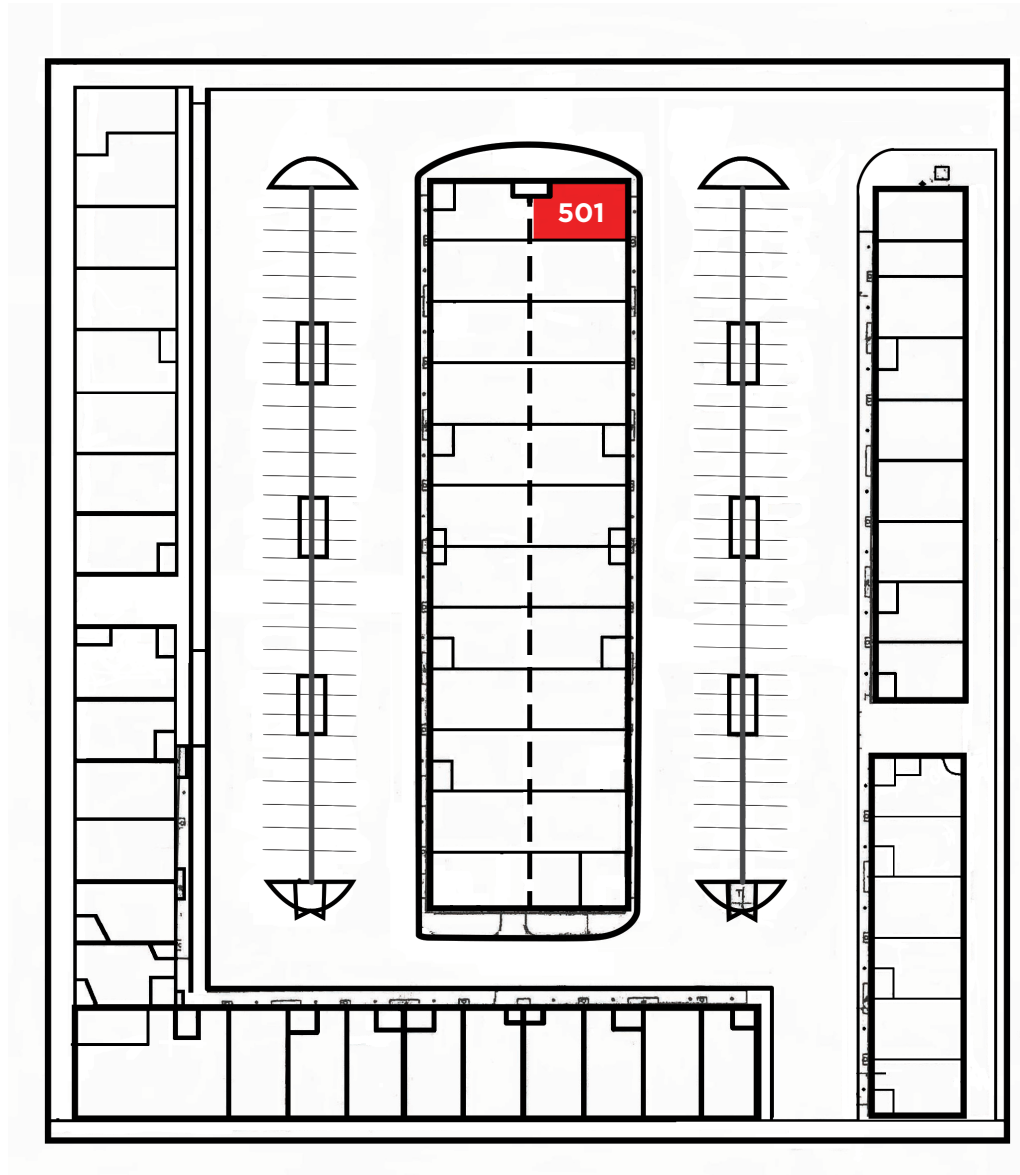

PRESENTED BY:

RUSS MAYER, PARTNER  
LIC # 01260916 (707) 664-1400, EXT 353  
RMAYER@KEEGANCOPPIN.COM

The above information, while not guaranteed, has been secured from sources we believe to be reliable. Submitted subject to error, change or withdrawal. An interested party should verify the status of the property and the information herein.



# PROPERTY INFORMATION



399 BUSINESS PARK CT  
WINDSOR, CA

**WAREHOUSE SPACE  
FOR LEASE**

## PROPERTY INFORMATION

### HIGHLIGHTS

- Sprinklered for Fire Protection
- Three-Phase Electrical Service
- Comcast High-Speed Data
- Monument and Building Signage
- Grade Level Truck Doors
- Exclusive Windsor Location
- Easy Access to Highway 101
- Proximity to Food and Retail Services
- On-Site Property Management

### AVAILABLE SPACE

**Unit 501**      925+/- SF

### DESCRIPTION

End unit featuring an approx. 100 SF office and ±16' clear span warehouse with a single grade level roll-up door.

### DESCRIPTION OF PREMISES

Shiloh Business Center is a multi-tenant industrial park designed to accommodate tenants seeking smaller warehouse and office space but also offers the flexibility for units to be combined for larger uses. Unit features include: 100-amp/3-phase electrical service, sprinklered for fire protection and insulated roofs. Very well maintained industrial park completed in 2007 with responsive, on-site property management. These modern and architecturally pleasing buildings are located just off Shiloh Road and adjacent to the Shiloh Retail Center anchored by Home Depot, Wal-Mart, and Grocery Outlet.

### LEASE TERMS

#### RATE

\$1.55 PSF

#### TERMS

Gross  
Rate includes CAM expense  
3-5 year lease term preferred  
4% requested annual rent adjustments

#### TOTAL BUILDING SIZE

63,840 +/- SF

#### PARKING

2:1,000 SF

#### ZONING

IL - Light Industrial

#### PRESENTED BY:

**RUSS MAYER, PARTNER**  
LIC # 01260916 (707) 664-1400, EXT 353  
RMAYER@KEEGANCOPPIN.COM



# AREA DESCRIPTION



399 BUSINESS PARK CT  
WINDSOR, CA

**WAREHOUSE SPACE  
FOR LEASE**

## DESCRIPTION OF AREA

Located just off Highway 101 at Shiloh Road. Shiloh Business Park is adjacent to the Shiloh Retail Power Center, anchored by Wal-Mart and Home Depot, insuring that this will be a quality business park long into the future. Other retail tenants in the center include Grocery Outlet, Les Schwab Tires, Starbucks, and many other national and strong regional retailers.



Keegan & Coppin Co., Inc.  
1201 N McDowell Boulevard  
Petaluma, CA 94954  
www.keegancoppin.com  
(707) 664-1400

The above information, while not guaranteed, has been secured from sources we believe to be reliable. Submitted subject to error, change or withdrawal. An interested party should verify the status of the property and the information herein.

REPRESENTED BY:

**RUSS MAYER, PARTNER**  
LIC # 01260916 (707) 664-1400, EXT 353  
RMAYER@KEEGANCOPPIN.COM



## ABOUT KEEGAN & COPPIN



399 BUSINESS PARK CT  
WINDSOR, CA

WAREHOUSE SPACE  
FOR LEASE



# Your partner in commercial real estate in the North Bay & beyond since 1976.

Keegan & Coppin has served our communities in the North Bay for well over 40 years. But our unmatched local experience is only part of what makes us the area's most trusted name in commercial real estate. At Keegan & Coppin, we bring together a range of services that go beyond traditional brokerage. That depth of knowledge and diverse skillset allows us to clarify and streamline all aspects of your transaction, giving you the confidence of knowing that we can help with anything that comes up through all phases of a project.

Keegan & Coppin Co., Inc.  
1201 N McDowell Blvd.  
Petaluma, CA 94954  
[www.keegancoppin.com](http://www.keegancoppin.com)  
(707) 664-1400

The above information, while not guaranteed, has been secured from sources we believe to be reliable. Submitted subject to error, change or withdrawal. An interested party should verify the status of the property and the information herein.

PRESENTED BY:

**RUSS MAYER, PARTNER**  
LIC #01260916 (707) 664-1400, EXT 353  
[RMAYER@KEEGANCOPPIN.COM](mailto:RMAYER@KEEGANCOPPIN.COM)