



AVAILABLE

**1041 Royal Avenue
EVANSVILLE, IN 47715**



FOR LEASE SUITE B

- Lease Price: \$9.00 / SF / NNN
- NNN Fee: \$3.50 / SF
- Available SF: 2,730 SF
- Lot Size: 0.70 Acres
- Year Built: 2006
- Zoning: C-4
- Ceiling Height: 10'
- Available: June 1st
- Ext. Construction: Brick
- Roof: Shingle
- # of Restrooms: 2 (1-Client / 1-Staff)
- Previous Use: Attorney Office
- Showing: Contact Listing Broker
- Location: East Side between Vogel Rd & Virginia St

Nice turn-key office space available with individual offices, conference room, break room, & large, separate secured waiting area. Building located on Royal Ave between Vogel Rd & Virginia St. Front & Rear parking lots.

Quick access to major retail areas.

For more information, contact:

Kristin Dannheiser, Broker

Direct: 812-455-0001 • KristinD@FCTuckerCommercial.com



812-473-6677 • FCTuckerCommercial.com

7820 EAGLE CREST BLVD., SUITE 200 • EVANSVILLE, IN 47715



AVAILABLE

1041 Royal Avenue EVANSVILLE, IN 47715

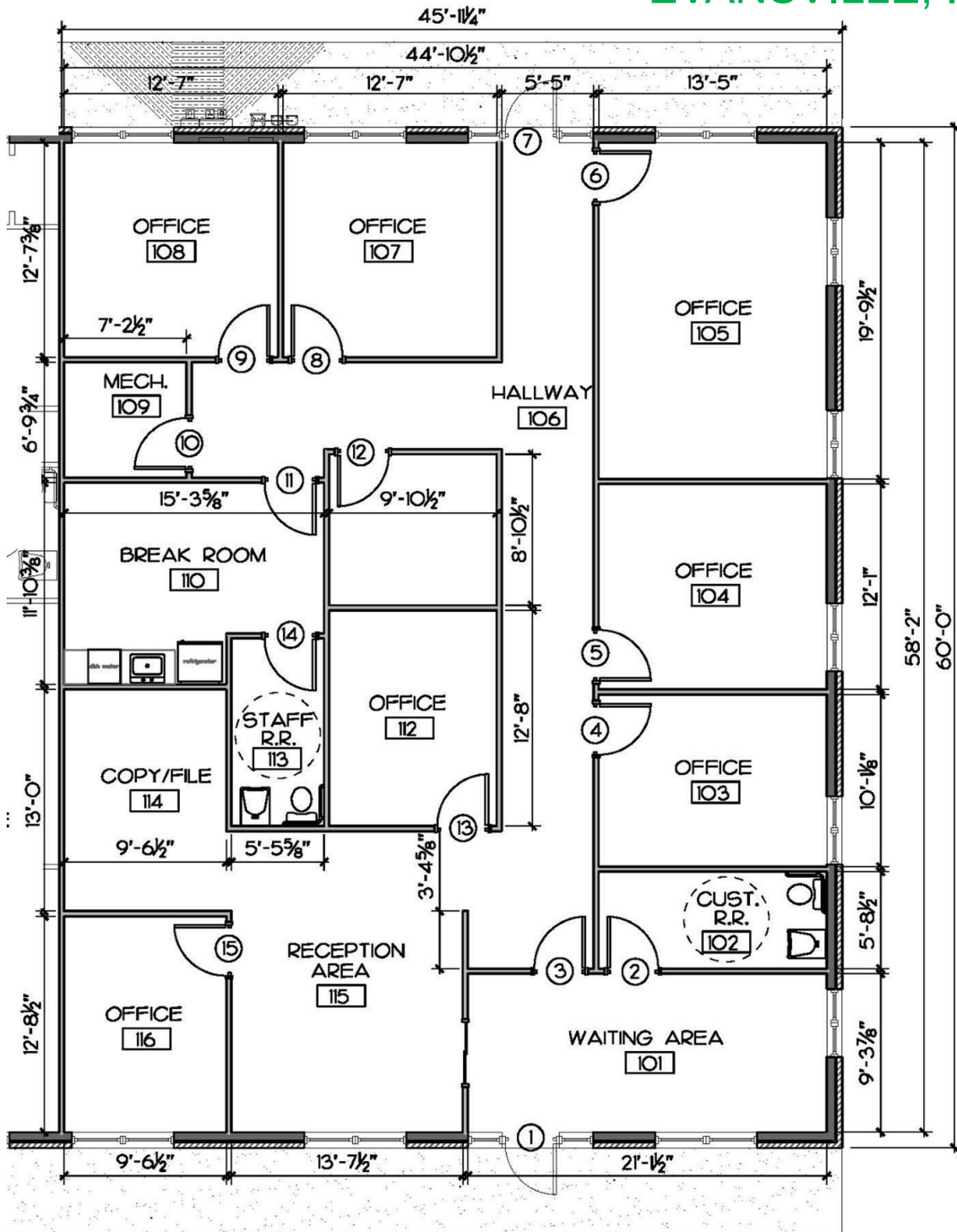

For more information, contact:

Kristin Dannheiser, Broker

Direct: 812-455-0001 • KristinD@FCTuckerCommercial.com



812-473-6677 • FCTuckerCommercial.com

7820 EAGLE CREST BLVD., SUITE 200 • EVANSVILLE, IN 47715

