



± 20,481 SF Industrial Building **FOR LEASE**

15557 Texaco Avenue
Paramount, CA



Property Features

- ± 20,481 SF Industrial Building
- ±800 SF Office Space
- Large ±14,000 SF Yard Area
- 16' Minimum Warehouse Clear Height
- One (1) Oversized 14' x 14' Ground Level Door
- One (1) Oversized 13' x 14' Truckwell Door
- 800A, 277/480 V 3 Phase Power (verify)
- Professionally Managed Building
- Excellent Access to Freeways , ,  and Port of Long Beach

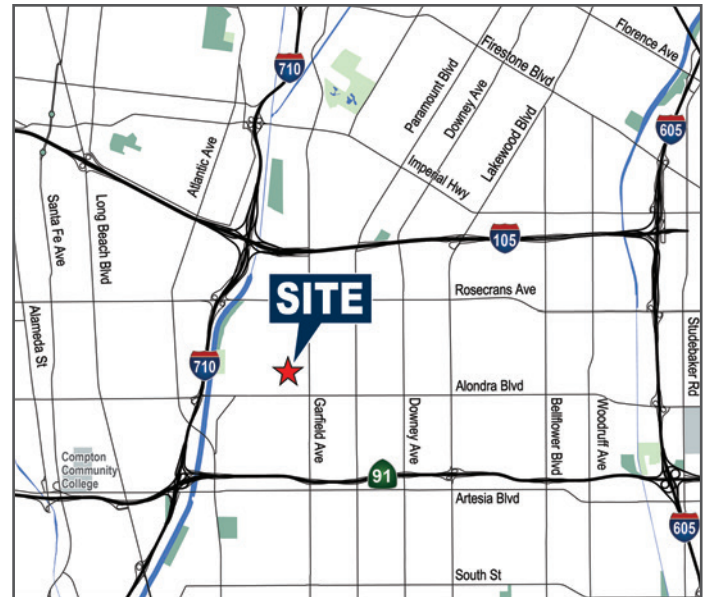

Voit
REAL ESTATE SERVICES

Loren Cargile
Vice President | Partner
(949) 307-2245 | lcargile@voitco.com
License # 01431329

Barry Walshe
Vice President | Partner
(714) 935-2309 | bwalshe@voitco.com
License # 01213417

2020 Main Street, Suite 100
Irvine, CA 92614
(949) 851-5100
www.voidco.com

± 20,481 SF Industrial Building
FOR LEASE

15557 Texaco Avenue
Paramount, CA

Site Plan: ± 20,481 SF

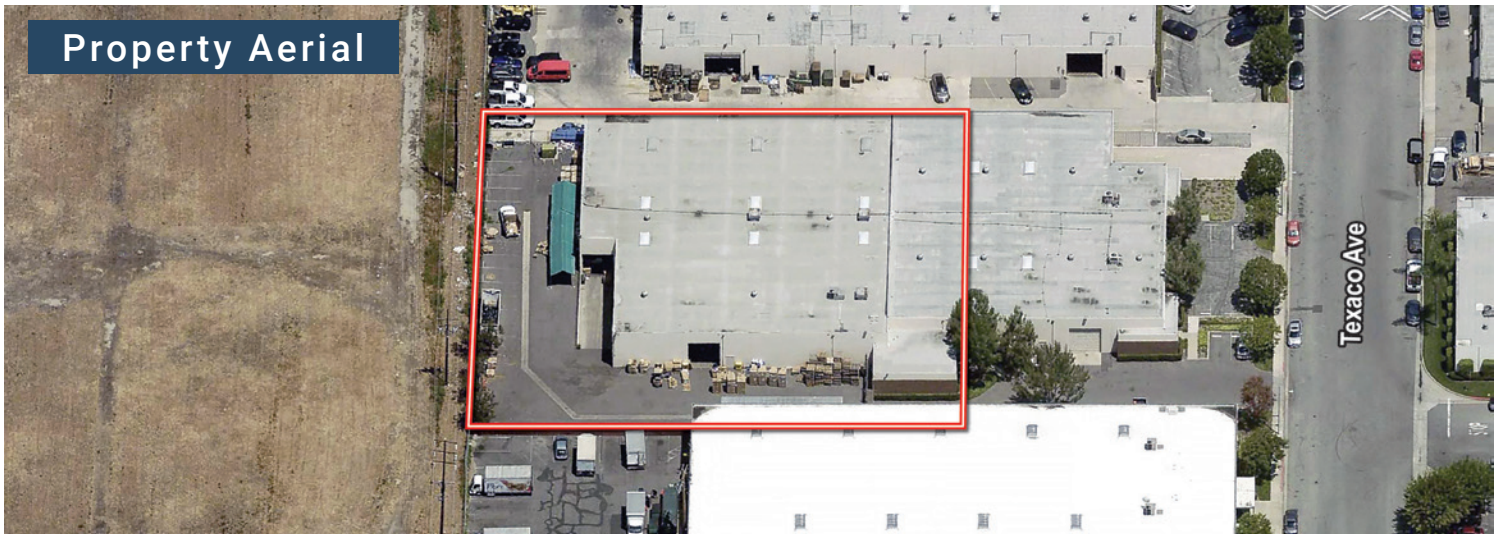
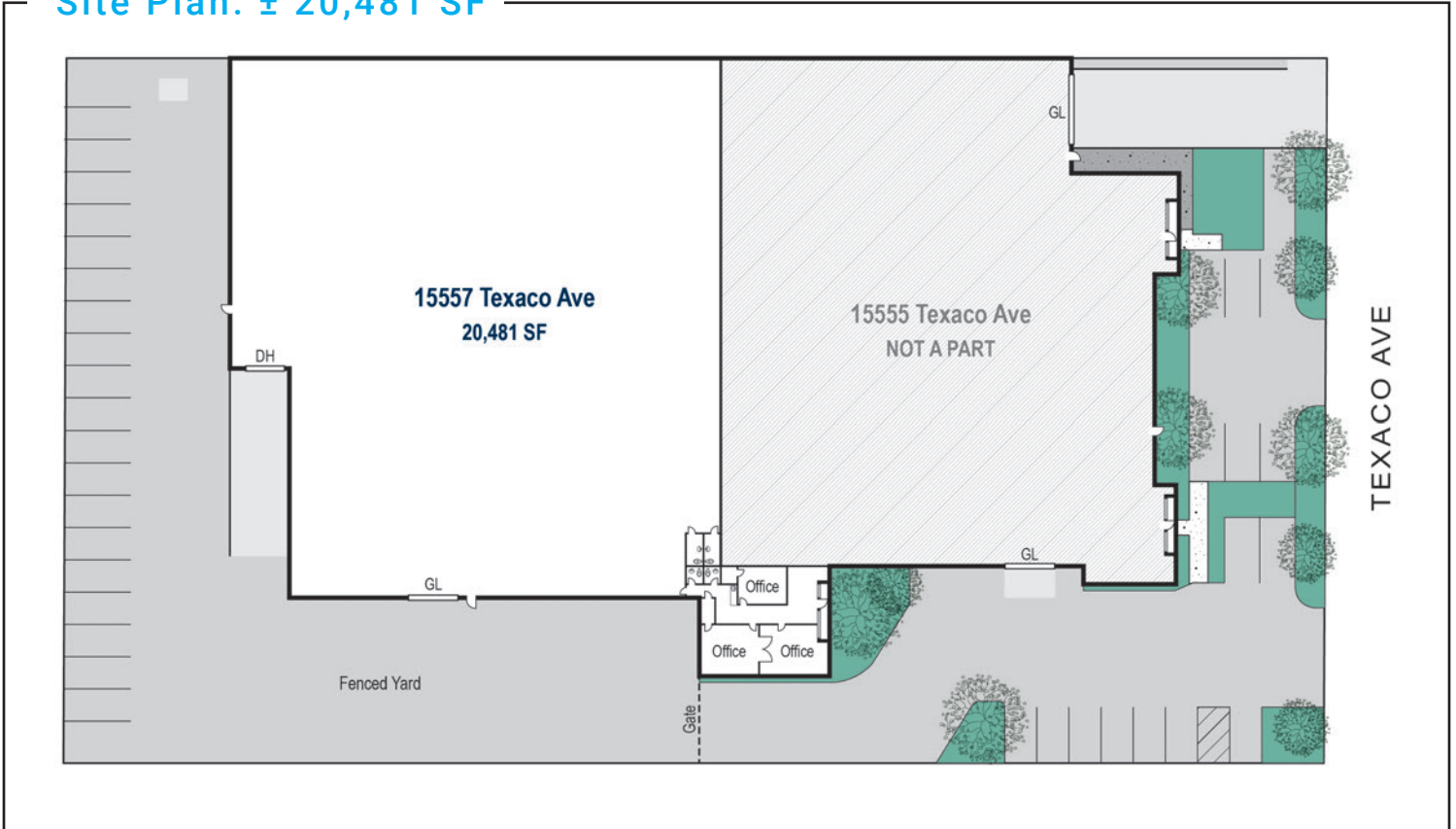

Voit
REAL ESTATE SERVICES

Loren Cargile
Vice President | Partner
(949) 307-2245 | lcargile@voitco.com
License # 01431329

Barry Walshe
Vice President | Partner
(714) 935-2309 | bwalshe@voitco.com
License # 01213417

2020 Main Street, Suite 100
Irvine, CA 92614
(949) 851-5100
www.voidco.com