

# Shoppes of Stewartville

95 20th St NE, Stewartville, MN 55976



## PROPERTY DESCRIPTION

The signalized intersection along the main road of Stewartville offers excellent visibility and accessibility, making it an ideal location for a retail establishment. The build-to-suit option provides the flexibility to create a tailored space that meets the specific needs of a retail tenant. This combination of prime location and customizable space presents an exciting opportunity for retailers looking to establish a strong presence in Stewartville.

## OFFERING SUMMARY

Lease Rate:	\$15.00 SF/yr (NNN)
Number of Units:	4
Available SF:	1,330 - 4,830 SF
Lot Size:	6,970 SF
Building Size:	7,700 SF

### CONTACT US

**Paul Aronhalt**

Partner

507.516.7132

Paul@northrockre.com

**Chris Beighley**

507.516.7134

chris@northrockre.com

# Shoppes of Stewartville

95 20th St NE, Stewartville, MN 55976

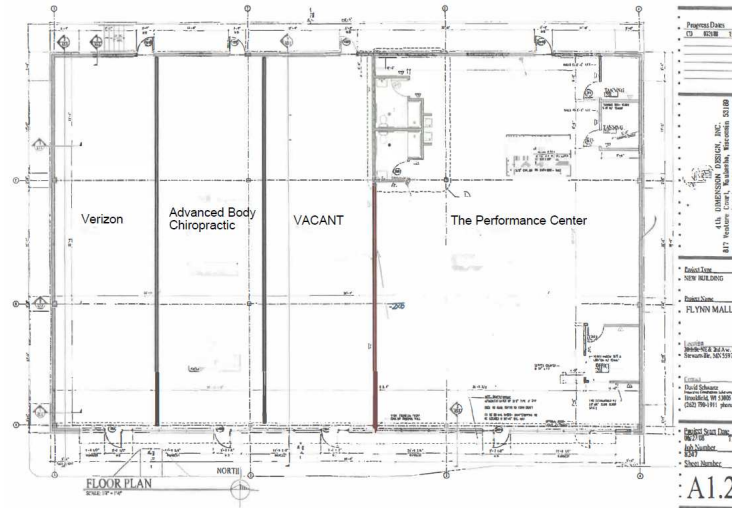

## LEASE INFORMATION

Lease Type:	NNN	Lease Term:	60 months
Total Space:	1,330 - 4,830 SF	Lease Rate:	\$15.00 SF/yr

## AVAILABLE SPACES

SUITE	TENANT	SIZE (SF)	LEASE TYPE	LEASE RATE	DESCRIPTION
Shoppes of Stewartville	Available	1,330 - 4,830 SF	NNN	\$15.00 SF/yr	-
Shoppes of Stewartville	Available	3,500 - 4,830 SF	NNN	\$15.00 SF/yr	-

### CONTACT US

**Paul Aronhalt**  
Partner  
507.516.7132  
Paul@northrockre.com

**Chris Beighley**  
507.516.7134  
chris@northrockre.com

Retail Property For Lease

# Shoppes of Stewartville

95 20th St NE, Stewartville, MN 55976



CONTACT US

*Paul Aronhalt*  
Partner  
507.516.7132  
Paul@northrockre.com

*Chris Beighley*  
507.516.7134  
chris@northrockre.com



Retail Property For Lease

# Shoppes of Stewartville

95 20th St NE, Stewartville, MN 55976

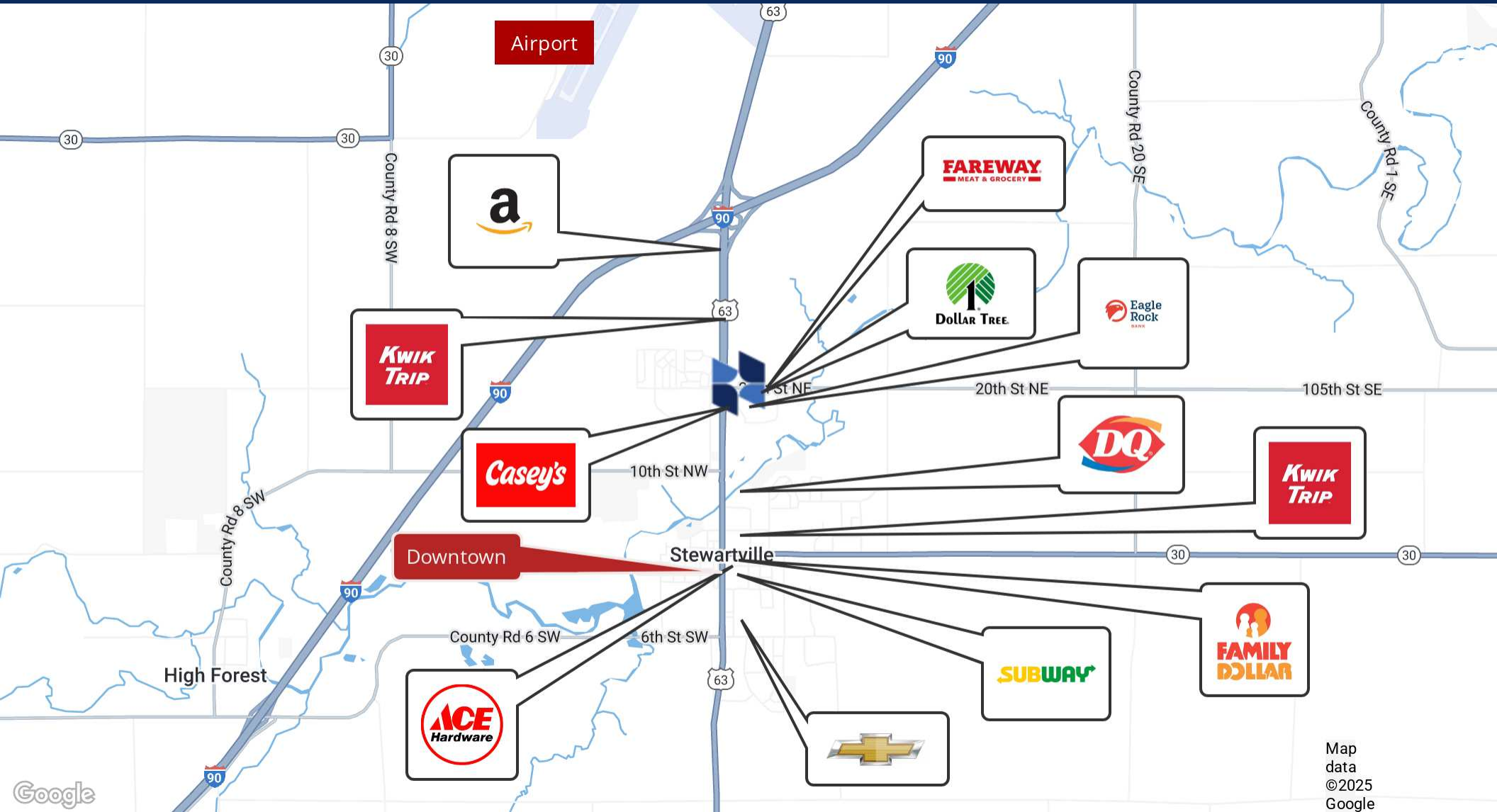

CONTACT US

Paul Aronhalt  
Partner  
507.516.7132  
Paul@northrockre.com

Chris Beighley  
507.516.7134  
chris@northrockre.com



Retail Property For Lease

# Shoppes of Stewartville

95 20th St NE, Stewartville, MN 55976



**PAUL ARONHALT**

Partner

**Direct:** 507.516.7132  
Paul@northrockre.com



**CHRIS BEIGHLEY**

**Direct:** 507.516.7134  
chris@northrockre.com

**CONTACT US**

*Paul Aronhalt*

Partner  
507.516.7132  
Paul@northrockre.com

*Chris Beighley*

507.516.7134  
chris@northrockre.com

