

**2,073 SF INDUSTRIAL SPACE AVAILABLE
BUILDING 4, SUITE 480**

11900 NE 95TH STREET, SUITE 480, VANCOUVER, WA 98682

**SUITE 480
HIGHLIGHTS & FEATURES**

- 512 SF Office Space
- Open Office Area
- Restroom
- Kitchen Bar
- 1 Grade Door
- 11' Clear Height
- 208 Volt, 3 Phase Power
- Ample Parking
- On-Site Property Management
- Restaurants and Retail Amenities nearby:
Los Jalapenos, Columbia Credit Union,
Papa John's Pizza, Chevron, Seize the Bagel
& Many More

paddencp.com

Available: Now

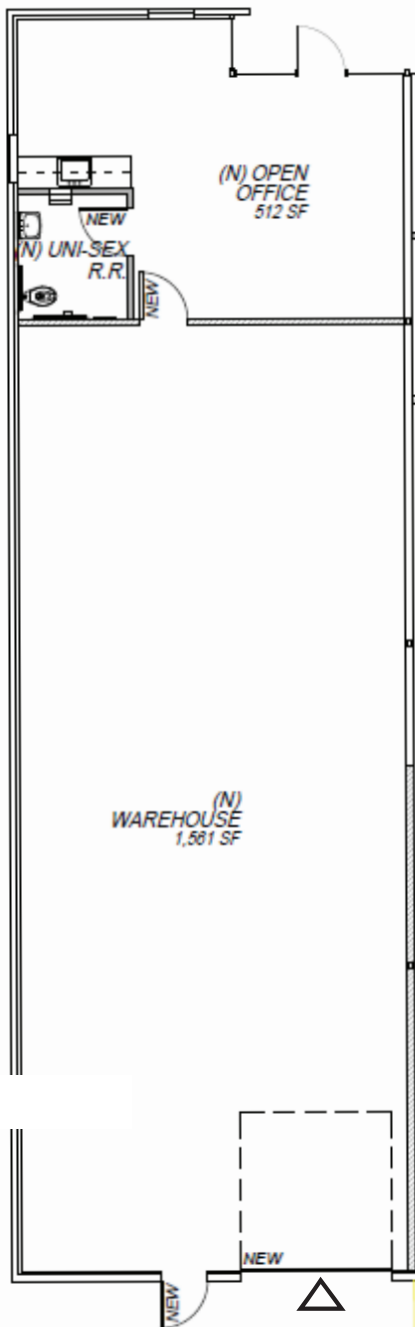

△ = Grade Door

OWNED & MANAGED BY:



**Columbia
Commercial**
Commercial Leasing | Sales | Property Management



WESTCORE

NOW AVAILABLE! BUILDING 4, SUITE 480

11900 NE 95th Street, Suite 480, Vancouver, WA 98682



LEASING CONTACTS

Coleman Brown, CCIM
Columbia Commercial, LLC
Coleman@CCPprop.com
360.952.4758

Dave Brown, CCIM, SIOR
Columbia Commercial, LLC
Dave@CCPprop.com
360.735.8001

paddencp.com

