

# MEDICAL SPACE FOR LEASE



## 199 S Addison Road, Wood Dale, IL



## 30,000 Square Foot Office Park

Fully built-out second-generation medical space w/ multiple offices (many w/ sinks), four ADA compliant restrooms, and reception.

All suites have independent control of their HVAC units. 60% RTUs new in 2026.

Abundant parking. New Lot Overlay in 2025.

Access to I-290 and Hwy 83.

### AVAILABLE

**Suite 108 - 4,275/sf**

\*Divisible to 3,050/sf

### PRICING

**\$16.00/sf  
Modified Gross**

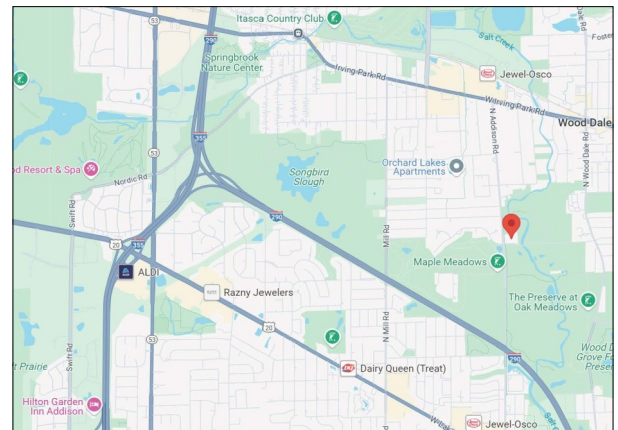

For More Information:

**Mark Levy**  
President/Managing Broker  
(630) 424-8902 x107  
mlevy@sequoiarg.com

**Shaunti Althoff**  
Property Manager/Broker  
(630) 424-8902 x105  
salthoff@sequoiarg.com

# MEDICAL SPACE FOR LEASE

199 S Addison Road, Wood Dale, IL



For More Information:

**Mark Levy**  
President/Managing Broker  
(630) 424-8902 x107  
mlevy@sequoiarg.com

**Shaunti Althoff**  
Property Manager/Broker  
(630) 424-8902 x105  
salthoff@sequoiarg.com