

# NOW LEASING



## 3017 DOUGLAS BLVD

ROSEVILLE,  
CA 95661

OLYMPUS CORPORATE CENTER  
CLASS A OFFICES  
HEART OF ROSEVILLE BUSINESS DISTRICT

**+/- 1,246 SF**



Jayna DeSoiza Byrnes | 916.638.3890 | [jayna@kcmre.com](mailto:jayna@kcmre.com)  
CA DRE #01941191

Brian Rabe | 916.601.0578 | [brabe@kcmre.com](mailto:brabe@kcmre.com)  
CA DRE #01743359

# 3017 DOUGLAS BLVD

OFFICE SUITES | FOR LEASE

INTERIOR  
PHOTOS



## BUILDING DETAILS & HIGHLIGHTS



GRAND LOBBY  
VISIBLE FROM DOUGLAS BLVD  
GYM ACCESS  
LARGE COURTYARD

# 3017 DOUGLAS BLVD

OFFICE SUITES | FOR LEASE

# FULLY LEASED 1ST FLOOR

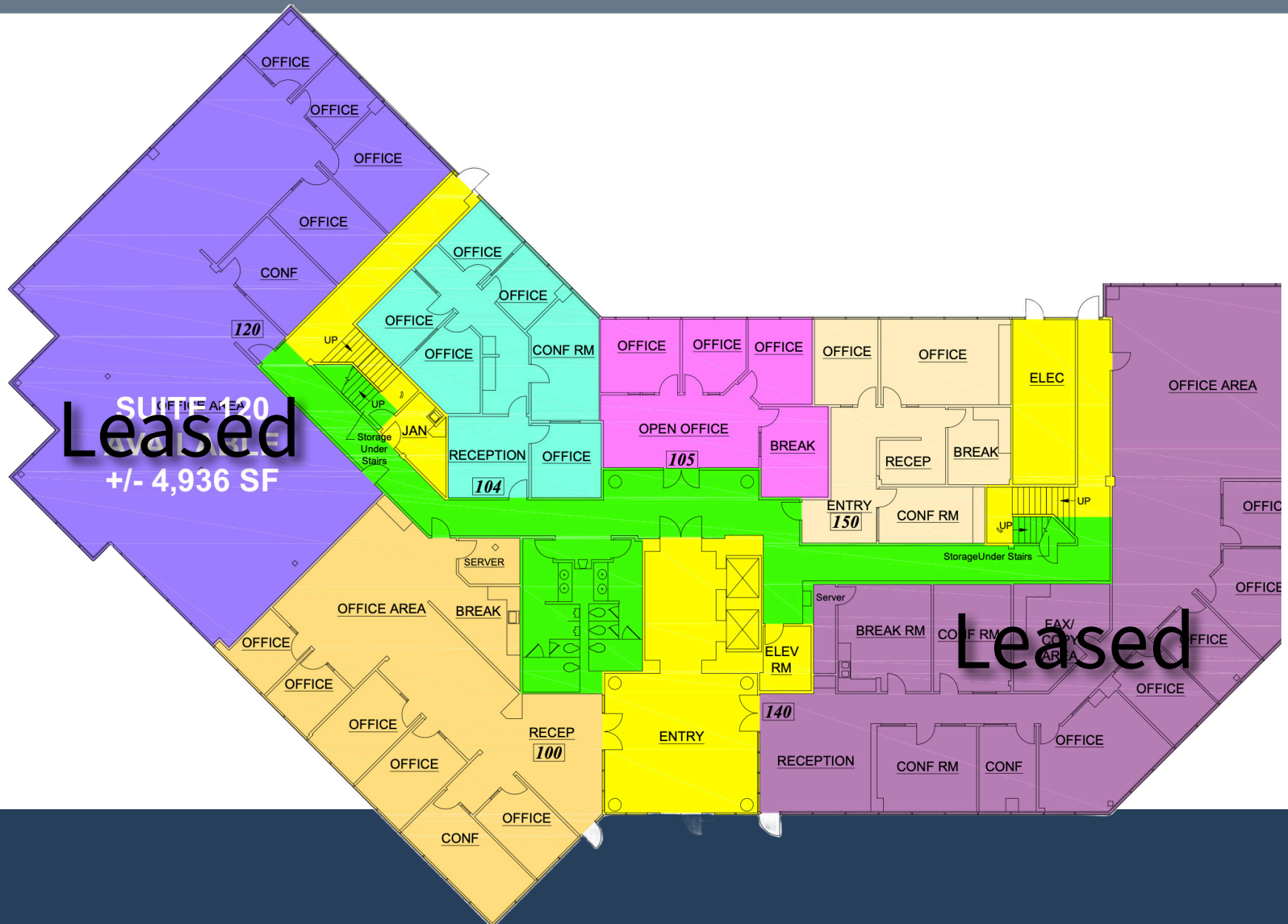

\*not to scale

# 3017 DOUGLAS BLVD

OFFICE SUITES | FOR LEASE

## SUITE 220 2ND FLOOR

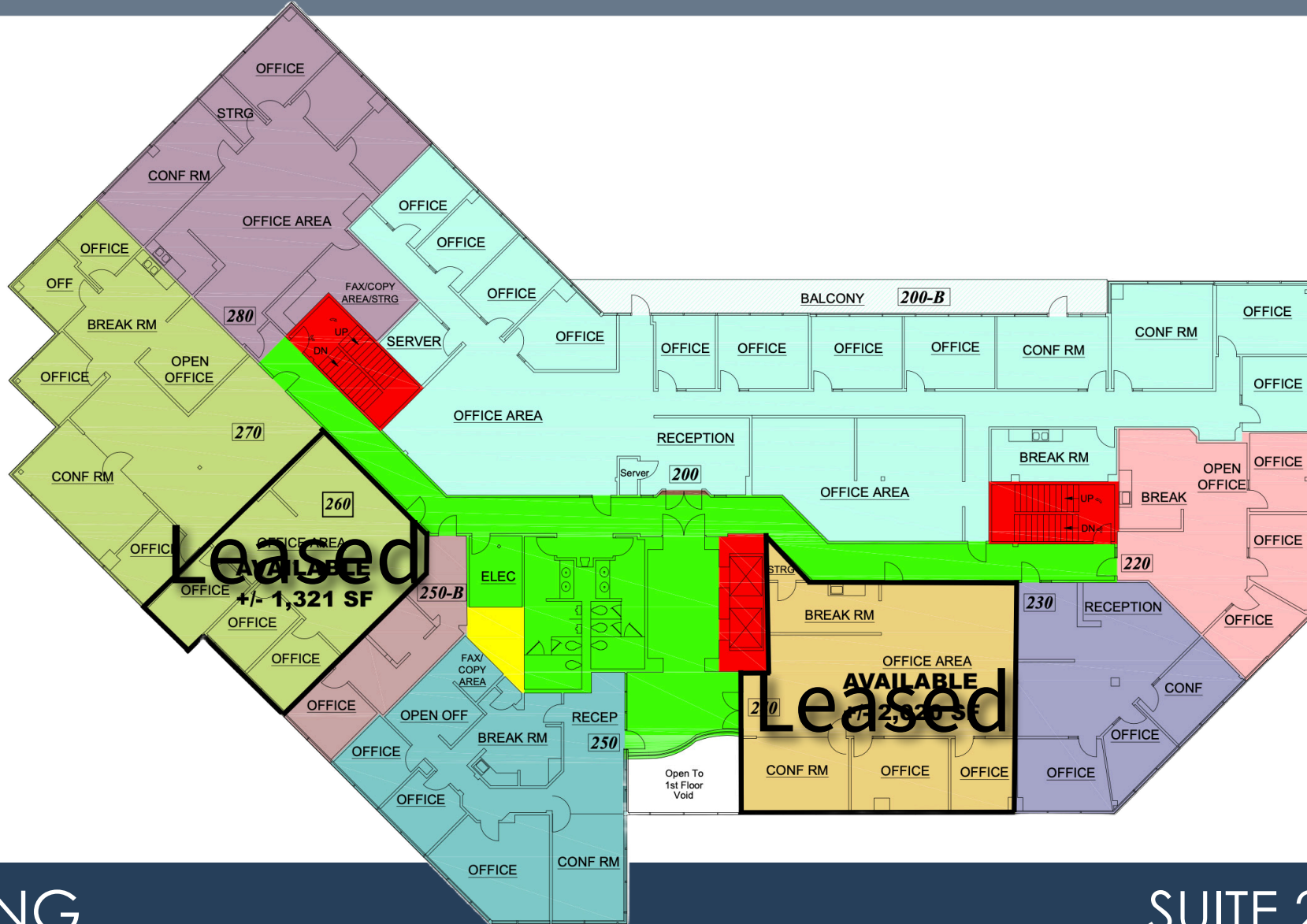

**ASKING**  
\$2.20/SF FSG

**SUITE 220**  
1246 RSF

# 3017 DOUGLAS BLVD

OFFICE SUITES | FOR LEASE

SUITE 220  
3D PLANS

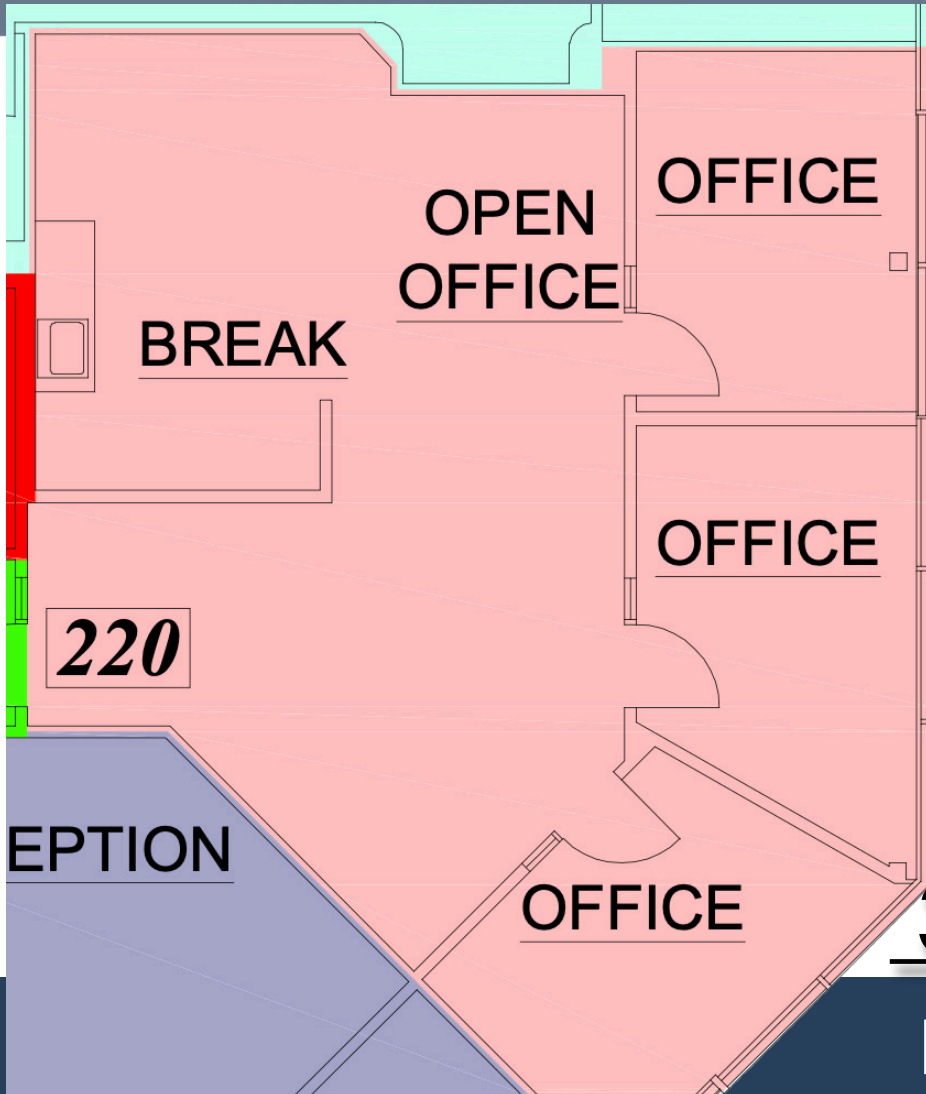

3D TOUR COMING SOON

**SUITE DETAILS &  
HIGHLIGHTS**

**PERFECT FOR SMALL BUSINESSES  
THREE PRIVATE OFFICES  
BREAKROOM & OPEN WORKSPACE**

# 3017 DOUGLAS BLVD

OFFICE SUITES | FOR LEASE

# PARKING OVERVIEW



## AMPLE PARKING WITH SECURITY

# 3017 DOUGLAS BLVD

OFFICE SUITES | FOR LEASE

BUSINESS PARK  
FRONT VIEW



## HIGHLIGHTS

UPSCALE BUSINESS PARK PROFESSIONALLY MANAGED  
HIGHLY DESIRABLE LOCATION  
DOUGLAS | SIERRA COLLEGE  
ROSEVILLE PKWY

# 3017 DOUGLAS BLVD

OFFICE SUITES | FOR LEASE

# BUSINESS PARK OVERVIEW



# 3017 DOUGLAS BLVD LOCATION AERIAL

OFFICE SPACE | FOR LEASE



## Retail & Shopping

Westfield Galleria,  
The Fountains at Roseville



## Dining

Paul Martin's, Mikuni, local café,  
fast-casual options nearby



## Parks & Recreation

Maidu Regional Park  
Mahany Park, Topgolf



## Health Care Providers

Sutter, Kaiser, Dignity Health



## Transit & Access

Immediate access to I-80,