



WALMART PLAZA

1065 Central Ave. (Route 201)
Greenwood (NS) B0P 1N0

± 25k Trade area population

115,000 sq. ft.

11 stores

958 parking spaces

The village serves as the commercial hub of the Annapolis Valley. The plaza is located at the corner of Rocknotch Road, Exit 17 off Highway 101. Vacant land (85,000 sq. ft.) is available for development. The plaza is attached to the Greenwood Mall.

NOVA SCOTIA



WALMART PLAZA

	STORE LIST	SQ. FT.
1	ATLANTIC FABRICS	8,000
2	AVAILABLE	4,095
6	CHINA VILLAGE RESTAURANT	3,151
7	YAME SUSHI	1,596
8	VOGUE OPTICAL	1,550
8.1	LIKED ITEMS BUY AND SELL	2,193
9	DOOLY'S	4,595
10	DOLLARAMA	14,138
14	THE BANK OF NOVA SCOTIA	3,972
15	ADMINISTRATION	1,090
100	WALMART	70,805
	GROSS LEASABLE AREA	115,185

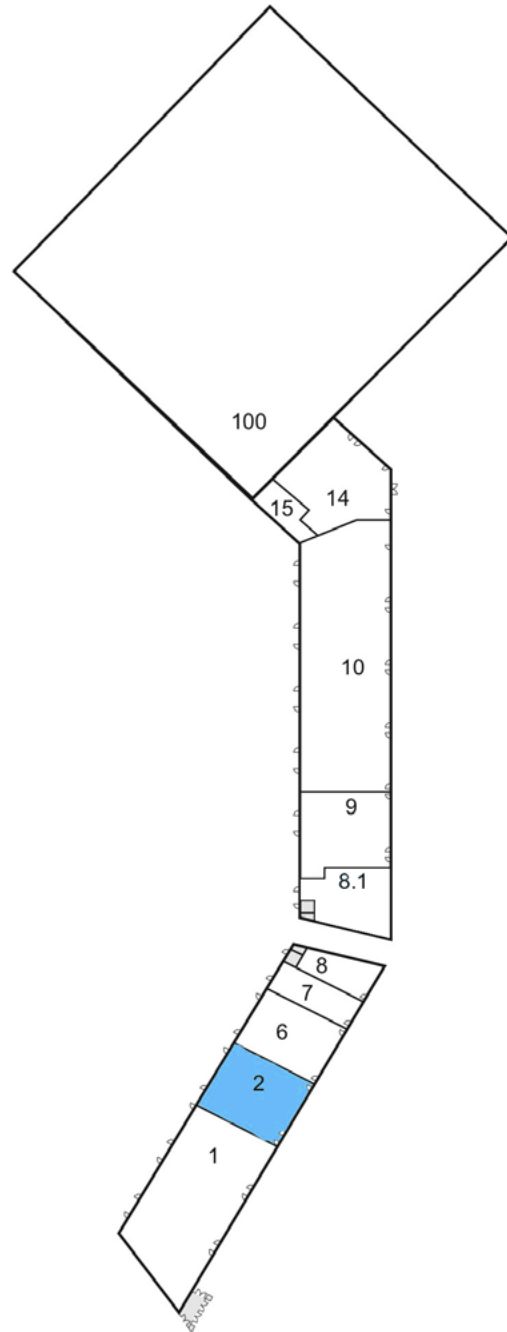

Howard Wiseman
President and COO
(514) 516-1345
howard@emrealestate.ca

Kyle Wiseman
Leasing Specialist
(514) 566-3879
kyle@emrealestate.ca

Wanda Pittman
Director of Real Estate – Atlantic Canada
(709) 571-3276
wanda@emrealestate.ca