

For Sale \pm 12,000 SF

Retail – Showroom – Industrial – Flex

8351 Katella Ave | Stanton, CA | 90680

PGi



KATELLA AVE ADT 26,000+ CARS PER DAY



Exclusively
Listed

- **Steve A. Abraham**
- Broker
- 949.673.5700
- steve@pgire.com
- **DRE LIC # 00873105**

PROPERTY OVERVIEW

SALE PRICE \$3,650,000
PRICE / SF \$304 PSF

TOTAL BUILDING SF ± 12,000
LOT SIZE (SF/AC) ± 29,182 / 0.67
WAREHOUSE SF ± 8,771
SHOWROOM SF ± 3,229
CLEAR HEIGHT 16' Min (18' most areas)
3 GRD LEVEL DOORS 1 @ Front of Bldg. 16' W x 8' H
 2 @ Rear of Bldg. 12' W x 12' H
YEAR BUILT 2078
YEAR RENOVATED 2017
PARKING 2.5:1000 (30 Spaces)
GAS STUBBED & AVAILABLE
POWER 400a / 480v / 3 phase / 3 wire

The above information was obtained from reliable sources but is not guaranteed.



ALLOWABLE USES

Full Zoning

ZONING: IG – Permitted Uses

Agricultural

- Hydroponics

Recreation

- Adult-Oriented Business

Industry, Manufacturing & Warehousing

- Accessory Industrial-Supporting Sales & Services
- Construction Contractor Base
- Laboratory
- Maintenance/Repair Client-Site Services
- Manufacturing/Processing Light & Medium Intensity
- Personal Storage Facility
- Printing Publishing
- Collection Facility
- Research & Development

Retail Trade Uses

- Accessory Retail Sales and Services
- Building/Landscape Materials Sales

Service Uses

- Veterinarian
- Equipment Rental, Repairs & Sales
- Funeral Home, Mortuary (Crematorium with CUP)





SITE PLAN - 8351 Katella Ave Stanton, CA | 90680

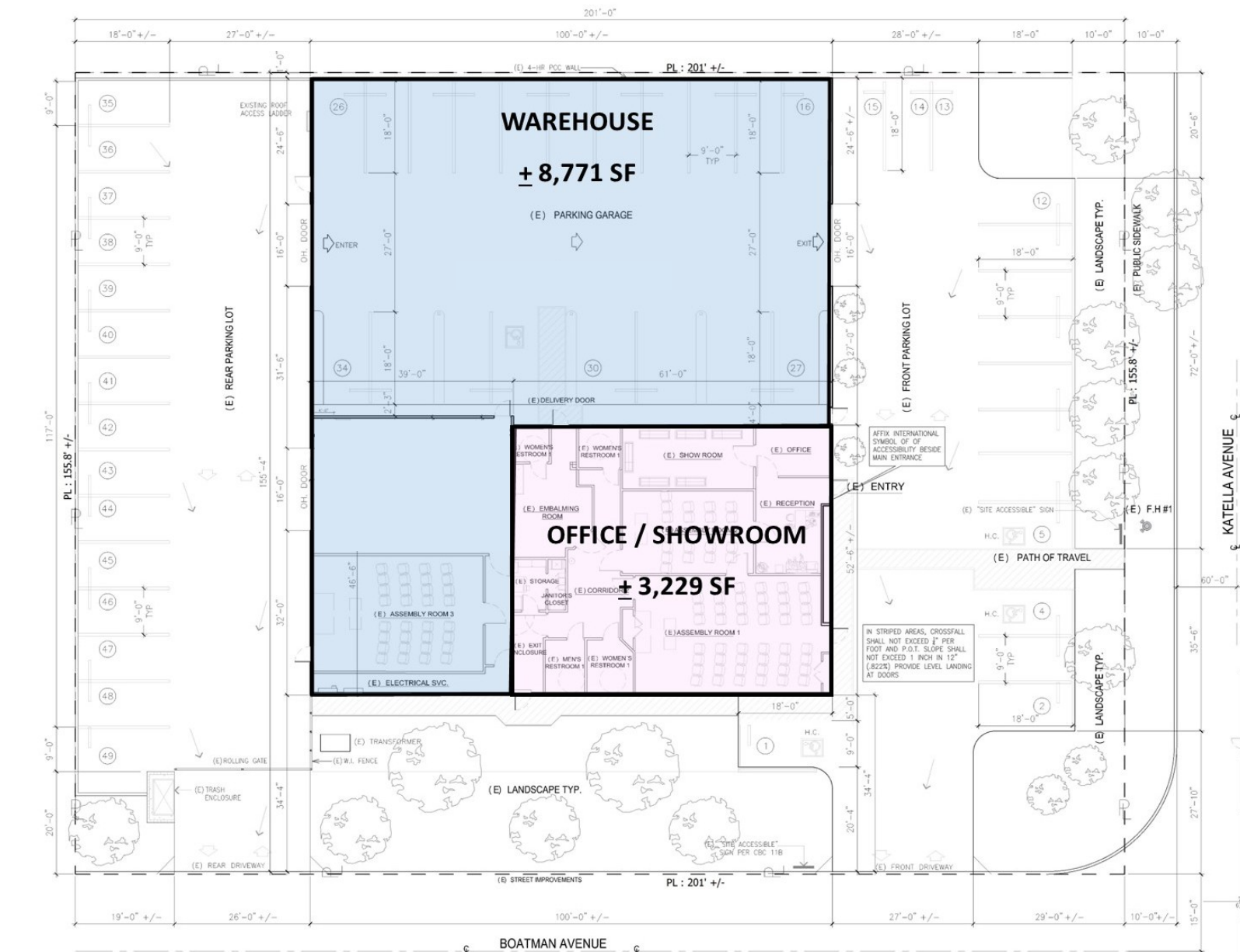

The logo for PGi, featuring the letters 'PGi' in a white serif font on a black square background. The 'i' has a small globe icon as its dot.

EXCLUSIVELY LISTED BY

- **Steve A. Abraham**
- Broker
- 949.673.5700
- steve@pgire.com
- **DRE LIC # 00873105**

