

**FOR LEASE | OFFICE / RETAIL**

## **Evergreen Plaza**

2547 State Hwy 35 | Luck, Wisconsin 54853



Conveniently located on State Highway 35 and State Highway 48, Evergreen Plaza is a retail and office space with high visibility and ample parking. It offers flexible plug and play office(s) and retail spaces.

### **Property Features**

- Highly visible location along State Highway 35
- Large suite with multiple office spaces and / or single offices
- 1,700 - 3,000 square feet available

### **Contact Us**

ERIC DUEHOLM  
Partner

651.621.2550  
[eric@terracegroupllc.com](mailto:eric@terracegroupllc.com)

Full Property Information at:  
[evergreen35.com](http://evergreen35.com)

**FOR SALE or LEASE | OFFICE / RETAIL**

**Evergreen Plaza**

2547 State Hwy 35 | Luck, Wisconsin 54853



## Property Overview

- Offices
- Large multi-office - 3,000 SF
  - 2 small office areas can be leased separately
- Retail / Potential office
- Ample parking
- \$12.00 PSF Net Rental Rate
- \$1.85 PSF Tax and CAM

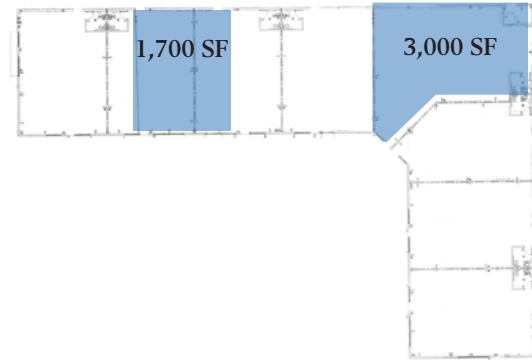

ERIC DUEHOLM  
Partner  
651.621.2550  
[eric@terracegroupllc.com](mailto:eric@terracegroupllc.com)

Full Property Information at:  
[evergreen35.com](http://evergreen35.com)

**FOR SALE or LEASE | OFFICE / RETAIL**  
**Evergreen Plaza**  
2547 State Hwy 35 | Luck, Wisconsin 54853



**Office Spaces** - 3,000 SF - Estimated initial monthly rent of \$3,460



Front entrance view - multi-office on the left with office with reception area on the right



Reverse front entrance view - small, single office with window and glass door bringing in plenty of natural light



Office with reception area - reception to office



Office with reception area - office to reception

ERIC DUEHOLM  
Partner  
651.621.2550  
[eric@terracegroupllc.com](mailto:eric@terracegroupllc.com)

**Full Property Information at:**  
**[evergreen35.com](http://evergreen35.com)**

**FOR SALE or LEASE | OFFICE / RETAIL**  
**Evergreen Plaza**  
2547 State Hwy 35 | Luck, Wisconsin 54853



Reception and open cubicle work spaces



Reception with view to conference room



Conference room / break area



One of two private offices



2nd of two private offices



Shared restroom

ERIC DUEHOLM  
Partner  
651.621.2550  
[eric@terracegroupllc.com](mailto:eric@terracegroupllc.com)

**Full Property Information at:**  
**[evergreen35.com](http://evergreen35.com)**

**FOR SALE or LEASE | OFFICE / RETAIL**  
**Evergreen Plaza**  
2547 State Hwy 35 | Luck, Wisconsin 54853

## Retail or Potential Office Space

- 1,700 square feet
- Initial estimated monthly rent of \$1,960
- Landlord will construct a new restroom as part of the lease



Plenty of natural light and storefront presence



Preexisting shelf walls



Storage room with wide door to back parking lot



Outside view

ERIC DUEHOLM  
Partner  
651.621.2550  
[eric@terracegroupllc.com](mailto:eric@terracegroupllc.com)

Full Property Information at:  
[evergreen35.com](http://evergreen35.com)

**FOR SALE or LEASE | OFFICE / RETAIL**  
**Evergreen Plaza**  
2547 State Hwy 35 | Luck, Wisconsin 54853



*Information is deemed reliable; however, no warranty or representation is made as to its accuracy or completeness. Property is subject to price change, prior sale or lease, and withdrawal from the market, all without notice.*

ERIC DUEHOLM  
Partner  
651.621.2550  
[eric@terracegroupllc.com](mailto:eric@terracegroupllc.com)

Full Property Information at:  
[evergreen35.com](http://evergreen35.com)