

For Sale

Class A Office Building on Kietzke Ln.

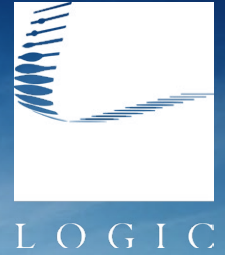

[Click for a Virtual Tour](#) 

5441 Kietzke Ln.
Reno, NV 89511

Michael Keating, SIOR
Partner
775.386.9727
mkeating@logicCRE.com
S.0174942

Michael Dorn
Vice President
775.453.4436
mdorn@logicCRE.com
S.0189635

Listing Snapshot



Contact Broker
Sale Price



± 66,291 SF
Total Square Footage



Class-A Office
Building Type

Property Highlights

- Class-A office turn-key building
- Anticipated \$1MM Exterior and interior renovations in 2026
- Close proximity to amenities including The Village at Rancharrah
- Easy access from S. Virginia St. & Interstate 580
- Covered parking available
- Building signage
- Balconies with views
- Walking distance from Anderson park & walking trails
- Owner-user opportunity
- Income through July 2026 - Contact broker for details

Demographics

	1-mile	3-mile	5-mile
2025 Population	4,730	68,672	162,021
2025 Average Household Income	\$115,271	\$109,067	\$129,325
2025 Total Households	2,197	29,964	71,800





Downtown Reno



Floor Plan | First Floor | Suite 100 & 150

Subject Common Area

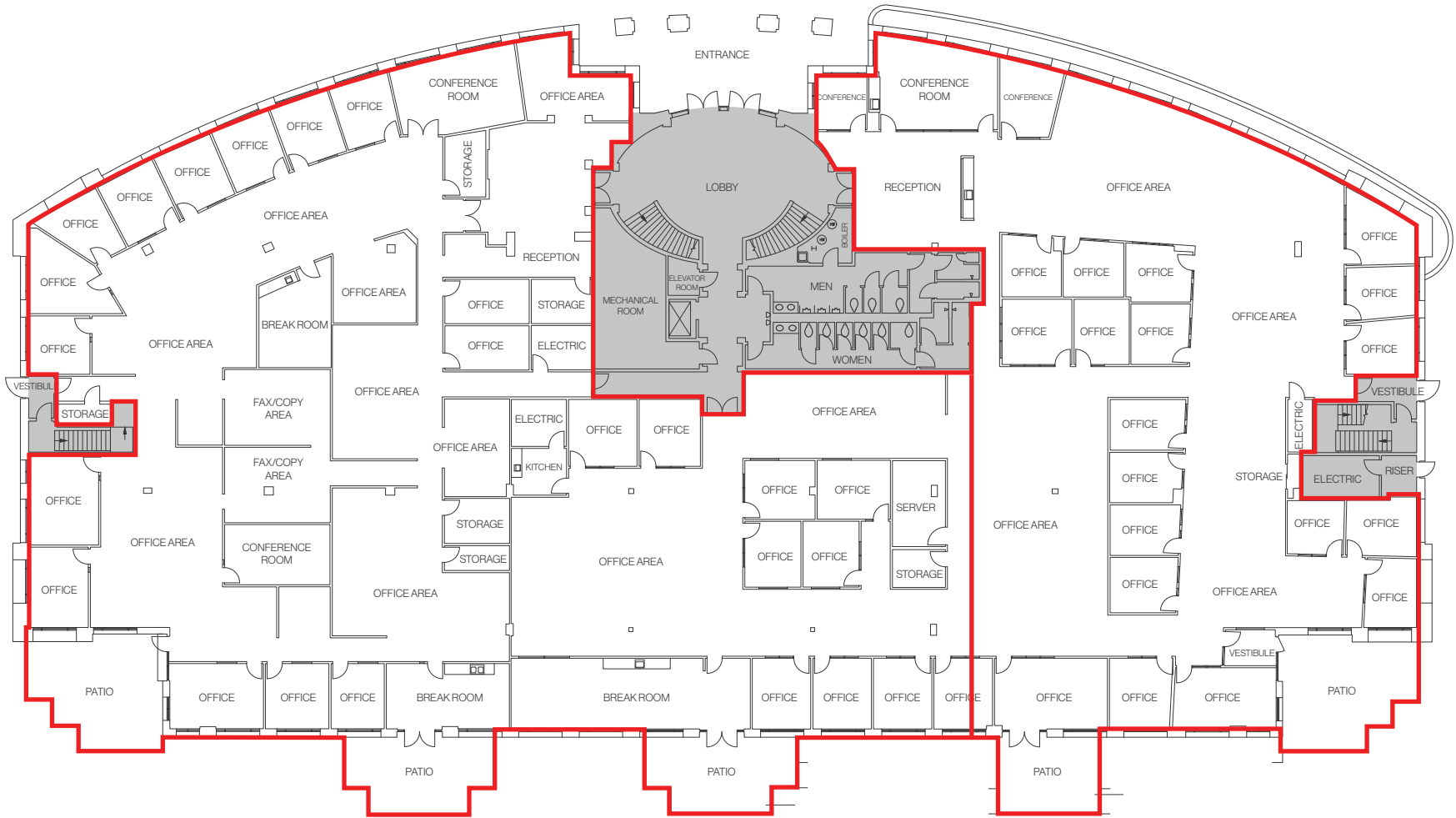

Floor Plan | Second Floor | Suite 200

Subject Common Area

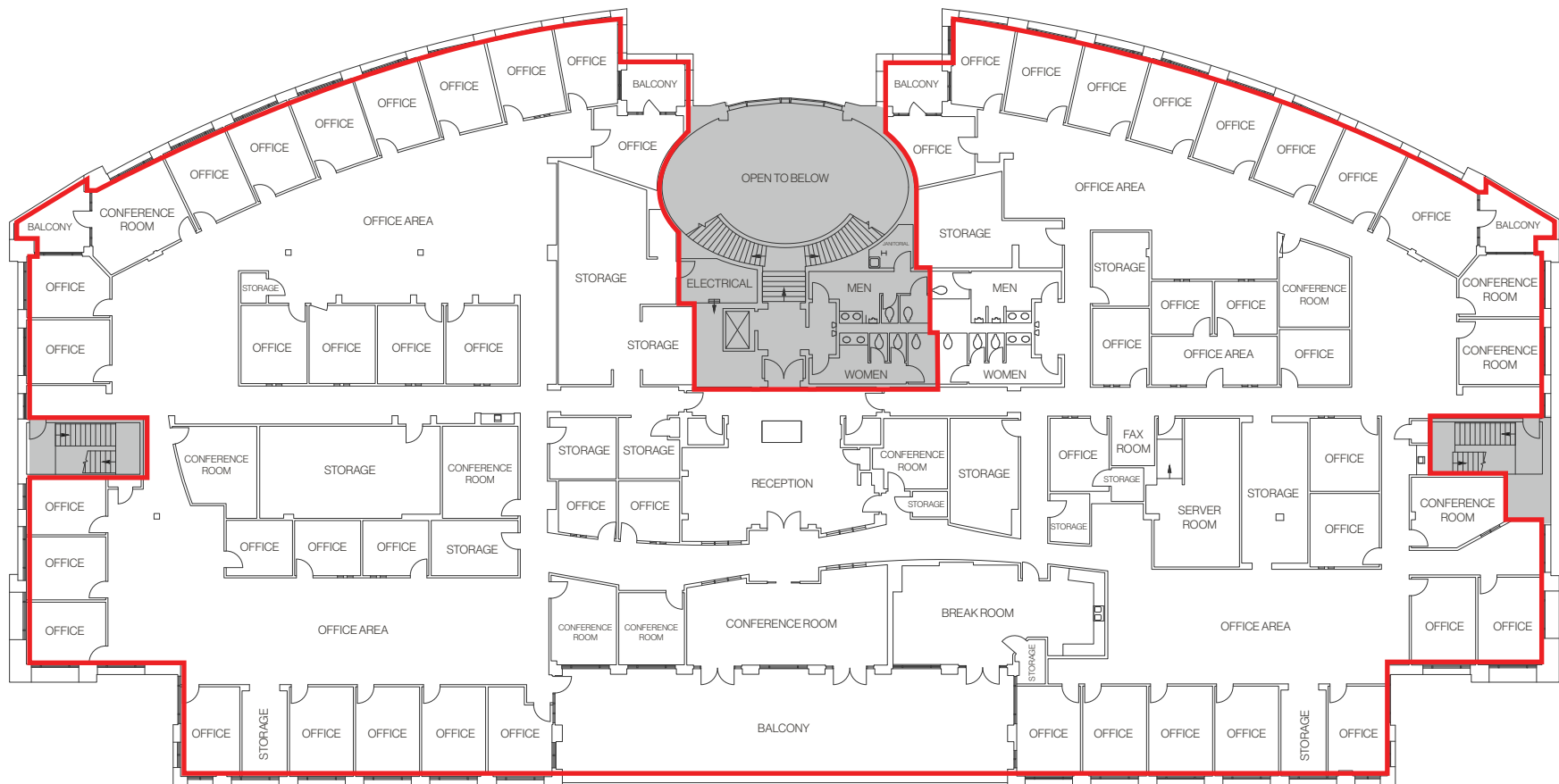

Property Photos



Property Photos | Interior



LOGIC Commercial Real Estate

Specializing in Brokerage and Receivership Services

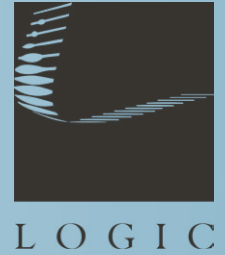

Join our email list and
connect with us on LinkedIn

The information herein was obtained from sources deemed reliable; however LOGIC Commercial Real Estate makes no guarantees, warranties or representation as to the completeness or accuracy thereof.

For inquiries please reach out to our team.

Michael Keating, SIOR

Partner
775.386.9727
mkeating@logicCRE.com
S.0174942

Michael Dorn

Vice President
775.453.4436
mdorn@logicCRE.com
S.0189635