

# ROUTE 924 & SCOTCH PINE DRIVE HUMBOLDT IND. PARK HAZLETON, PA



**8.18 ACRES OF LAND AVAILABLE AT SIGNALIZED INTERSECTION**  
***WILL SUBDIVIDE, UP-TO 3 PARCELS | 4 MINUTES TO I-81***

# ROUTE 924 & SCOTCH PINE DRIVE

## HUMBOLDT IND. PARK HAZLETON, PA

**8.18 ACRES AVAILABLE**

**WILL SUBDIVIDE, UP-TO 3 PARCELS**

### PERMITTED USES

#### RETAIL BUSINESS

- Supplies
- Automotive Supplies
- Building, Lumber or Plumber Supplies
- Commercial Greenhouses, Nurseries & Garden Shops
- Convenience Shops
- Convenience Shops with Gas Sales
- Electronic Equipment and Products
- Equipment Sales & Repair
- Florist Shops
- Food/Grocery
- Greeting Cards,
- Hardware
- Household Goods & Appliances
- Office Equipment & Supplies
- Pet Stores
- Pharmaceutical Products

- Retail Sales
- Sporting Goods
- Variety Goods
- Wholesale Goods

#### SERVICE-ORIENTED BUSINESS

- Animal Hospital/Veterinarian Clinic
- Banks
- Car Washes
- Child Care Centers
- Day Care Centers
- Gasoline Service Stations
- Health Clubs
- Medical Marijuana Dispensary
- Medial Offices
- Motels & Hotels
- Nursing Homes
- Personal Care Homes

- Personal Services
- Professional Offices
- Repair Garages
- Restaurants
- Self-Storage Facilities

#### RECREATION & ENTERTAINMENT

- Commercial Recreational Facilities
- Recreational Facilities
- Theaters (Indoor)

#### RESIDENTIAL

- Apartments, Condominiums
- Accessory Uses to the Above

#### ACCESSORY USES TO ALL USES PERMITTED BY RIGHT

- Minor Solar Energy System

#### USES PERMITTED BY SPECIAL EXCEPTION ZONING HEARING BOARD APPROVAL REQUIRED

- Bulk Fuel Storage
- Contractors Yards
- Entertainment Facilities
- Machine Shops
- Turbine
- Medical Clinics
- Multifamily Dwellings
- Outdoor Storage
- Printing, Lithographing or Publishing Plants
- Tire Retreading & Recapping
- Trucking Facilities & Terminals
- Trucking Warehouse
- Accessory Uses to Above

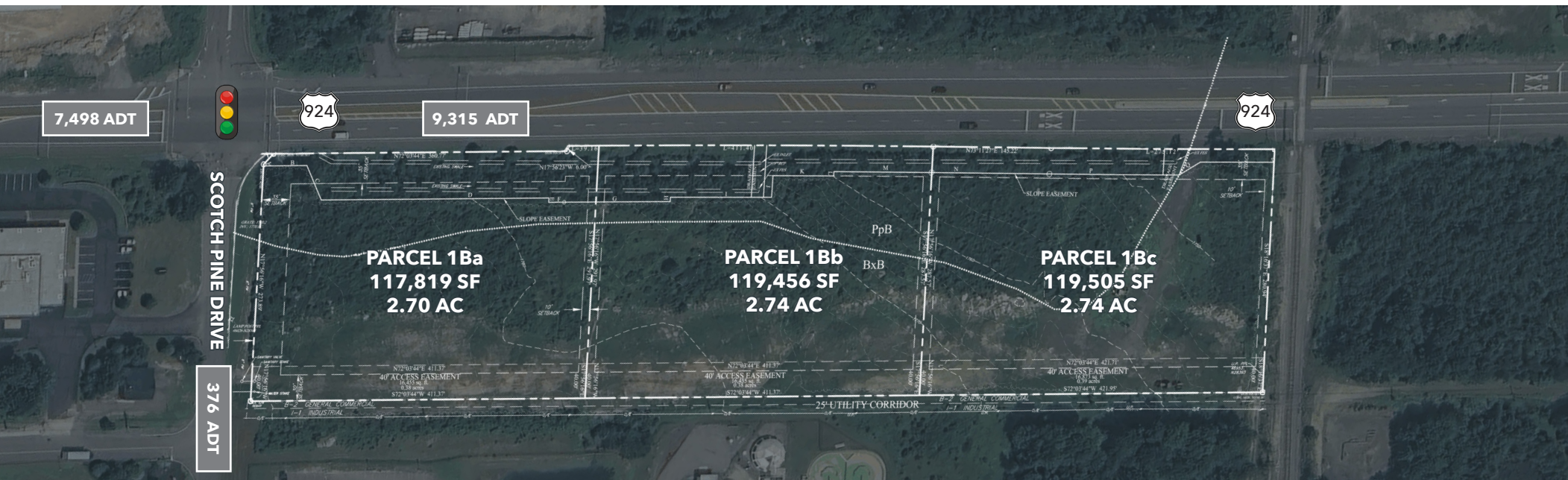

# ROUTE 924 & SCOTCH PINE DRIVE

## HUMBOLDT IND. PARK HAZLETON, PA

**8.18 ACRES AVAILABLE**  
**WILL SUBDIVIDE, UP-TO 3 PARCELS**

### CONCEPTUAL SITE PLAN ALTERNATIVES



### ADDITIONAL TRAFFIC COUNTS



**DEMOGRAPHICS**

**WORKFORCE**

	3 Miles	5 Miles	7 Miles
ESTIMATED TOTAL EMPLOYEES (2025)	4,370	18,402	22,731

**POPULATION**

	5 Miles	7 Miles
ESTIMATED POPULATION (2025)	47,117	63,158
HISTORICAL ANNUAL GROWTH (2020 - 2025)	1,649 (0.7%)	1,630 (0.5%)

**HOUSEHOLDS**

	5 Miles	7 Miles
ESTIMATED HOUSEHOLDS (2025)	17,805	24,341
PROJECTED ANNUAL GROWTH (2025 - 2030)	169 (0.2%)	265 (0.2%)

**HOUSEHOLD TYPES**

	5 Miles	7 Miles
HOUSEHOLDS WITH CHILDREN	6,784 (38.1%)	8,574 (35.2%)
AVERAGE HOUSEHOLD SIZE	2.6	2.6

**MEDIAN HOUSEHOLD INCOME**

	5 Miles	7 Miles
ESTIMATED MEDIAN HOUSEHOLD INCOME (2025)	\$52,892	\$57,136

**HOUSEHOLD INCOME DISTRIBUTION (2025)**

	5 Miles	7 Miles
HH INCOME \$200,000 OR MORE	617 (3.5 %)	938 (3.9%)
HH INCOME \$150,000 TO \$199,999	782 (4.4%)	1,229 (5.0%)
HH INCOME \$125,000 TO \$149,999	985 (5.5%)	1,428 (5.9%)
HH INCOME \$100,000 TO \$124,999	1,478 (8.3%)	2,103 (8.6%)
HH INCOME \$75,000 TO \$99,999	1,918 (10.8%)	2,947 (12.1%)
HH INCOME \$50,000 TO \$74,999	3,230 (18.1%)	4,415 (18.1%)
HH INCOME \$35,000 TO \$49,999	2,431 (13.7%)	3,060 (12.6%)
HH INCOME \$25,000 TO 34,999	1,780 (10.0%)	2,403 (9.9%)
HH INCOME \$15,000 TO 24,999	1,731 (9.7%)	2,255 (9.3%)
HH INCOME \$10,000 TO 14,999	1,185 (6.7%)	1,505 (6.2%)
HH INCOME UNDER \$10,000	1,670 (9.4%)	2,057 (8.4%)

**TOTAL AGE DISTRIBUTION (2025)**

	5 Miles	7 Miles
AGE UP TO 19 YEARS	12,205 (25.9%)	15,834 (25.1%)
AGE 20 TO 29	6,796 (14.4%)	8,528 (13.5%)
AGE 30 TO 39	6,639 (14.1%)	8,611 (13.6%)
AGE 40 TO 49	5,678 (12.0%)	7,475 (11.8%)
AGE 50 TO 59	5,794 (12.3%)	7,962 (12.6%)
AGE 60 TO 69	4,858 (10.3%)	7,099 (11.3%)
AGE 70 TO 79	3,534 (7.5%)	5,166 (8.2%)
AGE 80 AND OLDER	1,613 (3.4%)	2,482 (4.0%)

\*Results reflect consolidated age demographics.

**EDUCATION ATTAINMENT (2025)**

	5 Miles	7 Miles
ELEMENTARY (GRADE LEVEL 0 TO 8)	3,081 (9.8%)	3,662 (8.5%)
SOME HIGH SCHOOL (GRADE 9 TO 11)	2,746 (8.7%)	3,367 (7.8%)
HIGH SCHOOL GRADUATE	12,305 (39.0%)	17,049 (39.6%)
SOME COLLEGE	4,585 (14.5%)	6,667 (15.5%)
ASSOCIATE DEGREE ONLY	3,223 (10.2%)	4,640 (10.8%)
BACHELOR DEGREE ONLY	3,241 (10.3%)	4,441 (10.3%)
GRADUATE DEGREE	2,349 (7.4%)	3,257 (7.6%)

**TRAVEL TIME(2025)**

	5 Miles	7 Miles
WORKER BASE AGE 16 YEARS OR OVER	20,986	28,081
TRAVEL TO WORK IN 14 MINUTES OR LESS	6,997 (33.3%)	8,710 (31.0%)
TRAVEL TO WORK IN 15 TO 29 MINUTES	8,458 (40.3%)	11,381 (40.5%)
TRAVEL TO WORK IN 30 TO 59 MINUTES	3,748 (17.9%)	5,210 (18.6%)
TRAVEL TO WORK IN 60 MINUTES OR MORE	901 (4.3%)	1,328 (4.7%)
WORK AT HOME	880 (4.2%)	1,452 (5.2%)
AVERAGE MINUTES TRAVEL TO WORK	18.2	18.9



**MATT MACDONALD**  
 matt.macdonald@lee-associates.com  
 610.238.8118

**ERIN DOWNEY, CCIM**  
 edowney@lee-associates.com  
 717.237.1188

**LEE & ASSOCIATES**  
 COMMERCIAL REAL ESTATE SERVICES

All information furnished regarding property for sale, rental or financing is from sources deemed reliable, but no warranty or representation is made to the accuracy thereof and same is submitted to errors, omissions, change of price, rental or other conditions prior to sale, lease or financing or withdrawal without notice. No liability of any kind is to be imposed on the broker herein.

Lee & Associates of Eastern Pennsylvania LLC  
 610 Germantown Pike, Suite 160, Plymouth Meeting, PA 19462 USA | (610) 400.0499 | lee-associates.com/easternpa