

The Langham Estate



Moray House, 23-35
Great Titchfield
Street, London,
W1W 7PA

FIRST FLOOR SOUTH
1,443 SQ FT | 134.06 SQ M
OFFICE TO LET



Langhamestate.com

020 7580 5656

Moray House, 23-35 Great Titchfield Street - First Floor South



Location

Moray House is located on the west side of Great Titchfield Street, between Little Portland Street and Mortimer Street, in the heart of vibrant Fitzrovia. Rich in history with a notable artistic and Bohemian heritage, today Fitzrovia is known to be a popular destination attracting fashion, medical, creative and media businesses and offers an ever-growing array of dining, shopping, fitness and leisure facilities.

The area has excellent transport links including 8 underground tube lines spread across 8 stations, as well as the Elizabeth Line.

Connectivity

Oxford Circus	3 mins walk
Goodge Street	6 mins walk
Tottenham Court Road	8 mins walk
Great Portland Street	9 mins walk

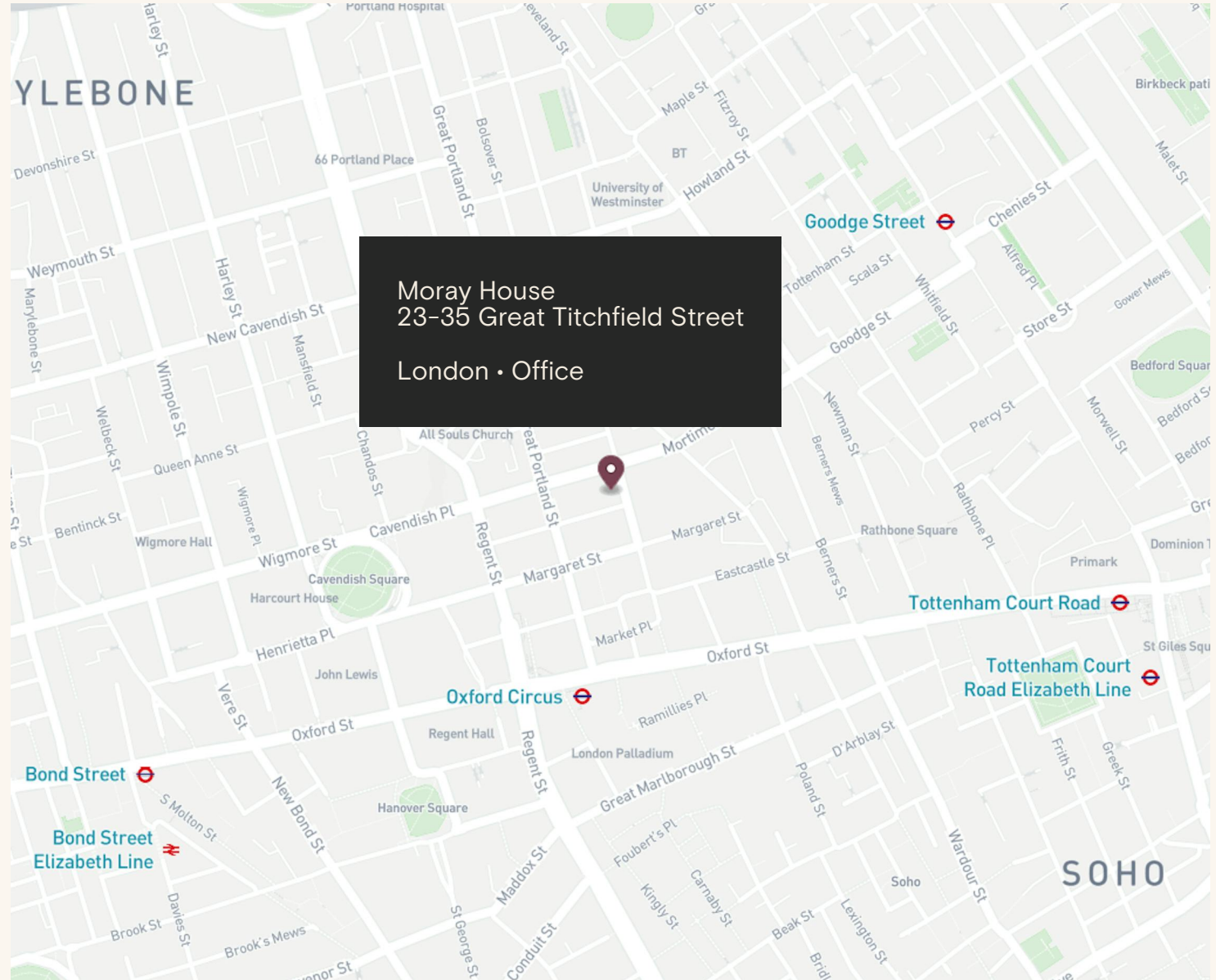

Moray House, 23-35 Great Titchfield Street - First Floor South



Open-plan office with great natural light, skylight and kitchenette in prime location





Moray House, 23-35 Great Titchfield Street - First Floor South



Moray House, 23-35 Great Titchfield Street - First Floor South



Moray House, 23-35 Great Titchfield Street - First Floor South



Features

- Good Ceiling Height
- Open Plan
- Excellent Transport Links
- Central Heating
- Wood Flooring
- Kitchenette
- Newly Refurbished
- Perimeter Trunking
- 24 Hour Access
- Skylight
- Secure Storage Space
- Phone Booth

Details

Floor Area

1,443 SQ FT / 134.06 SQ M

Rent

£70 per sq ft

Lease Terms

A new Full Repairing & Insuring Lease is available for a term by arrangement, outside the Landlord & Tenant Act 1954.

Possession

Immediate upon completion of legal formalities

Legal Costs

Each party to be responsible for their own legal costs

VAT

Pricing exclusive of V.A.T

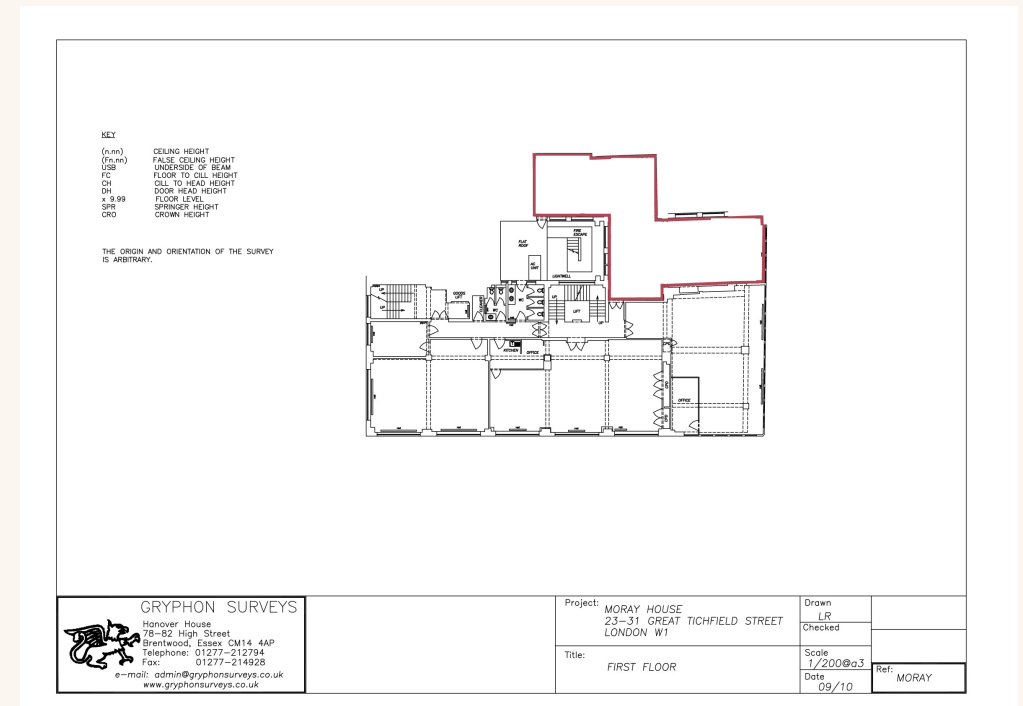



Name	sq ft	sq m	Availability
------	-------	------	--------------

1st - North	2,439	226.59	Available
-------------	-------	--------	-----------

1st - South	1,443	134.06	Available
-------------	-------	--------	-----------

Total	3,882	360.65	
--------------	--------------	---------------	--

Schedule of Areas





Sustainability



We aim to reach NET ZERO emissions by 2040 from our operations



100% Landlord Renewable Electricity



Zero waste to landfill in the building



Waste management initiative



We are Signatories of WCC Sustainable City Charter



LED Lighting



EPC Rating

FQ

Discover Fitzrovia Quarter



FITZROVIA QUARTER



Explore our neighbourhood

The Langham Estate

langhamestate.com

For further information call

020 7580 5656



Sabina Bathurst

sabina.bathurst@langhamestate.com

020 7907 4960

07355 603 106

Malcolm Cohen

malcolm.cohen@langhamestate.com

07526 189 462

020 7907 4983