

Available SF 10,800 SF Industrial For Lease Building Size 21,440 SF



Address: 1129 E 29th St, Los Angeles, CA 90011
Cross Streets: E 29th St/S Central Ave

Excellent Downtown Garment Facility
New Interior & Exterior Paint, New Office Carpeting
Newer Restrooms w/Ample Fixtures
200 Amps 3 Phase Available
Fenced Parking w/Automatic Gate

Lease Rate/Mo: \$7,776	Sprinklered: Yes	Office SF / #: 1,560 SF / 5
Lease Rate/SF: \$0.72	Clear Height: 12'	Restrooms: 2
Lease Type: Gross	GL Doors/Dim: 2 / 10'x10'	Office HVAC: None
Available SF: 10,800 SF	DH Doors/Dim: 0	Finished Ofc Mezz: 0 SF
Minimum SF: 10,800 SF	A: 200 V: 240 O: 1 W: 3	Include In Available: No
Prop Lot Size: POL	Construction Type: Masonry	Unfinished Mezz: 0 SF
Term: Acceptable to Owner	Const Status/Year Blt: Existing / 1927	Include In Available: No
Sale Price: NFS	Whse HVAC: No	Possession: Now
Sale Price/SF: NFS	Parking Spaces: 5 / Ratio: 0.5:1	Vacant: Yes
Taxes:	Rail Service: No	To Show: Call broker
Yard: Fenced / Paved	Specific Use: Warehouse/Office	Market/Submarket: CBD
Zoning: CM-1VL-CPIO		APN#: 5119-015-011
Listing Company: Sterling Industrial Realty, Inc		
Agents: Brad Harris 213-448-3313		
Listing #: 41869097	Listing Date: 02/04/2025	FTCF: CB250Y17S000
Notes: 200 amps 3 Phase power available. Lessee to independently verify all information stated herein. Contact Brad Harris 213-448-3313 bharris@sterlingprops.com to show.		

1129 E. 29th St., Los Angeles, CA 90011

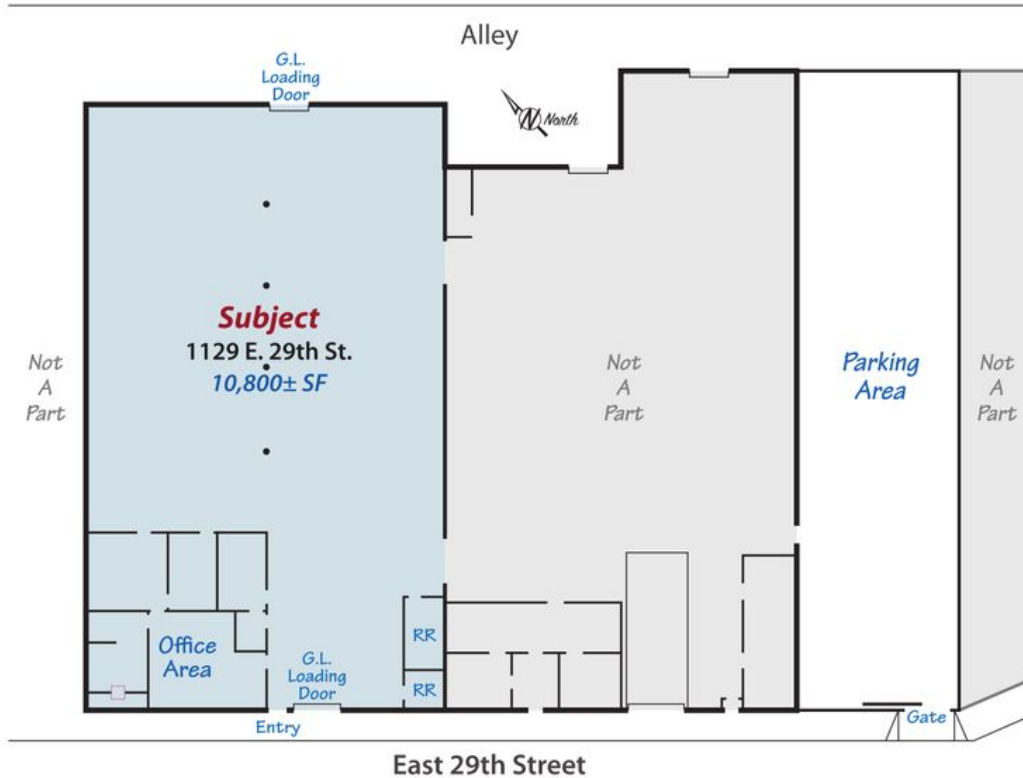

Contact Exclusive Agent:
Brad S. Harris
bharris@sterlingprops.com
Cell: 213-448-3313
213-483-3601
1625 W. Olympic Blvd.
Suite 735
Los Angeles, CA 90015

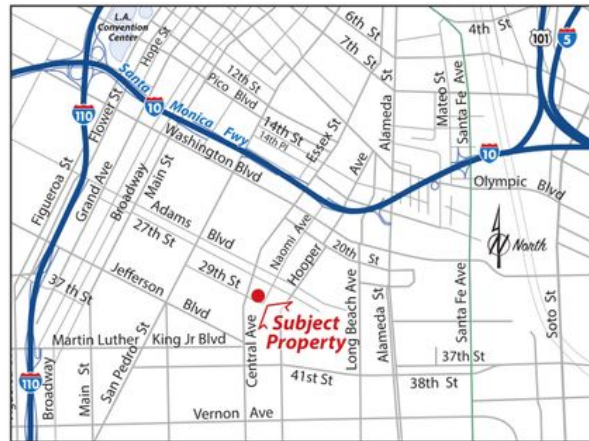

The information contained herein is from sources we believe to be reliable but, we do not guarantee its accuracy. All measurements & dimensions are approximations and are not to scale. Clients are encouraged to verify their accuracy.