

Industrial Space For Lease

808 S 26TH ST

Harrisburg, PA 17111

Presented By:

Ida McMurray, CCIM, SIOR

PRINCIPAL & SENIOR ADVISOR

imcmurray@capstonecre.co

O: 717.820.1127 X701

C: 717.443.5500



FOR LEASE | INDUSTRIAL

808 S 26th Street Harrisburg, PA 17111



PROPERTY DESCRIPTION

Opportunity to lease +/- 12,800 SF of warehouse space with private restrooms, dock access, and an additional +/- 2,000 SF of office buildout. Capital improvements include a new roof, new gas hung heaters, LED lighting and more. Great visibility along I-83 with quick access to the Capital Beltway highway network. Nearby connections include I-81, I-76 (PA Turnpike), Rt. 322 & Rt. 283.

PROPERTY HIGHLIGHTS

- +/- 12,800 SF available
- Dock access
- 14' clear
- Recent upgrades include LED lighting, roof top units and a new roof

OFFERING SUMMARY

Lease Rate:	\$6.95 SF/yr (Gross)
Building Size:	123,500 SF
Available Size:	+/- 14,800 SF
Lot Size:	5.88 Acres
Zoning:	Industrial
APN:	13-093-034



Ida McMurray, CCIM, SIOR

PRINCIPAL & SENIOR ADVISOR
imcmurray@capstonecre.co
O: 717.820.1127 X701
C: 717.443.5500

PROPERTY DETAILS

808 S. 26th Street Harrisburg, PA 17111

Lease Rate | CAM/Opex

\$6.95 SF/YR NNN GROSS

LOCATION INFORMATION

Street Address	808 S 26th St
City, State, Zip	Harrisburg, PA 17111
County	Dauphin
Nearest Highway	I-83
Nearest Airport	Harrisburg International Airport

PROPERTY INFORMATION

Property Type	Industrial
Zoning	Industrial
Lot Size	5.88 Acres
APN #	13-093-034
Lot Size	5.88 acres
Utilities	Water & Sewer: public Gas: available
Power	3 phase, 800 amp

BUILDING INFORMATION

Building Size	123,500 SF
Available Size	+/- 14,800 SF
Year Built	1954
Year Last Renovated	2022
Roof	Rubber
Construction Type	Masonry
Clear Height	14' clear
Walls	Block
Ceiling Type	Exposed
Lighting	LED
Restrooms	In common
Dock Access	Shared
Sprinklers	Wet
HVAC	Gas hung heaters
Additional Information	Outside storage available



Ida McMurray, CCIM, SIOR

PRINCIPAL & SENIOR ADVISOR

imcmurray@capstonecre.co

O: 717.820.1127 X701

C: 717.443.5500

FLOOR PLAN

808 S 26th Street Harrisburg, PA 17111

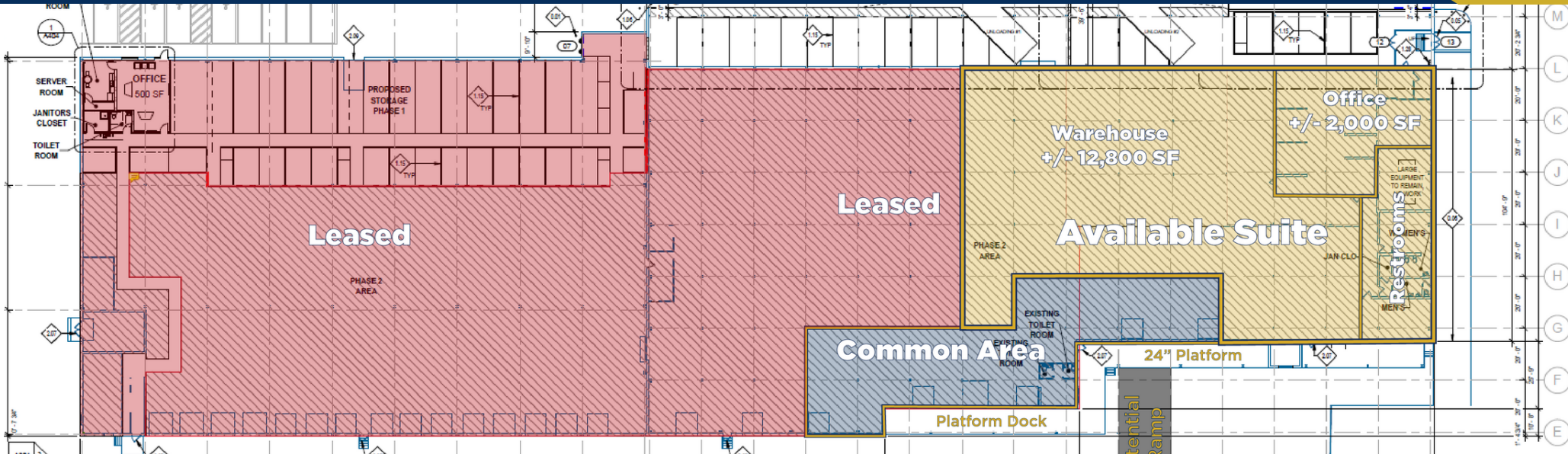

LEASE INFORMATION

Lease Type:	Gross	Lease Term:	Negotiable
Total Space:	20,400 SF	Lease Rate:	\$6.95 SF/yr

AVAILABLE SPACES



Ida McMurray, CCIM, SIOR

PRINCIPAL & SENIOR ADVISOR

imcmurray@capstonecre.co

O: 717.820.1127 X701

C: 717.443.5500

AREA MAP

808 S. 26th Street Harrisburg, PA 17111

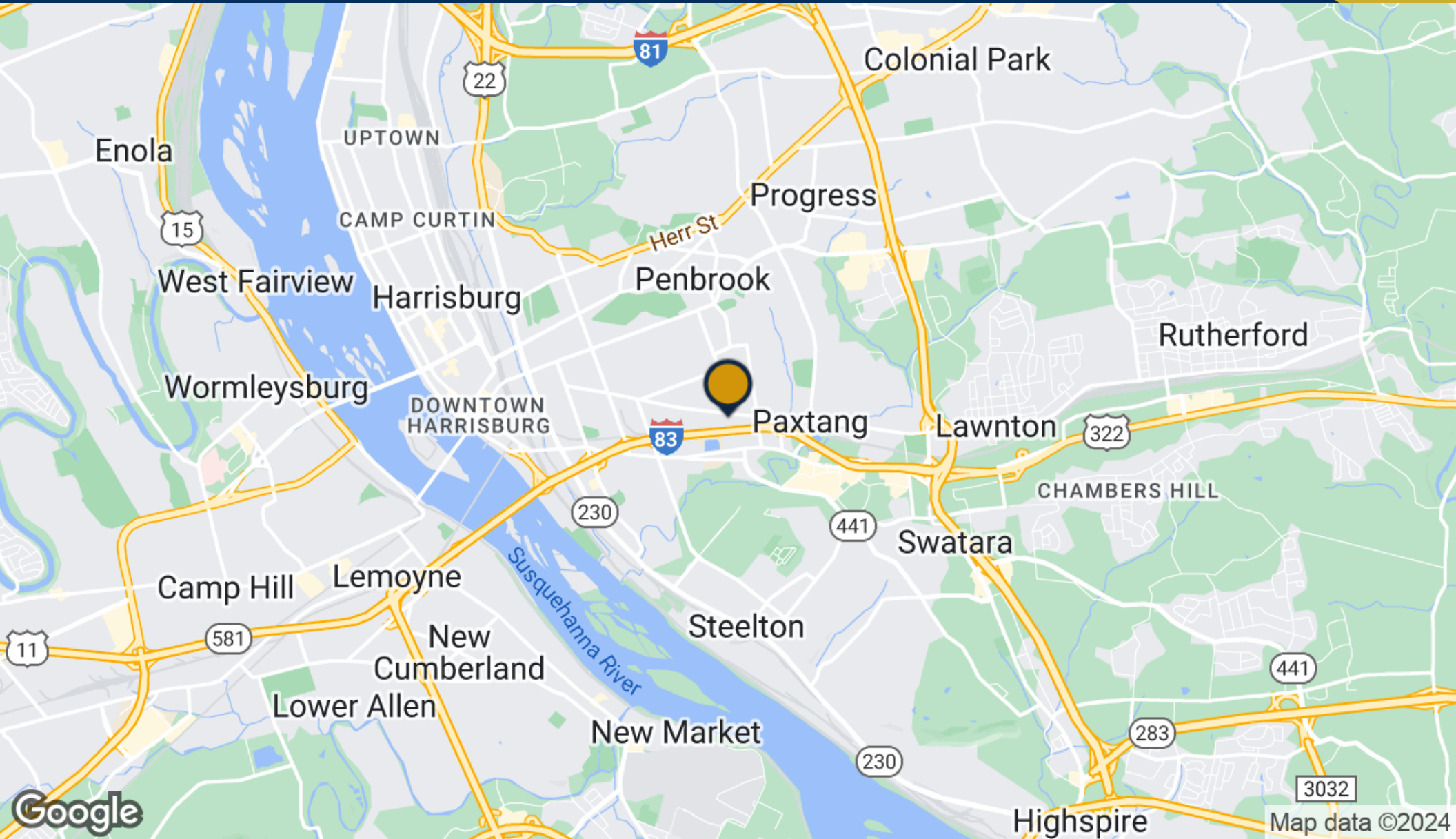

Ida McMurray, CCIM, SIOR

PRINCIPAL & SENIOR ADVISOR

imcmurray@capstonecre.co

O: 717.820.1127 X701

C: 717.443.5500

DEMOGRAPHICS

808 S. 26th Street Harrisburg, PA 17111

POPULATION

	1 MILE	3 MILES	5 MILES
Total Population	14,854	90,227	182,315
Average Age	34.3	35.3	37.6
Average Age (Male)	33.0	33.3	36.2
Average Age (Female)	36.6	37.8	39.0

HOUSEHOLDS & INCOME

	1 MILE	3 MILES	5 MILES
Total Households	6,277	42,806	83,525
# of Persons per HH	2.4	2.1	2.2
Average HH Income	\$51,737	\$55,223	\$67,659
Average House Value	\$93,060	\$124,155	\$151,240

2020 American Community Survey (ACS)

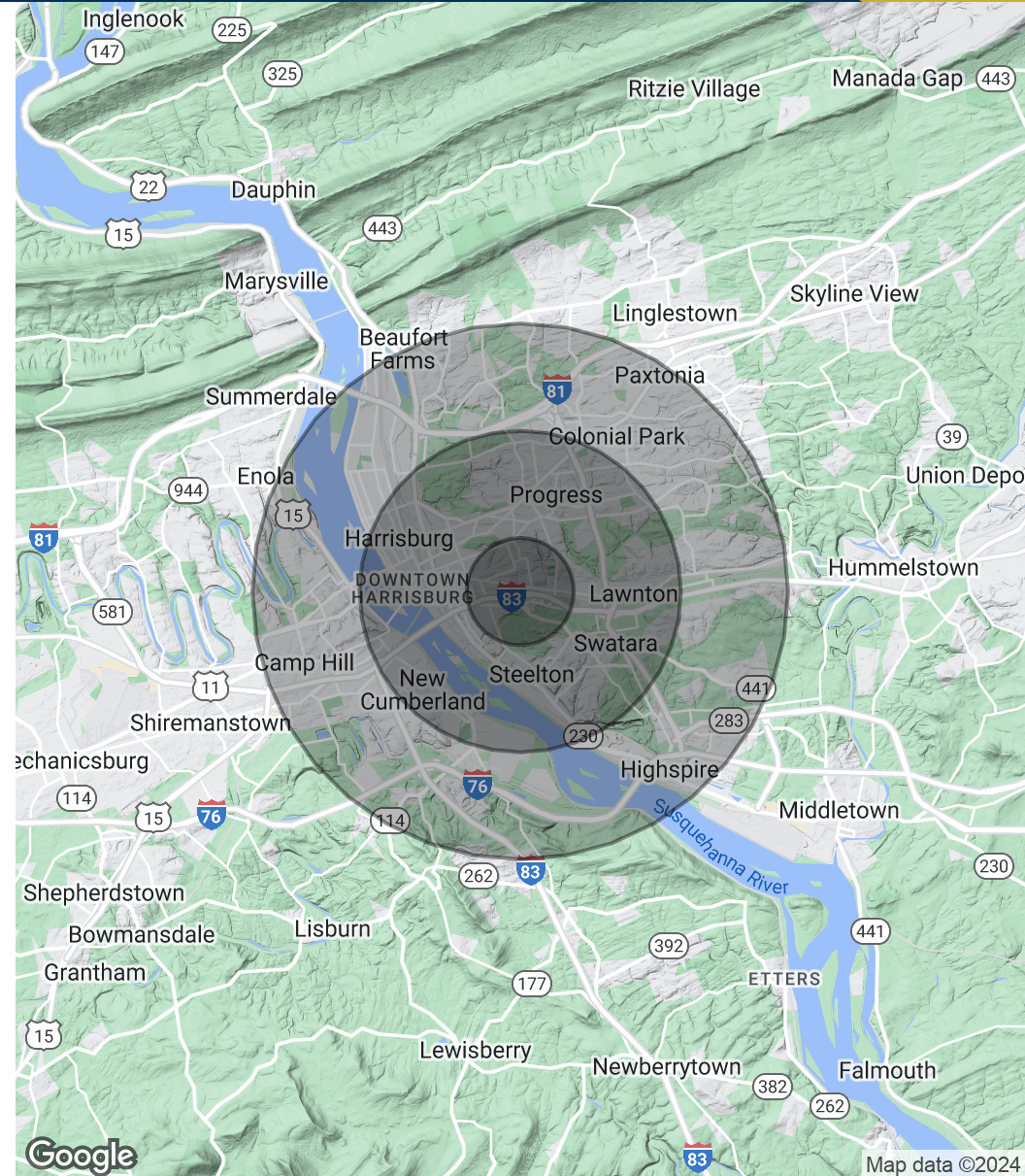

DISCLAIMER

808 S 26th St Harrisburg, PA 17111

CONFIDENTIALITY & DISCLAIMER

All materials and information received or derived from Capstone Commercial its directors, officers, agents, advisors, affiliates and/or any third party sources are provided without representation or warranty as to completeness, veracity, or accuracy, condition of the property, compliance or lack of compliance with applicable governmental requirements, developability or suitability, financial performance of the property, projected financial performance of the property for any party's intended use or any and all other matters. Neither Capstone Commercial its directors, officers, agents, advisors, or affiliates makes any representation or warranty, express or implied, as to accuracy or completeness of the any materials or information provided, derived, or received. Materials and information from any source, whether written or verbal, that may be furnished for review are not a substitute for a party's active conduct of its own due diligence to determine these and other matters of significance to such party. Capstone Commercial will not investigate or verify any such matters or conduct due diligence for a party unless otherwise agreed in writing.

EACH PARTY SHALL CONDUCT ITS OWN INDEPENDENT INVESTIGATION AND DUE DILIGENCE. Any party contemplating or under contract or in escrow for a transaction is urged to verify all information and to conduct their own inspections and investigations including through appropriate third party independent professionals selected by such party. All financial data should be verified by the party including by obtaining and reading applicable documents and reports and consulting appropriate independent professionals. Capstone Commercial makes no warranties and/or representations regarding the veracity, completeness, or relevance of any financial data or assumptions. Capstone Commercial does not serve as a financial advisor to any party regarding any proposed transaction. All data and assumptions regarding financial performance, including that used for financial modeling purposes, may differ from actual data or performance. Any estimates of market rents and/or projected rents that may be provided to a party do not necessarily mean that rents can be established at or increased to that level. Parties must evaluate any applicable contractual and governmental limitations as well as market conditions, vacancy factors and other issues in order to determine rents from or for the property. Legal questions should be discussed by the party with an attorney. Tax questions should be discussed by the party with a certified public accountant or tax attorney. Title questions should be discussed by the party with a title officer or attorney. Questions regarding the condition of the property and whether the property complies with applicable governmental requirements should be discussed by the party with appropriate engineers, architects, contractors, other consultants and governmental agencies. All properties and services are marketed by Capstone Commercial in compliance with all applicable fair housing and equal opportunity laws.



Ida McMurray, CCIM, SIOR

PRINCIPAL & SENIOR ADVISOR

imcmurray@capstonecre.co

O: 717.820.1127 X701

C: 717.443.5500