

# Wilkerson

PROPERTIES INC.

## 4615 W. Loop 289

Single Story Office/Flex  
Lubbock, TX  
1,774 SF for Lease

**Will Wilkerson**  
*office* 806.474.2210  
*cell* 214.843.8221  
**Gordon Wilkerson**  
*office* 806.474.2207  
*cell* 806.441.4307

### Property Description

Single story office/flex space available in Southwest Crossing office park. Currently finished out with 4 offices, 1 large work area/reception, 2 restrooms and a rear warehouse area. 10'X9' grade level overhead door in rear warehouse area. Large parking lot.

### Location

Located in SE corner of W. Loop and Marsha Sharp intersection. Attractive location for your employees. Large selection of restaurants and shopping nearby

### Rates

\$11.00/SF/year NNN  
Tenant Improvements Negotiable



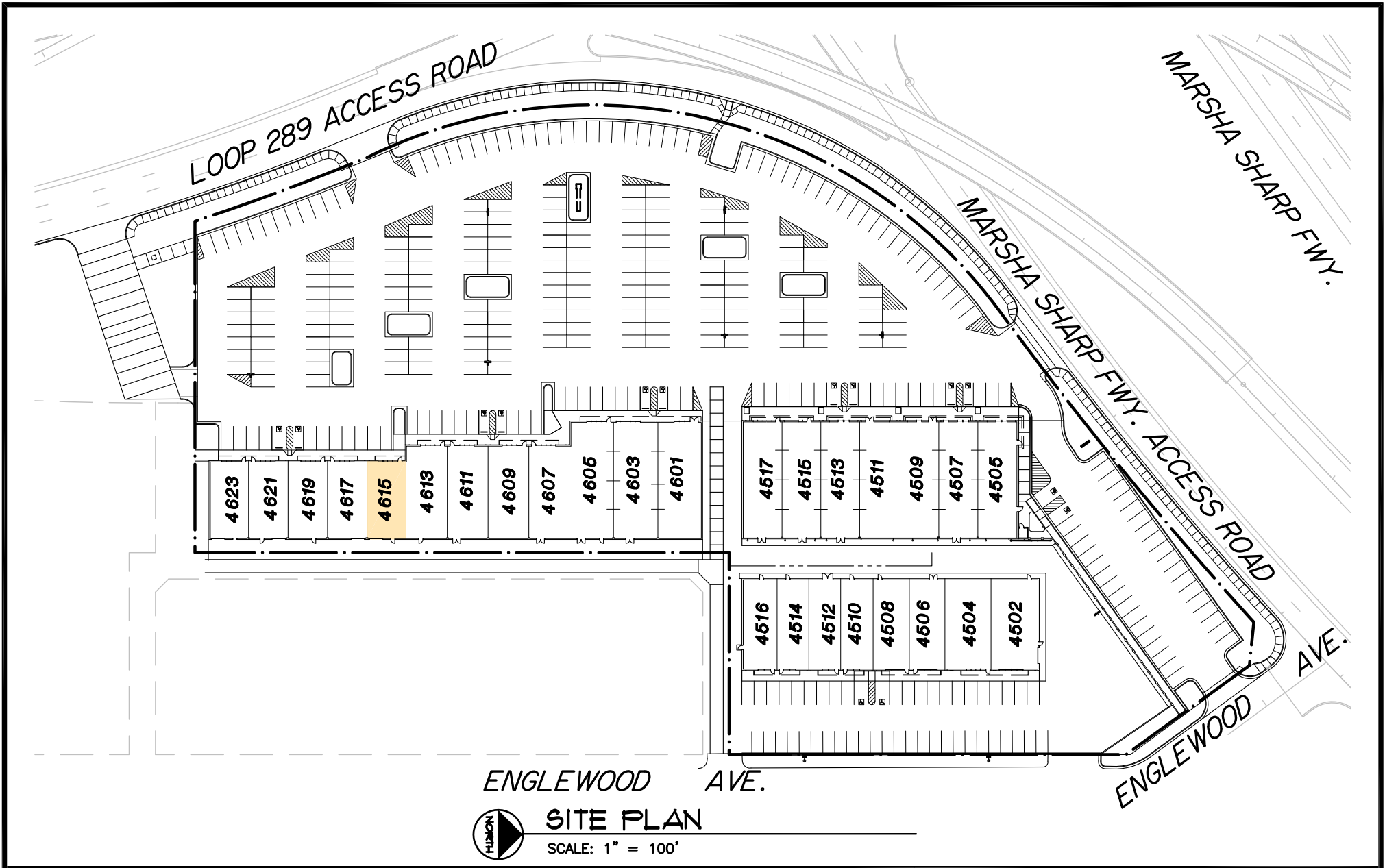

**Wilkerson**

PROPERTIES INC.

Commercial & Industrial  
 Development, Management & Brokerage  
 Phone: (806) 474-2223  
 Fax: (806) 474-2216  
 501 E. 66th Street  
 Lubbock, Texas 79404

Southwest Crossing	Date: 12/05/2017	Rev:
	Drawn by: JWT	
Lubbock, Texas 79414	Checked by:	

**A1**

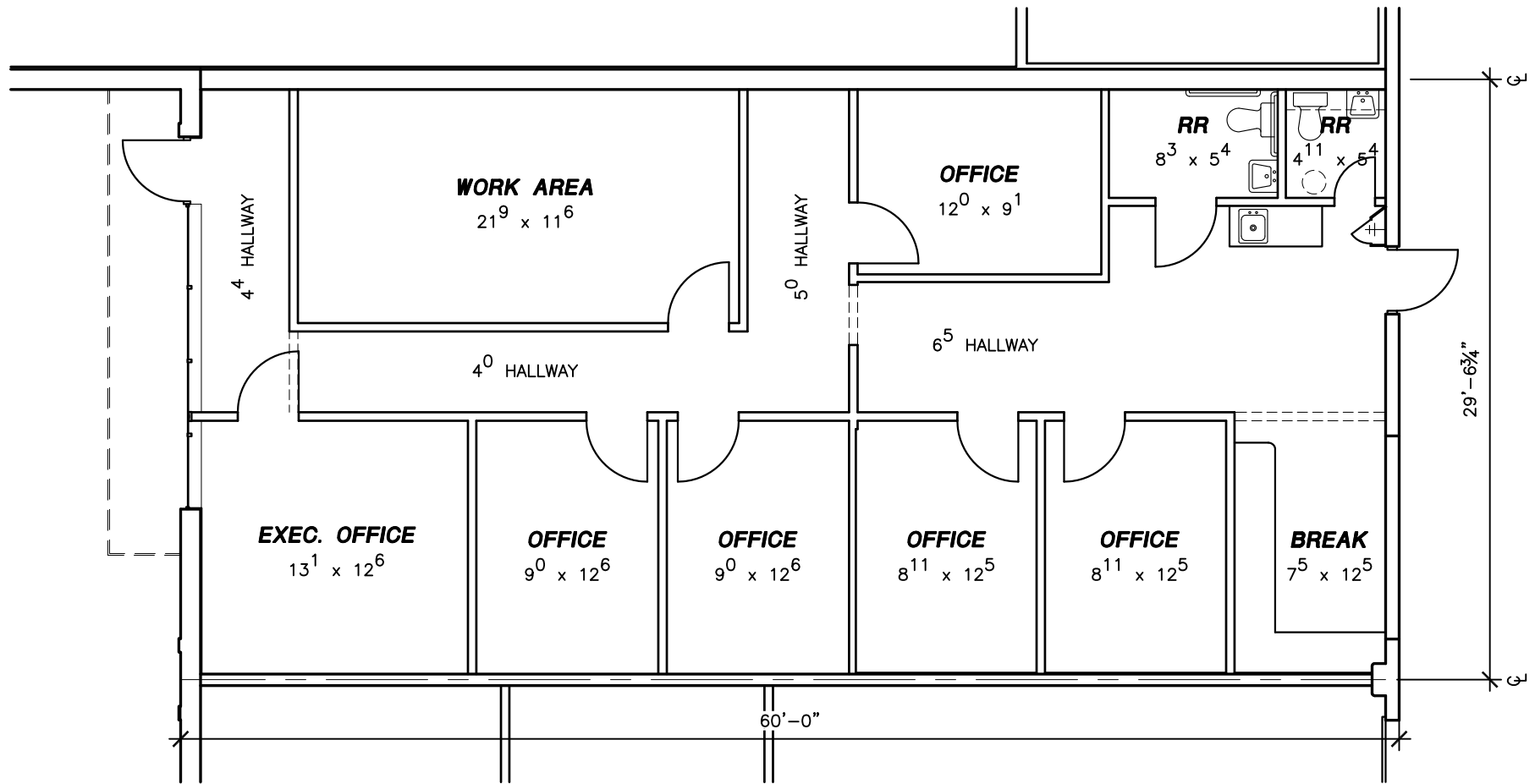

### EXIST. FLOOR PLAN

SCALE: 1/8" = 1'-0"

AREA = 1,774 S.F.



Commercial & Industrial  
Development, Management & Brokerage  
Phone: (806) 474-2223  
Fax: (806) 474-2216  
501 E. 66th Street  
Lubbock, Texas 79404

Southwest Crossing	Date: 01/10/2019	Rev:
4615 W. Loop 289	Drawn by: JWT	
Lubbock, Texas 79414	Checked by:	
G:\SWC\SWC-FLOR.dwg, 4615-FLOR, 1/10/2019 1:44:48 PM		

**A2**