

LAND TITLE SURVEY OF A TRACT OF LAND being Lot 3, in Block 202 in the City and County of Galveston, Texas.

NOTES:
 NO RECORDS SEARCH CONTRACTED.
 SURVEY PREPARED FROM TITLE COMPANY SPECIFICATIONS. CLIENT RELIES SOLELY ON TITLE COMPANY SPECIFICATIONS AS TO RECORD EASEMENTS, RESTRICTIONS, ROADWAYS, RIGHTS-OF-WAY, BUILDING LINES, ENCUMBRANCES, ETC.; CLIENT AND TITLE COMPANY HOLD TLTS, INC. HARMLESS FROM RESPONSIBILITY FOR SAME

- True ground distances shown
- Plat & bearings reference Plan of COG, Sandusky 1845
- Survey monuments reconciled w/ numerous previous surveys

Scale: 1" = 20'

Subject property: 2217 - 2219 Sealy (aka Avenue I) Galveston County, Texas
 This survey is certified for this transaction only and may only be relied on by David Bloom, Heidi Walker, Park Place Finance, LLC and Stewart Title Co., GF #1502470. This survey is only valid if print has original seal and signature of surveyor.

I hereby certify that this survey was made on the ground under my direct supervision and that this plat correctly represents the facts found at the time of the survey.

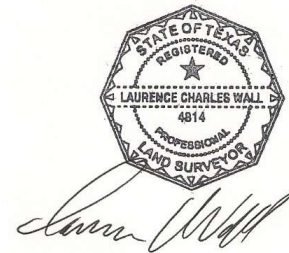

Laurence C. Wall
 RPLS #4814
 December 10, 2021

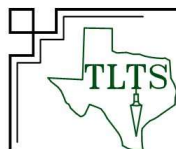

TLTS, Inc.
 TEXAS LAND TITLE SURVEYORS
 1801 Moody Avenue
 Galveston, Texas 77550
 (409) 765-8883