

BUILDING	SIZE	USE DESCRIPTION
BUILDING 'A'	160' x 180' = 28,800 SQ. FT.	BOTTLING AND STORAGE
BUILDING 'B'	210' x 180' = 37,800 SQ. FT.	FERMENTATION AND STORAGE
BUILDING 'C'	40' x 30' = 1,200 SQ. FT.	STORAGE
BUILDING 'D'	160' x 125' = 20,000 SQ. FT.	CASE GOODS STORAGE
BUILDING 'E'	160' x 120' = 19,200 SQ. FT.	GLASS STORAGE
BUILDING 'F'	40' x 80' = 3,200 SQ. FT.	WAREHOUSE
OFFICE	= 4,762 SQ. FT.	

± 9.25 ACRES  
 THAT PORTION IN THE NORTH EAST QUARTER OF SECTION 23, TOWNSHIP 12 SOUTH, RANGE 18 EAST, MOUNT DIABLO BASE AND MERIDIAN.  
 HIGHWAY 99 @ AVENUE 9  
 MADERA, CALIF.  
 CONSOLIDATED INDUSTRIES  
 1391 W. SHAW AVE.  
 FRESNO, CALIF. 93705  
 (209) 226-6888 OR (209) 225-1922

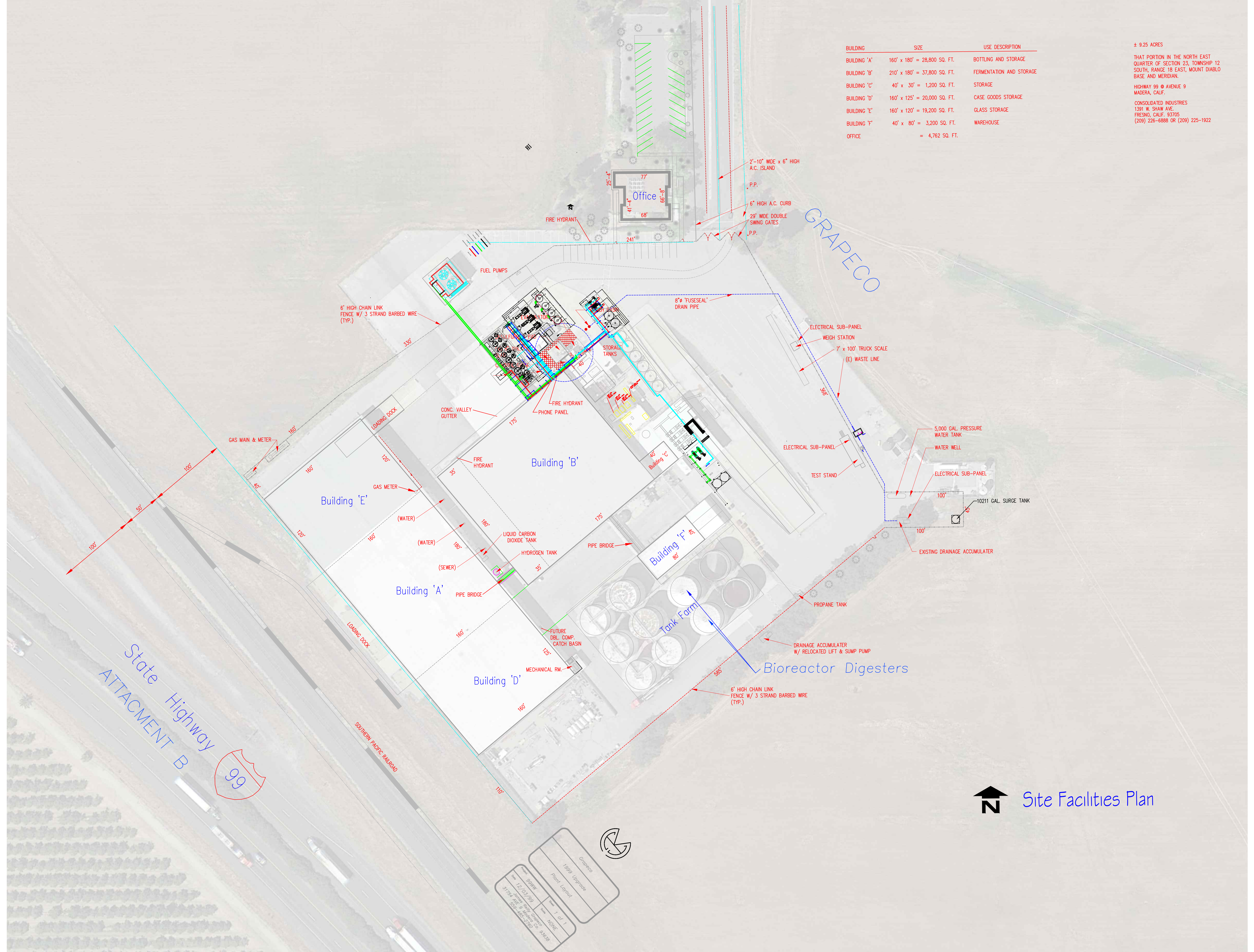

Site Facilities Plan

Grapeco  
 1999 Upgrade  
 Plant Layout  
 Date: 12/21/09  
 Scale: AS SHOWN  
 Project No: 31754  
 Rev: 1 of 1  
 Author: MJC  
 Checker: MJC  
 Date: 12/21/09