



ACCESS Commercial, LLC

LAND AVAILABLE

# Valley Landing

N 270th & Meigs St | Valley, NE 68064



Contact Listing Agents For More Information:

[www.AccessCommercial.com](http://www.AccessCommercial.com)

Kirk Hanson

[kirk@accesscommercial.com](mailto:kirk@accesscommercial.com)  
402.616.2580

Rocky Pryor

[rocky@accesscommercial.com](mailto:rocky@accesscommercial.com)  
402.216.7887



ACCESS Commercial, LLC

## LAND AVAILABLE

# Valley Landing

N 270th & Meigs St | Valley, NE 68064

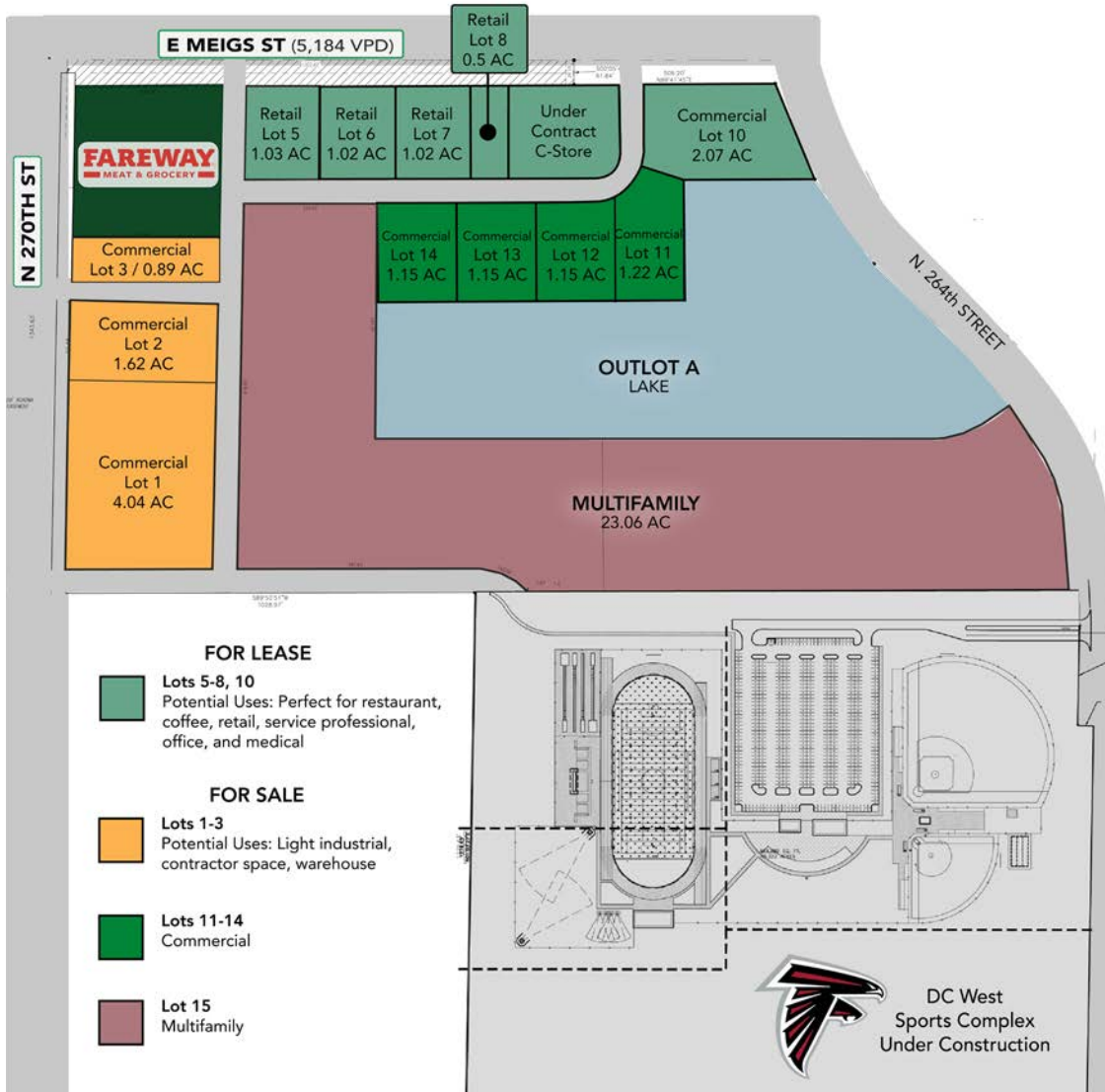

## ABOUT THE PROPERTY

- Rapidly growing and expanding area in Omaha metro
- Quick access to Hwy 275
- Commercial pads available now
- 3M, directly North, recently underwent an 80,000 SF expansion with an employee count of 680.
- Valmont Industries is 2.6 miles NW of site; 11K employees worldwide
- Local school district, DC West, developing 45 AC Sports Complex directly South
- Elkhorn Athletic Association: MD West ONE Sports Complex under development to the North East
- 10-minute drive to Omaha

Contact Listing Agents For More Information:

[www.AccessCommercial.com](http://www.AccessCommercial.com)

**Kirk Hanson**

[kirk@accesscommercial.com](mailto:kirk@accesscommercial.com)  
402.616.2580

**Rocky Pryor**

[rocky@accesscommercial.com](mailto:rocky@accesscommercial.com)  
402.216.7887



ACCESS Commercial, LLC

LAND AVAILABLE

# Valley Landing

N 270th & Meigs St | Valley, NE 68064

## DRONE PHOTOS



LOOKING SOUTHEAST



LOOKING NORTHEAST

Contact Listing Agents For More Information:

[www.AccessCommercial.com](http://www.AccessCommercial.com)

**Kirk Hanson**

[kirk@accesscommercial.com](mailto:kirk@accesscommercial.com)  
402.616.2580

**Rocky Pryor**

[rocky@accesscommercial.com](mailto:rocky@accesscommercial.com)  
402.216.7887



ACCESS Commercial, LLC

LAND AVAILABLE

# Valley Landing

N 270th & Meigs St | Valley, NE 68064

## DC WEST ATHLETIC COMPLEX



- Opening Fall 2025
- Includes a football field and track, soccer, and baseball fields
- The complex will be utilized for high school students, with walking access being added to the complex from DC West for safe travel
- 500 parking stalls included



Contact Listing Agents For More Information:

[www.AccessCommercial.com](http://www.AccessCommercial.com)

**Kirk Hanson**

[kirk@accesscommercial.com](mailto:kirk@accesscommercial.com)  
402.616.2580

**Rocky Pryor**

[rocky@accesscommercial.com](mailto:rocky@accesscommercial.com)  
402.216.7887



ACCESS Commercial, LLC

LAND AVAILABLE

# Valley Landing

N 270th & Meigs St | Valley, NE 68064

## LISTING TEAM



### Kirk Hanson Principal

Kirk is responsible for all business development and brokerage activities for ACCESS and affiliated companies. He holds a Bachelor's Degree in Finance from the University of Nebraska at Lincoln and is a licensed broker in Nebraska, Iowa, Missouri and North Dakota. He is also a long-time member of the International Council of Shopping Centers (ICSC) and the Entrepreneurs Organization (EO).



### Rocky Pryor Broker Associate

Rocky attended the Jesuit School of Rockhurst University where he was named the Vice President of the Nonprofit Leadership Alliance on campus and enjoyed competing in speech competitions. Rocky has 6+ years of experience. He specializes in development with a concentration in Landlord representation. He is also growing his key role in tenant representation on his team using the knowledge he has acquired focusing on development and landlord representation.

ACCESS is focused on growth opportunities through a select grouping of strategic partnerships. We strive to maximize value for every stakeholder involved in our projects, and have a proven track record of over 400 successfully completed projects across 40 states. We focus on forming deep relationships with our clients and believe durable success in our industry requires the right mixture of talents and virtues, collaboration, and relentless execution.

\*Agent has equity



ACCESS Commercial, LLC

**ACCESS Commercial, LLC**  
10730 Pacific Street, Suite 230  
Omaha, NE 68114 | 402.502.1983

All rights reserved. This information has been obtained from sources believed reliable but has not been verified for accuracy or completeness. ACCESS Commercial, LLC, makes no guarantee, representation or warranty and accepts no responsibility or liability as to the accuracy, completeness, or reliability of the information contained herein. You should conduct a careful, independent investigation of the property and verify all information. Any reliance on this information is solely at your own risk. ACCESS and the ACCESS logo are service marks of ACCESS Commercial, LLC. All other marks displayed on this document are the property of their respective owners, and the use of such marks does not imply any affiliation with or endorsement of ACCESS. Photos herein are the property of their respective owners. Use of these images without the express written consent of the owner is prohibited. (021523\_JR)

[WWW.ACCESSCOMMERCIAL.COM](http://WWW.ACCESSCOMMERCIAL.COM)



[facebook.com/accesscommercial](https://facebook.com/accesscommercial)



[instagram.com/accessretail](https://instagram.com/accessretail)