

# 212TH BUSINESS PARK



## FOR MORE INFORMATION:

**SHANE MAHVI, SIOR**  
206.336.5338 | smahvi@andoverco.com

**JACK CRANE**  
206.446.6699 | jacklc@andoverco.com

**BRIAN BRUININKS, CCIM**  
206.336.5324 | bbruininks@andoverco.com

**JEFF CRANE**  
206.336.5336 | jcrane@andoverco.com

7818 S 212TH ST | KENT | WA | 98032

## PROPERTY FEATURES

- 4 Building Business Park
- Extensive Exterior Improvements Planned
- Available Suites +/- 10,000 to 35,000 SF
- Suites Ready for Immediate Occupancy
- Highly Functional Dock & Grade Level Spaces
- HVAC In Office Areas
- 3-Phase Power to Each Space
- 3.8/1,000 Parking Ratio

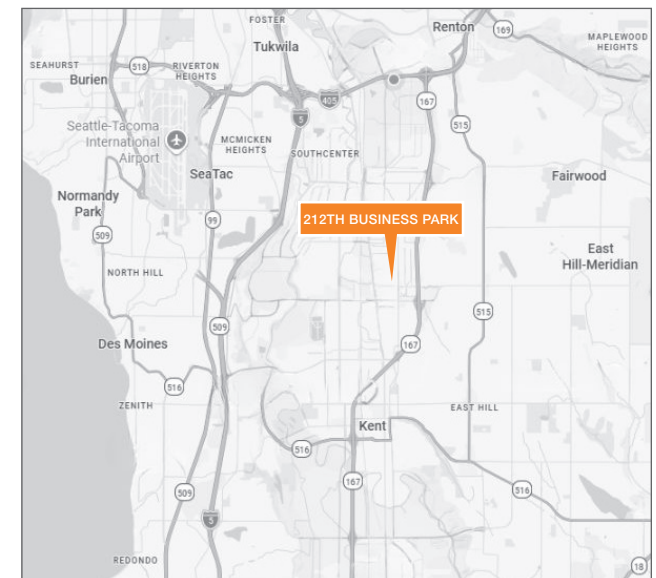

The information contained herein is believed to be accurate but is not warranted as to its accuracy and may change or be updated without notice. Seller or landlord makes no representation as to the environmental condition of the property and recommends purchaser's or tenant's independent investigation.



# 212TH BUSINESS PARK

## SITE PLAN



### FOR MORE INFORMATION

**SHANE MAHVI, SIOR**  
206.336.5338 | smahvi@andoverco.com

**JACK CRANE**  
206.446.6699 | jacklc@andoverco.com

**BRIAN BRUININKS, CCIM**  
206.336.5324 | bbruininks@andoverco.com

**JEFF CRANE**  
206.336.5336 | jcrane@andoverco.com

### AVAILABILITIES

AVAILABLE  OCCUPIED

SUITE	TOTAL SF	OFFICE SF	DOCK/GL	AVAILABLE
B - 104	10,552	1,052	2 DH, 1 GL	Now
B - 110	31,500	1,666	5 DH, 4 GL	Now
D - 107	35,873	2,973	4DH, 3 GL	Now

**212TH BUSINESS PARK**  
7818 S 212TH ST  
KENT, WA 98032



# 212TH BUSINESS PARK



## B-104 FLOOR PLAN

SPECIFICATIONS	
TOTAL SF	10,552
OFFICE SF	1,052
DOCK HEIGHT ▲	2
GRADE LEVEL ○	1
AVAILABLE	NOW

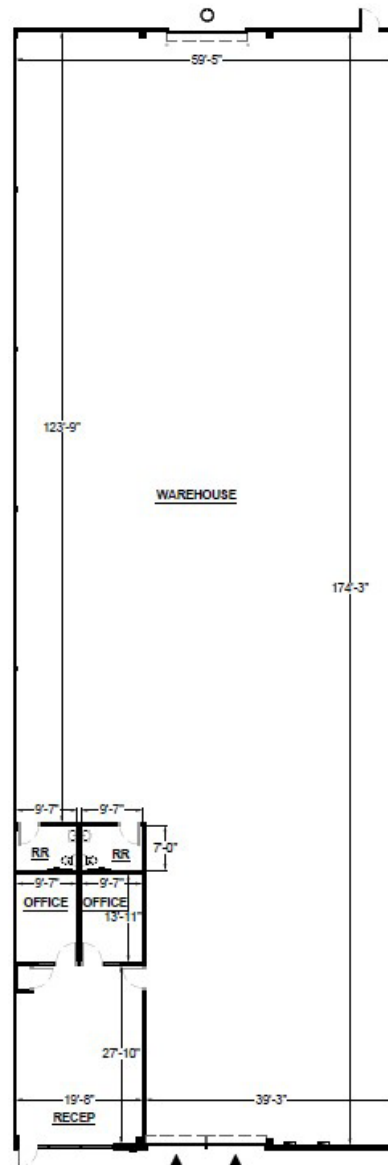

### FOR MORE INFORMATION

**SHANE MAHVI, SIOR**  
206.336.5338 | smahvi@andoverco.com

**JACK CRANE**  
206.446.6699 | jacklc@andoverco.com

**BRIAN BRUININKS, CCIM**  
206.336.5324 | bbruininks@andoverco.com

**JEFF CRANE**  
206.336.5336 | jcrane@andoverco.com

**212TH BUSINESS PARK**  
7818 S 212TH ST  
KENT, WA 98032



# 212TH BUSINESS PARK



## B-110 FLOOR PLAN

### SPECIFICATIONS

TOTAL SF	31,500
OFFICE SF	1,666
DOCK HEIGHT ▲	5
GRADE LEVEL ○	4
AVAILABLE	NOW

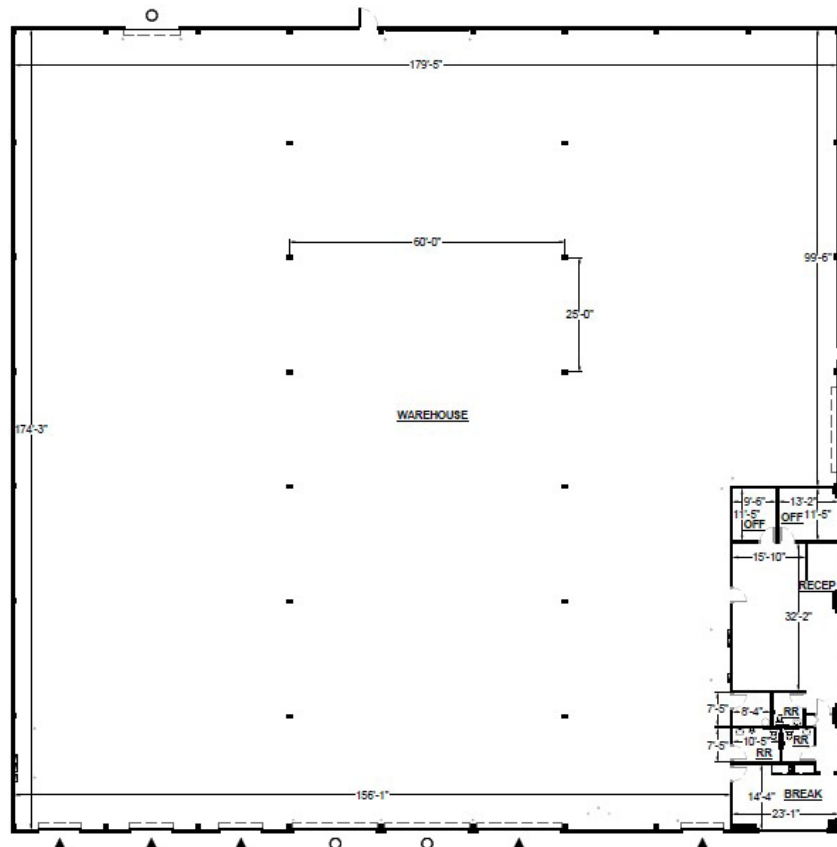

### FOR MORE INFORMATION

**SHANE MAHVI, SIOR**  
206.336.5338 | [smahvi@andoverco.com](mailto:smahvi@andoverco.com)

**JACK CRANE**  
206.446.6699 | [jacklc@andoverco.com](mailto:jacklc@andoverco.com)

**BRIAN BRUININKS, CCIM**  
206.336.5324 | [bbruininks@andoverco.com](mailto:bbruininks@andoverco.com)

**JEFF CRANE**  
206.336.5336 | [jcrane@andoverco.com](mailto:jcrane@andoverco.com)

**212TH BUSINESS PARK**  
7818 S 212TH ST  
KENT, WA 98032



# 212TH BUSINESS PARK



## D-107 FLOOR PLAN

SPECIFICATIONS	
TOTAL SF	35,873
OFFICE SF	2,973
DOCK HEIGHT ▲	4
GRADE LEVEL ○	3
AVAILABLE	NOW

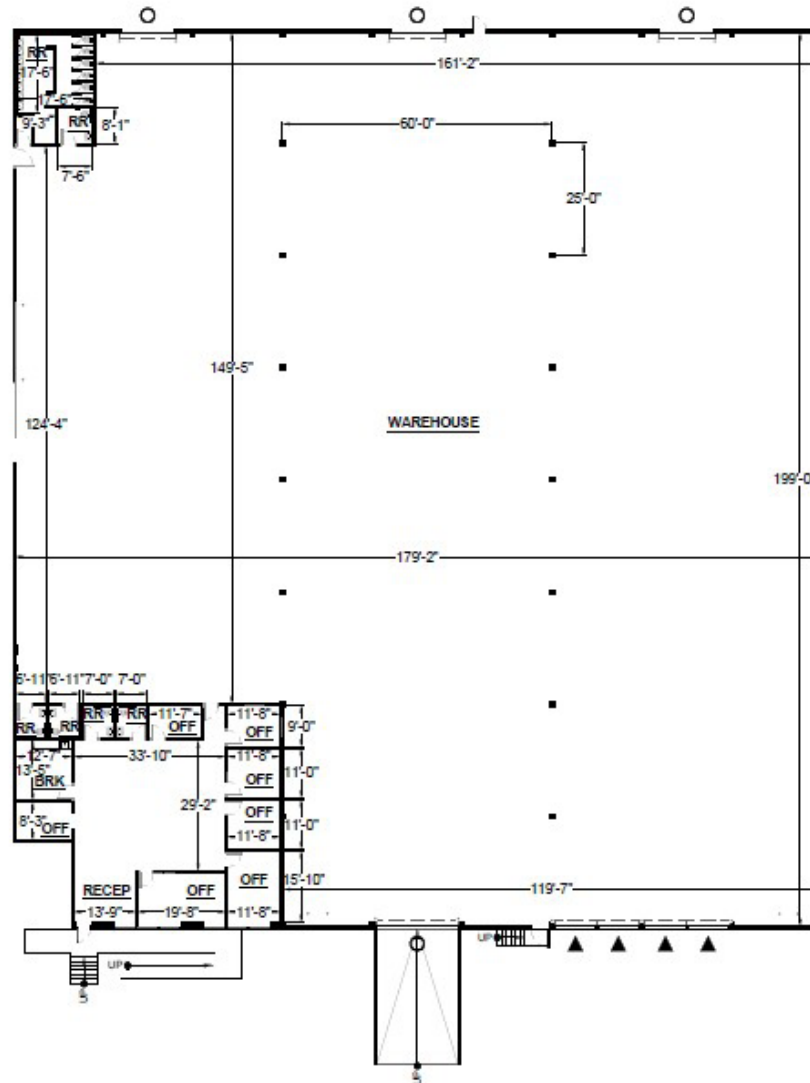

### FOR MORE INFORMATION

**SHANE MAHVI, SIOR**  
206.336.5338 | smahvi@andoverco.com

**JACK CRANE**  
206.446.6699 | jacklc@andoverco.com

**BRIAN BRUININKS, CCIM**  
206.336.5324 | bbruininks@andoverco.com

**JEFF CRANE**  
206.336.5336 | jcrane@andoverco.com

**212TH BUSINESS PARK**  
7818 S 212TH ST  
KENT, WA 98032



# 212TH BUSINESS PARK



## FOR MORE INFORMATION

**SHANE MAHVI, SIOR**  
206.336.5338  
smahvi@andoverco.com

**JACK CRANE**  
206.446.6699  
jacklc@andoverco.com

**BRIAN BRUININKS, CCIM**  
206.336.5324  
bbruininks@andoverco.com

**JEFF CRANE**  
206.336.5336  
jcrane@andoverco.com

---

**212TH BUSINESS PARK**  
7818 S 212TH ST  
KENT, WA 98032

 **THE ANDOVER  
COMPANY, INC.**  
CORFAC INTERNATIONAL

# 212TH BUSINESS PARK

## AMENITIES

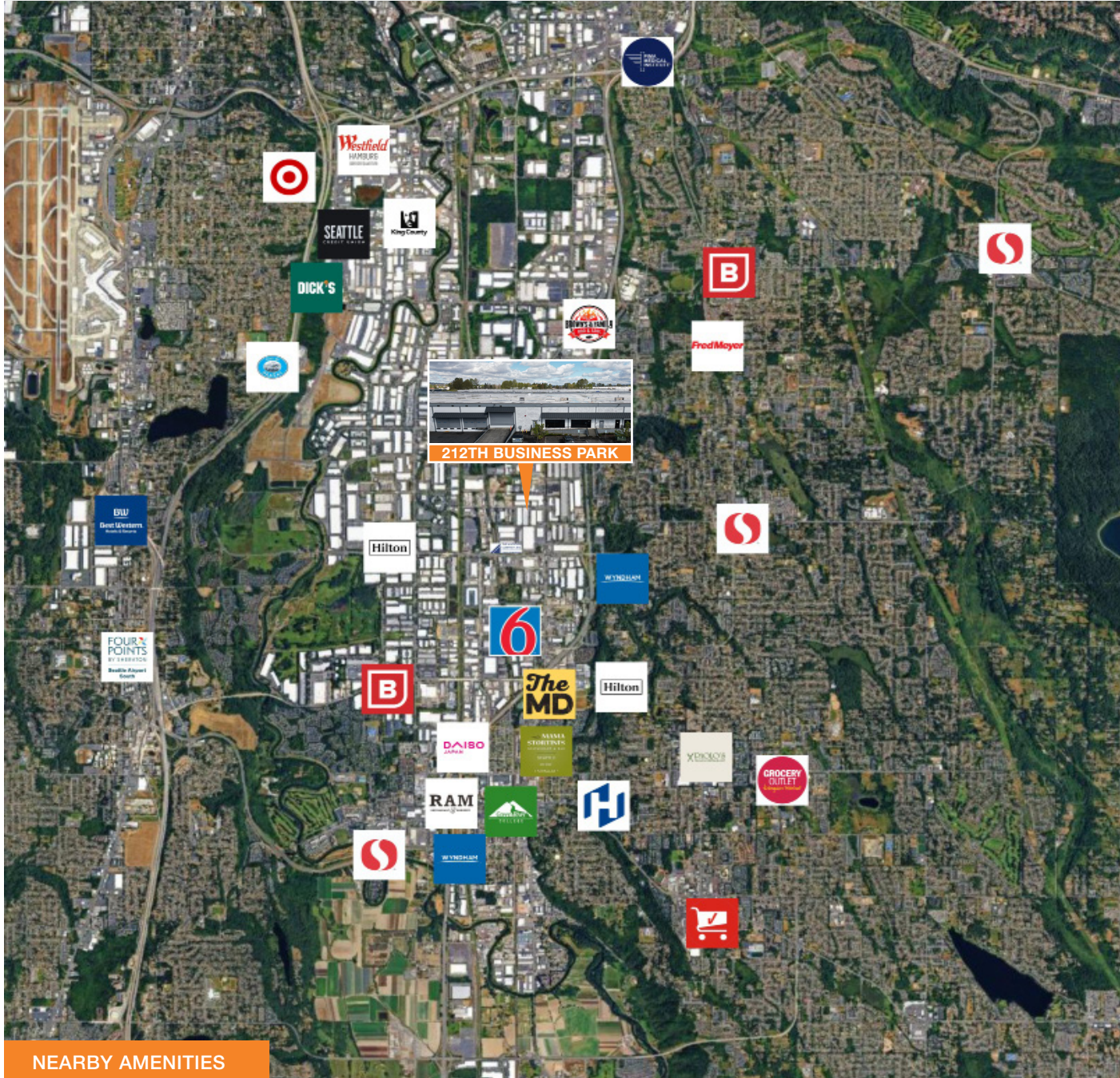

### NEARBY AMENITIES

Westfield Southcenter  
Kent Station  
SeaTac Airport  
Hwy I-5  
Hwy 167  
Hwy 405

### FOR MORE INFORMATION

**SHANE MAHVI, SIOR**  
206.336.5338  
smahvi@andoverco.com

**JACK CRANE**  
206.446.6699  
jacklc@andoverco.com

**BRIAN BRUININKS, CCIM**  
206.336.5324  
bbruininks@andoverco.com

**JEFF CRANE**  
206.336.5336  
jcrane@andoverco.com

**212TH BUSINESS PARK**  
7818 S 212TH ST  
KENT, WA 98032



NEARBY AMENITIES