



Sublease | 43,184 SF Available

# 230 CityPoint | Waltham, MA

- **Space Available:** 21,592 SF - 43,184 SF
- **Building Size:** 296,2123 SF
- **Year Built:** 1992
- **Timing:** Immediate
- **Term:** Through 7/31/2029
- **Condition:** High End Build Out
- **Furniture:** Available
- **Parking:** 3.0 /1,000

# 2nd Floor Plan

43,184 SF Available

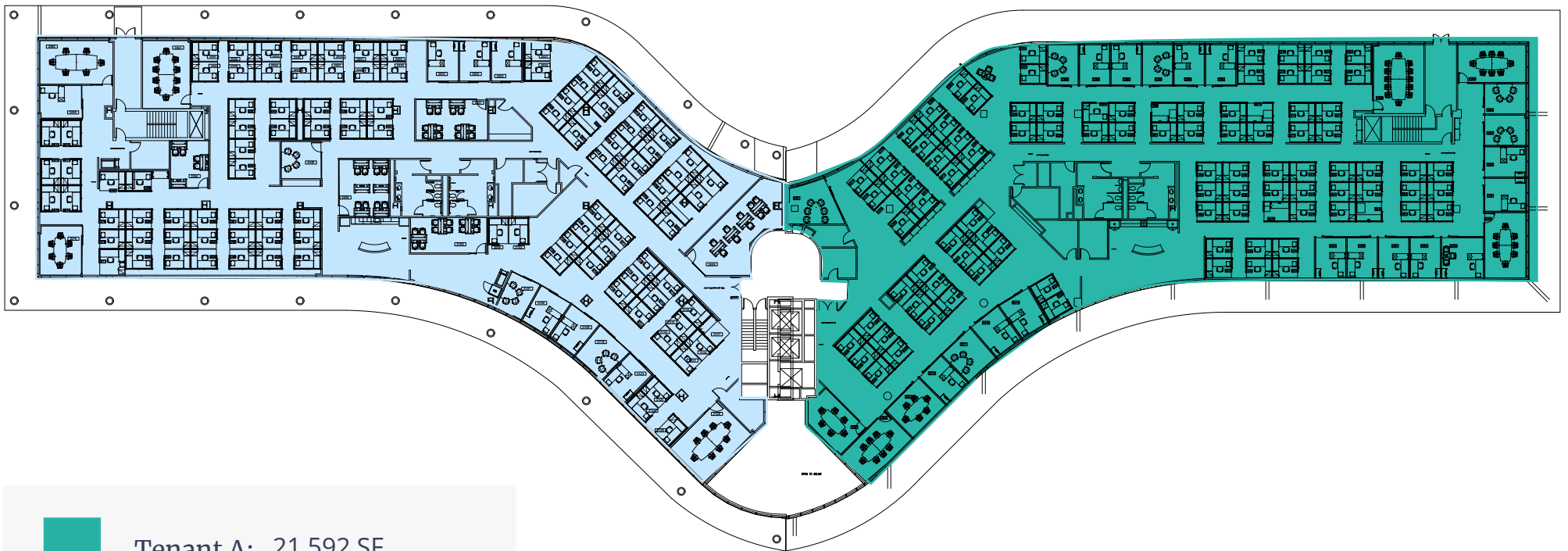

Tenant A: 21,592 SF



Tenant B: 21,592 SF

---

Total: 43,184 SF

230 CityPoint | For Sublease

# Class-A Office

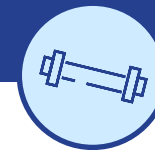
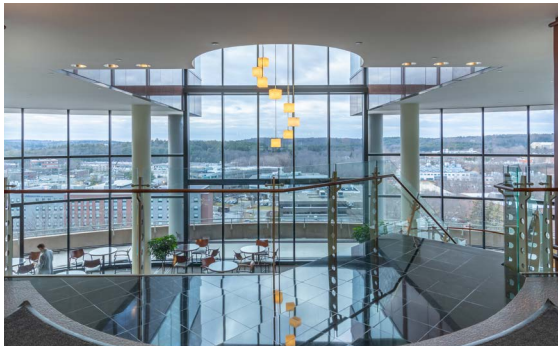

- Fitness Center
- Day Care
- Food Service / Cafe
- Outdoor Terrace
- Energy Star Labeled
- Conference Center
- 893 parking spaces
- Property Manager On-Site



**Amenities Within Minutes**



**James L. Elcock**  
 +1 617 538 0718  
 james.elcock@colliers.com

**Jason Rexinis**  
 +1 617 869 1227  
 jason.rexinis@colliers.com

**Caroline Evans**  
 +1 781 738 2308  
 caroline.evans2@colliers.com

**Colliers**  
 100 Federal Street  
 Boston, MA 02110  
 P: +1 617 330 8000  
 colliers.com

This document has been prepared by Colliers International for advertising and general information only. Colliers International makes no guarantees, representations or warranties of any kind, expressed or implied, regarding the information including, but not limited to, warranties of content, accuracy and reliability. Any interested party should undertake their own inquiries as to the accuracy of the information. Colliers International excludes unequivocally all inferred or implied terms, conditions and warranties arising out of this document and excludes all liability for loss and damages arising there from. This publication is the copyrighted property of Colliers International and/or its licensor(s). ©2026. All rights reserved.

