

OKC⁵⁷⁷



2500 E I-240 SERVICE RD.

NEW INDUSTRIAL BUILDINGS | FOR LEASE

2200 - 2500 E I-240 SERVICE RD., OKLAHOMA CITY, OK

BRETT PRICE, CCIM, SIOR
bprice@newmarkrp.com
C: 405.613.8380

KARLEY HARPER, CCIM
kharper@newmarkrp.com
C: 405.371.3498

NEWMARK
ROBINSON PARK

PROPERTY OVERVIEW

OKC 577 is a 577 acre± Master Planned park currently under construction, located just one mile east of the I-35 and I-240 interchange. The park benefits from a new two-way concrete I-240 frontage road and four-way I-240 interchanges on S Eastern & S Bryant. A new four-lane concrete central spine road runs through the development, maximizing access and circulation.

Locke Supply's 1.5M SF headquarters, located on the SE/c, is now complete and operating as well as OnCue's semi concept, located on the NW/c of the park.

Site I is the first phase of the spec development and features four industrial buildings totaling 340,000 square feet across 24.9 acres.



2200 E I-240 Service Rd.

80,000 SF Available

\$8.00/SF/YR (NNN)

TIA - \$8.00/SF

22 dock high doors

22 dock pits

4 grade level doors

32' clear height

50' x 50' column spacing

200' truck court

41 trailer parks

87 car parks (45 future)

LED lighting

Divisible to 30,000 SF

Available Now

2300 E I-240 Service Rd.

80,000 SF Available

\$8.00/SF/YR (NNN)

TIA - \$8.00/SF

22 dock high doors

22 dock pits

4 grade level doors

32' clear height

50' x 50' column spacing

200' truck court

39 trailer parks

80 car parks

LED lighting

Divisible to 30,000 SF

Available Now

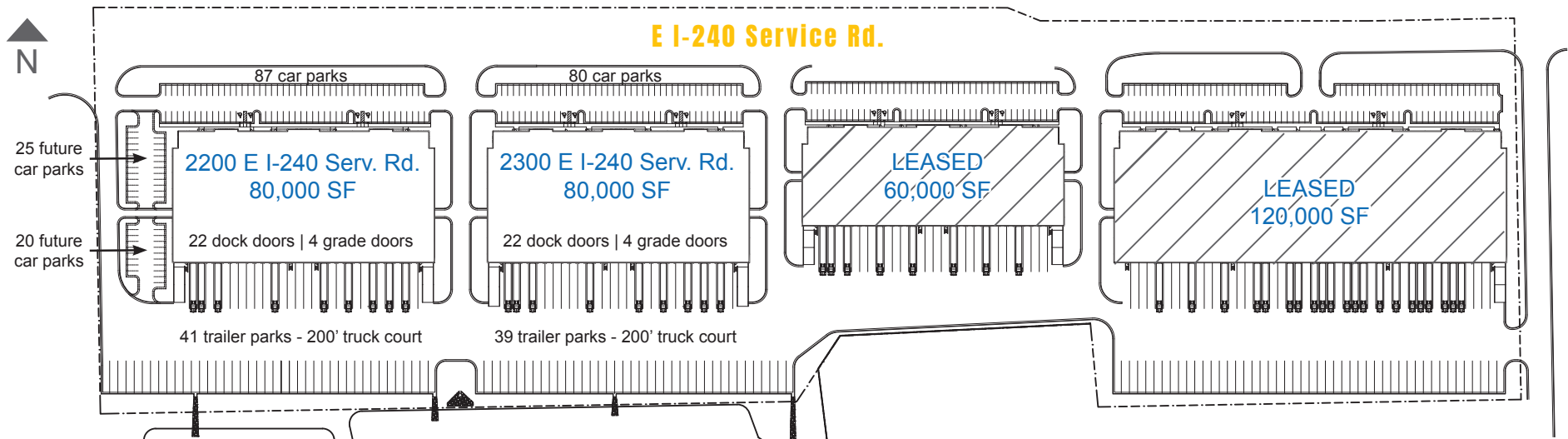

PARK HIGHLIGHTS

Industrial, office and retail pad sites available

Contiguous land sites available up to 235 acres

Potential building sizes range from 30,000 SF - 2M SF

State and federal incentive zones

Rail adjacent to park - BNSF Logistics Center ([link](#))

New BNSF intermodal facility now open ([link](#))

All utilities to site

Heavy power and large water & sewer capacity

3 miles west of Tinker Air Force Base

10 miles east of Will Rogers International Airport

www.OKC577.com



Site	Acres	Potential Building Size
A	37.42	530,400 SF
B	8.50	100,000 SF
C	74.35	1,257,500 SF
D	57.24	1,007,500 SF
E	95.14	1,500,000 SF
F	60.01	1,007,500 SF
G	2.56	OG&E Substation
H	3.58	-
I	24.90	340,000 SF
J	29.90	-
K	14.46	120,000 SF
L	16.24	-
M	19.61	248,000 SF
N	7.27	40,000 SF
O	8.95	100,000 SF
P	30.87	460,000 SF
Q	5.62	40,000 SF
R	10.71	120,000 SF
S	10.15	160,000 SF
T	36.61	-
U	6.19	-
V	14.55	80,000 SF
W	2.97	-
X	6.20	51,200 SF
TOTALS	584	7,162,100 SF

u/c = under construction

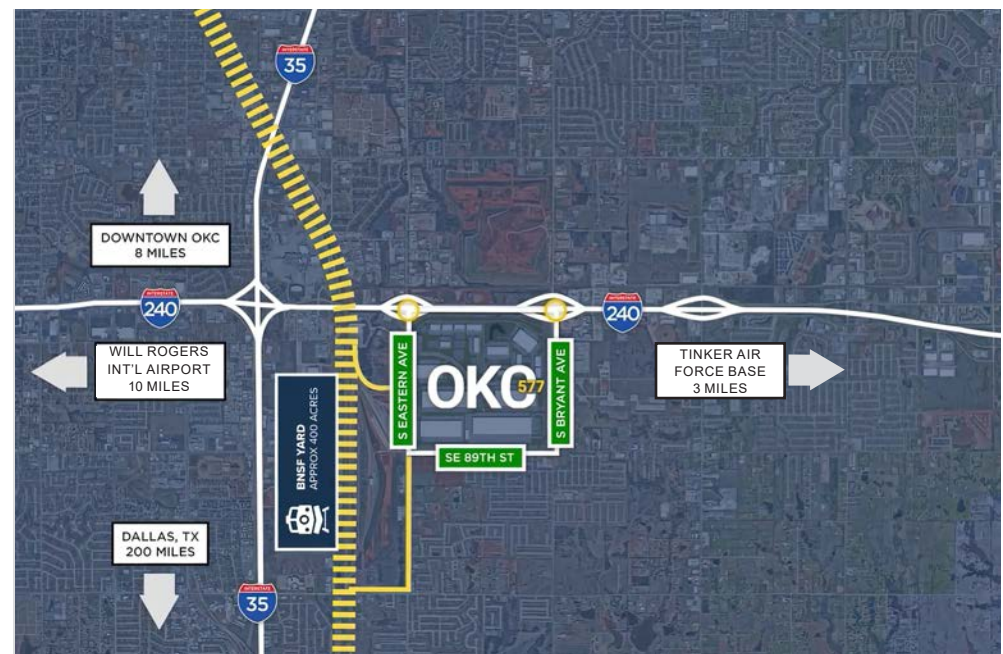

OKC 577



2500 E I-240 SERVICE RD.

NEWMARK
ROBINSON PARK

211 N. Robinson, Ste 600N OKC, OK, 73102 | for more information, visit us at
110 W. 7th, Ste 2710 Tulsa, OK, 74119 | **NEWMARKRP.COM**

The information contained herein was obtained from sources believed reliable; however, Newmark Robinson Park makes no guarantees, warranties or representations as to the completeness or accuracy thereof. The presentation of this property is submitted subject to errors, omissions, change of price or conditions prior to sale or lease, or withdrawal without notice. Independently Owned and Operated.