



8587
MELROSE
AVENUE

Carine Mamann
Vice Chairman
lic. 01734150
carine.mamann@cushwake.com
T. 310 595 2235

Kazuko Morgan
Executive Vice Chairman
lic. 01070005
kazuko.morgan@cushwake.com
T. 310 595 2235

Jay Luchs
Executive Vice Chairman
lic. 01260345
jay.luchs@nrmr.com
T. 310 407 6585

 **CUSHMAN &
WAKEFIELD**
NEWMARK
PACIFIC

PROPERTY DETAILS



ADDRESS

8587 Melrose Avenue
West Hollywood, CA 90069



USE

Retail



SIZE

± 6,530 SF



RENT

Available upon Request

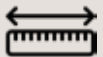

FRONTAGE

± 120' wraparound on Melrose
Avenue & Westbourne Drive



PARKING

Valet parking in front of site



HIGHLIGHTS



Contemporary design building



Surrounded by high-end retail and restaurants



Ground floor retail with an open layout



Floor to ceiling glass windows



17' Ceiling Height



Includes fitting rooms and a restroom

GROUND

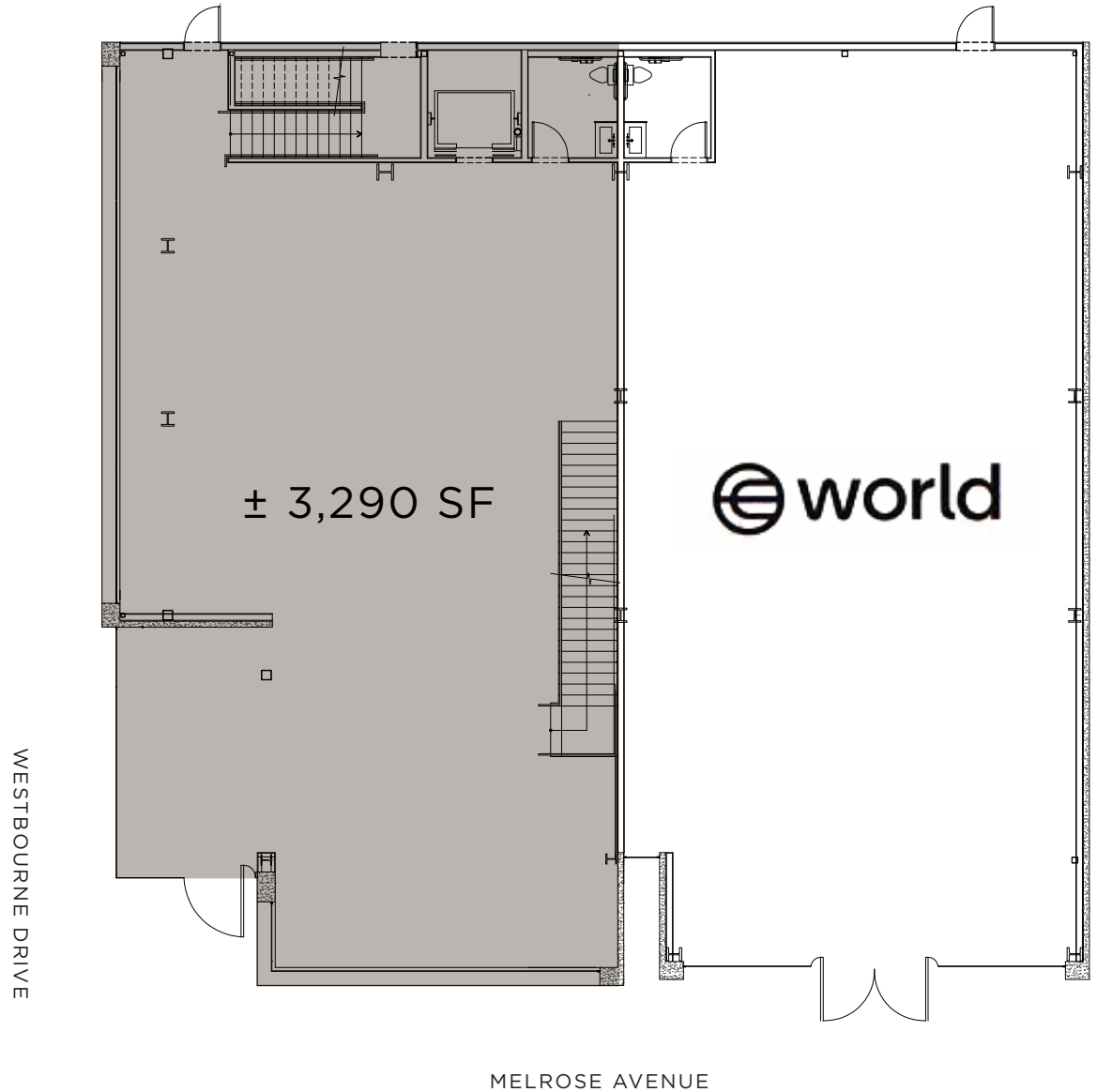

FLOORPLAN

Ground ± 3,290 SF
Second ± 3,240 SF
TOTAL ± 6,530 SF

SECOND

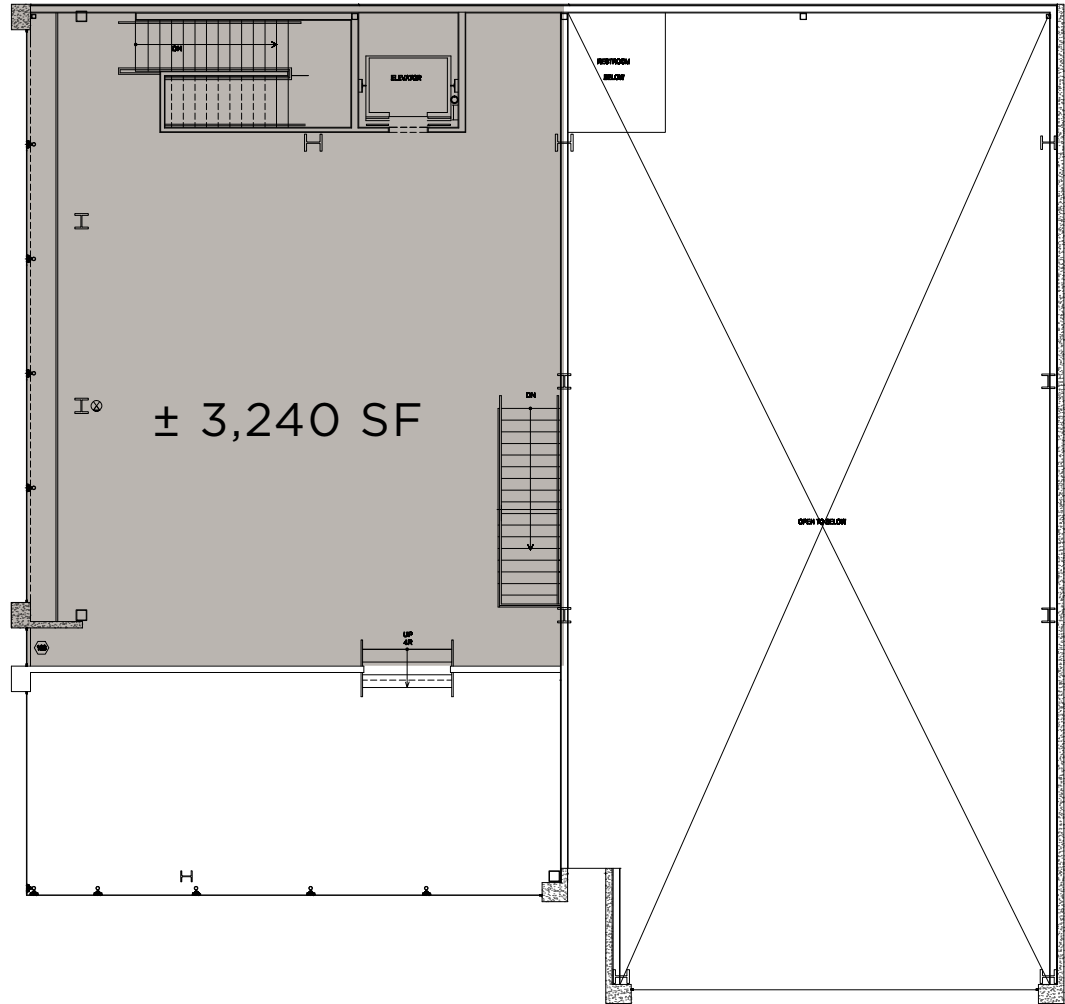

GROUND INTERIOR

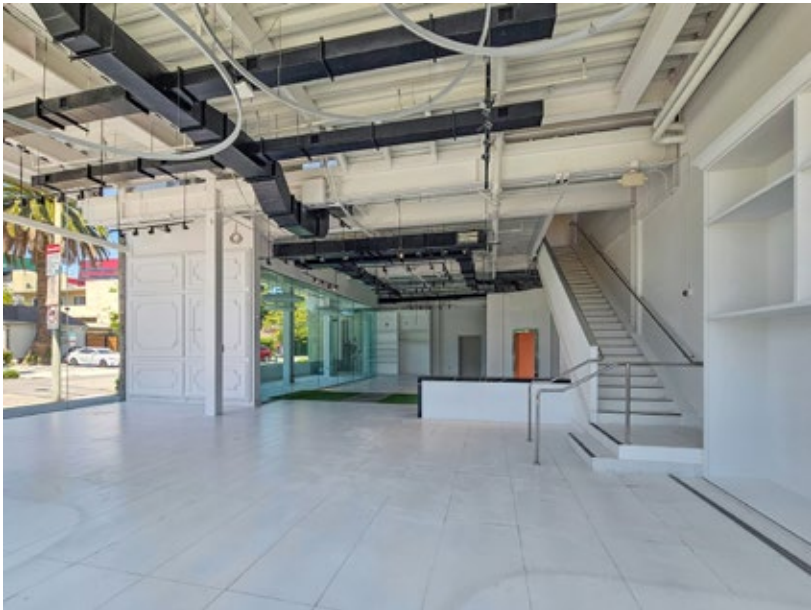

SECOND INTERIOR



DEMOGRAPHICS



POPULATION

44,069
1 MILE

262,504
3 MILE

812,602
5 MILE



DAYTIME POPULATION

77,899
1 MILE

396,522
3 MILE

1,048,296
5 MILE



MEDIAN AGE

43
1 MILE

40
3 MILE

38
5 MILE



AVERAGE HOUSEHOLD INCOME

\$158,713
1 MILE

\$155,601
3 MILE

\$131,999
5 MILE



AERIAL



8587
MELROSE
AVENUE

Alice
and Olivia

le PÈRE

ALFRED
COFFEE & BAKERY

Glossier.

rag & bone

HOKA

HAILE BOB
LOS ANGELES

FARM RIO

Urth Caffè
Exclusively Organic Coffee
24 Hour Tea

THE GREAT.

ami

world

RH
flagship

NEWMARK
PACIFIC

CUSHMAN &
WAKEFIELD



The information contained herein has been obtained from sources deemed reliable but has not been verified and no guarantee, warranty or representation, either express or implied, is made with respect to such information. Terms of sale or lease and availability are subject to change or withdrawal without notice.

Carine Mamann
Vice Chairman
lic. 01734150
carine.mamann@cushwake.com
T. 310 595 2235

Kazuko Morgan
Executive Vice Chairman
lic. 01070005
kazuko.morgan@cushwake.com
T. 310 595 2235

Jay Luchs
Executive Vice Chairman
lic. 01260345
jay.luchs@nrmk.com
T. 310 407 6585

