

**AVAILABLE FOR  
LEASE**

**INDUSTRIAL**  
**4,225 SF & 9,198 SF**



VELOCITY VENTURES

**1208 COLUMBUS ROAD  
BURLINGTON, NJ**



**WILL RITER | DIRECTOR OF ACQUISITIONS & LEASING**  
**VELOCITY VENTURE PARTNERS**

 (610) 212-5979

 [will@velocityinv.com](mailto:will@velocityinv.com)

# PROPERTY OVERVIEW & SPECS



**TOTAL BUILDING AREA**  
+/- 108,534 SF



**ACREAGE**  
+/- 7.60 ACRES



**LOADING**  
6 DRIVE-IN DOORS  
4 DOCK DOORS  
(1 DRIVE-IN DOOR AT EACH AVAILABILITY)



**POWER**  
**SUITE A:** 120/240 VOLTS,  
150 AMPS, SINGLE PHASE  
**SUITE F:** 277/480 VOLTS,  
400 AMPS, 3-PHASE



**CEILING HEIGHT**  
**SUITE A:** 12'-13'  
**SUITE F:** 14'



**PARKING**  
165 PARKING  
SPACES AVAILABLE



**BUILDING CONDITIONS**  
NEW ROOF, AND LED LIGHTING  
THROUGHOUT. PARKING LOT PAVING COMPLETED

## TRANSPORTATION ARTERIES



**INTERSTATES**  
ROUTE 130 (< 1 MILE)  
NJ TURNPIKE (3.7 MILES)  
I-295 (4.2 MILES)



**BRIDGES**  
BRISTOL BRIDGE (2.3 MILES)  
DELAWARE RIVER TURNPIKE  
BRIDGE (2.7 MILES)

# PROPERTY AERIAL

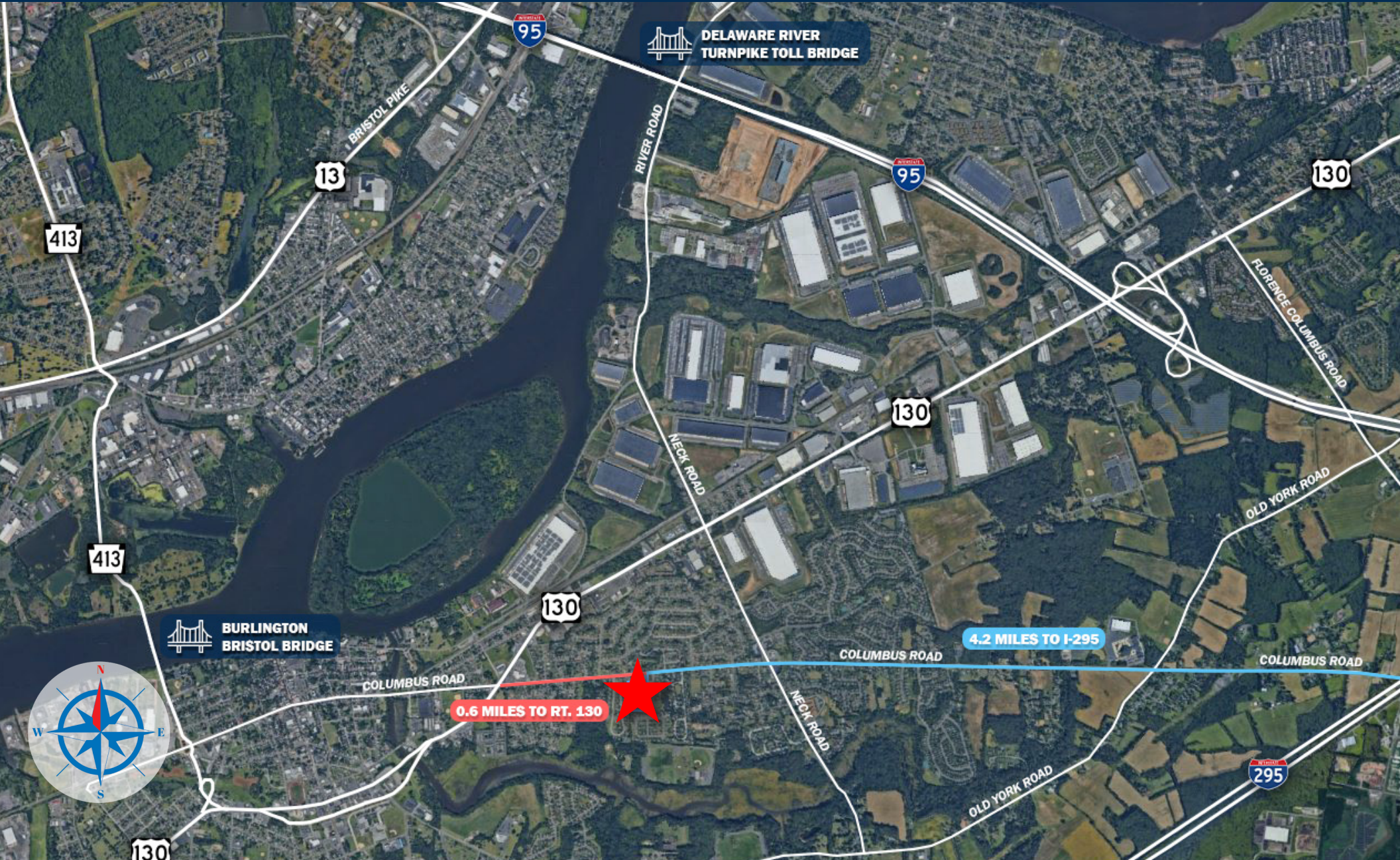

# SITE PLAN



VELOCITY VENTURES

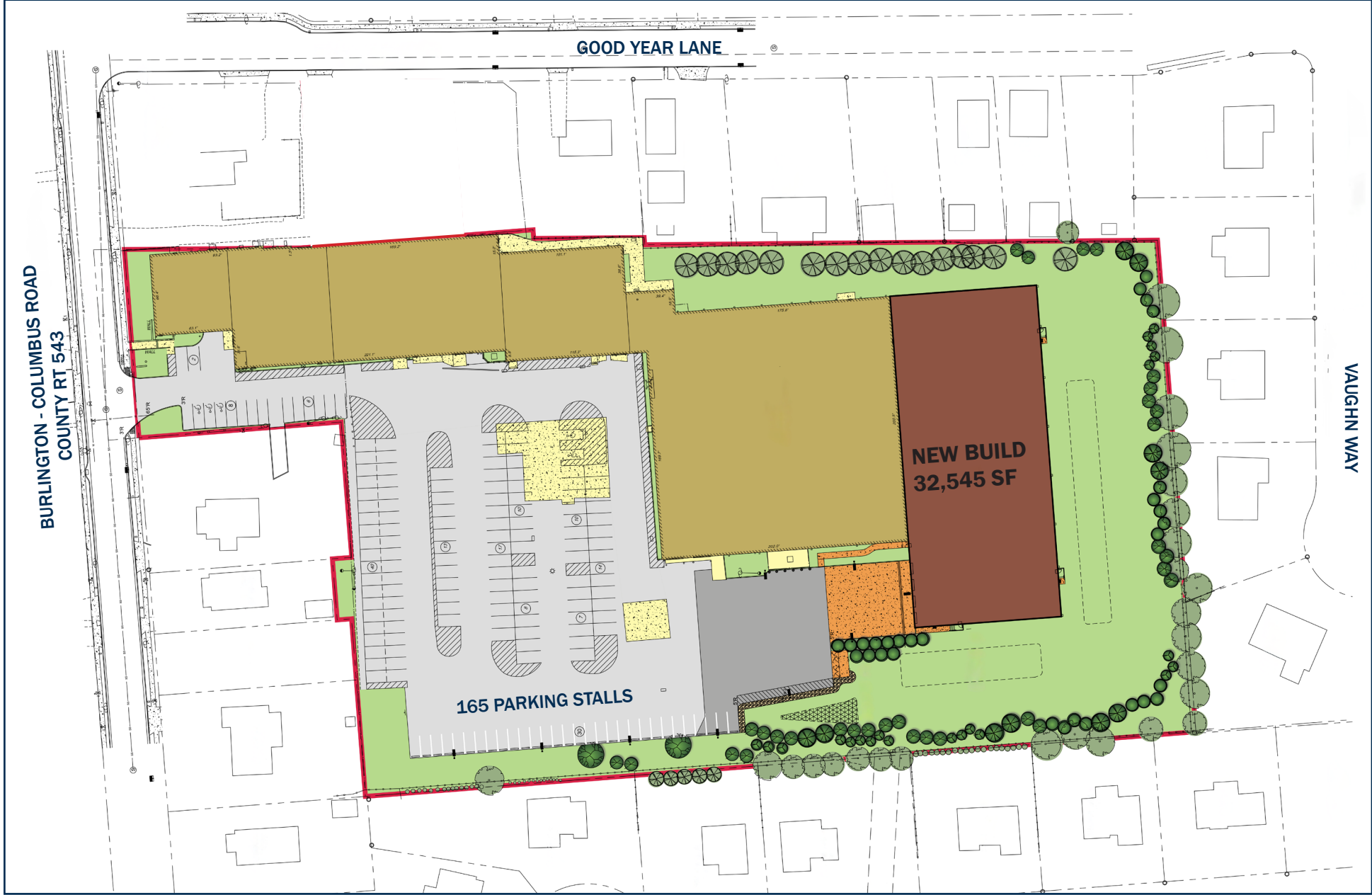

# FLOOR PLAN

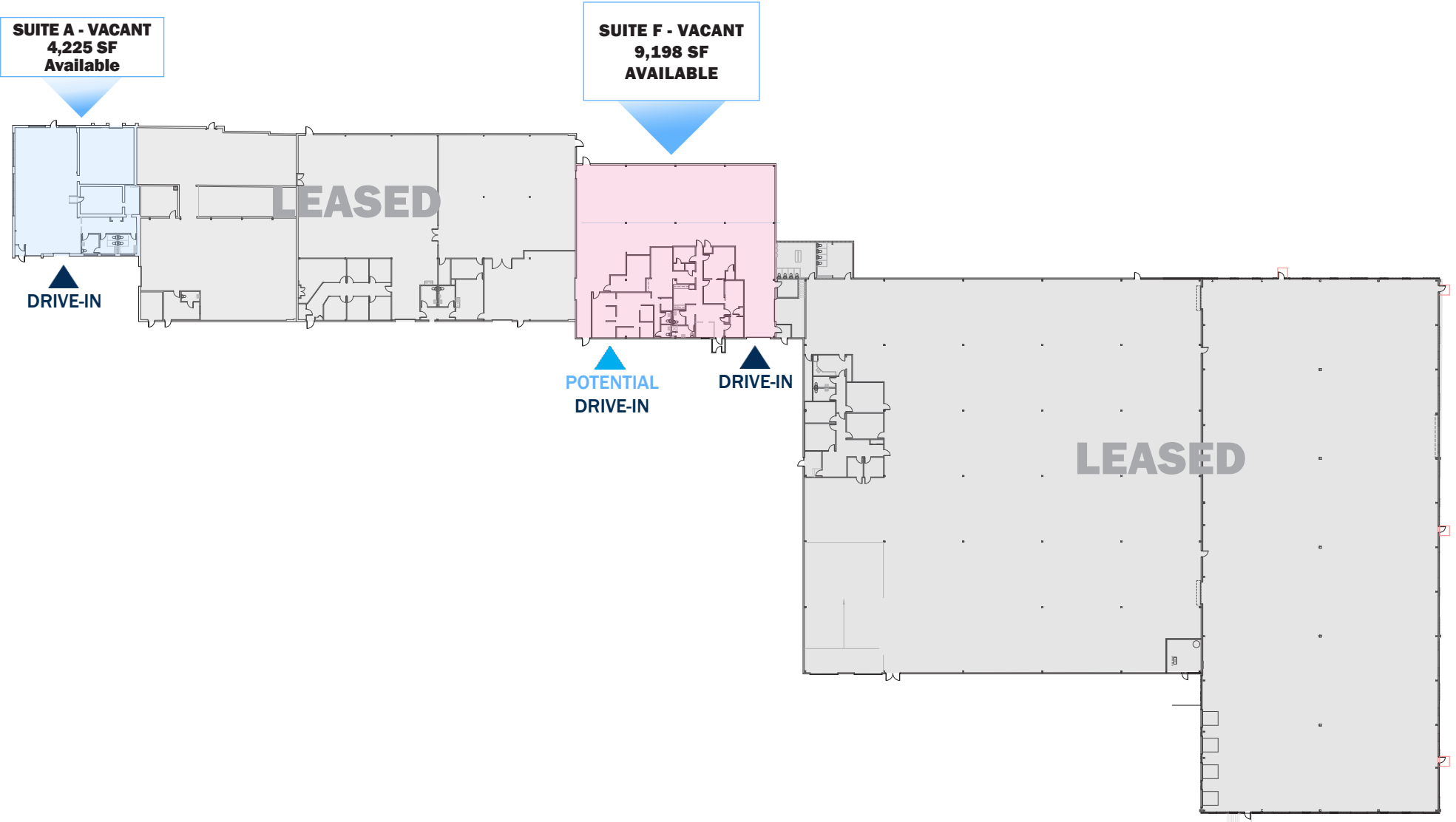

# PHOTOS



# ABOUT VELOCITY



Velocity Venture Partners is a leading developer of industrial real estate throughout the Northeastern Region of the United States and one of the largest owners of industrial space in the region. The firm devotes its time exclusively to industrial & conversion-to-industrial (office/lab/retail to industrial) assets that are located close to densely populated suburban corridors and major transportation arteries.

Velocity has built and maintained a vast network of debt and equity relationships, streamlining the internal funding process for each new acquisition. In addition, the firm's size and nimble approach enables quicker decision making & actions compared to competitors - ranging from acquisitions to leasing, to capex and cosmetic work on newly acquired assets. As a fully integrated firm - with internal infrastructure ranging from construction to property management - Velocity delivers an unmatched approach to strategic industrial acquisitions and asset management. The firm, founded in 2017, currently owns and manages over 8 million square feet of industrial space in the Greater Northeast region - a portfolio comprising more than 350 tenants and 100 properties. The company is led by Gloucester County NJ native, Tony Grelli and Montgomery County PA native, Zach Moore.

**VELOCITY VENTURE PARTNERS, LLC | ONE BELMONT AVENUE, SUITE 520 | BALA CYNWYD PA, 19004-1608 | PHONE: (610) 325-5400**

This brochure is intended for marketing purposes only, is not intended to be complete in all respects, and is provided solely as a convenience for the recipient. Any and all statements, information, and/or drawings contained herein should be independently verified by any recipient of the brochure wishing to rely on same. Neither Velocity Venture Partners LLC ("VVP") nor its owners, principals, subsidiaries, affiliates, members, employees, representatives, or agents (collectively, the "WP Parties") make any claim as to the truth, completeness, and/or accuracy of the contents herein and all VVP Parties hereby expressly disclaim any and all such representations and warranties, both express and implied. The recipient of this brochure waives any and all claims against the VVP Parties arising from and/or relating to the brochure. Any and all intellectual property rights pertaining to any statements, information, and/or drawings in this brochure created by or on behalf of VVP are the sole and exclusive property of VVP. This brochure and the contents herein including, but not limited to, any drawings may not be duplicated, published sold, and/or distributed in part or in whole without the prior written consent of WP.