



**FOR SALE**

**1695 & 1697 MAIN ST FERNDAL**

- **GENERAL INFORMATION**
- **PHOTOS**
- **AREA DEMOGRAPHICS**



**KEVIN GERAGTHY, CCIM**

keving@windermere.com

360-319-6351

www.wrecommercial.com

# FOR SALE

1695 & 1697 MAIN STREET FERNDALE

Best location in Ferndale just 10 minutes north of Bellingham, Ferndale is the fastest growing city in Northwest Washington. Located 15 minutes from the 2nd busiest land border crossing to Canada. Over 3 million people in the great Vancouver Metro area. 2 QSR pads at I-5 & Main St exit over 50,000 vehicles a day on I-5 & over 10,000 vehicles a day on Main St. Buy One for \$1.9m or both for \$3.8m. Current property taxes are for both QSR parcels.

Property is being developed into 2 QSR pads buy one for 1.9m or both for 3.8 Active construction site please get prior approval to enter property. Ok to park to observe the property from adjacent WTA parking lot. Please use Lisa S. at Chicago Title. Whatcom County has not assigned separate Tax ID yet.

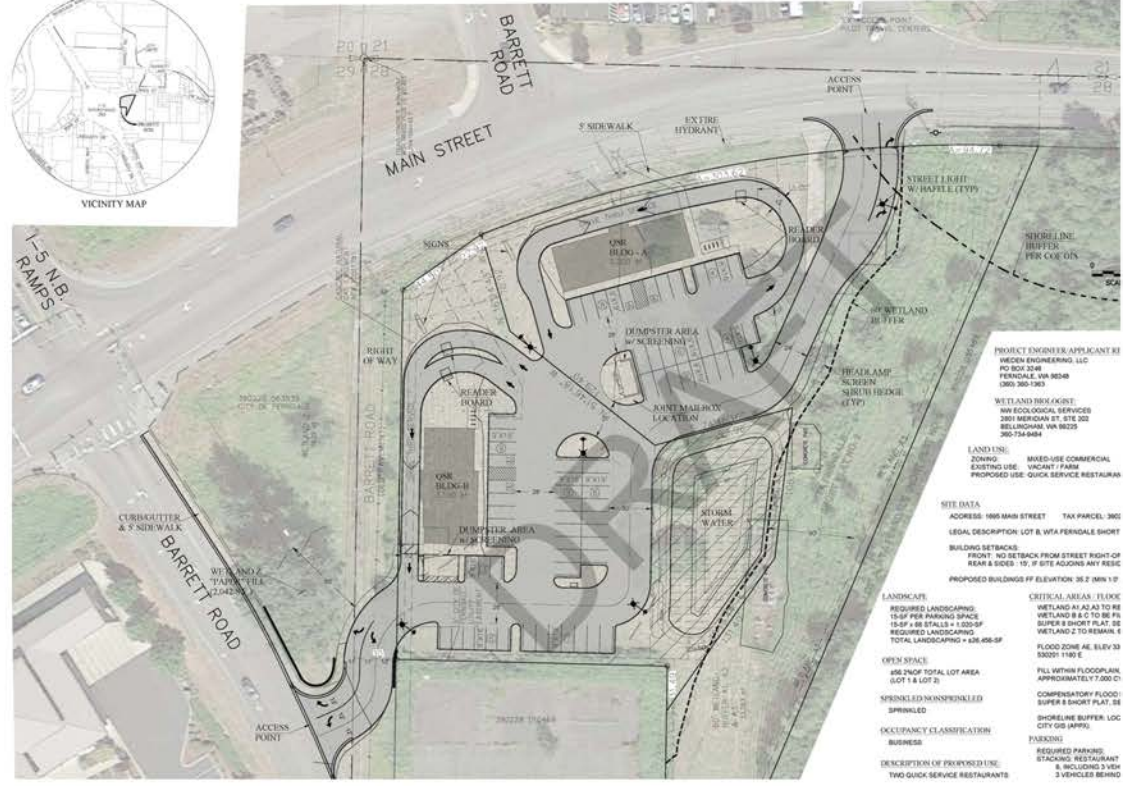

# FOR SALE

1695 & 1697 MAIN STREET FERNDALE



# LOCATION & DEMOGRAPHICS

## Location Facts & Demographics

Demographics are determined by a 10 minute drive from 1695 Main St, Ferndale, WA 98248

CITY, STATE

**Ferndale, WA**

POPULATION

**42,281**

AVG. HHSIZE

**2.51**

MEDIAN HH INCOME

**\$51,481**

HOME OWNERSHIP

Renters: **7,393**

Owners: **9,879**

EMPLOYMENT

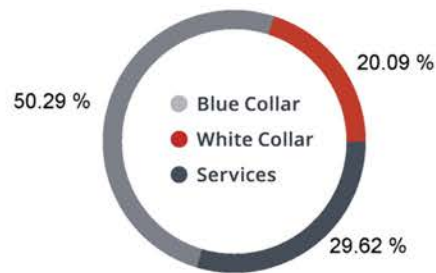

**47.90 %**  
Employed

**2.27 %**  
Unemployed

EDUCATION

High School Grad: **30.86 %**  
Some College: **26.27 %**  
Associates: **7.11 %**  
Bachelors: **22.50 %**

GENDER & AGE

49.13 % 50.87 %

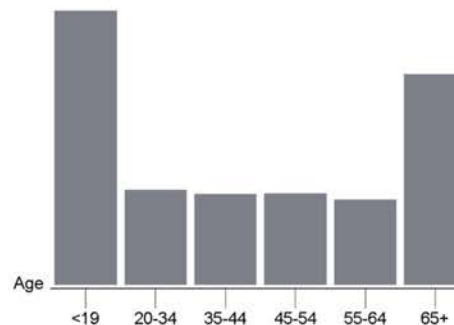

RACE & ETHNICITY

White: **75.51 %**  
Asian: **1.87 %**  
Native American: **1.18 %**  
Pacific Islanders: **0.06 %**  
African-American: **0.54 %**  
Hispanic: **11.85 %**  
Two or More Races: **8.99 %**

## MOODY'S

INCOME BY HOUSEHOLD

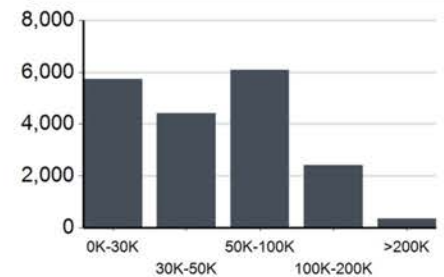

HH SPENDING

