

3440 HILLVIEW AVE

For Sublease
±2,000 – 11,922 RSF
Available Now

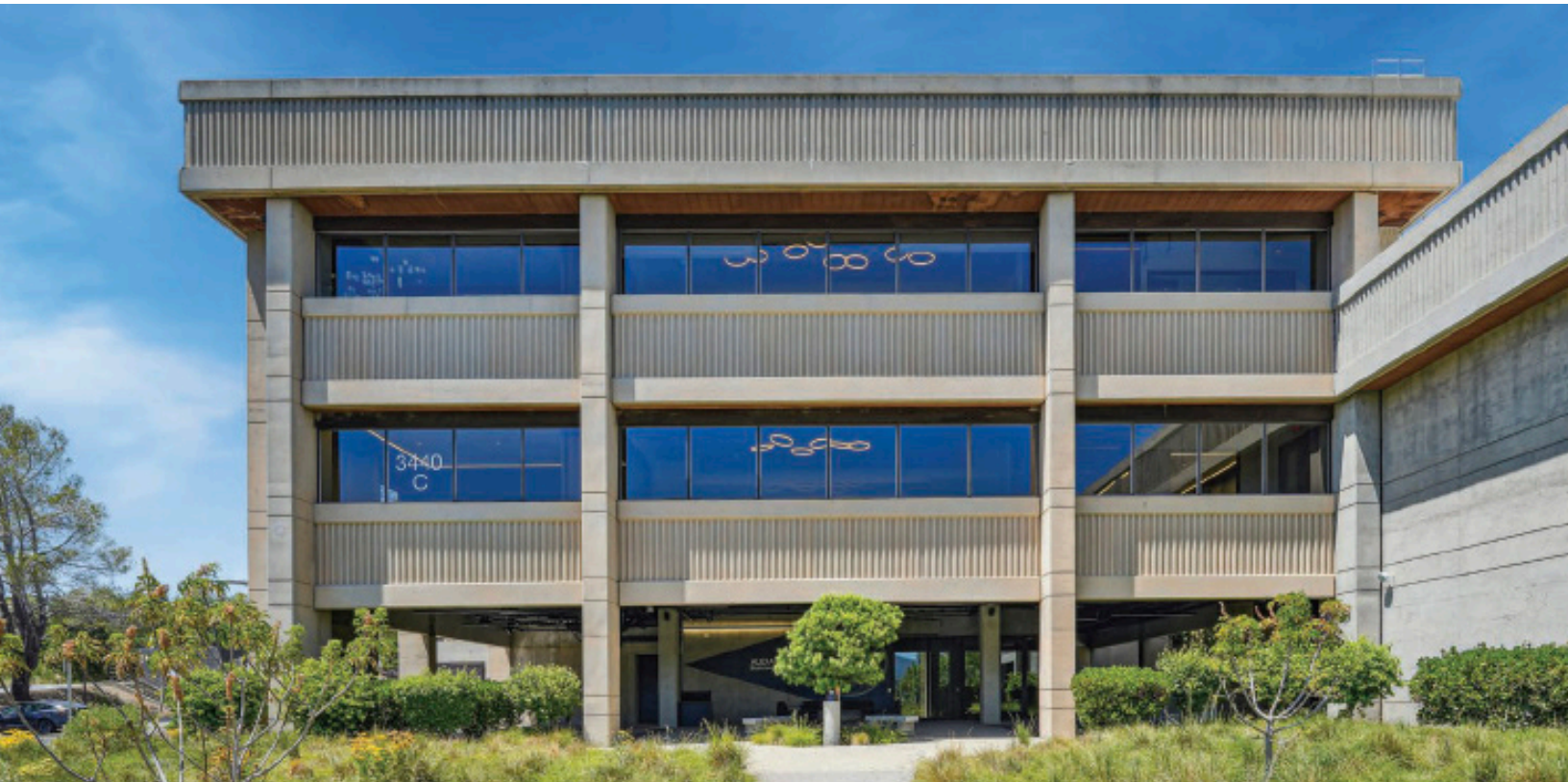

NEWMARK

RANDY SCOTT
Vice Chairman
t 650-688-8510
randy.scott@nmrk.com
CA RE LIC #00852506

ERIC BLUESTEIN
Exec. Managing Director
t 650-688-8547
eric.bluestein@nmrk.com
CA RE LIC #01720416

MAURICE SPIKES
Sr. Managing Director
t 510-356-8492
maurice.spikes@nmrk.com
CA RE LIC #02001506

SUITE C-300 HIGHLIGHTS

- ±2,000 – 11,922 RSF
- 60% Lab / 40% Office
- Large Open Lab Space
- Tissue Culture / Lab Support
- 2 Fume Hoods
- CDA / VAC
- 5 Private Offices (Double Occupancy)
- 3 Meeting Rooms
- 3 Conference Rooms
- Break Area
- Flexible Term

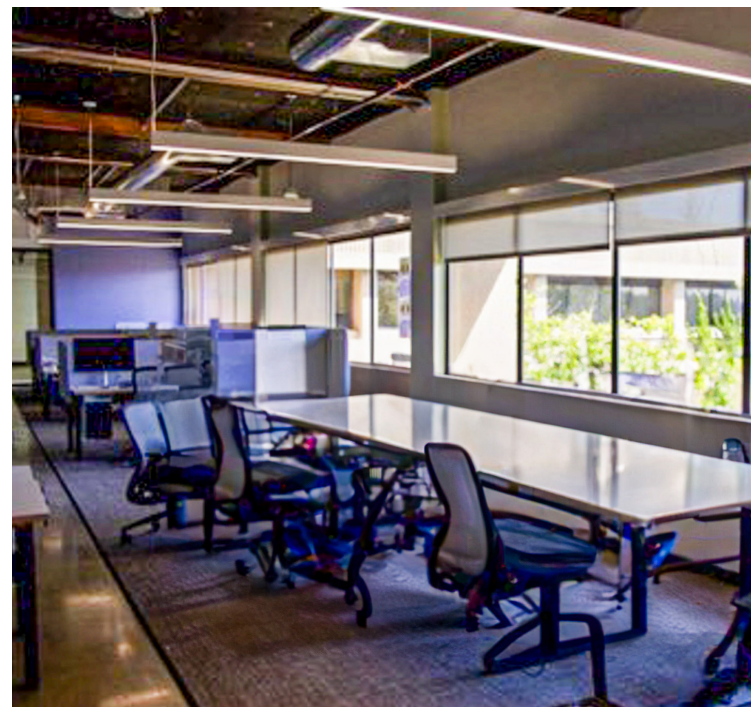
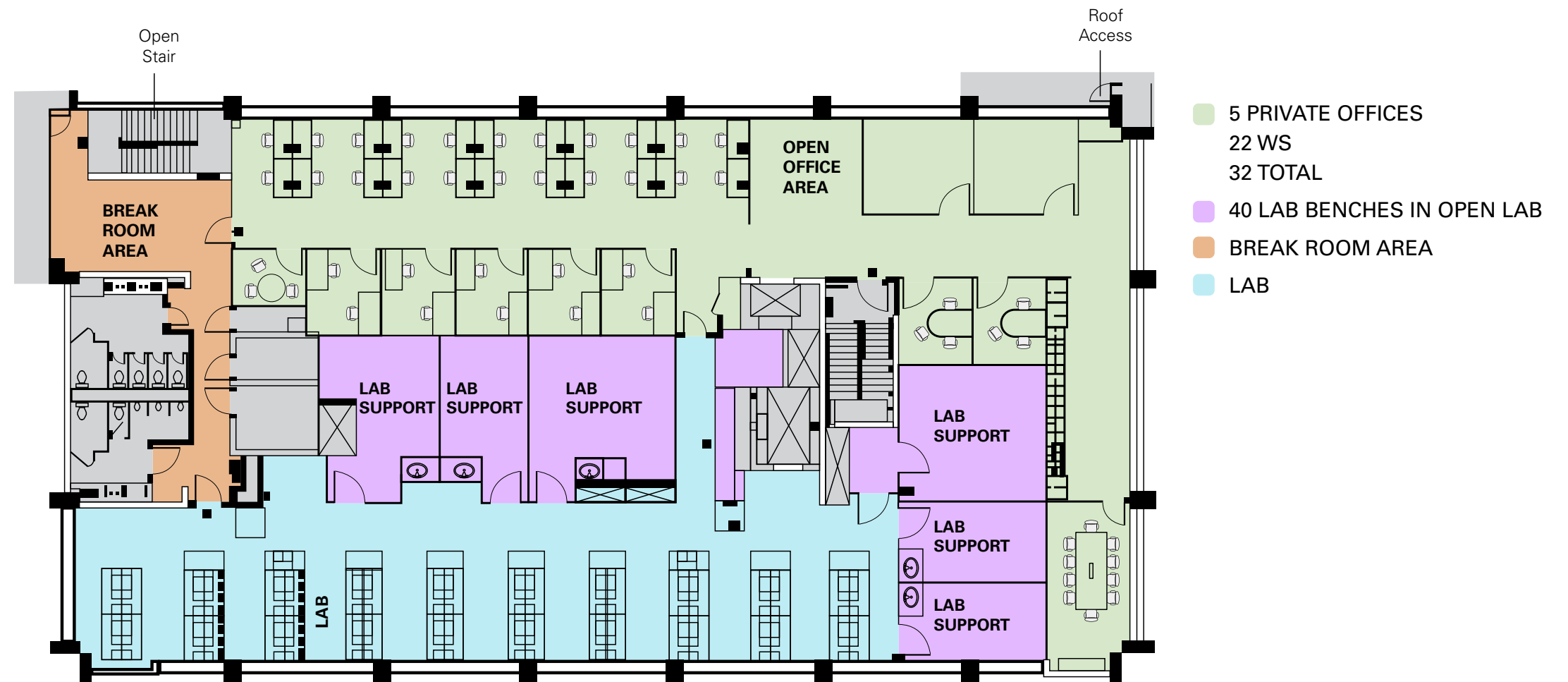

ALEXANDRIA HILLVIEW GALLERY



MARGUERITE SHUTTLE

A.M. Weekday Service (Monday - Friday)

(#216) PATC @ Bus Depot Bay # 3	(#127) On El Camino Real SB @ California Avenue	(#183) On Page Mill Road @ El Camino Real SB	(#184) 1290 Page Mill Road @ Hanover Street	(#255) 3170 Porter Drive	(#186) On Hillview Avenue @ Coyote Hill Road	(#193) 1070 Arastradero Road @ Front Door	(#190) 3475 Deer Creek Road
6:54 a	7:00 a	7:03 a	7:05 a	7:08 a	7:12 a	7:14 a	7:21 a
7:06 a	7:12 a	7:15 a	7:17 a	7:20 a	7:24 a	7:26 a	7:33 a
7:21 a	7:27 a	7:30 a	7:32 a	7:35 a	7:39 a	7:41 a	7:48 a
7:54 a	8:00 a	8:03 a	8:05 a	8:08 a	8:12 a	8:14 a	8:21 a
8:06 a	8:12 a	8:15 a	8:17 a	8:20 a	8:24 a	8:26 a	8:33 a
8:21 a	8:27 a	8:30 a	8:32 a	8:35 a	8:39 a	8:41 a	8:48 a
8:54 a	9:00 a	9:03 a	9:05 a	9:08 a	9:12 a	9:14 a	9:21 a
9:06 a	9:12 a	9:15 a	9:17 a	9:20 a	9:24 a	9:26 a	9:33 a
9:21 a	9:27 a	9:30 a	9:32 a	9:35 a	9:39 a	9:41 a	9:48 a
9:46 a	9:52 a	9:55 a	9:57 a	10:00 a	10:04 a	10:06 a	10:13 a

P.M. Weekday Service (Monday - Friday)

(#191) 3500 Deer Creek Road	(#193) 1070 Arastradero Road @ Front Door	(#195) 3405 Hillview Avenue	(#256) 3165 Porter Drive	(#197) Across From 1290 Page Mill Road @ Hanover Street	(#218) On El Camino Real NB @ Oregon Expressway	(#126) On El Camino Real NB @ California Avenue	(#66) University Circle @ Caltrain Platform
3:19 p	3:21 p	3:24 p	3:28 p	3:32 p	3:35 p	3:37 p	3:48 p
3:35 p	3:37 p	3:40 p	3:44 p	3:48 p	3:51 p	3:53 p	4:04 p
3:45 p	3:47 p	3:50 p	3:54 p	3:58 p	4:01 p	4:03 p	4:14 p
4:19 p	4:21 p	4:24 p	4:28 p	4:32 p	4:35 p	4:37 p	4:48 p
4:35 p	4:37 p	4:40 p	4:44 p	4:48 p	4:51 p	4:53 p	5:04 p
4:45 p	4:47 p	4:50 p	4:54 p	4:58 p	5:01 p	5:03 p	5:14 p
5:18 p	5:20 p	5:23 p	5:27 p	5:31 p	5:34 p	5:36 p	5:47 p
5:35 p	5:37 p	5:40 p	5:44 p	5:48 p	5:51 p	5:53 p	6:04 p
5:45 p	5:47 p	5:50 p	5:54 p	5:58 p	6:01 p	6:03 p	6:14 p
6:18 p	6:20 p	6:23 p	6:27 p	6:31 p	6:34 p	6:36 p	6:47 p
6:35 p	6:37 p	6:40 p	6:44 p	6:48 p	6:51 p	6:53 p	7:04 p

EASY CONNECTIONS TO CALTRAIN WITH FREE MARGUERITE SHUTTLE STOP

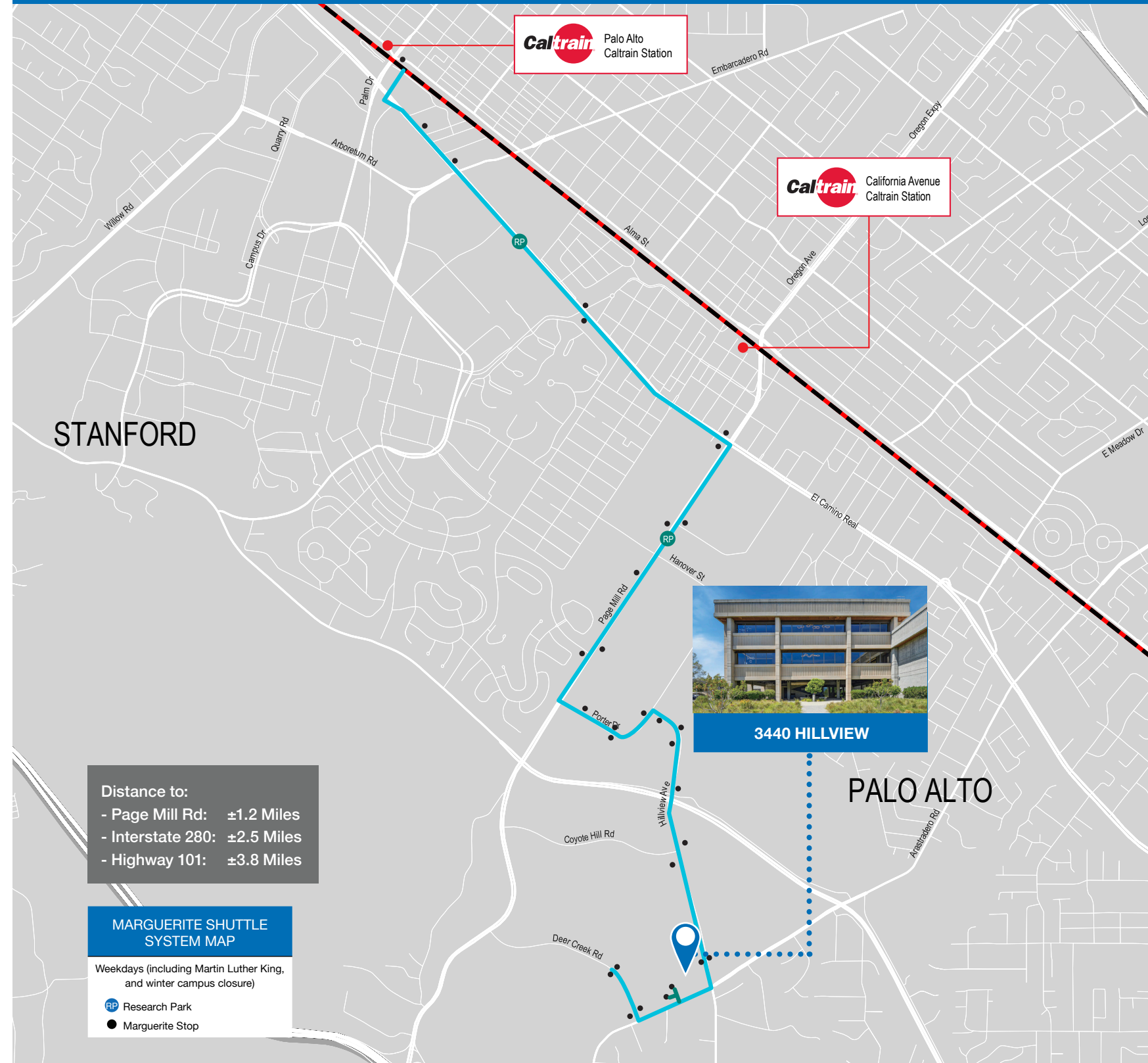



RANDY SCOTT

Vice Chairman
t 650-688-8510
randy.scott@nmrk.com
RE LIC #00852506

ERIC BLUESTEIN

Exec. Managing Director
t 650-688-8547
eric.bluestein@nmrk.com
RE LIC #01720416

MAURICE SPIKES

Sr. Managing Director
t 510-356-8492
maurice.spikes@nmrk.com
RE LIC #02001506

One Sansome Street, Suite 4100
San Francisco, CA 94104

The distributor of this communication is performing acts for which a real estate license is required. The information contained herein has been obtained from sources deemed reliable but has not been verified and no guarantee, warranty or representation, either express or implied, is made with respect to such information. Terms of sale or lease and availability are subject to change or withdrawal without notice.