



# Automotive / Retail Showroom & Warehouse Available

**FOR SALE:** 2733 8th Avenue, Garden City, CO 80631

12,970 SF | .66 Acres | **\$1,426,700**



- Former auto restoration facility
- Four (4) overhead doors on grade.
- Large 2 panel pylon sign which provides for significant exposure to traffic from all directions
- Small fenced storage area in the rear of the building
- Ideal for retail sales, automotive repair and service shops, automotive sales, service establishments (plumbing, sheet metal, and woodworking shops), printing, laundry, office uses, and more – [Click here for Zoning Code](#)
- Close Proximity to Business 85, Hwy 85, and Hwy 34



Demographics & Community	1 Mile	3 Miles	10 Miles
2025 Population	18,208	94,680	140,298
Avg Household Income	\$70,545	\$76,869	\$85,222
Median Age	29.8	32.4	34.1

**Heather Taylor, CCIM**  
Principal  
720.217.1315  
heather@impactcommercial.co

**Ian Elfner**  
Vice President  
414.559.6000  
ian@impactcommercial.co

7000 S. Yosemite St., Ste. 290  
Centennial, CO 80112  
720.608.4201  
**impactcommercial.co**



# Automotive / Retail Showroom & Warehouse Available

**FOR SALE:** 2733 8th Avenue, Garden City, CO 80631

12,970 SF | .66 Acres | **\$1,426,700**

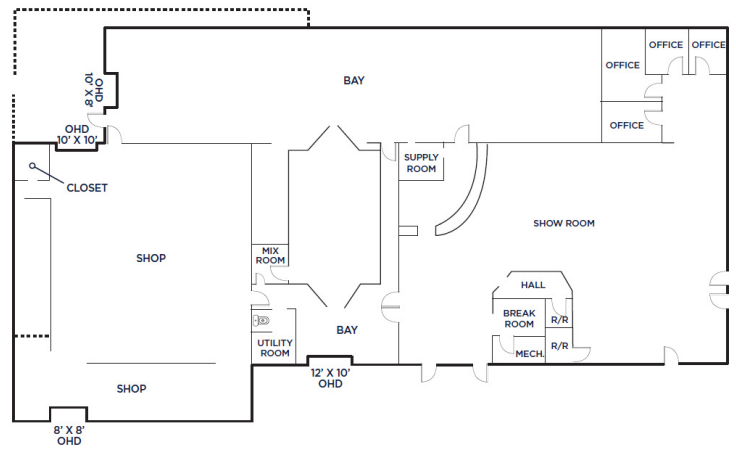

County:  
Year Built:  
Zoning:  
2025 Tax Estimate:

Weld  
1967, 2015 Addition  
"Commercial"  
\$44,028.29

**Heather Taylor, CCIM**  
Principal  
720.217.1315  
heather@impactcommercial.co

**Ian Elfner**  
Vice President  
414.559.6000  
ian@impactcommercial.co

7000 S. Yosemite St., Ste. 290  
Centennial, CO 80112  
720.608.4201  
**impactcommercial.co**