



Industrial at FREMONT STATION

NEW OWNERSHIP



±128,400 SF
MULTI-TENANT ADVANCED
MANUFACTURING / WAREHOUSE



NEWMARK  **LONGPOINT**

2700 - 2728 PRUNE AVENUE | FREMONT, CALIFORNIA

FEATURES

Industrial at FREMONT STATION

- New Institutional Ownership
- Brand New Enhanced Exterior & Interior Renovations
- Ideal Transit Focused Location:
 - 4 min walk to Warm Springs / South Fremont BART Station
 - Easy Access to I-880 & I-680
- High Visibility Corner Location
- Current Availabilities + Future Expansion Opportunities

FLOOR PLAN

SPACE HIGHLIGHTS

2700 Prune Avenue

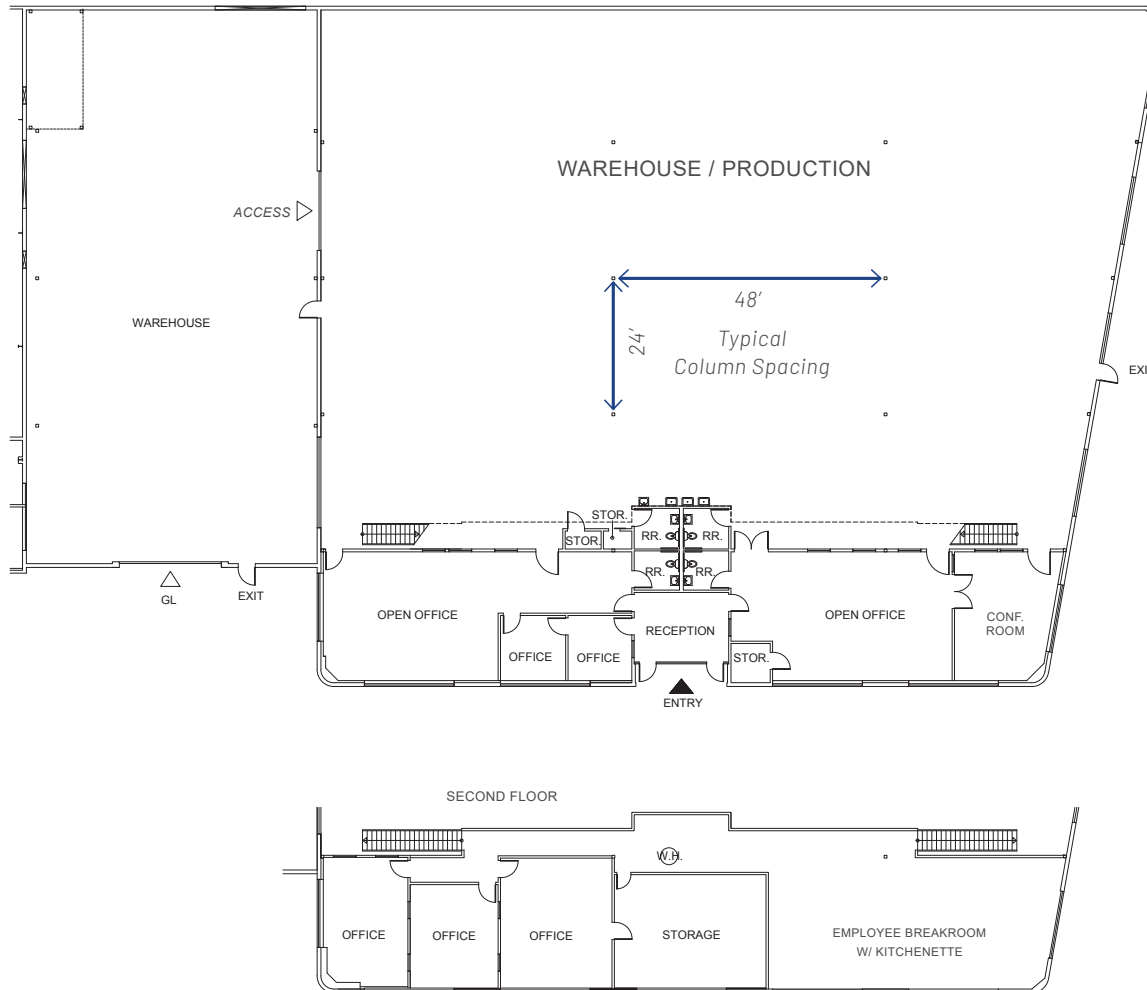

- ±25,474 Square Feet
- High Visibility Corner Unit
- Up to ±1,600 Amps at 277/480 Volts Power
- ±5,054 SF Office
- 24' Clear Height in Warehouse/Production Area
- One (1) Over-sized Grade Level Door
- 24' x 48' Column Spacing
- Ample Parking
- Skylights Throughout
- Tenant Improvement Dollars Available
- Available Now

Now Touring - Contact Brokers to Schedule

PHOTOS

2700 Prune Avenue



PHOTOS

2700 Prune Avenue



MAP



5

MINUTES

I-880 &
I-680

6

MILES

CA-237

10

MILES

SJC

20

MILES

STANFORD

24

MILES

OAK

34

MILES

SFO

Industrial at FREMONT STATION

±128,400 SF MULTI-TENANT ADVANCED MANUFACTURING / WAREHOUSE

JOE KELLY
408.987.4111
joe.kelly@nrmk.com
CA RE License #01420963

CURTIS STAHLE
510.300.0222
curtis.stahle@nrmk.com
CA RE License #01955258

3055 Olin Avenue, Suite 2200, San Jose, CA 95128

The distributor of this communication is performing acts for which a real estate license is required. The information contained herein has been obtained from sources deemed reliable but has not been verified and no guarantee, warranty or representation, either express or implied, is made with respect to such information. Terms of sale or lease and availability are subject to change or withdrawal without notice. **7674275 • 04/26**

NEWMARK

LONGPOINT

2700 - 2728 PRUNE AVENUE | FREMONT, CALIFORNIA