

FOR SALE

± 3,140 SQUARE FEET TWO-STORY INDUSTRIAL CONDO



1279 N. TUSTIN AVE., ANAHEIM, CA 92807

PROPERTY HIGHLIGHTS

- ± 2,186 SF of Two-Story Office Space
- ± 954 SF Warehouse
- One (1) 12'x14' Warehouse Loading Door
- Twenty Foot (20') Warehouse Clearance
- 200 Amps; 120/208V Power (verify)
- Two (2) Restrooms
- 2.5:1,000 Parking Ratio
- Excellent East Anaheim Location
- Street Frontage on Tustin Avenue
- Anaheim Power - Competitive Rates
- Business Park Environment

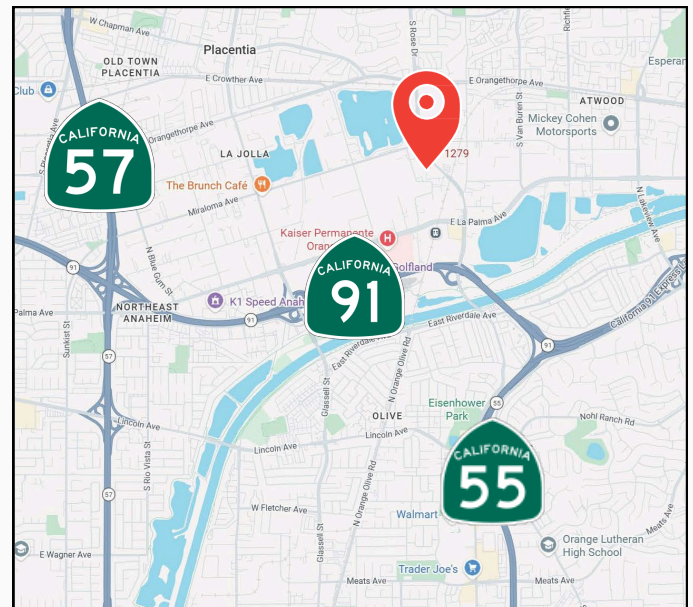

BRIAN WILLIAMS
SENIOR VICE PRESIDENT

(714) 453-0300

BWILLIAMS@ASHWILLASSOCIATES.COM

CADRE LIC.00805001

Disclaimer: This Information contained herein is believed reliable but not guaranteed. Photos may be digitally altered or artistic renderings. All trademarks and images are the property of their respective owners. Buyers and Tenants should verify information independently.



CORP. DRE LIC.01291393

FOR SALE

± 3,140 SQUARE FEET

TWO-STORY INDUSTRIAL CONDO

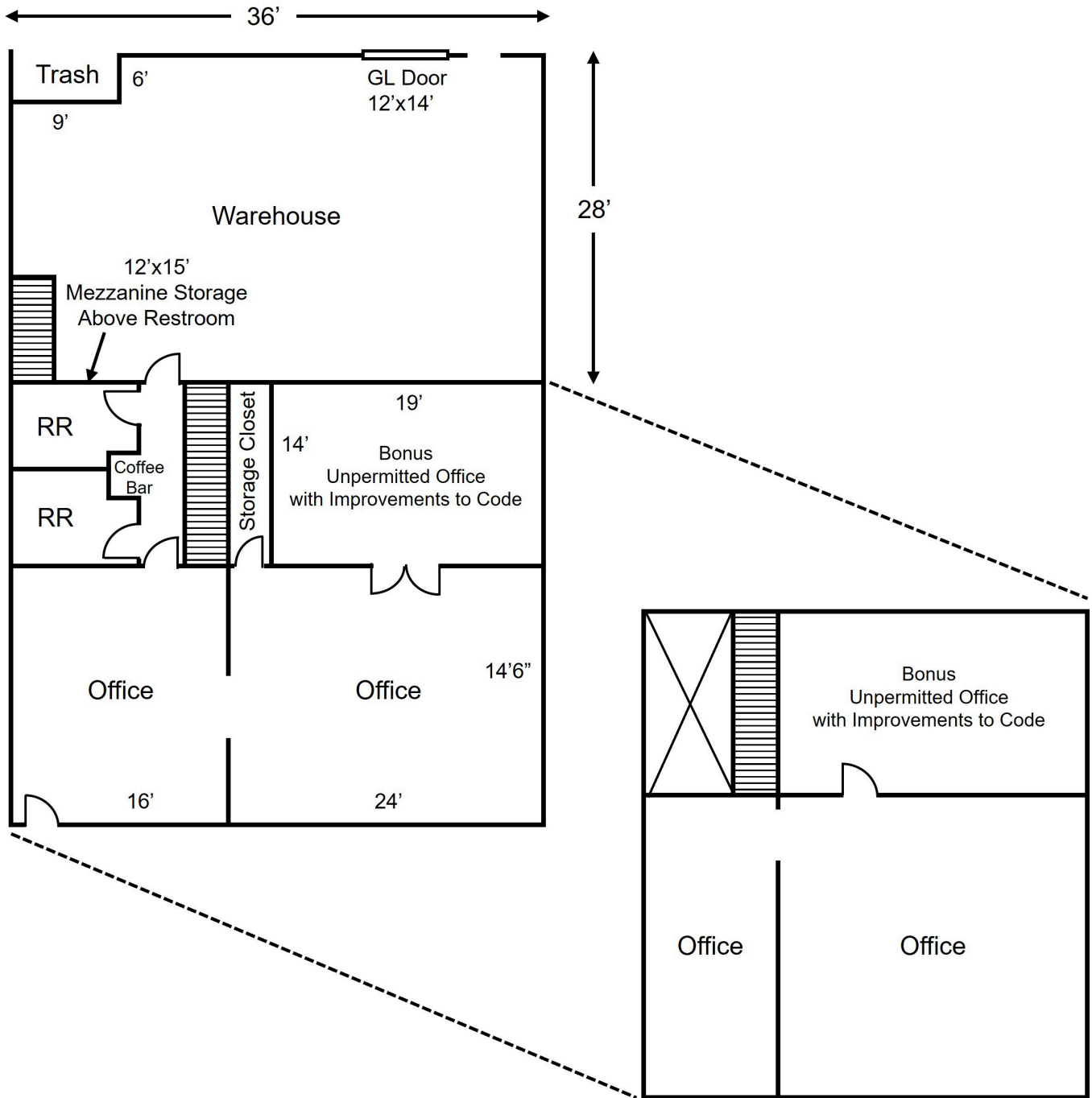

Second Floor Office

BRIAN WILLIAMS

SENIOR VICE PRESIDENT

(714) 453-0300

BWILLIAMS@ASHWILLASSOCIATES.COM

CADRE LIC.00805001

Disclaimer: This Information contained herein is believed reliable but not guaranteed. Photos may be digitally altered or artistic renderings. All trademarks and images are the property of their respective owners. Buyers and Tenants should verify information independently.

**Ashwill
Associates**
COMMERCIAL REAL ESTATE

CORP. DRE LIC.01291393

FOR SALE

± 3,140 SQUARE FEET

TWO-STORY INDUSTRIAL CONDO

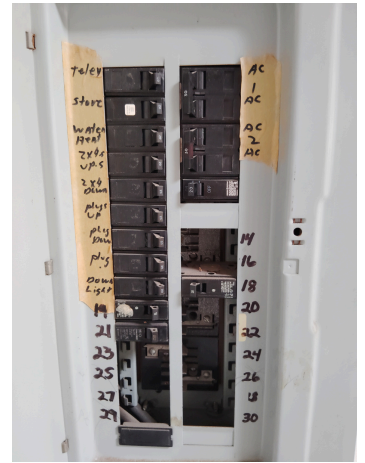
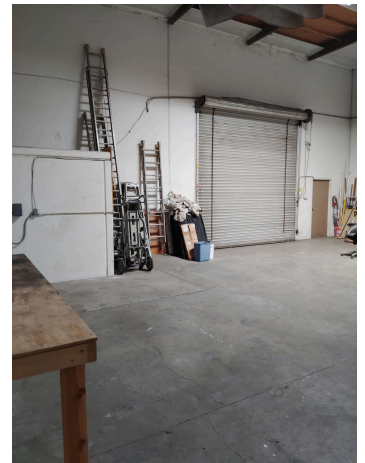

BRIAN WILLIAMS

SENIOR VICE PRESIDENT

(714) 453-0300

BWILLIAMS@ASHWILLASSOCIATES.COM

CADRE LIC.00805001

Disclaimer: This Information contained herein is believed reliable but not guaranteed. Photos may be digitally altered or artistic renderings. All trademarks and images are the property of their respective owners. Buyers and Tenants should verify information independently.



CORP. DRE LIC.01291393