

Industrial Facility For Sublease

1103 E AIRTEX DR
HOUSTON / TX



Airtex Business Park

**18,573 SF
Freestanding
Warehouse
For Sublease**

1103 E AIRTEX DR | HOUSTON | TX 77073

Steve King
First Vice President
+1 713 577 1617
steve.king@cbre.com

Wesley King
Senior Associate
+1 713 577 1582
wesley.king@cbre.com

CBRE

Building Specifications

- Building Size: 18,573 SF
- Warehouse: 16,379 SF
- Office: 2,194 SF
- Tiltwall Construction
- Loading Configuration: Rear-Load
- Truck court is fully fenced and gated
- Clear Height: 26'
- ESFR Sprinklered
- Outside Storage included behind the building
- Loading Access: 3 dock-high OH doors | 1 ramp
- Power: 3 Phase/480 Volt/400 Amps
- Within 6 miles of George Bush Intercontinental Airport
- Easy access to Hardy Toll Rd, I-45, Beltway 8, and Hwy 59
- Sublease Expiration: 10/31/2027
- Lease Rate: Please Contact Brokers for Pricing

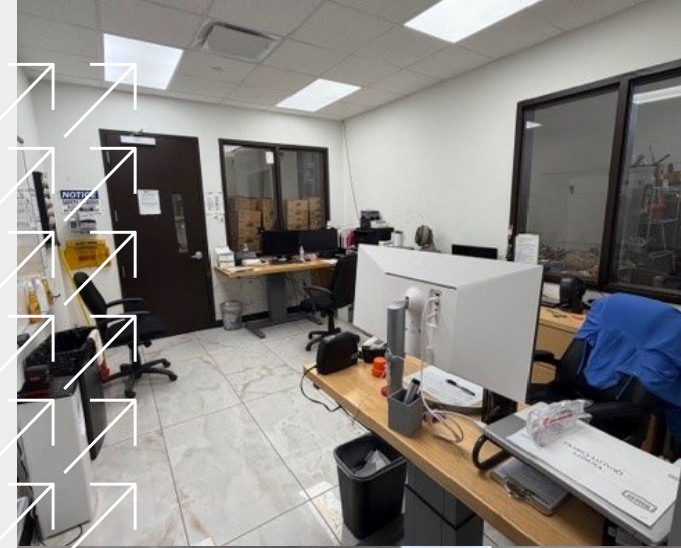

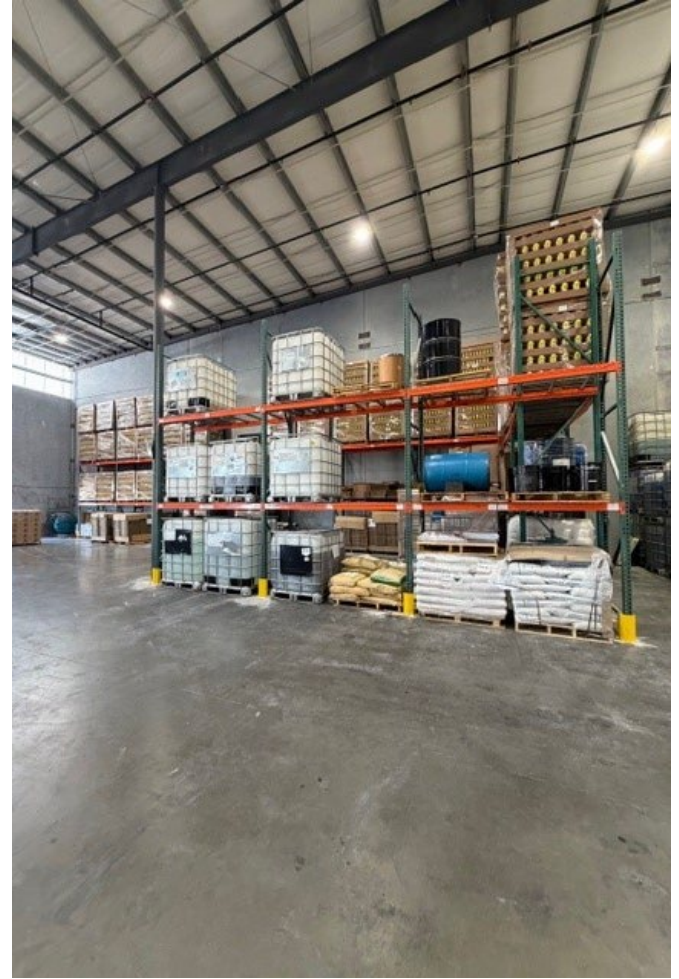

Building Photos

Floor Plan

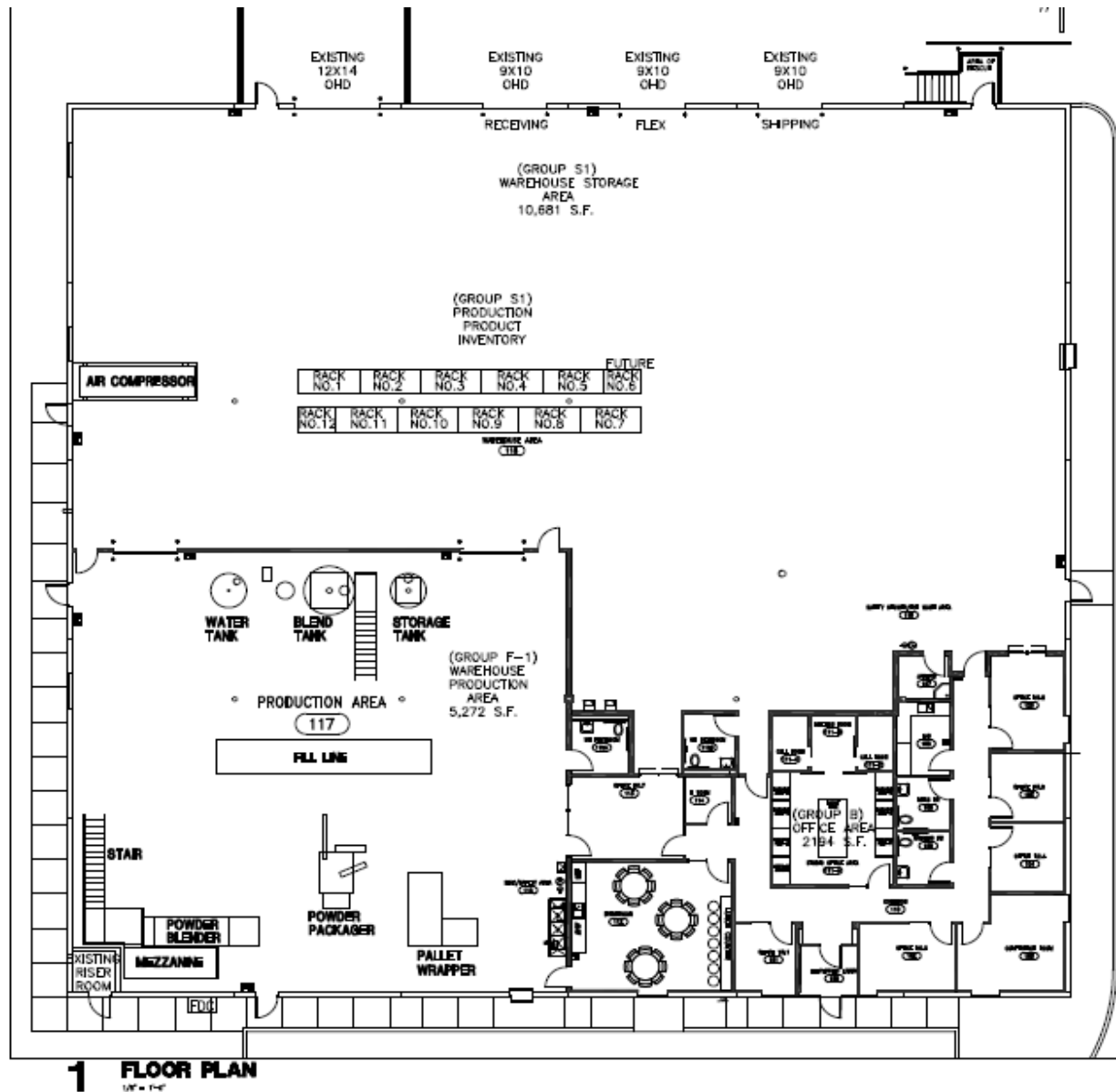

Warehouse: 16,379 SF
Office: 2,194 SF
Total: 18,573 SF

Aerial Map



1103 E AIRTEX DR
HOUSTON / TX

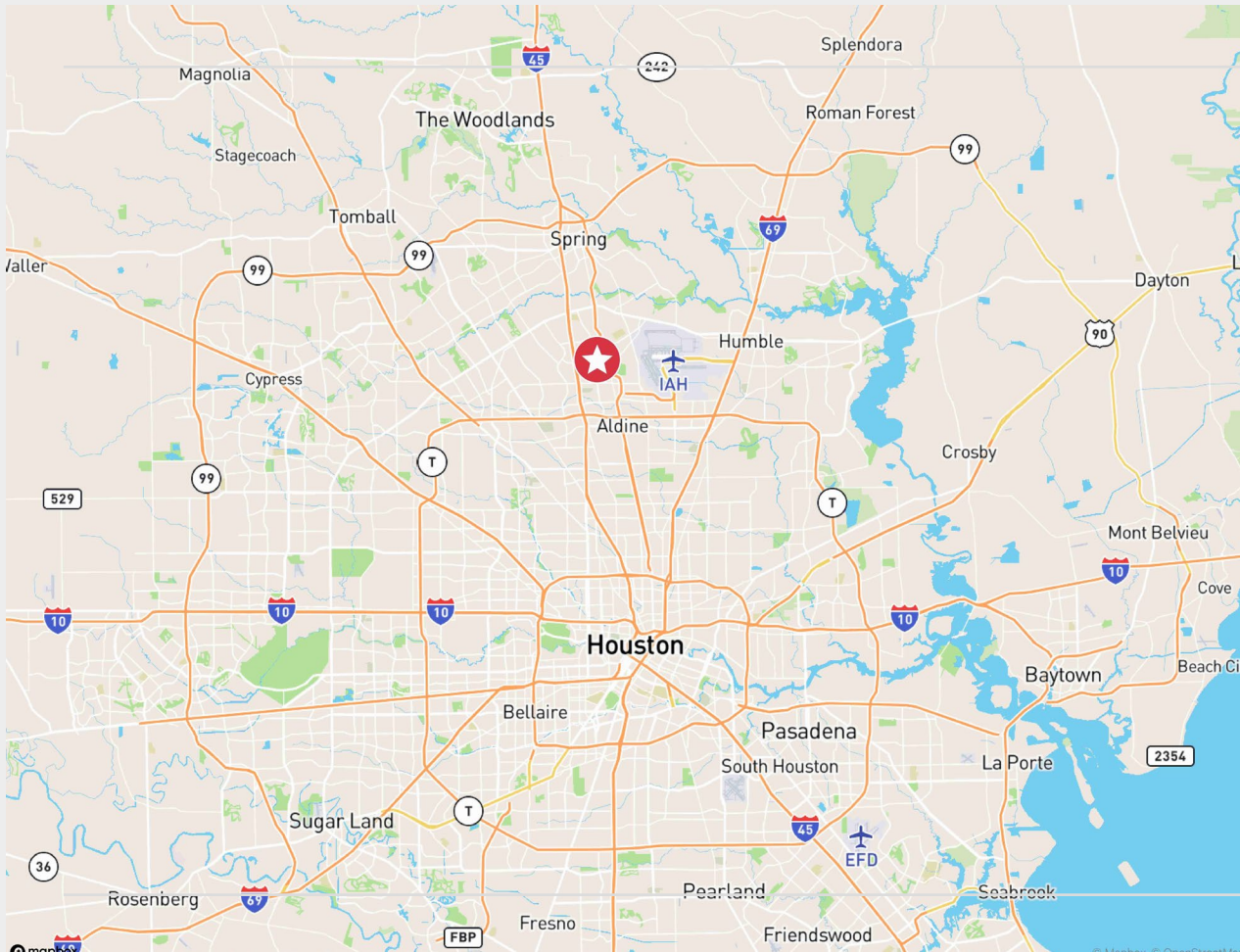

Airtex Business Park

18,573 SF
Available
For Sublease

Steve King
First Vice President
+1 713 577 1617
steve.king@cbre.com

Wesley King
Senior Associate
+1 713 577 1582
wesley.king@cbre.com



© 2025 CBRE, Inc. All rights reserved. This information has been obtained from sources believed reliable but has not been verified for accuracy or completeness. CBRE, Inc. makes no guarantee, representation or warranty and accepts no responsibility or liability as to the accuracy, completeness, or reliability of the information contained herein. You should conduct a careful, independent investigation of the property and verify all information. Any reliance on this information is solely at your own risk. CBRE and the CBRE logo are service marks of CBRE, Inc. All other marks displayed on this document are the property of their respective owners, and the use of such marks does not imply any affiliation with or endorsement of CBRE. Photos herein are the property of their respective owners. Use of these images without the express written consent of the owner is prohibited.