



**FOR SUBLEASE**

**2322 W 500 N  
SUITE C.  
SPRINGVILLE, UT  
84663**



**RSE**  
2,760 SF



**RATE**  
\$4,148.19 NNN



**AVAILABILITY**  
AVAIL NOW

**SPRINGPOINTE SUBLEASE**



**CASON ACOR**

cason@summitutahcre.com  
direct: 801.995.5184  
office: 801.435.5005

*[View Profile](#)*

# FLOOR PLAN

## Building Highlights

- 2,760 SF
- Available for short or long-term sublease, allowing maximum flexibility
- Sublease includes all office furniture
- Equidistant from the 1400 North and 400 South Springville interchanges
- Positioned to easily service northern and southern Utah County
- 4/1000 parking ratio
- 18' clear height, 14' roll-up door
- Building power: 1600 amp - 3 Phase  
- 208 Volt
- Warehouse dimensions are 64'x30'
- \$4,148.19/month NNN

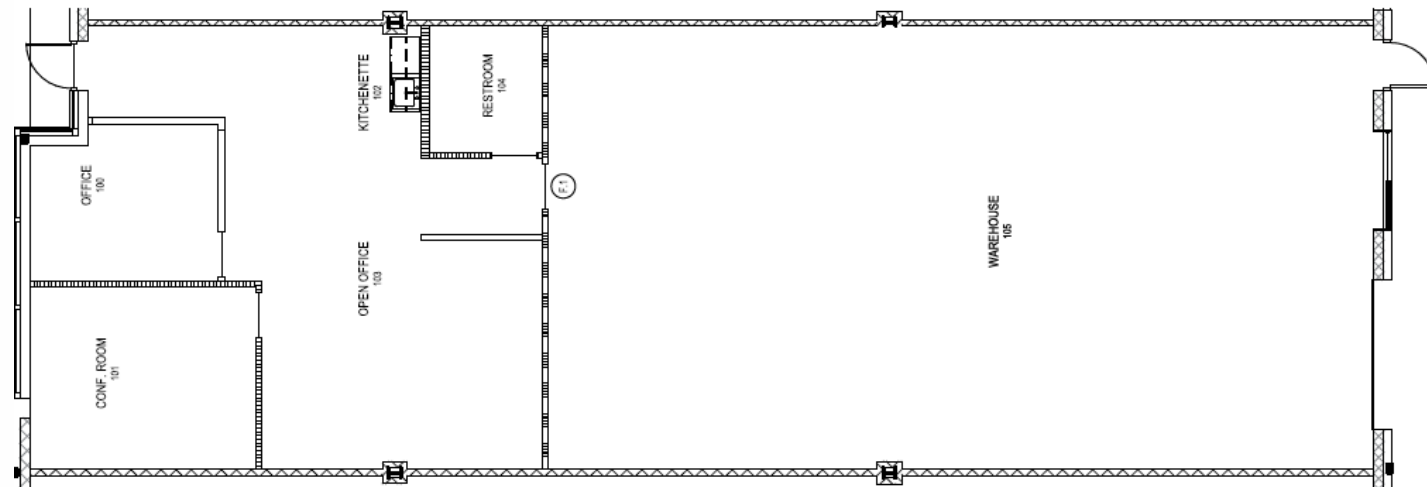

### CASON ACOR

cason@summitutahcre.com  
direct: 801.995.5184  
office: 801.435.5005

[View Profile](#)



**CASON ACOR**

cason@summitutahre.com

direct: 801.995.5184

office: 801.435.5005

*[View Profile](#)*





**CASON ACOR**

cason@summitutahcre.com

direct: 801.995.5184

office: 801.435.5005

*[View Profile](#)*

