

Retail | For Lease

CBRE

# Oak & Olive

85th Street SW & Broadcast Avenue SW



Now Leasing!



# The Development

“West District is where life happens”

Oak & Olive is located in the highly sought after West side, directly off of 85th Street SW and across from the completed Gateway project at West District. Like the Gateway Oak & Olive will also be a mixed use development comprising of approximately 23,000 square feet of commercial space and 216 residential units. This “Urban Centre” will allow residents to stay connected to their neighborhood while providing opportunities to live, work, shop and play. In addition, the West Calgary Ring Road project will further connect this community providing easy and quick access around and out of the city.

The Oak & Olive development is one of the many phases of this multi-phase 95 acre community which will host a total of 3,500 residential units, 500,000 square feet of retail space and 1.2 million square feet of office space. Over the next decade the West District will be transformed into a vibrant, mixed use neighborhood that will redefine urban living and working in Calgary. West District is where life happens.

## Details

**Size:** Building A- 10,979 sq.ft  
Building B- 3,283 sq.ft  
Building C- 8,319 sq.ft

**Op Costs ( 2023 est. ) :** \$18.71 per sq.ft

**Zoning:** Direct Control- C-COR1

**Available:** Q2 2025

**Signage:** Fascia & Pylon

**Rates:** Market



Population of 125,997  
within 5km with an  
average age of 38



Household income within  
5km is \$219,476



22,000 vehicles per day  
on 85th Street



# Oak & Olive

## Site Plans

### Building A

#### Details

CRU A01-27-	2,067 sq.ft
CRU A01-28-	1,152 sq.ft
CRU A01-29-	1,152 sq.ft
CRU A01-09-	1,485 sq.ft
CRU A01-10-	1,345 sq.ft
CRU A01-11-	1,001 sq.ft
CRU A01-12-	1,001 sq.ft
CRU A-1-13-	1,776 sq.ft

#### Space:

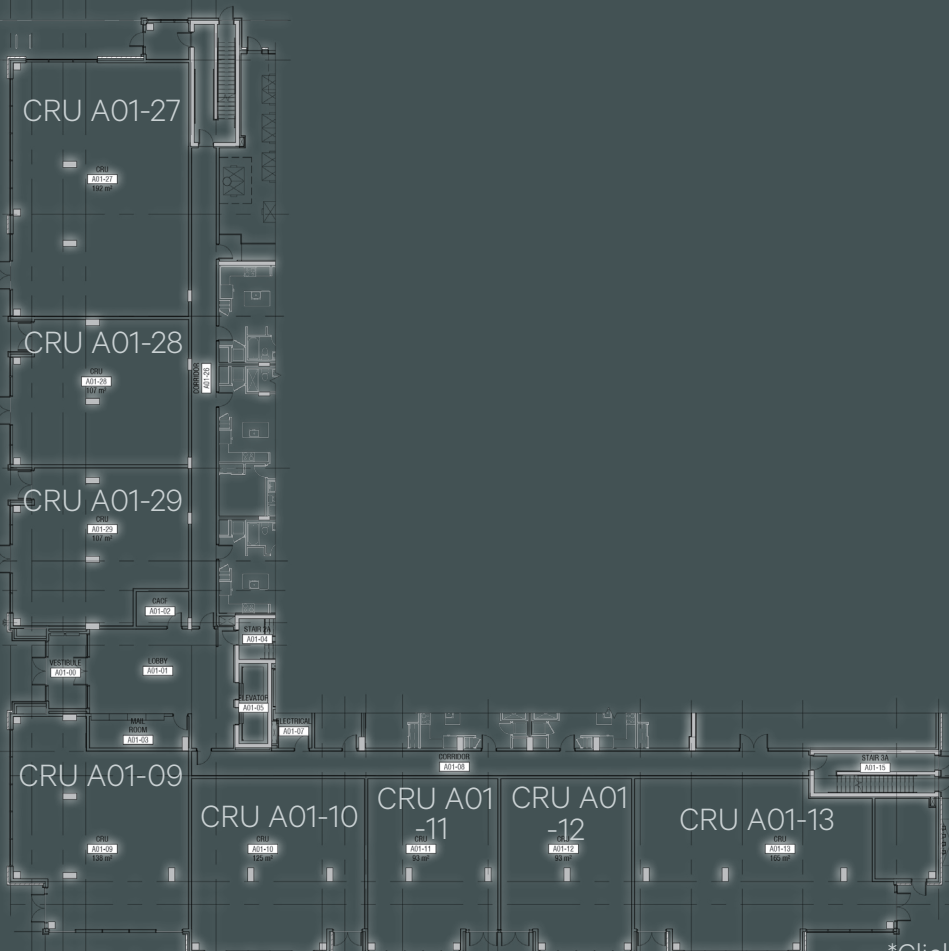
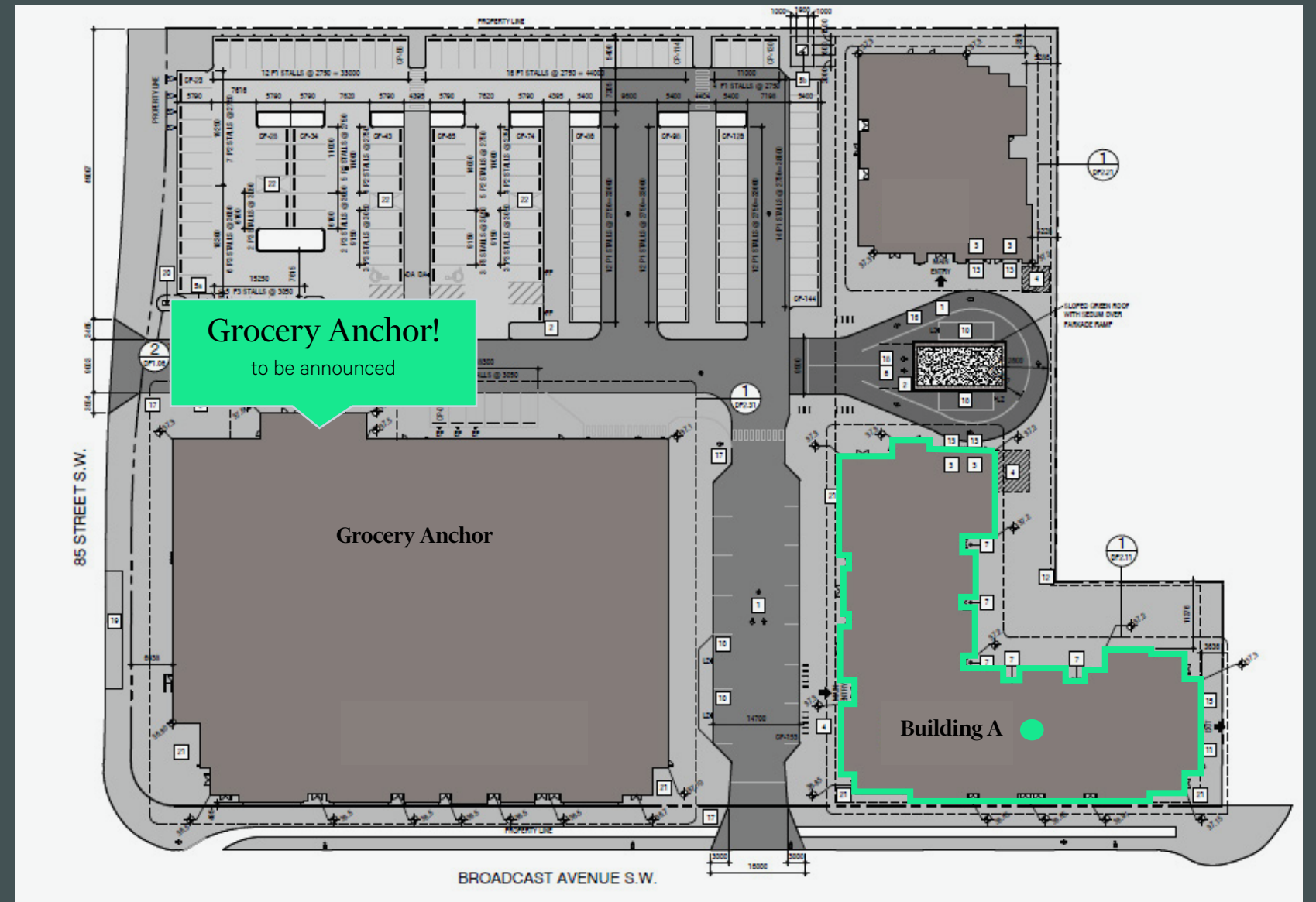

\*Click on circles for more information



# Oak & Olive

## Site Plans

### Building B

#### Details

Space:

CRU B01-17-	1,130 sq.ft
CRU B01-16-	958 sq.ft
CRU B01-15-	1,195 sq.ft

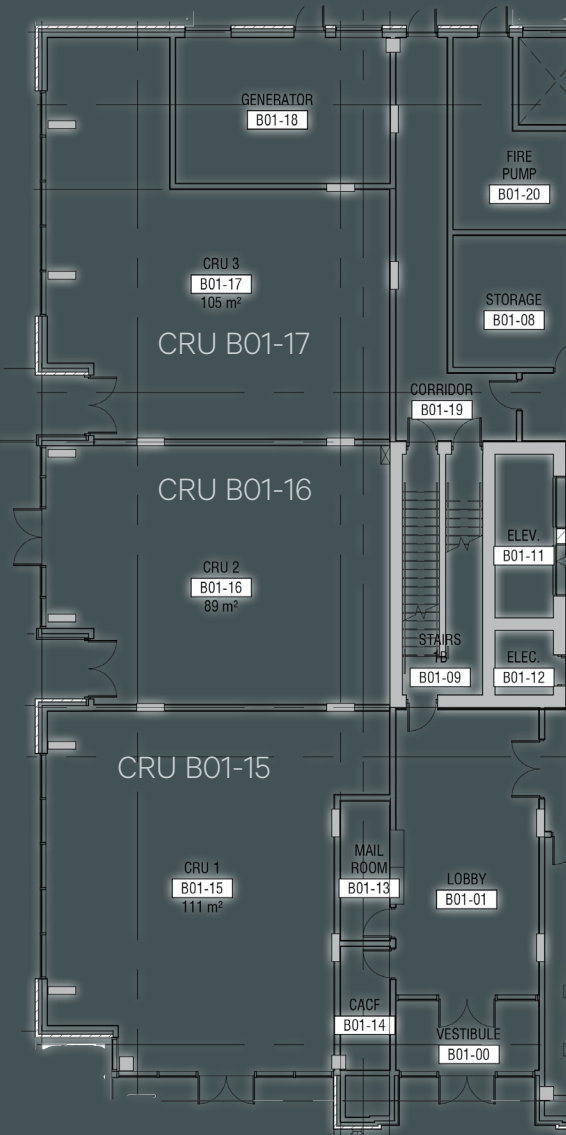
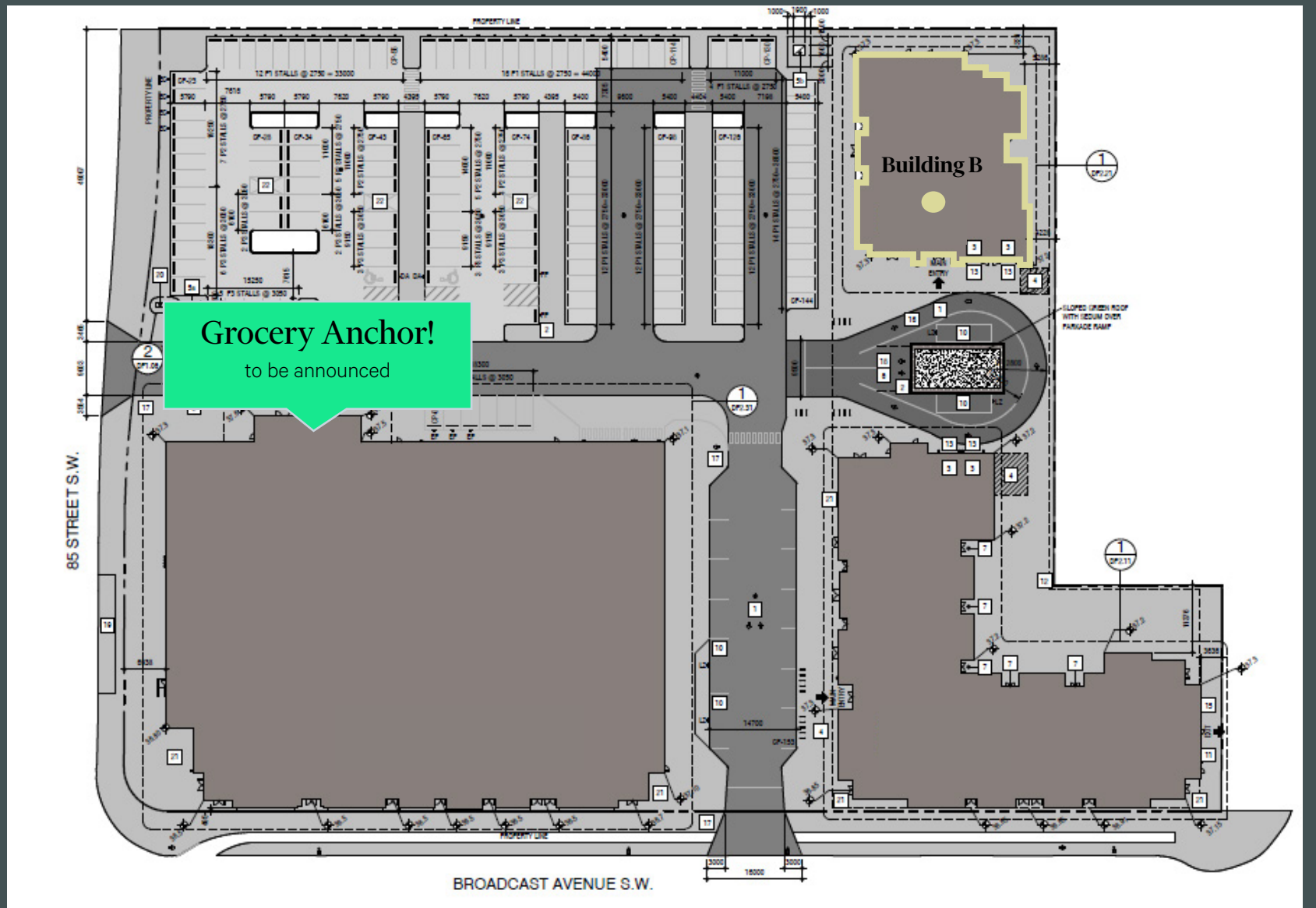

\*Click on circles for more information

# Oak & Olive

## Site Plans

### Building C

#### Details

CRU A C105-	2,433 sq.ft + Roof Top Patio!
CRU B C106-	1,141 sq.ft
CRU C C107-	936 sq.ft
CRU D C108-	936 sq.ft
CRU E C109-	914 sq.ft
CRU F C110-	1,141 sq.ft
CRU G C111-	818 sq.ft

#### Space:

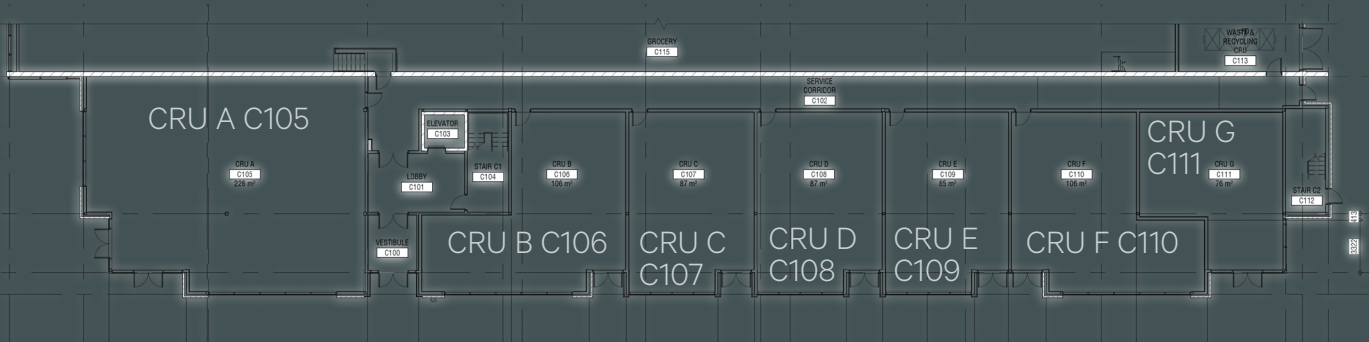
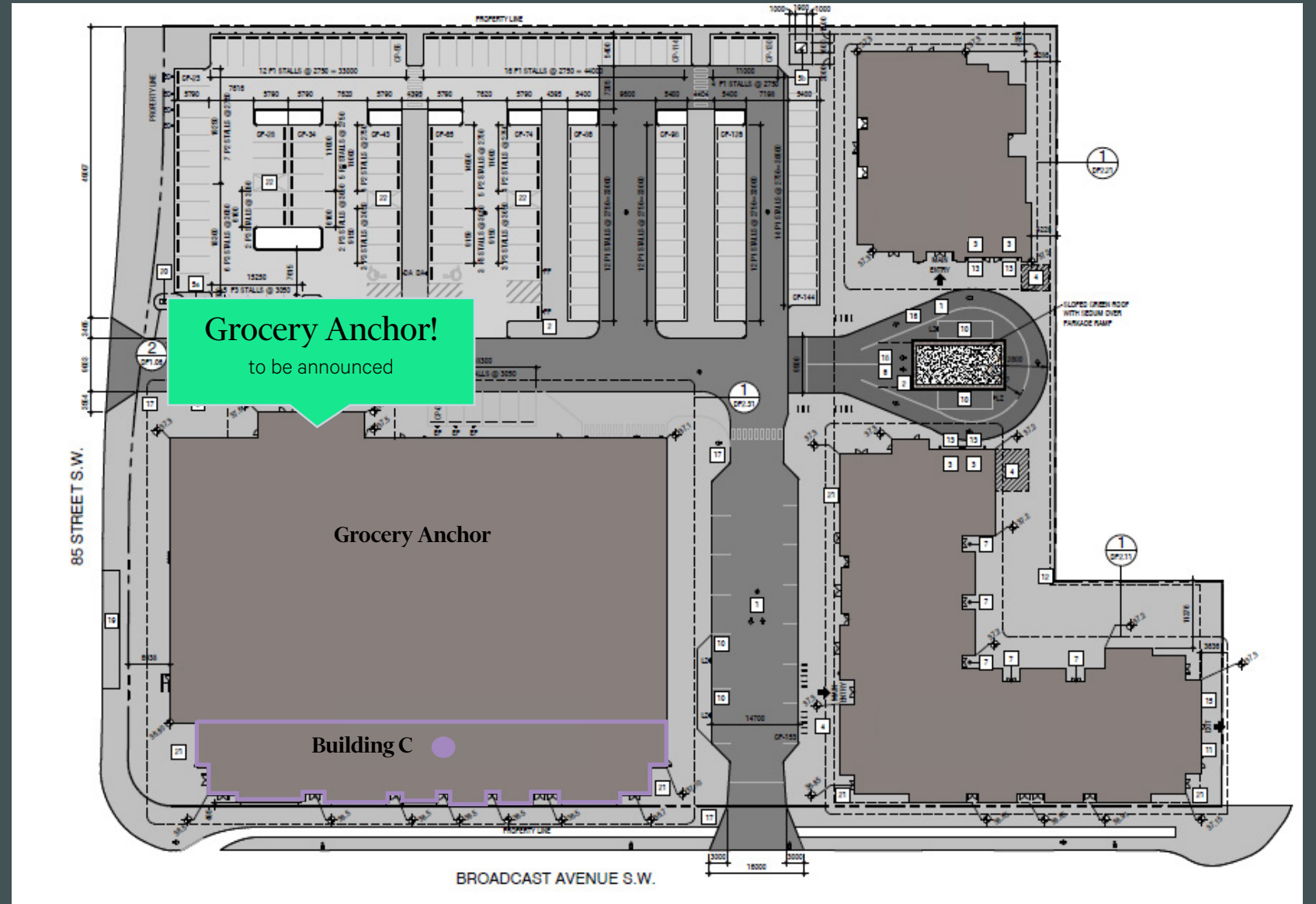

\*Click on circles for more information

# Desirable Location



- Servicing the area of Aspen, Wentworth, Westsprings, Coach Hill, Discovery Ridge, Crestmont and more!
- Close proximity to 85th Street and Old Banff Coach Road with pending Ring Road slated to open Summer 2024.
- West District will comprise of multiple mixed-use buildings, all of which will surround the main amenity park; Radio Park. Radio Park will be a multi million dollar park featuring award winning architecture and the central gathering spot for the community.



West District Phases Coming Soon!





## Contact Us

**John Moss**  
Senior Vice President  
+1 403 750 0507  
john.moss@cbre.com

**Ania Gryzewski**  
Vice President  
+1 403 750 0806  
ania.gryzewski@cbre.com

**Brittany Camilleri**  
Client Service Specialist\*  
+1 403 294 5706  
brittany.camilleri@cbre.com

**Brodie Davis**  
Associate\*  
+1 403 750 0513  
brodie.davis@cbre.com

\*Licensed

\*Not Licensed

This disclaimer shall apply to CBRE Limited, and to all divisions of the Corporation ("CBRE"). The information set out herein (the "Information") has not been verified by CBRE, and CBRE does not represent, warrant or guarantee the accuracy, correctness and completeness of the Information. CBRE does not accept or assume any responsibility or liability, direct or consequential, for the Information or the recipient's reliance upon the Information. The recipient of the Information should take such steps as the recipient may deem necessary to verify the Information prior to placing any reliance upon the Information. The Information may change and any property described in the Information may be withdrawn from the market at any time without notice or obligation to the recipient from CBRE.

**CBRE**